

Open Look ShatterGuard: Hospitals and Food Service

Features

Lamp / Socket

- Designed for:
 - RR20613: Vertical 150 watt (max.) A-21 inside frosted incandescent lamp (by others). RR20714: Vertical 300 watt (max.) PS-25 inside frosted incandescent lamp (by others).
- Dimmable (controls by others).
- Glazed porcelain medium base socket.

Reflectors

- Upper: Ellipsoidal clear specular Alzak® aluminum.
- Lower: Parabolic self-flanged specular Alzak aluminum.
- Twelve optional self-flanged lower reflector colors and finishes available. See Options.

Lens

- Tempered prismatic low brightness C#73 spread distribution lens mounted to upper reflector.

Housing

- Acrylic enameled 100% aluminum.
- Rustproof: Exceeds 1000 hour ASTM 5% salt spray test.
- Cool: Dissipates heat across entire surface area.

- Entire luminaire visible and serviceable from below through removable reflectors.
- Built-in plaster frame. Also see Option -79.

Outlet Box

- Prewired 14GA (NEC) galvanized steel. UL listed. With removable insulated cover.
- 1/2" and 3/4" knockouts.

Installation

- 27" galvanized hanger bars supplied (2).
- Fully adjustable universal galvanized mounting brackets supplied (2). Accepts 3/4" or 1-1/4" fathers channel or 1/2" T.S. conduit.
- Recesses indoor or outdoor in covered ceilings.

UL, C-UL (Canada) Listings

- Wet, damp or dry locations, covered ceilings.
- Through-branch circuit conductors (6 #12 AWG 90°C).

Three Year Limited Warranty

- Complete standard fixture.
- Thermal Protection (Per Current NEC)**
- Thermal protector included which provides automatic cut-off if rated temperature is exceeded. (Insulation related)



THESE FIXTURES ARE NO LONGER AVAILABLE FOR CONSULTANTS

Performance at a Glance

RR20613

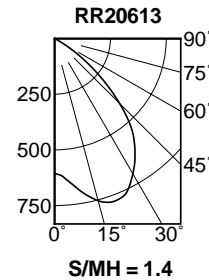
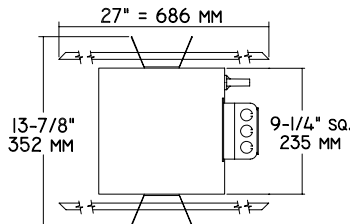
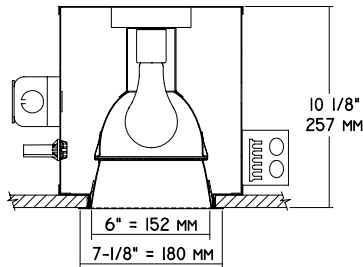

Cone of Light*

Ft.	FC	Dia.
6	16.8	9.1
8	9.5	12.1
10	6.1	15.1
12	4.2	18.1
14	3.1	21.1
16	2.4	24.2

Cone of Light Key
Ft. Distance from fixture
FC Footcandles (average)
Dia. Circle of light at 50% of FC

RR20714

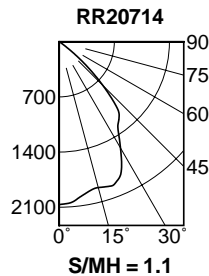
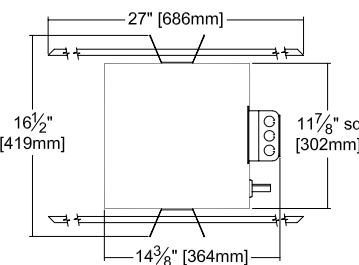
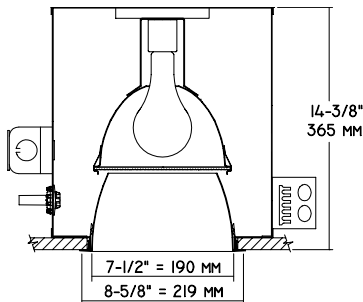

Cone of Light*

Ft.	FC	Dia.
6	57.4	6.8
8	32.3	9.1
10	20.7	11.4
12	14.3	13.7
14	10.5	16.0
16	8.1	18.3

* Dia. (in ft.) shown is where FC value is half the FC at nadir.

THE KIRLIN COMPANY

3401 EAST JEFFERSON AVENUE • DETROIT, MICHIGAN 48207-4232
 (313) 259-6400 • Fax: (313) 259-9409 OR (313) 259-3121

NEW MILLENNIUM

TUNGSTEN HALOGEN and
INCANDESCENT LIGHTING

LAMP

A-21
PS-25

MAXIMUM WATTAGE

150
300

CATALOG NUMBERS

RR20613
RR20714

Detailed Photometry - Installed Fixture

FROM I.T.L. (BOULDER, CO)

RR20613 (150W): TEST NUMBER 47001
RR20714 (300W): TEST NUMBER 47005

RR20613 (100W): TEST NUMBER 47003
RR20714 (200W): TEST NUMBER 47007

LIMITED WARRANTY: CATALOGUED KIRLIN FIXTURES ARE WARRANTED FREE OF DEFECTS IN WORKMANSHIP OR MATERIAL FOR THREE YEARS FROM DATE OF PURCHASE. INSTALLATION, E.C., IS NORMAL USE. Manufacturer at his option will replace or repair such fixture or refund the purchase price on presentation of proof of purchase and defective fixture at the office of manufacturer within the first year of original shipment. Liability of manufacturer is limited to the foregoing, and manufacturer shall not be liable for any other damages, direct or indirect, sustained or suffered by purchaser or any person. This warranty is supplied from the manufacturer and other warranties, expressed or implied, Seller does not warrant as to merchantability or fitness for a particular use, nor warranty of statement constitute a warranty of amended this specific warranty. Abnormal use, abuse of the fixture, improper installation, or repair, or modification of the fixture without prior written authorization from the manufacturer will void this warranty. ©2008

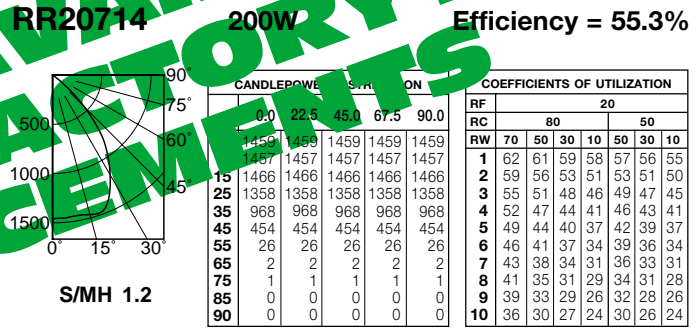
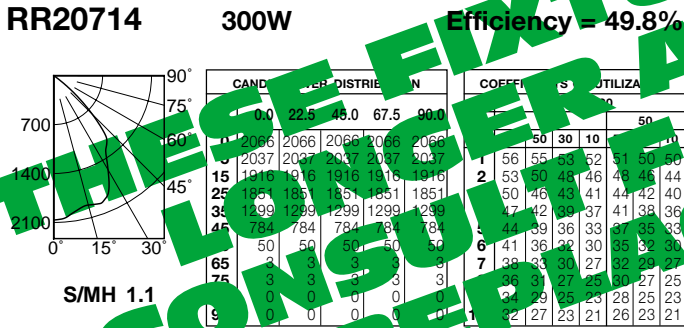
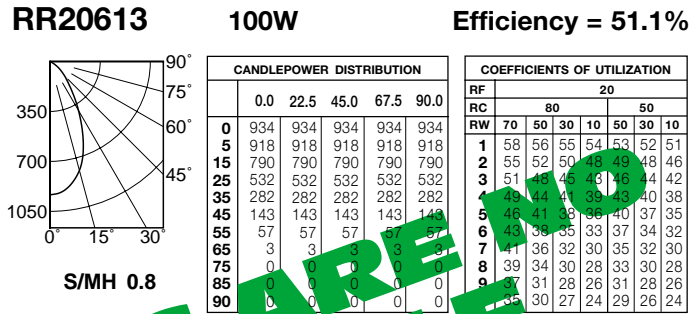
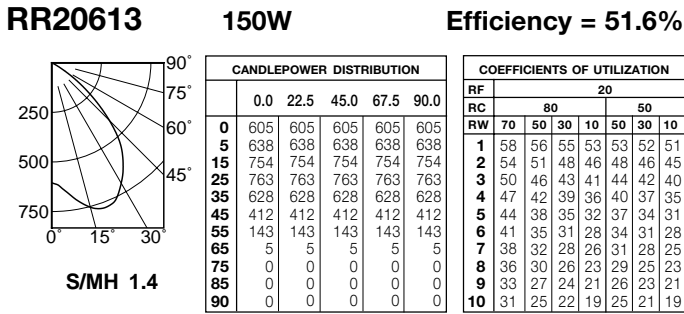

Estimated Multipliers

- 16 Champagne Gold Alzak®: CP x .95
- 30 White: CP x .95
- 63 Dune Alzak: CP x .93
- 69 Wheat Alzak: CP x .92
- 70 SofTex Clear: CP x .92
- 71 SofTex Dune: CP x .89
- 72 Black Alzak: CP x .77
- 90 SofTex Champagne Gold: CP x .90
- 91 SofTex Wheat: CP x .88
- 93 Pewter Alzak: CP x .88
- OG Black OptiGroove: CP x .83

Options

- 16 Champagne Gold specular Alzak self-flanged lower reflector. (CP x .95)
- 30 All white lower reflector, self-flanged. (CP x .95)
- 31 White flange (only) on self-flanged lower reflector.
- 32 Trim extender. Broadens trim flange O.D. by 1" to cover larger ceiling opening.
- 45 Gasket above lower reflector flange. Stops dust streaks on ceiling.
- 58 277/120V stepdown transformer for 277 volt line input, prewired into fixture.
- 63 Dune specular Alzak self-flanged lower reflector. (CP x .93)
- 69 Wheat specular Alzak self-flanged lower reflector. (CP x .92)
- 70 SofTex Clear softly etched self-flanged lower reflector. Resists smudges. (CP x .92)
- 71 SofTex Dune softly etched self-flanged lower reflector. Resists smudges. (CP x .89)
- 72 Black specular Alzak self-flanged lower reflector. (CP x .77)
- 79 Extension collar for up to 2" thick ceilings.
- 82 Sloped ceiling adapter. Specify slope in 5° increments up to 30°.
- 90 SofTex Champagne Gold softly etched self-flanged lower reflector. Resists smudges. (CP x .90)
- 91 SofTex Wheat softly etched self-flanged lower reflector. Resists smudges. (CP x .88)
- 93 Pewter specular Alzak self-flanged lower reflector. (CP x .88)
- 94 Specular or SofTex custom color/finish lower reflector, self-flanged. Consult factory.
- 99 Special modification. Consult factory.
- OG OptiGroove black seamless tapered aluminum lower reflector. White trim, self-flanged. (CP x .83)

SUBMITTAL DATA

APPROVAL STAMP

JOB NAME _____

TYPE _____

WATTAGE _____ VOLTAGE _____

CATALOG NUMBER _____