

CATALOG #	TYPE	
JOB NAME	WATTAGE	VOLTAGE

10" 1 Triple 57 WATT MAXIMUM

RR01093

## Sealed & Gasketed "IP65 Rated" Downlight for Isolation Rooms

Hospitals • Urgent Care • Skilled Nursing

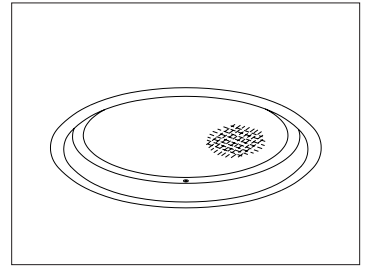

### Specifications

#### Lamp

- Designed for one 4-pin triple tube amalgam or quad compact fluorescent lamp: 57W triple/four tube.

#### Ballast: Multi-Voltage

- Installed electronic high power factor, thermally protected. For lower wattages see Option -43. For dimming see Option -39.
- 120-277 multi-volt; 50-60 Hz. THD <10%.
- ClickQuick connectors for fast servicing.
- Cold weather -22°F (-30°C).
- End of lamp life protection circuit. RFI filter.
- Internally fused. Also see Option -FS.

#### Reflector

- Specular Alzak® aluminum.

#### Trim / Lens Assembly

- Rustproof 100% aluminum grooveless, smooth, self-flanged white trim.

- C#73 tempered prismatic glass spread lens. See Option -GE for green acrylic filter.

#### 5X Sealed and Gasketed

- (1) Silicone seal between trim and lens seals lens to trim, (2) closed cell gasketing between trim and housing flange seals trim to housing, (3) closed cell gasketing on trim flange seals flange to ceiling (4) closed cell gasketing on bottom pan seals housing to ceiling and (5) neoprene O-rings on stainless steel fasteners seal fasteners to trim.

#### Aluminum Housing: Shallow 6" Depth

- Acrylic enameled. Rustproof: Exceeds 1000 hour ASTM 5% salt spray test.
- Lightweight: Minimizes ceiling load.
- Cool operation: Extends component life and reduces air conditioning load.
- Entire luminaire serviced through aperture.
- Built-in plaster frame (housing flange).

#### Outlet Box

- UL listed, prewired 14 GA (NEC) galvanized steel with removable insulated cover.
- 1/2" and 3/4" knockouts.

#### Installation

- 27" galvanized hanger bars with adjustable mounting brackets (2) supplied.
- Recesses indoor or outdoor in covered locations.

#### UL, C-UL (Canada) Listings

- Wet, damp or dry locations, covered ceilings.
- Through-branch conductors (6 #12).

#### Three Year Limited Warranty

- Complete standard fixture and ballast.

### Performance at a Glance

RR01093

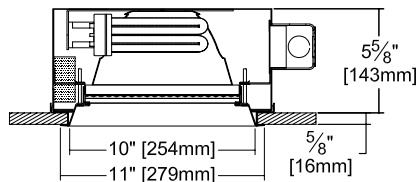

Ceiling Cut-out  
10 1/2" Dia.

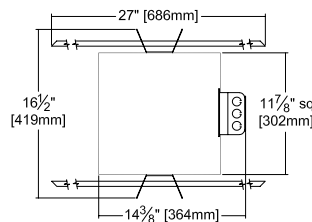

RR01093 (1 Triple 57W)

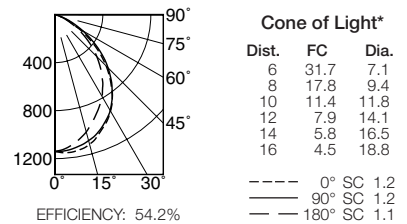

\* Dia. (in ft.) shown is where FC value is half the FC at nadir.

**Cone of Light Key**  
**FT.** Distance from fixture  
**FC** Footcandles at nadir (0°)  
**Dia.** Circle of light at 50% of FC

## THE KIRLIN COMPANY

3401 EAST JEFFERSON AVENUE • DETROIT, MICHIGAN 48207-4232  
 (313) 259-6400 • Fax: (313) 259-9409 OR (313) 259-3121 • www.kirlinlighting.com

PATIENT EXAM &  
HEALTHCARE LIGHTING

MAXIMUM WATTAGE

1 Triple 57

CATALOG NUMBER

RR01093

Detailed Photometry - Installed Fixture

Photometry from I.T.L., Boulder, CO

RR01093 (1 Triple 57)

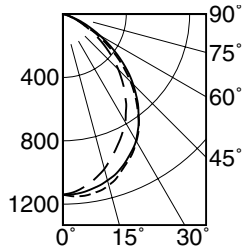

--- 0° SC 1.2  
 — 90° SC 1.2  
 - · - 180° SC 1.1

EFFICIENCY : 54.2%

CANDLEPOWER DISTRIBUTION					
	0.0	45.0	90.0	135.0	180.0
0	1140	1140	1140	1140	1140
5	1154	1150	1136	1120	1116
15	1118	1105	1087	1024	1012
25	1002	1027	988	905	863
35	834	895	836	756	697
45	604	681	627	558	495
55	348	416	386	332	287
65	130	169	166	138	116
75	19	26	29	24	23
85	1	1	1	1	1
90	0	0	0	0	0

COEFFICIENTS OF UTILIZATION							
RF	20						
RC	80				50		
RW	70	50	30	10	50	30	10
1	60	58	56	55	55	53	52
2	56	52	49	47	49	47	45
3	52	47	43	40	44	41	39
4	48	42	38	35	40	37	34
5	44	38	34	31	36	33	30
6	41	35	30	27	33	29	27
7	38	32	27	24	30	27	24
8	36	29	25	22	28	24	22
9	33	27	23	20	26	22	20
10	31	25	21	18	24	20	18

ITL TEST #59137 \*LER=34.4 •AEC=\$6.97

Options

**Ballast, Wattage and Voltage**

- 39 Installed electronic dimming ballast. Not Type IC listed. Indoor use. 10°C (50°F) minimum start. Specify wattage, voltage and brand. Not available with Option -75, -CR or -HR.
- 43 Lower wattage. For 42/32/26W triple or 26W quad (multi-wattage/voltage). Specify wattage.
- 97 Specify other voltage. Consult factory.
- 98 347 volt, 50/60 Hz. input. Consult factory.

**Emergency Ballast - Specify Voltage<sup>1</sup>**

- Remote (field mounted) ballast, test switch and indicator light. Suitable for damp locations from 0° to 50°C (32° to 122°F) or with Cold Weather version (see -CR) -20° to 55°C (-4° to 131°F).
- 75 Remote 1-lamp EM ballast. Specify voltage.
- CR Remote cold weather (-20° to 55°C) 1-lamp EM ballast. Specify voltage.
- HR<sup>1</sup> Remote higher lumen (up to 1250) 1-lamp EM ballast. 13-42W only. Specify voltage.

**Lenses and Trims**

- 94 Custom color/finish. Specify. Consult factory.
- GE Green acrylic filter mounted in lens assembly.
- UV UV filter. Consult factory.

**Other**

- 99 Special modification. Consult factory.
- FS Additional in-line fuse. Not available with Option -98(347V).
- LE With 4-pin electronic lamp. 3500°K standard. 82 CRI and 12,000 hour life. Specify wattage, style and color temperature.

<sup>1</sup> Visit [www.kirlinlighting.com](http://www.kirlinlighting.com) for most current performance/specifications.

SUBMITTAL DATA

JOB NAME  
 TYPE  
 WATTAGE VOLTAGE  
 CATALOG NUMBER

APPROVAL STAMP

LIMITED WARRANTY: CATALOGED KIRLIN FIXTURES ARE WARRANTED FREE OF DEFECTS IN WORKMANSHIP OR MATERIAL FOR THREE YEARS FROM DATE OF PURCHASE. INSTALLED TO N.E.C. IN NORMAL USE. Manufacturer at the option will replace or repair each fixture or refund the purchase price on presentation of proof of purchase and defective fixture at the office of manufacturer within three years of original shipment. Liability of manufacturer shall not be liable for any other damages, direct or indirect, sustained or suffered by purchaser or any person. This warranty is supplied in the box in place of all other warranties, expressed or implied. Seller does not warrant as to merchantability or fitness for a particular use, nor will any oral statement constitute a warranty or amend this specific warranty. Abnormal use, abuse of the fixture, improper installation, or repair, or modification of the fixture without prior written authorization from the manufacturer will render the warranty void.