

CATALOG #	TYPE
JOB NAME	WATTAGE VOLTAGE

10" 1 Triple 42 WATT MAXIMUM

RR01076

Sealed / Gasketed Downlight

Features

Lamp

- Designed for one 4-pin triple tube amalgam or quad compact fluorescent lamp: 42/32/26W triple or 26W quad.

Ballast: Multi-Wattage/Voltage

- Electronic high power factor, thermally protected. For lower wattages: Option -43.
- 120-277 multi-volt; 50/60 Hz.
- ClickQuick connectors for easy service.
- Cold weather -22°F (-30°C).
- End of lamp life protection circuit. RFI filter. THD less than 10%.
- Internally fused. Also see Options -FS.

Reflector

- Specular Alzak® aluminum.

Trim / Lens Assembly

- Smooth white seamless tapered aluminum self-flanged flare trim with 2 stainless steel fasteners with O-rings to seal the fastener to the trim. Die cut and extruded closed cell gasketing (.062") mounted onto trim flange underside.
- 3/16" prismatic polycarbonate lens above 1/4"

clear polycarbonate. Secured to trim with steel trim ring.

- Air tight silicone seal between trim and lens.

Aluminum Housing

- Bottom pan flange with extruded closed cell gasketing to seal trim / lens assembly to housing.
- Acrylic enameled. Rustproof: Exceeds 1000 hour ASTM 5% salt spray test.
- Lightweight: Minimizes ceiling load.
- Cool operation: Extends component life.
- Entire luminaire serviced through aperture.
- Built-in plaster frame.

Outlet Box

- Prewired 14 GA (NEC) galvanized steel, UL listed. 1/2" and 3/4" knockouts.

Installation

- 27" galvanized hanger bars with adjustable mounting brackets (2) supplied.
- Recesses indoor or outdoor in covered locations.

UL, C-UL (Canada) Listings

- Wet, damp or dry locations, covered ceilings.
- Through-branch conductors (6 #12).

Three Year Limited Warranty

- Complete standard fixture and ballast.

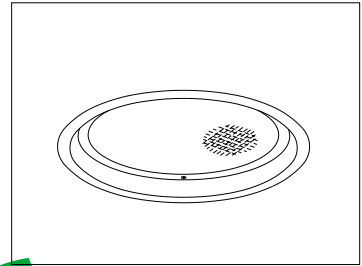

Recessed Round
Regressed Lens
Shallow Plenum
Sealed / Gasketed

Applications

- Hospital Patient Rooms
- Isolation Rooms
- Animal Labs
- Operating Rooms

Performance at a Glance

RR01076

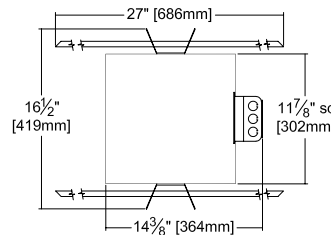
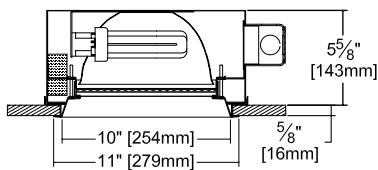

Ceiling Cut-out 10 1/2"

Cone of Light Key

- Ft. Distance from fixture
- FC Footcandles (average)
- Dia. Circle of light at 50% of FC

* Dia. (in ft.) shown is where FC value is half the FC at nadir.

RR01076 (1 Triple 42W)

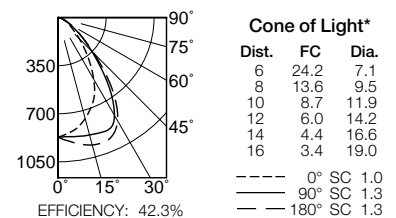

RR01076 (1 Triple 32W)

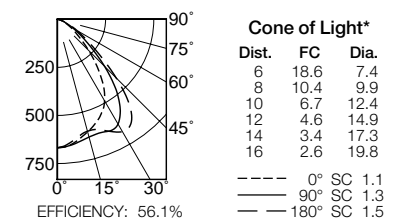

THE KIRLIN COMPANY

3401 EAST JEFFERSON AVENUE • DETROIT, MICHIGAN 48207-4232
(313) 259-6400 • Fax: (313) 259-9409 OR (313) 259-3121 • www.kirlinlighting.com

HEALTHCARE FACILITY & PATIENT LIGHTING

MAXIMUM WATTAGE

1 Triple 42

CATALOG NUMBER

RR01076

DUE TO OUR CONTINUING EFFORT TO IMPROVE PRODUCTS, TECHNICAL INFORMATION IS SUBJECT TO CHANGE WITHOUT NOTICE.

Alzak® is a registered trademark of ALCOA.

RR01076

10" 1 Triple 42 WATT MAXIMUM

KIRLIN

Since 1895

Detailed Photometry - Installed Fixture

Photometry from I.T.L., Boulder, CO

RR01076 (1 Triple 42)

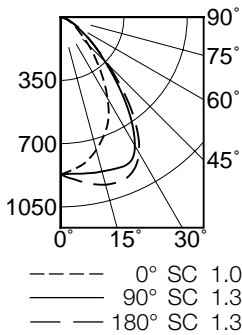

EFFICIENCY : 49.3%

CANDLEPOWER DISTRIBUTION					
	0.0	45.0	90.0	135.0	180.0
0	871	871	871	871	871
5	845	852	870	892	902
15	761	812	884	928	960
25	625	748	892	924	943
35	405	540	673	724	725
45	218	280	347	370	371
55	109	137	154	168	165
65	55	63	66	66	68
75	20	21	21	21	20
85	0	0	0	0	0
90	0	0	0	0	0

COEFFICIENTS OF UTILIZATION								
RF	20							
RC	80							
RW	70	50	30	10	50	30	10	
1	55	53	52	50	50	49	48	
2	51	48	46	44	46	44	42	
3	48	44	41	38	42	39	37	
4	45	40	36	34	38	35	33	
5	42	36	33	30	35	32	30	
6	39	33	30	27	32	29	27	
7	36	31	27	24	30	27	24	
8	34	28	25	22	27	24	22	
9	32	26	23	20	26	22	20	
10	30	25	21	19	24	21	19	

ITL TEST #45268 *LER=29.6 •AEC=\$8.11

RR01076 (1 Triple 32)

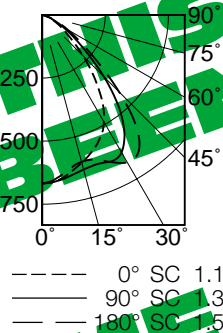

EFFICIENCY : 56.1%

CANDLEPOWER DISTRIBUTION					
	0.0	45.0	90.0	135.0	180.0
0	668	668	668	668	668
5	660	661	661	655	660
15	606	616	634	669	603
25	540	607	641	623	643
35	414	551	568	577	664
45	229	328	346	360	431
55	107	142	151	166	182
65	46	56	57	59	71
75	15	17	17	17	17
85	0	0	0	0	0
90	0	0	0	0	0

COEFFICIENTS OF UTILIZATION								
RF	20							
RC	80							
RW	70	50	30	10	50	30	10	
1	63	61	59	57	57	56	54	
2	58	55	52	49	52	49	47	
3	54	49	45	42	47	44	41	
4	50	44	40	37	42	39	36	
5	46	40	36	33	39	35	32	
6	43	37	32	29	35	32	29	
7	40	34	29	26	32	29	26	
8	38	31	27	24	30	26	24	
9	35	29	24	22	28	24	21	
10	33	26	22	20	26	22	20	

ITL TEST #42088 *LER=29.6 •AEC=\$8.11

Options

Ballast, Wattage and Voltage

- 39 Installed electronic dimming ballast. Indoor use only. 10°C (50°F) minimum start. Please specify wattage and voltage; consult factory to request brand.
- 43 Lower wattage: for 4-pin 18W triple or 18-13W quad. Specify wattage.
- 58 277V 60 Hz. ballast instead.
- 73 Internal emergency 1 lamp battery pack with test switch and indicator light in reflector. Damp location. Ambient temp. limits: 0° to

50°C (32° to 122°F)). Specify voltage. Also see Option -CE.

- 97 Specify other voltage. Consult factory.
- 98 347 volt, 50/60 Hz. input. Consult factory.
- CE Cold weather internal emergency battery pack with test switch and indicator light in reflector. Damp location. Ambient temp. limits: -20° to 55°C (-4° to 131°F). Specify voltage.

Lenses and Trims

- 94 Custom color/finish. Specify. Consult factory.
- CF High temperature color filter. Specify color.
- UV UV filter. Consult factory.

Other

- 99 Special modification. Consult factory.
- FS Additional in-line fuse.
- LE With 4-pin electronic lamp. 3500°K standard. 82 CRI and 12,000 hour life. Specify wattage, style and color temperature.

SUBMITTAL DATA

APPROVAL STAMP

JOB NAME

TYPE

WATTAGE

VOLTAGE

CATALOG NUMBER

* LER = Luminaire Efficiency Rating
LER = Luminaire Effic. x Total Lamp Lumens x Ballast Factor
Input Watts

* AEC = Annual Energy Cost per
1000 lumens (based on 3000
hours use @ \$0.08 KWH).

LIMITED WARRANTY: CATALOGED KIRLIN FIXTURES ARE WARRANTED FREE OF DEFECTS IN WORKMANSHIP OR MATERIAL FOR THREE YEARS FROM DATE OF PURCHASE. INSTALLATION TO N.E.C. IN NORMAL USE. Manufacturer at this option will replace or repair such fixture or refund the purchase price on presentation of proof of purchase and defective fixture at the offices of manufacturer within three years of original shipment. Liability of manufacturer is limited to the foregoing, and manufacturer shall not be liable for any other damages, direct or indirect, sustained or suffered by purchaser or any person. This warranty is supplied to the buyer in place of all other warranties, expressed or implied. Seller does not warrant as to merchantability or fitness for a particular use, nor will any oral statement constitute a warranty or amendment to this specific warranty. Abnormal use, abuse of the fixture, improper installation, or repair, or modification of the fixture without prior written authorization from the manufacturer will void the warranty void.

HEALTHCARE
AUGUST 2006