

CATALOG #	TYPE	
JOB NAME	WATTAGE	VOLTAGE

8" 1 Triple 42 WATT MAXIMUM

RR00891

Sealed & Gasketed Type IC "IP65 Rated" Downlight for Patient Rooms

Hospitals • Urgent Care • Skilled Nursing

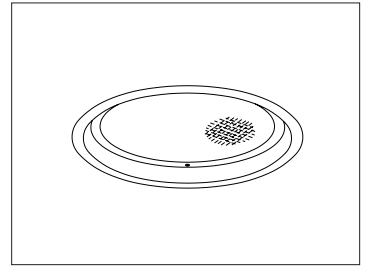

Specifications

Lamp

- Designed for one 4-pin triple tube amalgam or quad compact fluorescent lamp: 42/32/26W triple or 26W quad.

Ballast: Multi-Wattage/Voltage

- Installed electronic high power factor, thermally protected. For lower wattages see Option -43. For dimming see Option -39.
- 120-277 multi-volt; 50-60 Hz. THD <10%.
- ClickQuick connectors for fast servicing.
- Cold weather -22°F (-30°C).
- End of lamp life protection circuit. RFI filter.
- Internally fused. Also see Option -FS.

Reflector

- Specular Alzak® aluminum.

Trim / Lens Assembly

- Rustproof 100% aluminum grooveless, smooth, self-flanged white trim.

- C#73 tempered prismatic glass spread lens. See Option -GE for green acrylic filter.

5X Sealed and Gasketed

- (1) Silicone seal between trim and lens seals lens to trim, (2) closed cell gasketing between trim and housing flange seals trim to housing, (3) closed cell gasketing on trim flange seals flange to ceiling (4) closed cell gasketing on bottom pan seals housing to ceiling and (5) neoprene O-rings on stainless steel fasteners seal fasteners to trim.

Aluminum Housing: Shallow 6" Depth

- Acrylic enameled. Rustproof: Exceeds 1000 hour ASTM 5% salt spray test.
- Lightweight: Minimizes ceiling load.
- Cool operation: Extends component life and reduces air conditioning load.
- Entire luminaire serviced through aperture.
- Built-in plaster frame (housing flange).

Outlet Box

- UL listed, prewired 14 GA (NEC) galvanized steel with removable insulated cover.
- 1/2" and 3/4" knockouts.

Installation

- 27" galvanized hanger bars with adjustable mounting brackets (2) supplied.
- Recesses indoor or outdoor in covered locations. Type IC.

UL, C-UL (Canada) Listings

- Wet, damp or dry locations, covered ceilings.
- Through-branch conductors (6 #12).
- Type IC. Approved for direct contact with insulation.

Three Year Limited Warranty

- Complete standard fixture and ballast.

Performance at a Glance

RR00891: Type IC

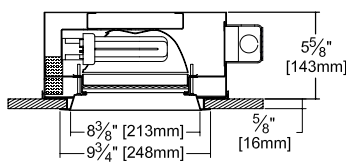

Ceiling Cut-out
9" Dia.

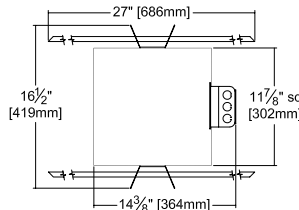

Cone of Light Key
Ft. Distance from fixture
FC Footcandles at nadir (0°)
Dia. Circle of light at 50% of FC

* Dia. (in ft.) shown is where FC value is half the FC at nadir.

RR00891 (1 Triple 42W)

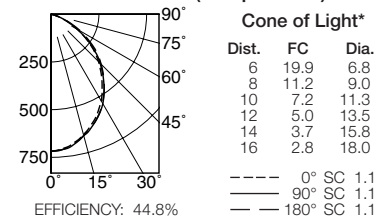

RR00891 (1 Triple 32W)

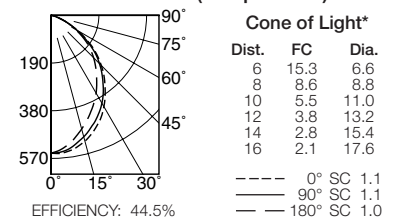

THE KIRLIN COMPANY

3401 EAST JEFFERSON AVENUE • DETROIT, MICHIGAN 48207-4232
(313) 259-6400 • Fax: (313) 259-9409 OR (313) 259-3121 • www.kirlinlighting.com

PATIENT EXAM &
HEALTHCARE LIGHTING

MAXIMUM WATTAGE

1 Triple 42

CATALOG NUMBER

RR00891

DUE TO OUR CONTINUING EFFORT TO IMPROVE PRODUCTS, TECHNICAL INFORMATION IS SUBJECT TO CHANGE WITHOUT NOTICE.

Alzak® is a registered trademark of ALCOA.

Detailed Photometry - Installed Fixture

Photometry from I.T.L., Boulder, CO

RR00891 (1 Triple 42)

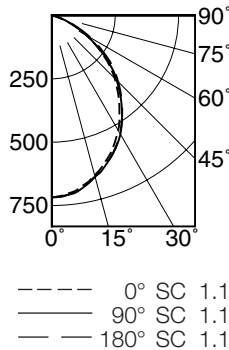

EFFICIENCY : 44.8%

CANDLEPOWER DISTRIBUTION					
	0.0	45.0	90.0	135.0	180.0
0	718	718	718	718	718
5	706	708	711	711	711
15	653	659	659	659	658
25	573	593	587	582	585
35	465	480	484	475	483
45	351	363	362	358	370
55	224	230	225	228	243
65	99	103	101	103	113
75	16	19	20	20	21
85	0	0	0	0	0
90	0	0	0	0	0

COEFFICIENTS OF UTILIZATION								
RF	20							
	80				50			
RC	RW	70	50	30	10	50	30	10
1		50	48	47	45	45	44	43
2	46	43	40	38	41	39	37	
3	42	38	35	33	36	34	32	
4	39	35	31	28	33	30	28	
5	36	31	28	25	30	27	25	
6	34	28	25	22	27	24	22	
7	31	26	22	20	25	22	20	
8	29	24	20	18	23	20	18	
9	27	22	18	16	21	18	16	
10	26	20	17	15	20	17	15	

ITL TEST #59142 *LER=28.9 •AEC=\$8.31

RR00891 (1 Triple 32)

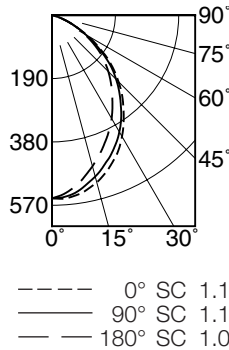

EFFICIENCY : 44.5%

CANDLEPOWER DISTRIBUTION					
	0.0	45.0	90.0	135.0	180.0
0	549	549	549	549	549
5	550	550	544	536	532
15	519	518	501	480	469
25	460	460	440	407	396
35	375	381	362	324	316
45	282	287	272	238	239
55	176	180	169	148	156
65	75	78	74	67	74
75	11	14	14	15	15
85	0	0	0	0	0
90	0	0	0	0	0

COEFFICIENTS OF UTILIZATION								
RF	20							
	80				50			
RC	RW	70	50	30	10	50	30	10
1		49	48	46	45	45	44	43
2	46	43	40	38	40	38	37	
3	42	38	35	33	36	34	32	
4	39	34	31	28	33	30	28	
5	36	31	28	25	30	27	25	
6	34	28	25	22	27	24	22	
7	31	26	22	20	25	22	20	
8	29	24	20	18	23	20	18	
9	27	22	18	16	21	18	16	
10	26	20	17	15	20	17	15	

ITL TEST #59141 *LER=26.9 •AEC=\$8.91

* LER = Luminaires Efficiency Rating
LER = Luminaire Effic. x Total Lamp Lumens x Ballast Factor
Input Watts

• AEC = Annual Energy Cost per 1000 lumens
(based on 3000 hours use @ \$0.08 kWh).

Options

- Ballast, Wattage and Voltage**
- 39 Installed electronic dimming ballast. Not Type IC listed. Indoor use. 10°C (50°F) minimum start. Specify wattage, voltage and brand.
 - 43 Lower wattage: for 4-pin 18W triple or 18-13W quad. Specify wattage.
 - 97 Specify other voltage. Consult factory.
 - 98 347 volt, 50/60 Hz. input. Consult factory.

- Emergency Ballast - Specify Voltage¹**
- Internal (factory installed) ballast, test switch and indicator light. Suitable for damp locations from 0° to 50°C (32° to 122°F) or with Cold Weather version (see -CE) -20° to 55°C (-4° to 131°F).
 - 73 Internal EM ballast. Specify voltage.
 - CE Internal cold weather (-20° to 55°C) EM ballast. Specify voltage.
 - HE¹ Internal higher lumen (up to 1250) EM ballast. 13-32W only. Specify voltage.

- Lenses and Trims**
- 94 Custom color/finish. Specify. Consult factory.
 - GE Green acrylic filter mounted in lens assembly.
 - UV UV filter. Consult factory.
- Other**
- 99 Special modification. Consult factory.
 - FS Additional in-line fuse. Not available with Option -98(347V).
 - LE With 4-pin electronic lamp. 3500°K standard. 82 CRI and 12,000 hour life. Specify wattage, style and color temperature.

¹ Visit www.kirlinlighting.com for most current performance/specifications.

SUBMITTAL DATA

APPROVAL STAMP

JOB NAME _____
TYPE _____
WATTAGE _____ VOLTAGE _____
CATALOG NUMBER _____

LIMITED WARRANTY: CATALOGED KIRLIN FIXTURES ARE WARRANTED FREE OF DEFECTS IN WORKMANSHIP OR MATERIAL FOR THREE YEARS FROM DATE OF PURCHASE. INSTALLED TO N.E.C. IN NORMAL USE. Manufacturer at the option will replace or repair each fixture or refund the purchase price on presentation of proof of purchase and defective fixture at the office of manufacturer within three years of original shipment. Liability of manufacturer is limited to the foregoing, and manufacturer shall not be liable for any other damages, direct or indirect, sustained or suffered by purchaser or any person. This warranty is supplied in place of all other warranties, expressed or implied. Seller does not warrant as to merchantability or fitness for a particular use, nor will any oral statement constitute a warranty or amend this specific warranty. Abnormal use, abuse of the fixture, improper installation, or repair, or modification of the fixture without prior written authorization from the manufacturer will render the warranty void.