

CATALOG #	TYPE	
JOB NAME	WATTAGE	VOLTAGE

7" 1 Triple 42 WATT MAXIMUM

RR00762

Medical / Surgical Patient Rooms: Recessed Round Reading Light

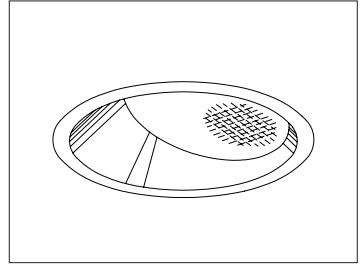

Features

Lamp

- Designed for one 4-pin triple tube amalgam or quad compact fluorescent lamp: 42/32/26W triple or 26W quad.

Ballast: Multi-Wattage/Voltage

- Installed electronic high power factor, thermally protected. For lower wattages see Option -43. For dimming see Option -39.
- 120-277 multi-volt; 50-60 Hz. THD <10%.
- ClickQuick connectors for fast servicing.
- Cold weather -22°F (-30°C).
- End of lamp life protection circuit. RFI filter.
- Internally fused. Also see Option -FS.

Trim Assembly

- Forward throw Alzak trim.
- Acrylic linear lens.

Aluminum Housing

- Acrylic enameled. Rustproof: Exceeds 1000 hour ASTM 5% salt spray test.

- Lightweight: Minimizes ceiling load.
- Cool operation: Extends component life.
- Entire luminaire serviced through trim.
- Built-in plaster frame.

Outlet Box

- UL listed, prewired 14 GA (NEC) galvanized steel with removable insulated cover.
- 1/2" and 3/4" knockouts.

Installation

- 27" galvanized hanger bars with adjustable mounting brackets (2) supplied.
- Recesses in any ceiling type.

UL, C-UL (Canada) Listings

- Wet, damp or dry locations, covered ceilings.
- Through-branch circuit conductors (up to 6 #12). Supply wire rating: 90°C.

Three Year Limited Warranty

- Complete standard fixture and ballast.

Recessed Round
Lensed
Wall Wash
"Reading Light"

Performance at a Glance

RR00762

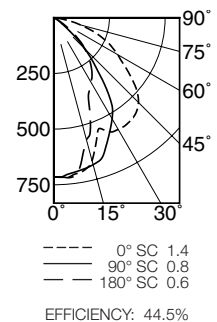
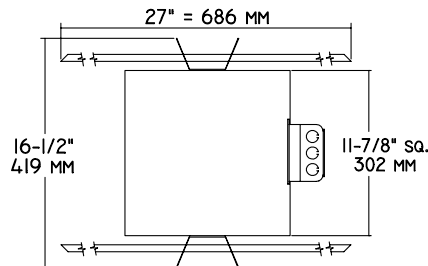
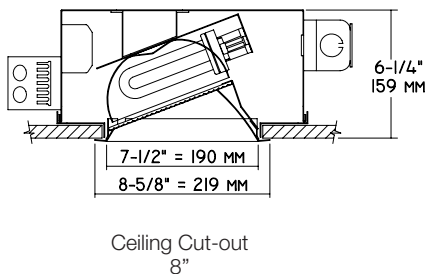

THE KIRLIN COMPANY

3401 EAST JEFFERSON AVENUE • DETROIT, MICHIGAN 48207-4232
(313) 259-6400 • Fax: (313) 259-9409 OR (313) 259-3121 • www.kirlinlighting.com

HEALTHCARE FACILITY
& PATIENT LIGHTING

MAXIMUM WATTAGE

1 Triple 42

CATALOG NUMBER

RR00762

DUE TO OUR CONTINUING EFFORT TO IMPROVE PRODUCTS, TECHNICAL INFORMATION IS SUBJECT TO CHANGE WITHOUT NOTICE.

Alzak® is a registered trademark of ALCOA.

Detailed Photometry - Installed Fixture

Photometry from I.T.L., Boulder, CO

RR00762 (1 Triple 42)

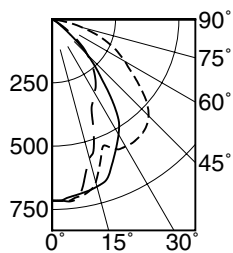

EFFICIENCY : 38.7%

CANDLEPOWER DISTRIBUTION					
	0.0	45.0	90.0	135.0	180.0
0	715	715	715	715	715
5	719	714	706	719	721
15	665	661	683	608	569
25	560	452	585	497	372
35	579	375	439	360	299
45	538	423	197	248	196
55	398	325	39	111	71
65	273	167	13	21	2
75	123	52	6	0	0
85	0	0	0	0	0
90	0	0	0	0	0

COEFFICIENTS OF UTILIZATION							
RF	20						
	80				50		
	RW	70	50	30	10	50	30
1	43	42	40	39	39	38	37
2	40	37	35	33	35	33	32
3	37	33	31	29	32	30	28
4	34	30	27	25	29	26	24
5	32	27	24	22	26	24	22
6	29	25	22	20	24	21	19
7	27	23	20	18	22	19	17
8	26	21	18	16	20	18	16
9	24	19	17	15	19	16	14
10	23	18	15	13	17	15	13

ITL TEST #50260

DISTANCE FROM CEILING IN FEET	SINGLE FIXTURE					MULTIPLE FIXTURES				
	1'	2'	3'	4'		3' CENTERS	4' CENTERS			
1	9.9	6.0	3.4	2.0	1.4	11.4	11.7	11.8	11.0	8.0
2	19.9	15.8	6.9	2.8	1.9	25.8	25.3	24.9	22.6	17.5
3	26.6	22.8	12.9	5.7	2.6	32.7	35.7	33.5	30.1	26.0
4	25.1	23.1	15.4	8.5	3.8	32.2	37.2	34.0	29.1	29.5
5	18.4	17.7	13.6	8.9	5.0	26.5	30.7	28.3	23.4	26.7
6	13.7	13.2	11.4	8.4	5.3	20.9	24.0	22.5	18.8	21.7
7	10.3	9.9	8.8	7.3	5.1	16.4	18.8	18.1	15.2	17.4
8	7.9	7.6	6.9	5.9	4.7	13.4	14.7	14.5	12.4	13.8
9	6.3	6.1	5.6	4.9	4.1	11.1	11.9	11.8	10.4	11.2

Patient Room Lighting Requirements are Surpassed by Kirlin

 Recommended Standards for Patient Room
 Lighting by IESNA "Lighting for Hospital and
 Healthcare Facilities":

Reading Light 20-50 fc on Task

 Reading Light
 fc on Task (1' x 2' area)
 (2 luminaires/bed)

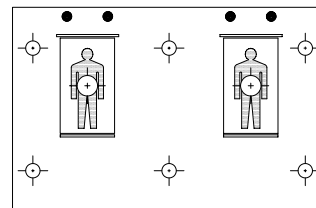
 RR00762 20 fc
 1-42W Triple tube

15' x 23' x 9'H room size represented

Options

Ballast, Wattage and Voltage

- 39 Installed electronic dimming ballast. Not Type IC listed. Indoor use. 10°C (50°F) minimum start. Specify wattage, voltage and brand.
- 43 Lower wattage: for 4-pin 18W triple or 18-13W quad. Specify wattage.
- 97 Specify other voltage. Consult factory.
- 98 347 volt, 50/60 Hz. input. Consult factory.

Emergency Ballast - Specify Voltage¹

- Internal (factory installed) ballast, test switch and indicator light. Suitable for damp locations from 0° to 50°C (32° to 122°F) or with Cold Weather version (see -CE) -20° to 55°C (-4° to 131°F).
- 73 Internal EM ballast. Specify voltage.
- CE Internal cold weather (-20° to 55°C) EM ballast. Specify voltage.
- HE¹ Internal higher lumen (up to 1250) EM ballast. Specify voltage.

Lenses and Trims

- 30 White self-flanged reflector instead.
- 32 Trim extender. Broadens trim flange O.D. by 1".
- 45 Gasket between trim and ceiling.
- 94 Custom color trim / reflector. Consult factory.

Other

- 99 Special modification. Consult factory.
- FS Additional in-line fuse. Not available with Option -98(347V).
- LE With 4-pin electronic lamp. 3500° standard. 82 CRI and 12,000 hour life. Specify wattage, style and color temperature.

¹ Visit www.kirlinlighting.com for most current performance / specifications.

SUBMITTAL DATA

APPROVAL STAMP

JOB NAME

TYPE

WATTAGE

VOLTAGE

CATALOG NUMBER