

CATALOG #	TYPE	
JOB NAME	WATTAGE	VOLTAGE

7" 1 Triple 42 WATT MAXIMUM

RR00760

## Medical / Surgical Patient Rooms: Recessed Round General Illumination

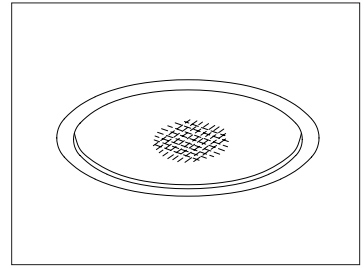

### Features

#### Lamp

- Designed for one 4-pin triple tube amalgam or quad compact fluorescent lamp: 42/32/26W triple or 26W quad.

#### Ballast: Multi-Wattage/Voltage

- Installed electronic high power factor, thermally protected. For lower wattages see Option -43. For dimming see Option -39.
- 120-277 multi-volt; 50-60 Hz. THD <10%.
- ClickQuick connectors for fast servicing.
- Cold weather -22°F (-30°C).
- End of lamp life protection circuit. RFI filter.
- Internally fused. Also see Option -FS.

#### Reflector

- Seamless 100% aluminum. High efficiency.

#### Trim Assembly

- Flat white aluminum trim.
- Tempered prismatic low brightness, spread distribution C#73 lens.
- Torsion springs retain snug fit to ceiling.
- Optional lenses available.

#### Aluminum Housing

- Acrylic enameled. Rustproof: Exceeds 1000 hour ASTM 5% salt spray test.
- Lightweight: Minimizes ceiling load.
- Cool operation: Extends component life.
- Entire luminaire serviced through trim.
- Built-in plaster frame.

#### Outlet Box

- UL listed, prewired 14 GA (NEC) galvanized steel with removable insulated cover.
- 1/2" and 3/4" knockouts.

#### Installation

- 27" galvanized hanger bars with adjustable mounting brackets (2) supplied.
- Recesses in any ceiling type.

#### UL, C-UL (Canada) Listings

- Wet, damp or dry locations, covered ceilings.
- Through-branch circuit conductors (up to 6 #12). Supply wire rating: 90°C.

#### Three Year Limited Warranty

- Complete standard fixture and ballast.

Recessed Round  
Lensed  
Flat Trim  
Super Shallow

### Performance at a Glance

RR00760

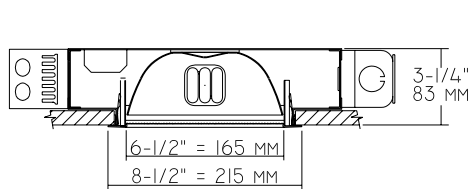

Ceiling Cut-out  
8"

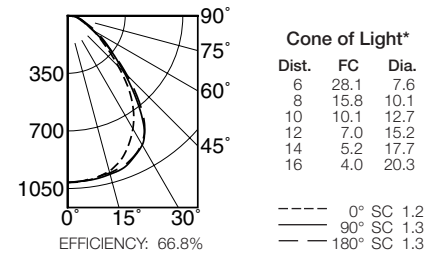
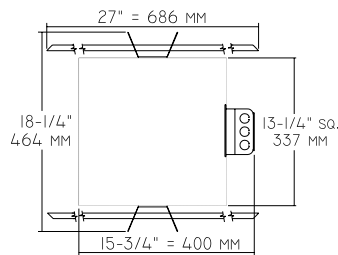

\* Dia. (in ft.) shown is where FC value is half the FC at nadir.

**Cone of Light Key**  
Ft. Distance from fixture  
FC Footcandles at nadir (0°)  
Dia. Circle of light at 50% of FC

## THE KIRLIN COMPANY

3401 EAST JEFFERSON AVENUE • DETROIT, MICHIGAN 48207-4232  
(313) 259-6400 • Fax: (313) 259-9409 OR (313) 259-3121 • www.kirlinlighting.com

HEALTHCARE FACILITY  
& PATIENT LIGHTING

MAXIMUM WATTAGE

1 Triple 42

CATALOG NUMBER

RR00760

DUE TO OUR CONTINUING EFFORT TO IMPROVE PRODUCTS, TECHNICAL INFORMATION IS SUBJECT TO CHANGE WITHOUT NOTICE.

Detailed Photometry - Installed Fixture

Photometry from I.T.L., Boulder, CO

RR00760 (1 Triple 42)

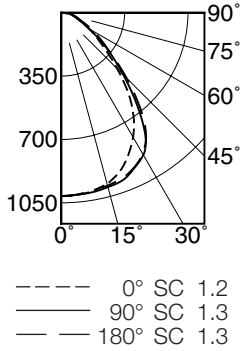

EFFICIENCY : 66.8%

CANDLEPOWER DISTRIBUTION					
	0.0	45.0	90.0	135.0	180.0
0	1013	1013	1013	1013	1013
5	1010	1011	1009	1007	1008
15	978	993	997	994	989
25	872	921	950	932	946
35	696	773	805	800	816
45	437	473	485	491	511
55	241	242	260	259	278
65	123	130	128	138	149
75	71	75	81	83	82
85	22	24	27	28	26
90	0	0	0	0	0

COEFFICIENTS OF UTILIZATION							
RF	20						
	80				50		
RC	70	50	30	10	50	30	10
RW	70	50	30	10	50	30	10
1	45	44	43	42	42	41	40
2	43	41	39	37	39	37	36
3	40	37	35	33	36	34	32
4	38	34	32	30	33	31	29
5	36	32	29	27	31	28	27
6	33	29	27	24	28	26	24
7	32	27	25	23	26	24	22
8	30	25	23	21	25	22	21
9	28	24	21	19	23	21	19
10	27	22	20	18	22	19	18

ITL TEST #52486

Patient Room Lighting Requirements are Surpassed by Kirlin

Recommended Standards for Patient Room Lighting by

IESNA "Lighting for Hospital and Healthcare Facilities": General Illumination 5-10 fc @ Work-plane 30" AFF

**General Illumination**  
Avg. fc at Work-plane @ 30" AFF  
(6 luminaires)

RR00760 30 fc  
1-42W Triple tube

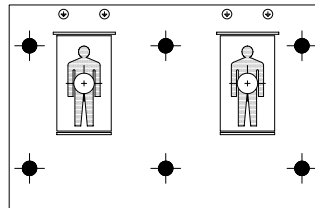

15' x 23' x 9'H room  
size represented.

Options

**Ballast, Wattage and Voltage**

- 39 Installed electronic dimming ballast. Indoor use. 10°C (50°F) minimum start. Specify wattage, voltage and brand. Not available with Option -75, -CR or -HR.
- 43 Lower wattage: for 4-pin 18W triple or 18-13W quad. Specify wattage.
- 97 Specify other voltage. Consult factory.
- 98 347 volt, 50/60 Hz. input. Consult factory.

**Emergency Ballast - Specify Voltage<sup>1</sup>**

Remote (field mounted) ballast, test switch and indicator light. Suitable for damp locations from 0° to 50°C (32° to 122°F) or with Cold Weather

- version (see -CR) -20° to 55°C (-4° to 131°F).
- 75 Remote 1-lamp EM ballast. Specify voltage. 13-42W only.
- CR Remote cold weather (-20° to 55°C) 1-lamp EM ballast. Specify voltage. 13-42W only.
- HR<sup>1</sup> Remote higher lumen (up to 1250) 1-lamp EM ballast. Specify voltage.

**Lenses and Trims**

- 13 Vandal resistant tempered prismatic C#73 spread lens above 1/8" flat polycarbonate.
- 17 .187" prismatic flat high strength acrylic.
- 18 Opal flat glass diffuser.
- 20 Louver, aluminum, egg-crate. 1/2" cube. White.
- 21 White flat polycarbonate diffuser.

- 32 White oversize trim ring. Specify O.D.
- 45 Gasket between ceiling and trim flange.
- 46 Gasket between trim and lens.
- 94 Custom color/finish. Specify. Consult factory.
- FR Fresnel tempered glass lens.
- UV UV filter. Consult factory.

**Other**

- 99 Special modification. Consult factory.
- FS Additional in-line fuse. Not available with Option -98(347V).
- LE With 4-pin electronic lamp. 3500°K standard. 82 CRI and 12,000 hour life. Specify wattage, style and color temperature.

<sup>1</sup> Visit [www.kirlinlighting.com](http://www.kirlinlighting.com) for most current performance/specifications.

SUBMITTAL DATA

APPROVAL STAMP

JOB NAME \_\_\_\_\_  
 TYPE \_\_\_\_\_  
 WATTAGE \_\_\_\_\_ VOLTAGE \_\_\_\_\_  
 CATALOG NUMBER \_\_\_\_\_

LIMITED WARRANTY: CATALOGED KIRLIN FIXTURES ARE WARRANTED FREE OF DEFECTS IN WORKMANSHIP OR MATERIAL FOR THREE YEARS FROM DATE OF PURCHASE. INSTALLED TO N.E.C. IN NORMAL USE. Manufacturer at the option will replace or repair each fixture or refund the purchase price on presentation of proof of purchase and defective fixture at the office of manufacturer within three years of original shipment. Liability of manufacturer is limited to the foregoing, and manufacturer shall not be liable for any other damages, direct or indirect, sustained or suffered by purchaser or any person. This warranty is supplied in place of all other warranties, expressed or implied. Seller does not warrant as to merchantability or fitness for a particular use, nor will any oral statement constitute a warranty or amend this specific warranty. Abnormal use, abuse of the fixture, improper installation, or repair, or modification of the fixture without prior written authorization from the manufacturer will render the warranty void.