

Direct Illumination of Patient: Attractive Design

Features

Lamp

- Designed for:
 - 1 vertical 250 watt (max.) frosted tungsten halogen T4Q.
- Double contact bayonet (DCB) base.
- Rated 2000 hour life; 100 CRI.
- 3000°K color temperature and 100 CRI for accurate tissue rendering and patient evaluation.
- Dimmable (controls by others).

Lampholder

- Double contact bayonet. Heat resistant.
- Lamp socket bracket designed as heat sink.

Reflectors

- Upper: Specular Alzak® aluminum for precise control of source.
- Lower: Low brightness clear SofTex clear softly etched Alzak aluminum cone, self-flanged. Resists fingerprints, smudges, dust.
- Optional self-flanged cone colors and finishes available. See Options.
- Convection and radiation cooling by design.

Lens

- Tempered MicroLux microprismatic.
- Optional clear tempered lens available.
- Mounted to upper reflector.

Housing

- Cool, acrylic enameled aluminum.
- Dissipates heat across entire surface area. Ventilated for convection cooling.
- Rustproof: Exceeds 1000 hour ASTM 5% salt spray test.
- Entire luminaire visible and serviceable from below through removable lower cone.
- Top access optional. See Option -TA.
- Built-in plaster frame. Also see Option -79.

Outlet Box

- Prewired 14 GA (NEC) galvanized steel, UL listed; with removable insulated cover.
- 1/2" and 3/4" knockouts.

Installation

- 27" galvanized hanger bars with adjustable mounting brackets supplied.
- Lightweight. Recesses in any ceiling type.

UL, C-UL (Canada) Listings

- Wet, damp or dry locations, covered ceilings.
- Through-branch circuit conductors (6 #12). Supply wire rating: 90°C.

Three Year Limited Warranty

- Complete standard fixture.

Thermal Protection

- Per current NEC.

Recessed Round
Lensed
Dual Reflector
Downlight

Performance at a Glance

RR00715

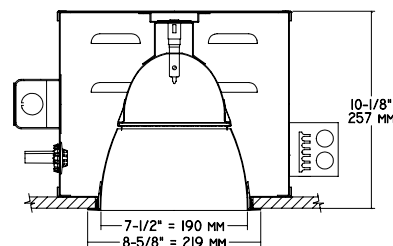

Ceiling Cut-out
8"

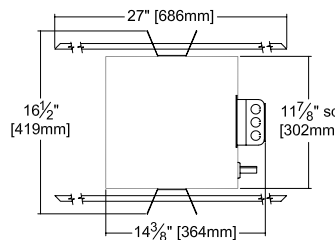

KIRLIN RECOMMENDS T4 HALOGEN LAMPS BY USHIO, GE OR SYLVANIA ONLY

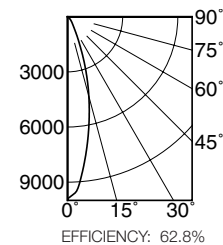

Cone of Light*

Dist.	FC	Dia.
6	275.0	2.6
8	154.7	3.5
10	99.0	4.4
12	68.8	5.3
14	50.5	6.2
16	38.7	7.1

SC 0.5

Cone of Light Key

- Ft. Distance from fixture
- FC Footcandles at nadir (0°)
- Dia. Circle of light at 50% of FC

* Dia. (in ft.) shown is where FC value is half the FC at nadir.

THE KIRLIN COMPANY

3401 EAST JEFFERSON AVENUE • DETROIT, MICHIGAN 48207-4232
(313) 259-6400 • Fax: (313) 259-9409 OR (313) 259-3121 • www.kirlinlighting.com

HEALTHCARE FACILITY
& PATIENT LIGHTING

MAXIMUM WATTAGE

1 T4Q 250

CATALOG NUMBER

RR00715

DUE TO OUR CONTINUING EFFORT TO IMPROVE PRODUCTS, TECHNICAL INFORMATION IS SUBJECT TO CHANGE WITHOUT NOTICE.

Alzak® is a registered trademark of ALCOA.

Footcandle Distribution Data

Photometry from I.T.L., Boulder, CO

- Notes:
- 1. All lighting levels are expressed in average footcandles, with distances expressed in feet, as measured at the work plane (3'6").
 - 2. The work plane (3'6") is defined as: examination bed height, plus patient body depth.
 - 3. Fixture is centered over examination bed with its longest axis parallel to the length of the bed.

Ceiling Height: 8' • Work Plane: 3'6"

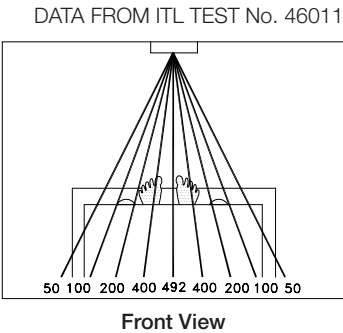
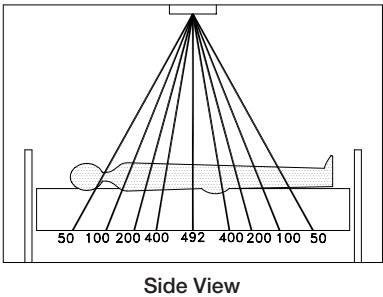
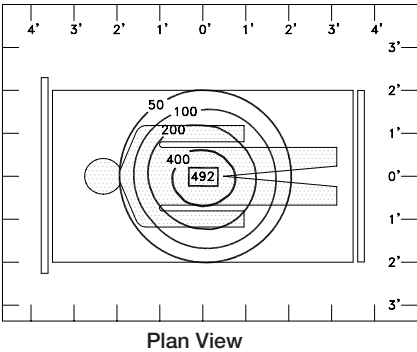

Ceiling Height: 8'6" • Work Plane: 3'6"

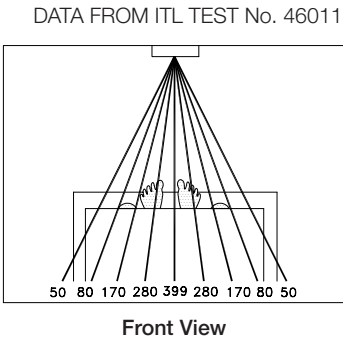
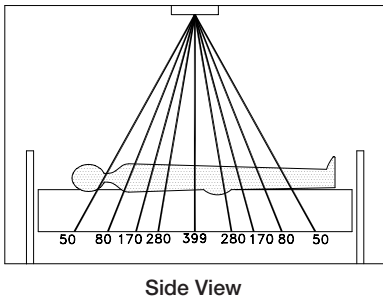
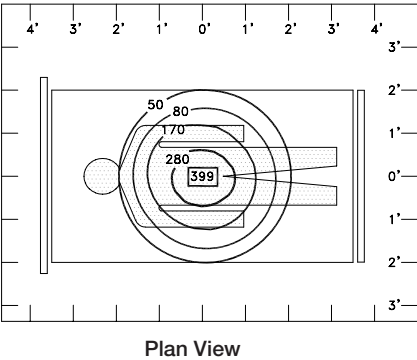

Options

- 28 Tempered clear glass lens instead. (0.2 SC)
- 30 All white self-flanged lower cone.
- 31 White flange (only) on self-flanged lower cone.
- 32 Trim extender. Broadens trim flange by 1" to cover larger ceiling opening.
- 45 Gasket above reflector flange. (Minimizes dust streaks on ceiling.)
- 58 277/120 volt stepdown transformer for 277 volt line input, prewired into each fixture; with 277 volt thermal protector.
- 62 Clear specular Alzak® self-flanged lower cone.
- 79 Extension collar for up to 2" thick ceiling.
- 94 SoftTex or specular custom color self-flanged lower cone. Consult factory.
- 97 For other input supply voltages, consult factory.
- 99 Special modification. Consult factory.
- LP With DCB 250 watt T4Q frosted lamp.
- TA Top access. For servicing from above ceiling.
- TC Teflon coated safety lens; retains glass particles in event of breakage. Consult factory.

SUBMITTAL DATA

APPROVAL STAMP

JOB NAME
TYPE
WATTAGE
VOLTAGE
CATALOG NUMBER