

CATALOG #	TYPE	
JOB NAME	WATTAGE	VOLTAGE

# Lighting for Patient Spaces

## Vandal Resistant Clean Room 7" LED Exam Light

Up to 90,000 Hour Rated Life • Type IC • Antimicrobial Trim  
LM-80 Qualified • LM-79 Certified Photometry

## Specifications

### Delivered System Performance\*

- Lumen Series: **Must Specify**
  - 2000L (25W)
  - 1500L (15W)
- Distribution: NFL standard; optional: -MFL
- Color temperature: 3500°K standard; optional: -27K, -30K or -41K
- CRI: 80+ standard; optional: -HC (90+)
- 90,000 Hour Rated Life (L70\*\*)
- Fully sustainable: removable for servicing

### Thermal Management System

- Aluminum heat sink and components for cool operation, long life, and low maintenance

### LED Driver - INTERNAL

- Indoor/Outdoor: -30°C to 60°C (-22°F to 140°F)
- 0-10V CCR dimming standard (100-10%)
- Voltage Options: **Must Specify**
  - 120: -120V (50-60Hz); load insensitive
  - 277: -277V (50-60Hz); load insensitive
- Optional remote SmartSupply™ driver instead, see Option -SS for restrictions and details

### Trim and Lens Assembly

- Vandal resistant smooth white seamless tapered aluminum self-flanged flare trim

- Kirlin BioGard™ antimicrobial white finish continuously inhibits growth of bacteria on the coating of the trim
- Flush center pin tamperproof hex screws and captive nuts secure trim to housing
- Regressed tempered microprismatic above 1/8" clear flat polycarbonate lens
- Continuous ring secures lens to trim
- Tamperproof tool included

### IP65 Sealed & Gasketed Trim

- Liquid silicone seals between trim and lens
- O-rings seal stainless fasteners to trim
- Meets ASTM E283 restricted airflow of 2CFM

### Acrylic Enameled Aluminum Housing

- Rustproof: exceeds 1000 hour ASTM 5% salt spray test; all components fully sustainable
- Shallow depth for restricted plenums
- Cool operation extends component life
- Modular design; visible and fully serviceable through aperture
- Built-in plaster flange
- Air tight housing and junction box; meets/exceeds ASTM E283 restricted airflow (2 CFM maximum); CCEA approved

## MRV-07560



### Outlet Box (Galvanized)

- UL listed J-box with insulated removable cover; prewired 14 GA (NEC) with 1/2" and 3/4" knockouts

### Installation & Hardware

- Indoor/outdoor in ceilings up to 1 1/8" thick
- Compatible with fire rated enclosures (by others)
- 27" galvanized hanger bars & adjusting brackets (2) supplied

### UL, C-UL (Canada) Listings

- Wet, damp or dry locations, covered ceilings
- Type IC: for direct contact with insulation
- Through-branch conductors (4 #12 AWG 90°C)

### IEC & FCC Compliance

- Meets IEC/EN 60601-1-2 electromagnetic compatibility standard for medical electrical equipment
- FCC Part 15 certified for EMI/RFI emissions

### FIVE YEAR Limited Warranty

- Complete standard fixture

## Options and Ordering Configuration

(Example: MRV-07560-2000L-120-30K-MFL)



Must Specify			Optional					
Model	Lumens	Volts	CCT & CRI	Beam	Driver Options	Emergency	Trim & Lens Options	Other Options
MRV-07560								
	-2000L -1500L	-120 -277  -97: Other voltage; consult factory	(Blank): 35K, 80+ CRI  <b>80+ CRI</b> -27K: 2700°K -30K: 3000°K -35K: 3500°K -41K: 4000°K -50K: 5000°K <b>90+ CRI</b> -27K-HC: 2700°K -30K-HC: 3000°K -35K-HC: 3500°K -41K-HC: 4000°K -50K-HC: 5000°K	(Blank): NFL  -MFL	(Blank): Standard 0-10V CCR 10% dim  -D1: 0-10V 1.0% dim -D2†: 0-10V 0.1% dim -D3†: DALI 1.0% dim -D4†: DALI 100-0.1% dim -D5†: DMX512A 0.1% dim	(Blank): None  -EI: Remote emergency inverter for 50% of rated lumens; 90+ minutes; 60Hz input only; N/A for option -FS  -ERH: Remote emergency battery pack; delivers 1000 lumens; 90+ minutes (CEC Compliant)	(Blank): White tamper-resistant trim, dual lens  <b>Trim Finishes</b> -BKBC: BioGard™ antimicrobial black -94BG: BioGard™ antimicrobial custom color finish	(Blank): None  -99: Special modification; consult factory -AWN: Athena Wireless Node; N/A for Dimming Option D5 -FS: Fused primary; One per fixture; not for use with Option -EI  <b>*Note:</b> For other integrated control solutions, such as nLight, contact factory
*See note next page								
<b>Projected L70** for Kirlin Luminaires</b> In Open Plenum 90,000 hours In Insulation (Type IC) 60,000 hours **Hours at 70% lumen maintenance								
			† Consult factory for use with -2000L lumen series					

## Dimensions

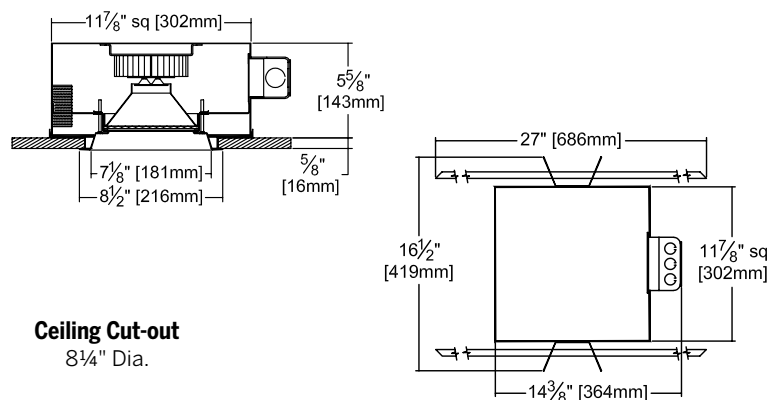

## Infection Control Levels

Level	Option	Patient Safety	Infection Protection
3+	Standard	<b>VR</b> Vandal Resistant	<b>BioGard™</b> <b>IP65</b> <b>ISO 5/ Class 100</b>

## Performance Factors

NOMINAL LUMENS	LUMEN FACTOR	NOMINAL WATTS	LPW FACTOR
-2000L	1.26	1.37	0.92
-1500L	1.00	1.00	1.00

## Footcandle Distribution Data

### Notes:

- All lighting levels are expressed in average footcandles, with distances expressed in feet, as measured at the work plane (3'6")
- The work plane (3'6") is defined as: examination bed height, plus patient body depth

## Photometry - Installed Complete Fixture

Photometry from I.T.L., Boulder, CO

LM-79 IESNA Certified Photometry from Independent Lab

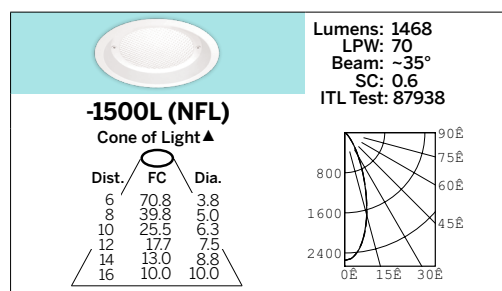

Total System Watts 20.9

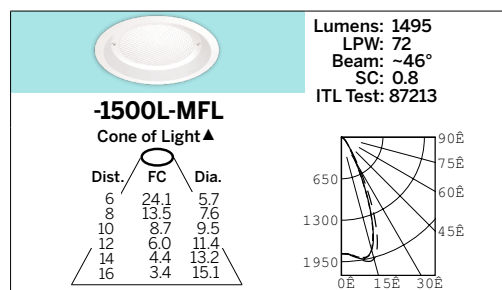
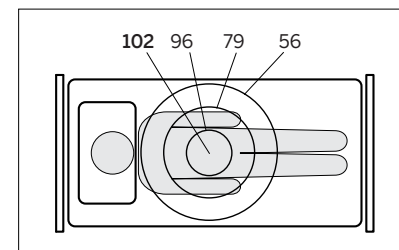
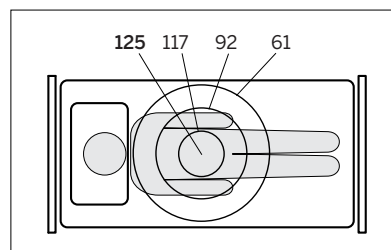

Total System Watts 20.9

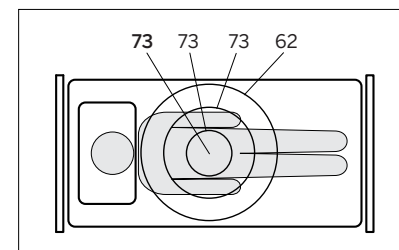
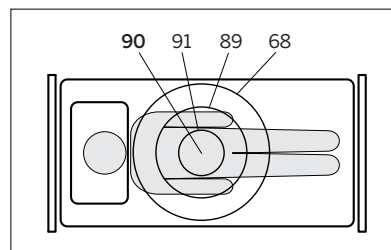

\*LED manufacturers maintain a tolerance of +/-7% on flux (lumens) and power (electrical) measurements.

▲ Cone of Light Key  
Dist. Distance (Ft.) from fixture  
FC Footcandles at nadir (0°)  
Dia. (in ft.) shown is where FC value is half the FC at nadir.  
Dia. Circle of light at 50% of FC

LIMITED WARRANTY: KIRLIN LIGHTING FIXTURES ARE WARRANTED FREE OF DEFECTS IN WORKMANSHIP OR MATERIAL FOR FIVE YEARS FROM DATE OF PURCHASE. INSTALLATION, ETC., IS NOT COVERED. THE WARRANTY IS LIMITED TO THE REPLACEMENT OF THE DEFECTIVE FIXTURE. THE WARRANTY DOES NOT COVER DAMAGE TO THE FIXTURE OR TO THE SURFACE IT IS MOUNTED ON. THE WARRANTY IS VOID IF THE FIXTURE IS NOT INSTALLED OR USED IN ACCORDANCE WITH THE INSTALLATION INSTRUCTIONS. THE WARRANTY IS VOID IF THE FIXTURE IS USED IN A MANNER NOT INTENDED BY THE MANUFACTURER. THE WARRANTY IS VOID IF THE FIXTURE IS USED IN A MANNER THAT MAY BE DANGEROUS TO THE USER OR OTHERS. THE WARRANTY IS VOID IF THE FIXTURE IS USED IN A MANNER THAT MAY BE ILLEGAL. THE WARRANTY IS VOID IF THE FIXTURE IS USED IN A MANNER THAT MAY BE IN VIOLATION OF ANY APPLICABLE LAWS. THE WARRANTY IS VOID IF THE FIXTURE IS USED IN A MANNER THAT MAY BE IN VIOLATION OF ANY APPLICABLE REGULATIONS. THE WARRANTY IS VOID IF THE FIXTURE IS USED IN A MANNER THAT MAY BE IN VIOLATION OF ANY APPLICABLE STANDARDS. THE WARRANTY IS VOID IF THE FIXTURE IS USED IN A MANNER THAT MAY BE IN VIOLATION OF ANY APPLICABLE CODES. THE WARRANTY IS VOID IF THE FIXTURE IS USED IN A MANNER THAT MAY BE IN VIOLATION OF ANY APPLICABLE ORDINANCES. THE WARRANTY IS VOID IF THE FIXTURE IS USED IN A MANNER THAT MAY BE IN VIOLATION OF ANY APPLICABLE DECREES. THE WARRANTY IS VOID IF THE FIXTURE IS USED IN A MANNER THAT MAY BE IN VIOLATION OF ANY APPLICABLE STATUTES. THE WARRANTY IS VOID IF THE FIXTURE IS USED IN A MANNER THAT MAY BE IN VIOLATION OF ANY APPLICABLE ACTS. THE WARRANTY IS VOID IF THE FIXTURE IS USED IN A MANNER THAT MAY BE IN VIOLATION OF ANY APPLICABLE ORDINANCES. THE WARRANTY IS VOID IF THE FIXTURE IS USED IN A MANNER THAT MAY BE IN VIOLATION OF ANY APPLICABLE DECREES. THE WARRANTY IS VOID IF THE FIXTURE IS USED IN A MANNER THAT MAY BE IN VIOLATION OF ANY APPLICABLE STATUTES. THE WARRANTY IS VOID IF THE FIXTURE IS USED IN A MANNER THAT MAY BE IN VIOLATION OF ANY APPLICABLE ACTS.

PATENT SPACES  
NOVEMBER 2024