

CATALOG #	TYPE
JOB NAME	VOLTAGE

MRV-06863-2500L

IP66 Ligature / Vandal Resistant LED Downlight

Wet Location • 6" Aperture

10% Dimming • WFL • 5 CCT • 3-Step Binning

Up to 90,000 Hour Life • LM-80 Qualified • LM-79 Certified



4" Lens Aperture



Specifications

Delivered System Performance*

- Lumen Series: **MUST SPECIFY**
- 2500L: 2500 nominal lumens (35W).
- Distribution: WFL standard. Optional: -NFL or -MFL.
- Color temperature: 3500°K standard. Optional: -27K, -30K, -41K or 50K.
- CRI: 80+ standard. Optional: -HC (90+).
- 90,000 hour life (L70).
- Fully sustainable: removable for servicing.

Thermal Management System

- All aluminum heat sink, components and housing maximize cool operation and long life while minimizing maintenance.

LED Power Supply - INTERNAL

- 0-10V CCR dimming standard. (100-10%)**
- 120-277V / 50-60Hz standard. Load insensitive.
- Suitable for outdoor / indoor use: -30°C (-22°F) to 60°C (140°F).

Trim / Lens Assembly

- Ligature resistant smooth white seamless tapered aluminum self-flanged rigid cast trim.
- Kirlin BioGard™ antimicrobial white finish continuously inhibits growth of bacteria on the coating of the trim.



See Option -SH for **Cleanroom Rated Luminaire**

- Flush center pin tamperproof hex screws and captive nuts secure trim to housing. Tamperproof tool included.
- High strength prismatic acrylic above .220" clear flat polycarbonate lens. Also see -DA.
- Continuous ring secures lens to trim.

IP66 Sealed and Gasketed Trim

- Silicone seal between trim and lens seals lens to trim.
- Closed cell gasketing on trim flange seals flange to ceiling.
- O-rings on stainless steel fasteners seal fasteners to trim.
- Meets ASTM E283 restricted airflow of 2CFM maximum.

Acrylic Enamelled Aluminum Housing

- Rustproof and corrosion resistant: Exceeds 1000 hour ASTM 5% salt spray test.
- Shallow depth fits restricted plenums.
- Cool operation: Extends life of all components.
- Entire luminaire, including LED light engine, is modular, easily visible and serviced through aperture.
- Built-in plaster flange.

Outlet Box

- UL listed J-box with insulated removable cover. Prewired 14 GA (NEC) with 1/2" and 3/4" knockouts.

Installation

- Recesses indoor/outdoor in covered locations.
- Accommodates ceilings up to 1-1/8" thick.
- 27" galvanized hanger bars with adjustable mounting brackets (2) supplied.

UL, C-UL (Canada) Listings

- Wet, damp or dry locations, covered ceilings.
- Through-branch conductors (4 #12 AWG 90°C).

IEC & FCC Compliance

- Meets IEC/EN 60601-1-2 electromagnetic compatibility standard for medical electrical equipment.
- FCC Part 15 certified for EMI/RFI emissions.



FIVE YEAR Limited Warranty

- Complete standard fixture.

MUST SPECIFY		OPTIONAL	Ordering Example: MRV-06863-2500L-120-30K-BN
Product Number	Voltage	Options	
MRV-06863-2500L	-120 (120 volts) -277 (277 volts) -97 (Specify other)	See "Options" below	

Options

Input Power: SPECIFY

- 120 120V (50-60Hz) input.
- 277 277V (50-60Hz) input
- 97 Specify other voltage. Consult factory.

LED Power Supply

- 29 **Two wire** full range (100-1%) PWM dimming instead (Lutron). Consult factory. 120V only.
- 39 **Three wire** full range (100-1%) PWM dimming instead (Lutron). Consult factory.
- D1 0-10V 1.0% dimming instead.
- D2 0-10V 0.1% dimming instead.
- D3 DALI 1.0% dimming instead.
- D4 DALI 0.1% dimming instead.
- D5 DMX512A 0% dimming instead.

- ECO Digital driver for Lutron EcoSystem controls. Dims to 1% or consult factory.
- ERH REMOTE emergency battery pack. Delivers 1000 lumens. Run time: 90+ minutes. CEC Compliant.

Color (CCT and CRI)

- 27K Color temperature 2700°K instead.
- 30K Color temperature 3000°K instead.
- 41K Color temperature 4100°K instead.
- 50K Color temperature 5000°K instead.
- HC 90+ CRI instead. Consult factory.

Optics

- MFL Medium flood distribution instead.
- NFL Narrow flood distribution instead.

Lens and Trim

- 35T Natural aluminum (silver) acrylic enamelled trim. (non BioGard™)

- 94 Custom color/finish. Specify. (non BioGard™) Consult factory.
- BN Brushed nickel cast trim instead. (non BioGard™)
- CF Custom color filter (Rosco). Specify.
- DA Diffuse acrylic lens above poly instead of prismatic acrylic. -WFL only.
- WA White acrylic (flat) diffuser above poly instead of prismatic acrylic; will provide wide flood distribution.

Other

- 99 Special modification. Consult factory.
- FS Single in-line fuse.
- SH Sealed housing and junction box. Provides Cleanroom Rated luminaire. (ISO 5 Class 100)

MRV-06863-2500L

PERFORMANCE



Dimensions

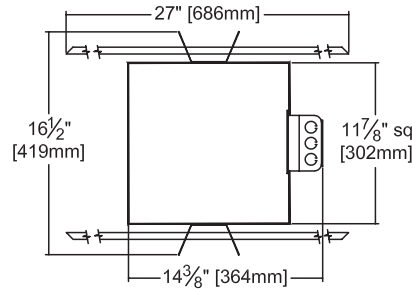
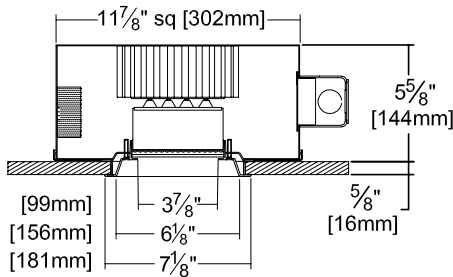

Ceiling Cut-out
6 3/4" Dia.

Detailed Photometry - Installed Fixture

Photometric testing done in accordance with IESNA LM-79

Photometry from I.T.L., Boulder, CO

-2500L STANDARD (WFL)

Lumens: 2590
Beam: ~49°
SC: 0.9
LPW: 78
Efficiency: 69.7%
ITL Test: 90897



Total System Watts 33.3

CANDLEPOWER DISTRIBUTION					
	0.0	22.5	45.0	67.5	90.0
0	2652	2652	2652	2652	2652
5	2801	2804	2807	2814	2806
10	3037	3104	3192	3128	3064
15	1559	1696	1838	1640	1500
20	497	531	563	516	481
25	210	220	222	214	209
30	117	117	118	117	112
35	55	55	54	54	54
40	15	15	15	15	15
45	3	2	2	3	3
90	0	0	0	0	0

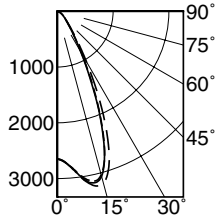

Cone of Light ▲

Dist.	FC	Dia.
6	73.7	5.5
8	41.4	7.3
10	26.5	9.1
12	18.4	11.0
14	13.5	12.8
16	10.4	14.6

-2500L Option -NFL

Lumens: 2517
Beam: ~24°
SC: 0.4
LPW: 76
Efficiency: 67.7%
ITL Test: 90898



Total System Watts 33.2

CANDLEPOWER DISTRIBUTION					
	0.0	22.5	45.0	67.5	90.0
0	8551	8551	8551	8551	8551
5	7571	7571	7571	7571	7571
10	3239	3239	3239	3239	3239
15	974	974	974	974	974
20	338	338	338	338	338
25	163	163	163	163	163
30	95	95	95	95	95
35	48	48	48	48	48
40	14	14	14	14	14
45	2	2	2	2	2
90	0	0	0	0	0

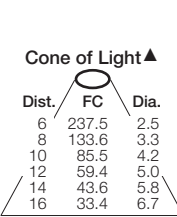

Cone of Light ▲

Dist.	FC	Dia.
6	237.5	2.5
8	133.6	3.3
10	85.5	4.2
12	59.4	5.0
14	43.6	5.8
16	33.4	6.7

-2500L Option -MFL

Lumens: 2264
Beam: ~32°
SC: 0.6
LPW: 68
Efficiency: 60.9%
ITL Test: 90899



Total System Watts 33.3

CANDLEPOWER DISTRIBUTION					
	0.0	22.5	45.0	67.5	90.0
0	4237	4237	4237	4237	4237
5	4017	4017	4017	4017	4017
10	2599	2599	2599	2599	2599
15	1143	1143	1143	1143	1143
20	461	461	461	461	461
25	217	217	217	217	217
30	119	119	119	119	119
35	58	58	58	58	58
40	17	17	17	17	17
45	2	2	2	2	2
90	0	0	0	0	0

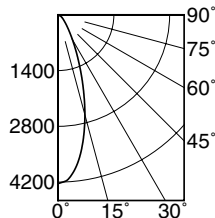

Cone of Light ▲

Dist.	FC	Dia.
6	117.7	3.5
8	66.2	4.7
10	42.4	5.8
12	29.4	7.0
14	21.6	8.1
16	16.6	9.3

LM-80 Qualified • LM-79 Certified Photometry

* LED manufacturers maintain a tolerance of ±7% on flux (lumens) and power (electrical) measurements. Kirlin photometrics are actual test data from Independent Testing Laboratories (ITL) where photometry was measured from 3717 (-2500L) light engines (within the established tolerance).

▲ Cone of Light Key
Dia. (in ft.) shown is where FC value is half the FC at nadir.

Dist. Distance (Ft.) from fixture
FC Footcandles at nadir (0°)
Dia. Circle of light at 50% of FC

SUBMITTAL DATA

JOB NAME _____
TYPE _____ VOLTAGE _____
CATALOG NUMBER _____

APPROVAL STAMP



LIMITED WARRANTY: CATALOGED KIRLIN FIXTURES ARE WARRANTED FREE OF DEFECTS IN WORKMANSHIP OR MATERIAL FOR FIVE YEARS FROM DATE OF PURCHASE. INSTALLED TO N.E.C. IN NORMAL USE. Manufacturer at the option will replace or repair such fixture or refund the purchase price on presentation of proof of purchase and defective fixture at the office of manufacturer within the years of original shipment. Liability of manufacturer is limited to the foregoing, and manufacturer shall not be liable for any other damages, direct or indirect, sustained or suffered by purchaser or any person. This warranty is supplied to the buyer in place of all other warranties, expressed or implied. Seller does not warrant as to merchantability or fitness for a particular use, nor will any oral statement constitute a warranty or amend this specific warranty. Abnormal use, abuse of the fixture, improper installation, or repair or modification of the fixture without prior written authorization from the manufacturer will render the warranty void.