

CATALOG #	TYPE
JOB NAME	WATTAGE VOLTAGE

4" x 9" LED 4800 LUMEN SERIES

70 WATT

MRT-04550

4" x 9" Rectangular Exam Light • LED

Up to 60,000 Hour Life • Wet Location
LM-80 Qualified • LM-79 Certified Photometry



Two LED Arrays
Prevent Loss of
Illumination

Specifications

Delivered System Performance*

- Standard NFL distribution: 5770 delivered lumens / 59 LPW / 0.4 SC.
- 2x35 watt LED array. 3500°K standard (or see Options -30K or -41K).
- Up to 85 CRI and 60,000 hour life (L70). For 90+ CRI, see Option -HC.
- Fully sustainable: removable for servicing.

Thermal Management System

- All aluminum proprietary heat sinks, components and housing maximize cool operation and long life while minimizing maintenance.

LED Power Supplies (2) - INTERNAL

- Suitable for outdoor / indoor use: -30°C (-22°F) to 60°C (140°F).
- 120-277V / 50-60Hz standard. Load insensitive.
- 0-10V CC dimming standard. (100-1% dimming range)

Thermal Protection: SPECIFY VOLTAGE

- Thermal protector for insulation detection per UL/NEC. Must specify input voltage.

Trim and Lens Assembly

- Clear SofTex™ aluminum self-flanged downlight cone with clear tempered microprismatic glass lens above.
- Optional (white) anti-microbial Kirlin BioGard™ finish, see Option -BG.
- See Option -GE for green filter.

Acrylic Enameled Aluminum Housing

- Rustproof and corrosion resistant: Exceeds 1000 hour ASTM 5% salt spray test.
- Cool operation: Extends life of all components
- Fully sustainable: Entire luminaire, including LED light engine, is modular, easily visible and serviced through aperture.
- Built-in plaster flange.

Outlet Box

- UL listed J-box with insulated removable cover. Prewired 14 GA (NEC) with 1/2" and 3/4" knockouts.

Installation

- Recess indoor or outdoor.
- Accommodates ceilings up to 1-1/8" thick.
- 27" galvanized hanger bars with adjustable mounting brackets (2) supplied.

UL, C-UL (Canada) Listings

- Wet, damp or dry locations, covered ceilings.
- Through-branch conductors (4 #12 AWG 90°C).

CE & FCC Compliance

- Meets IEC/EN 60601-1-2 electromagnetic compatibility standard for medical electrical equipment.
- FCC Part 15 certified for EMI/RFI emissions.

FIVE YEAR Limited Warranty

- Complete standard fixture.

Performance at a Glance

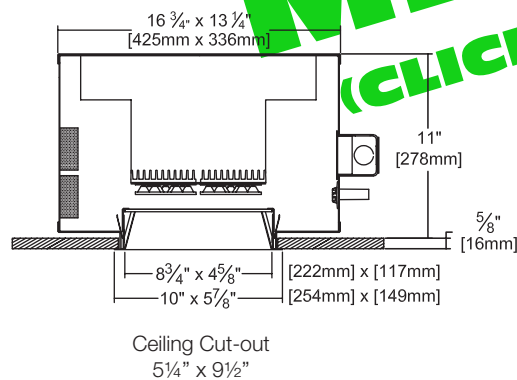

STANDARD (NFL) DISTRIBUTION

Lumens: 4351
SC: 0.4
LPW: 59
Efficiency: 64.5%
ITL Test: 79935

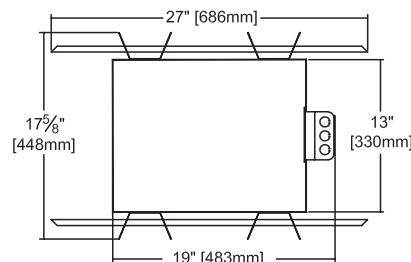
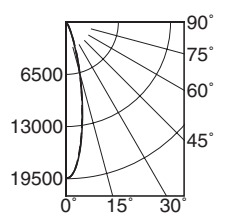

THE KIRLIN COMPANY

3401 EAST JEFFERSON AVENUE • DETROIT, MICHIGAN 48207-4232
(313) 259-6400 • Fax: (313) 259-9409 OR (313) 259-3121 • www.kirlinlighting.com

*See note next page

CATALOG NUMBER

MEDICAL FACILITY - LED EXAM LIGHTING

MRT-04550

DUE TO OUR CONTINUING EFFORT TO IMPROVE PRODUCTS, TECHNICAL INFORMATION IS SUBJECT TO CHANGE WITHOUT NOTICE. THE KIRLIN COMPANY EXPECTS PHOTOMETRIC PERFORMANCE TO IMPROVE SIGNIFICANTLY AND FREQUENTLY AS LED SOURCE TECHNOLOGY IMPROVES.

MRT-04550

4" x 9"

LED

4800 LUMEN SERIES

70 WATT

KIRLIN

Since 1895

Footcandle Distribution Data

Photometry from I.T.L., Boulder, CO

- Notes:
1. All lighting levels are expressed in average footcandles, with distances expressed in feet, as measured at the work plane (3'6").
 2. The work plane (3'6") is defined as: examination bed height, plus patient body depth.
 3. Fixture is centered over examination bed with its longest axis parallel to the length of the bed.

Photometric testing done
in accordance with IESNA
LM-79-08

STANDARD (70W) (2x35W)

Lumens: 4351
SC: 0.4
LPW: 59
Efficiency: 64.5%
ITL Test: 79935



Cone of Light ▲		
Dist.	FC	Dia.
6	539.3	2.4
8	303.3	3.1
10	194.1	3.9
12	134.8	4.7
14	99.1	5.5
16	75.8	6.3

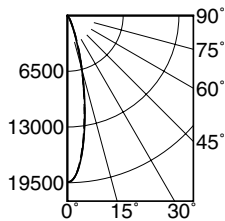

Total System Watts 73.6

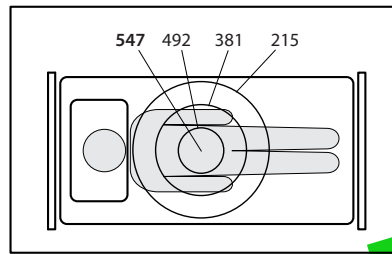

fc on Task: 8' Ceiling 3'6" Work Plane

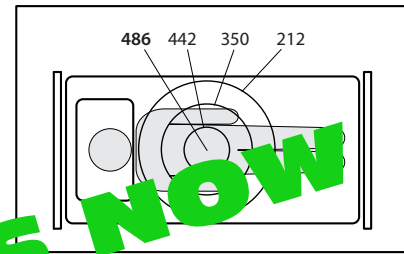

fc on Task: 8' Ceiling 3'6" Work Plane

LM-80 Qualified • LM-79 Certified Photometry

* LED manufacturers maintain a tolerance of $\pm 7\%$ on flux (lumens) and power (electrical) measurements. Kirlin photometrics are actual test data from Independent Testing Laboratories (ITL) where photometry was measured from 6742 lumen (2x35W) light engines (within the established tolerance).

▲ Cone of Light Key
(Dia. (in ft.) shown is where FC value is half the FC at nadir.)

Ft. Distance from fixture
FC Footcandles at nadir (0°)
Dia. Circle of light at 50% of FC

Options

LED Power Supply

- 120 120V (50-60Hz) input for thermal protector.
- 277 277V (50-60Hz) input for thermal protector.
- 29 **Two wire** full range (100-1%) PWM dimming instead (Lutron).
- 39 **Three wire** full range (100-1%) PWM dimming instead (Lutron).
- 97 Specify other voltage. Consult factory.

- EI Remote emergency inverter for 85% of rated fixture lumens, one LED array only. Run time: 90+ minutes. 120 or 277V, 60 Hz input only. Specify voltage.

Color (CCT and CRI)

- 30K Color temperature 3000°K instead.
- 41K Color temperature 4100°K instead.
- HC 90+ CRI instead. 3000°K only. Consult factory for availability. Reduces output by ~15%.

Trims

- 45 Gasket between trim flange and ceiling.
- BG Antimicrobial Kirlin BioGard™ white trim finish.
- GE Green acrylic filter mounted in lens assembly.

Other

- 99 Special modification. Consult factory.
- FS In-line fusing.

EMI-21220 SmartPower™ Emergency Back-Up System: see www.kirlinlighting.com

SUBMITTAL DATA

APPROVAL STAMP

JOB NAME

TYPE

WATTAGE

VOLTAGE

CATALOG NUMBER

