

CATALOG #	TYPE	
JOB NAME	WATTAGE	VOLTAGE

# Lighting for Patient Spaces

## Rectangular 4" x 9" LED Exam Light

Up to 60,000 Hour Rated Life • Antimicrobial Trim • Wet Location  
LM-80 Qualified • LM-79 Certified Photometry

## Specifications

### Delivered System Performance\*

- Lumen Series: **Must Specify**  
-5000L: 2x2500 (70W)
- Distribution: NFL standard
- Color temperature: 3500°K standard; optional: -27K, -30K or -41K
- CRI: 80+ standard; optional: -HC (90+)
- 60,000 Hour Rated Life (L70)
- Fully sustainable: removable for servicing

### Thermal Protection: SPECIFY VOLTAGE

- Thermal protector for insulation detection per UL/NEC; must specify input voltage

### Thermal Management System

- Aluminum heat sink and components for cool operation, long life, and low maintenance

### LED Driver - INTERNAL

- Indoor/Outdoor: -30°C to 60°C (-22°F to 140°F)
- 0-10V CCR dimming standard (100-10%)
- Voltage Options: **Must Specify**  
-120: -120V (50-60Hz); load insensitive  
-277: -277V (50-60Hz); load insensitive

### Trim and Lens Assembly

- Deep cutoff all aluminum self-flanged white trim with clear tempered microprismatic glass lens above
- Kirlin BioGard™ antimicrobial white finish continuously inhibits growth of bacteria on the coating of the trim

### Acrylic Enameled Aluminum Housing

- Rustproof: exceeds 1000 hour ASTM 5% salt spray test; all components fully sustainable
- Cool operation extends component life
- Modular design; visible and fully serviceable through aperture
- Built-in plaster flange

### Outlet Box (Galvanized)

- UL listed J-box with insulated removable cover; prewired 14 GA (NEC) with ½" and ¾" knockouts

### Installation & Hardware

- Indoor/outdoor in ceilings up to 1¼" thick
- Compatible with fire rated enclosures (by others)
- 27" galvanized hanger bars & adjusting brackets (2) supplied

## MRT-04511



### UL, C-UL (Canada) Listings

- Wet, damp or dry locations, covered ceilings
- Through-branch conductors (4 #12 AWG 90°C)

### IEC & FCC Compliance

- Meets IEC/EN 60601-1-2 electromagnetic compatibility standard for medical electrical equipment
- FCC Part 15 certified for EMI/RFI emissions

### FIVE YEAR Limited Warranty

- Complete standard fixture



## Options and Ordering Configuration

(Example: MRT-04511-5000L-120-30K-45)

Must Specify			Optional				
Model	Lumens	Volts	CCT & CRI	Driver Options	Emergency	Trim & Lens Options	Other Options
MRT-04511							
	-5000L	-120 -277  -97: Other voltage; consult factory	(Blank): 35K, 80+ CRI  80+ CRI -27K: 2700°K -30K: 3000°K -35K: 3500°K -41K: 4000°K -50K: 5000°K 90+ CRI -27K-HC: 2700°K -30K-HC: 3000°K -35K-HC: 3500°K -41K-HC: 4000°K -50K-HC: 5000°K	(Blank): Standard 0-10V CCR 10% dim  -ECO: For use with Lutron EcoSystem controls; dims to 1% or consult factory	(Blank): None  -EI: Remote emergency inverter for 50% of rated lumens; 90+ minutes; 60Hz input only; N/A for option -FS  -ERH: Remote emergency battery pack; delivers 1000 lumens; one array only; 90+ minutes (CEC Compliant)	(Blank): White trim, clear tempered microprismatic glass lens  Trim Finishes -BKBG: BioGard™ anti-microbial black -94BG: BioGard™ anti-microbial custom color finish  Other Trim Features -45: Gasket between trim flange and ceiling	(Blank): None  -99: Special modification; consult factory  -AWN: Athena Wireless Node; N/A for Dimming Option -ECO  -FS: Fused primary; One per fixture; not for use with Option -EI  *Note: For other integrated control solutions, such as nLight, contact factory

\*See note next page

Dimensions

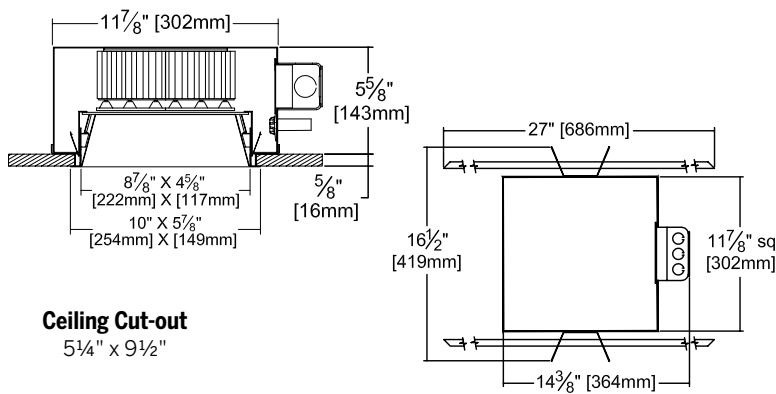

Ceiling Cut-out  
5 1/4" x 9 1/2"

Infection Control Levels

Level	Option	Infection Protection
1	Standard	BioGard™

Footcandle Distribution Data

Notes:

- 1. All lighting levels are expressed in average footcandles, with distances expressed in feet, as measured at the work plane (3'6")
- 2. The work plane (3'6") is defined as: examination bed height, plus patient body depth
- 3. Fixture is centered over examination bed with its longest axis parallel to the length of the bed

Photometry - Installed Complete Fixture

Photometry from UL Verification Services, Allentown, PA

LM-79 IESNA Certified Photometry from Independent Lab

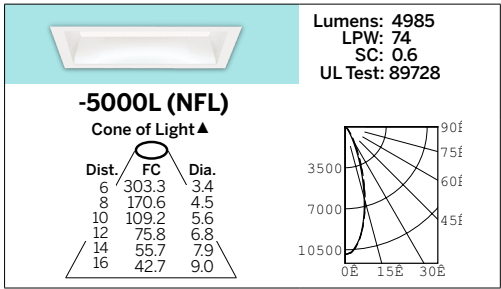

Total System Watts 67.0

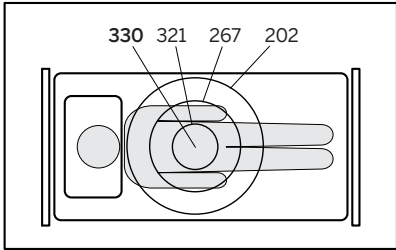
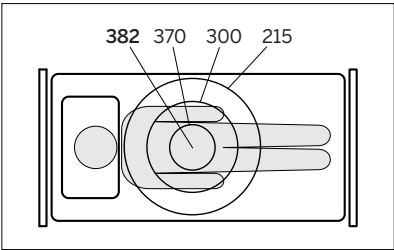

\*LED manufacturers maintain a tolerance of +/-7% on flux (lumens) and power (electrical) measurements.

▲ Cone of Light Key  
Dist. (in ft.) shown is where FC value is half the FC at nadir.  
FC Footcandles at nadir (0°)  
Dia. Circle of light at 50% of FC

LIMITED WARRANTY: CATALOGED KIRLIN FIXTURES ARE WARRANTED FREE OF DEFECTS IN WORKMANSHIP OR MATERIAL FOR FIVE YEARS FROM DATE OF PURCHASE. INSTALLED TO E.C. IN NORMAL USE. Manufacturer at his option will replace or repair such fixture or refund the purchase price on presentation of proof of purchase and defective fixture at the offices of manufacturer within the years of original shipment. Liability of manufacturer is limited to the foregoing and manufacturer shall not be liable for any other damages, direct or indirect, sustained or suffered by purchaser or any person. This warranty is supplied to the buyer in place of all other warranties, expressed or implied. Seller does not warrant as to merchantability or fitness for a particular use, nor will any oral statement constitute a warranty or amend this specific warranty. Abnormal use, abuse of the fixture, improper installation, or repair or modification of the fixture without prior written authorization from the manufacturer will render the warranty void.

PATENT SPACES  
NOVEMBER 2024