

CATALOG #	TYPE	
JOB NAME	WATTAGE	VOLTAGE

# Lighting for Patient Spaces

## Sealed & Gasketed 8" Downlight • LED

Class 100 Clean Room (-SH) • IP65 Rated • Wet Location

LM-80 Qualified • LM-79 Certified Photometry

## Specifications

### Delivered System Performance\*

- Nominal Lumens: **Must Specify**

#### Non-IC

-5000L

-3500L

-2500L

- Select trim & beam distribution: see chart
- Select color (CCT): see chart; 80+ CRI standard; Option -HC for 90+ (15% lumen loss)
- 60,000 Hour Rated Life (L70)

### Thermal Management System

- Aluminum heat sink and components for cool operation, long life, and low maintenance

### LED Driver - INTERNAL

- Indoor/Outdoor: -30°C to 60°C (-22°F to 140°F)
- 0-10V CCR dimming standard (100-10%)
- Voltage Options: **Must Specify**
  - 120: -120V (50-60Hz); load insensitive
  - 277: -277V (50-60Hz); load insensitive

### Trim/Lens Assembly

- Rustproof 100% aluminum grooveless, smooth, self-flanged white trim
- Kirlin BioGard™ antimicrobial white finish continuously inhibits growth of bacteria on the coating of the trim

- Regressed tempered prismatic spread lens with high efficiency reflector above

### IP65 Sealed and Gasketed

- Liquid silicone seal between trim and lens
- Closed cell housing flange gasketing seals trim to housing
- Closed cell trim flange gasketing seals flange to ceiling
- O-rings seal stainless steel fasteners to trim

### Acrylic Enameled Aluminum Housing

- Rustproof and corrosion resistant: exceeds 1000 hour ASTM 5% salt spray test; all components fully sustainable
- Shallow depth fits restricted plenums
- Cool operation extends component life
- Modular design; visible and fully serviceable through aperture
- Built-in plaster flange

### Outlet Box (Galvanized)

- UL listed J-box with removable cover. Prewired 14 GA (NEC) with 1/2" and 3/4" knockouts

### Installation & Hardware

- Recesses indoor/outdoor in ceilings up to 1 1/8" thick or see Option -79

## MRR-08835



- Compatible with fire rated enclosures (by others)
- 27" galvanized hanger bars & adjusting brackets (2) supplied

### UL, C-UL (Canada) Listings

- Wet, damp or dry locations, covered ceilings
- Through-branch conductors (4 #12 AWG 90°C)

### IEC & FCC Compliance

- Meets IEC/EN 60601-1-2 electromagnetic compatibility standard for medical electrical equipment
- FCC Part 15 certified for EMI/RFI emissions

### FIVE YEAR Limited Warranty

- Complete standard fixture



## Available Infection Control Levels

Level	Option	Infection Protection
2	Standard	BioGard™ IP65
3	-SH	BioGard™ IP65 ISO 5 / Class 100

Options and Ordering Configuration

(Example: MRR-08835-3500L-120-41K-NFL-35T-SH)

Must Specify			Optional					
Model	Lumens	Volts	CCT & CRI	Beam	Driver Options	Emergency	Lens & Trim Options	Other Options
MRR-08835	-5000L -3500L -2500L	-120 -277 -97 <sup>†</sup> : Other voltage	(Blank): 3500K, 80+ CRI  80+ CRI -27K: 2700°K -30K: 3000°K -35K: 3500°K -41K: 4000°K -50K: 5000°K 90+ CRI -27K-HC: 2700°K -30K-HC: 3000°K -35K-HC: 3500°K -41K-HC: 4000°K -50K-HC: 5000°K	(Blank): MFL  -NFL -MFL -WFL	(Blank): Standard 0-10V CCR 10% dim  -D1: 0-10V 1.0% dim -D2: 0-10V 0.1% dim -D3: DALI 1.0% dim -D4: DALI 100-0.1% dim -D5: DMX512A 0% dim -ECO: Digital driver for Lutron EcoSystem controls. Dims to 1% or consult factory; -3500L max	(Blank): None  -EI: Remote emergency inverter for 50% of rated lumens (-5000L or -3500L). N/A for -2500L. Run time: 90+ minutes; 120V or 277V, 60Hz input only; specify voltage; N/A for option -FS -EM: Internal emergency battery pack; Delivers 500 lumens; 90+ minutes -ERH: Remote emergency battery pack; delivers 1000 lumens; CEC Compliant; 90+ minutes	(Blank): Kirlin BioGard antimicrobial white finish trim with lens above  Trim Finishes -35T: Silver enamel (complete trim) -KBG: BioGard™ anti-microbial black -94: Custom color; consult factory -94BG: BioGard™ anti-microbial custom color finish  Other Trim Features -13: Clear poly lens below lens. Photometric distribution unaffected -17: Prismatic high strength acrylic lens instead -23: Frosted microprismatic lens instead -CF: Custom color filter (Rosco). Specify -GE: Green acrylic filter mounted in lens assembly -NS: NSF approved fixture -WA: White acrylic (flat) diffuser instead; will produce wide flood distribution	(Blank): None  Mounting -79: Extension collar; ceilings up to 2" thick  Other Options -99: Special modification; consult factory -AWN: Athena Wireless Node; N/A for Dimming Options -D5, -ECO -FS: Fused primary; One per fixture -SH: Sealed housing and junction box. Provides Cleanroom Rated luminaire (ISO 5 Class 100)  *Note: For other integrated control solutions, such as nLight, contact factory

Dimensions

Performance Factors

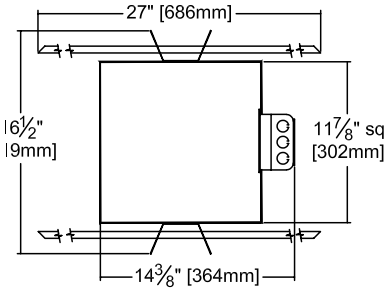
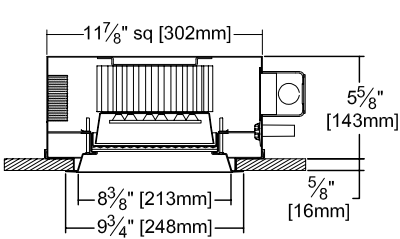

Ceiling Cut-out  
9 1/4" Dia.

NOMINAL LUMENS	LUMEN FACTOR	NOMINAL WATTS	LPW FACTOR
-5000L	1.00	56.7	1.00
-3500L	0.80	42.4	1.07
-2500L	0.57	36.9	0.88

Photometry - Installed Complete Fixture

Photometry from I.T.L., Boulder, CO

LM-79 IESNA Certified Photometry from Independent Lab

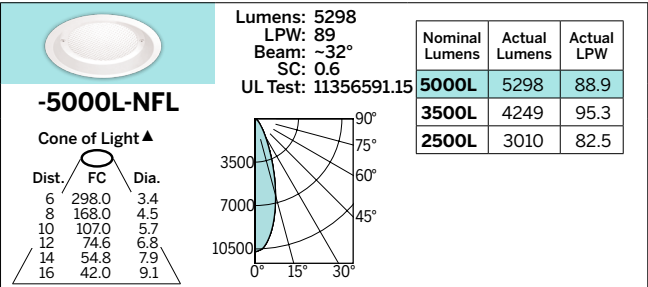
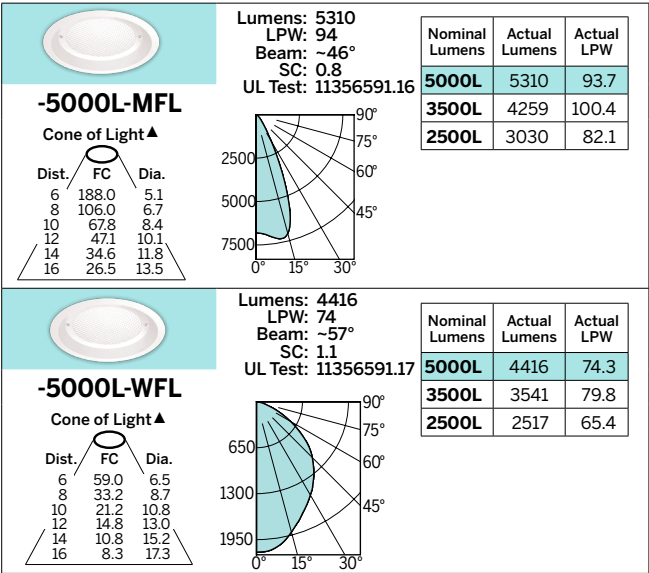

\*LED manufacturers maintain a tolerance of +/-7% on flux (lumens) and power (electrical) measurements.

▲ Cone of Light Key  
Dist. Distance (Ft.) from fixture  
FC Footcandles at nadir (0°)  
Dia. Circle of light at 50% of FC

LIMITED WARRANTY: KIRLIN LIGHTING FIXTURES ARE WARRANTED FREE OF DEFECTS IN WORKMANSHIP OR MATERIAL FOR FIVE YEARS FROM DATE OF PURCHASE. INSTALLATION TO N.E.C. IN NORMAL USE. Manufacturer at the option will replace or repair such fixture or refund the purchase price on presentation of proof of purchase and defective fixture at the offices of manufacturer within two years of original shipment. Liability of manufacturer shall not be liable for any other damages, direct or indirect, sustained or suffered by purchaser or any person. This warranty is supplied to the buyer in place of all other warranties, expressed or implied. Seller does not warrant as to merchantability or fitness for a particular use, nor will any oral statement constitute a warranty or amend this specific warranty. Abnormal use, abuse of the fixture, improper installation or repair, or modification of the fixture without prior written authorization from the manufacturer will render the warranty void.

PATIENT SPACES  
NOVEMBER 2024