

CATALOG #	TYPE	
JOB NAME	WATTAGE	VOLTAGE

8" LED 4800 • 3300 LUMEN SERIES 55 • 42 WATT

MRR-08542

Sealed & Gasketed IP65 LED Adjustable Exam Light

LM-80 Qualified • LM-79 Certified Photometry
Up to 60,000 Hour Life • Antimicrobial Trim



"IP65 Rated"

LEVEL 2

Specifications

Delivered System Performance*

- Standard NFL distribution: 4487 delivered lumens / 77 LPW / 0.4 SC.
- 55 watt LED array. 3500°K standard (or see Options -30K or -41K).
- Up to 85 CRI and 60,000 hour life (L70). For 90+ CRI, see Option -HC.
- Option -43: 3300 lumen / 42 watt series package instead.
- Fully sustainable: removable for servicing.

Center Beam Optics

- Self-aligns with trim for optimal performance.
- Hot aiming by hand.
- Tilts from 0° to 35° in 1° increments and locks in place.
- Rotates full 365° and locks in place.
- Accommodates sloped ceilings up to 35°.

Thermal Management System

- All aluminum proprietary heat sink, components and housing maximize cool operation and long life while minimizing maintenance.

LED Power Supply - INTERNAL

- Suitable for outdoor / indoor use: -30°C (-22°F) to 60°C (140°F).
- 120-277V / 50-60Hz standard. Load insensitive.
- 0-10V CCR dimming standard. (100-10%)**
- For Lutron HiLume dimming, see -29 or -39.

- Optional remote SmartSupply™ driver instead, see Option -SS for restrictions and details.

Thermal Protection: SPECIFY VOLTAGE

- Thermal protector for insulation detection per UL/NEC. Must specify input voltage.

Trim and Lens Assembly

- Rustproof 100% aluminum grooveless, smooth, self-flanged trim.
- Kirlin BioGard™ antimicrobial white finish continuously inhibits growth of bacteria on the coating of the trim.
- Regressed tempered micropismatic glass lens. See Option -GE for green filter.

5X Sealed and Gasketed

- (1) Silicons seal between trim and lens seals lens to trim, (2) closed cell gasketing between trim and housing flange seals trim to housing, (3) closed cell gasketing on trim flange seals flange to ceiling (4) closed cell gasketing on bottom pan seals housing to ceiling and (5) neoprene O-rings on stainless steel fasteners seal fasteners to trim.
- Meets ASTM E283 restricted airflow of 2 CFM maximum.

Acrylic Enamelled Aluminum Housing

- Rustproof and corrosion resistant: Exceeds 1000 hour ASTM 5% salt spray test.
- Cool operation: Extends life of all components.
- Fully sustainable: Entire luminaire, including LED light engine, is modular, easily visible and serviced through aperture.

- Built-in plaster flange.
- Sealed housing design available, see -SH.

Outlet Box

- UL listed J box with insulated removable cover. Prewired 14 GA (NEC) with 1/2" and 3/4" knockouts.

Installation

- Recess indoor or outdoor.
- Accommodates ceilings up to 1/4" thick or see Option -79.
- 27" galvanized hanger bars with adjustable mounting brackets (2) supplied.

UL, C-UL (Canada) Listings

- Wet, damp or dry locations, covered ceilings.
- Through-branch conductors (4 #12 AWG 90°C).

CE & FCC Compliance

- Meets IEC/EN 60601-1-2 electromagnetic compatibility standard for medical electrical equipment.
- FCC Part 15 certified for EMI/RFI emissions.



FIVE YEAR Limited Warranty

- Complete standard fixture.

THIS PRODUCT IS NOW AVAILABLE AS MRR-08542 (CLICK TO DOWNLOAD)

Performance at a Glance

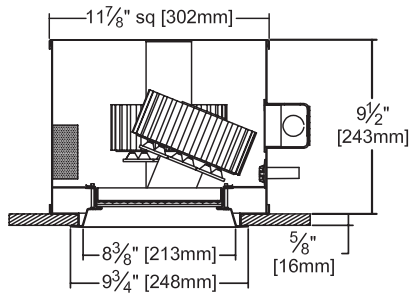

Ceiling Cut-out 9" Dia.

SPECIFY VOLTAGE

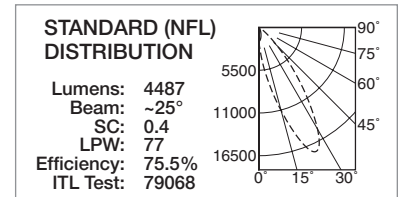
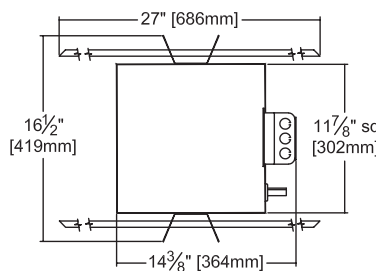

THE KIRLIN COMPANY

3401 EAST JEFFERSON AVENUE • DETROIT, MICHIGAN 48207-4232
(313) 259-6400 • Fax: (313) 259-9409 OR (313) 259-3121 • www.kirlinlighting.com

*See note next page

CATALOG NUMBER

MEDICAL FACILITY - LED EXAM LIGHTING

MRR-08542

DUE TO OUR CONTINUING EFFORT TO IMPROVE PRODUCTS, TECHNICAL INFORMATION IS SUBJECT TO CHANGE WITHOUT NOTICE. THE KIRLIN COMPANY EXPECTS PHOTOMETRIC PERFORMANCE TO IMPROVE SIGNIFICANTLY AND FREQUENTLY AS LED SOURCE TECHNOLOGY IMPROVES.

Footcandle Distribution Data

Photometry from I.T.L., Boulder, CO

Photometric testing done in accordance with IESNA LM-79-08

- Notes:
- All lighting levels are expressed in average footcandles, with distances expressed in feet, as measured at the work plane (3'6").
 - The work plane (3'6") is defined as: examination bed height, plus patient body depth.

STANDARD (NFL) (55W)

Lumens: 4487
 Beam: ~25°
 SC: 0.4
 LPW: 77
 Efficiency: 75.5%
 ITL Test: 79068

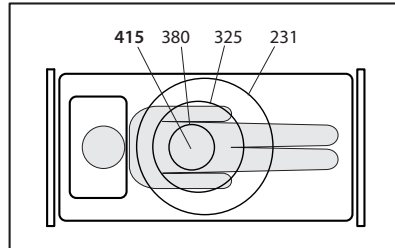

fc on Task: 8' Ceiling 3'6" Work Plane

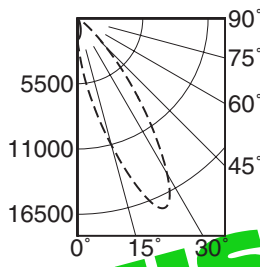

Total System Watts 58.1

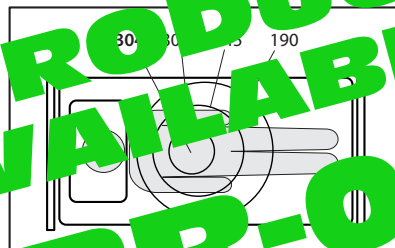

fc on Task: 5' Ceiling 3'6" Work Plane

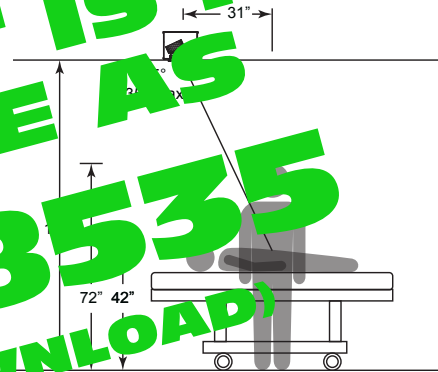
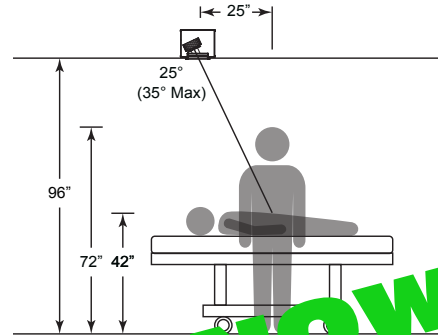

THIS PRODUCT IS NOW AVAILABLE AS MRR-08535 (CLICK TO DOWNLOAD)

LM-80 Qualified • LM-79 Certified Photometry

* LED manufacturers maintain a tolerance of ±7% on flux (lumens) and power (electrical) measurements. Kirlin photometrics are actual test data from Independent Testing Laboratories (ITL) where photometry was measured from 5946 lumen (55W) light engines (within the established tolerance).

Options

SPECIFY VOLTAGE

LED Power Supply

- 120 120V (50-60Hz) input for thermal protector.
- 277 277V (50-60Hz) input for thermal protector.
- 29 **Two wire** full range (100-1%) PWM dimming instead (Lutron). 120V only.
- 39 **Three wire** full range (100-1%) PWM dimming instead (Lutron).
- 43 3300 lumen / 42 watt series instead. Also see Options -29 and -39.
- 97 Specify other voltage. Consult factory.
- EI Remote emergency inverter for 45% of rated lumens for 55W or 42W. Run time: 90+ minutes. 120 or 277V, 60Hz input

- only. Specify voltage. Not for use with -SS SmartSupply™ driver or with Option -29.
- SS Remote mounted Kirlin SmartSupply™ driver (instead of standard internal driver), sold separately. Drives up to 3 (55W) luminaires. Not available for -43(42W). Order LPS-1220A (0-10V analog for 100-1% PWM dimming). See submittal sheet at www.kirlinlighting.com

Color Temperature (CCT)

- 30K Color temperature 3000°K instead.
- 41K Color temperature 4100°K instead.
- HC 90+ CRI instead. 3000°K only. Consult factory for availability. Reduces output by ~15%.

Trims

- GE Green filter added to lens assembly.

Other

- 79 Extension collar for up to 2" thick ceilings.
- 99 Special modification. Consult factory.
- FD Dual circuit fusing for use only with Option -EI.
- FS In-line fusing.
- SH Sealed housing and junction box. (CCEA approved) Also meets ASTM E283 restricted airflow of 2 CFM maximum.



EMI-21220 SmartPower™ Emergency Back-Up System: see www.kirlinlighting.com

SUBMITTAL DATA

APPROVAL STAMP

JOB NAME _____
 TYPE _____
 WATTAGE _____ VOLTAGE _____
 CATALOG NUMBER _____



LIMITED WARRANTY: CATALOGED KIRLIN FIXTURES ARE WARRANTED FREE OF DEFECTS IN WORKMANSHIP OR MATERIAL FOR THREE YEARS FROM DATE OF PURCHASE. INSTALLATION TO N.E.C. IN NORMAL USE. Manufacturer at his option will replace or repair such fixture or refund the purchase price on presentation of proof of purchase and defective fixture at the office of manufacturer within three years of original shipment. Liability of manufacturer is limited to the foregoing, and manufacturer shall not be liable for any other damages, direct or indirect, sustained by purchaser or any other person. This warranty is supplied to the buyer in place of all other warranties, expressed or implied. Seller does not warrant as to merchantability or fitness for a particular use, nor will any oral statement constitute a warranty or amend this specific warranty. Abnormal use, abuse of the fixture, improper installation, or repair, or modification of the fixture without prior written authorization from the manufacturer will render the warranty void.