

CATALOG #	TYPE	
JOB NAME	WATTAGE	VOLTAGE

# Lighting for Patient Spaces

## OR/Clean Room 7" LED Exam Light

Up to 90,000 Hour Rated Life • Type IC • Antimicrobial Trim  
LM-80 Qualified • LM-79 Certified Photometry

### Specifications

#### Delivered System Performance\*

- Lumen Series: **Must Specify**
  - 2000L (25W)
  - 1500L (15W)
- Distribution: NFL standard; optional: -MFL
- Color temperature: 3500°K standard; optional: -27K, -30K or -41K
- CRI: 80+ standard; optional: -HC (90+)
- 90,000 Hour Rated Life (L70\*\*)
- Fully sustainable: removable for servicing

#### Thermal Management System

- Aluminum heat sink and components for cool operation, long life, and low maintenance

#### LED Driver - INTERNAL

- Indoor/Outdoor: -30°C to 60°C (-22°F to 140°F)
- 0-10V CCR dimming standard (100-10%)
- Voltage Options: **Must Specify**
  - 120: -120V (50-60Hz); load insensitive
  - 277: -277V (50-60Hz); load insensitive

#### Trim and Lens Assembly

- Rustproof 100% aluminum grooveless, smooth, self-flanged trim

- Kirlin BioGard™ antimicrobial white finish continuously inhibits growth of bacteria on the coating of the trim
- Regressed tempered microprismatic glass lens

#### IP65 Sealed & Gasketed Trim

- Liquid silicone seals between trim and lens
- O-rings seal stainless fasteners to trim
- Meets ASTM E283 restricted airflow of 2CFM

#### Acrylic Enameled Aluminum Housing

- Rustproof: exceeds 1000 hour ASTM 5% salt spray test; all components fully sustainable
- Shallow depth for restricted plenums
- Cool operation extends component life
- Modular design; visible and fully serviceable through aperture
- Built-in plaster flange
- Air tight housing and junction box; meets/exceeds ASTM E283 restricted airflow (2 CFM maximum); CCEA approved

#### Outlet Box (Galvanized)

- UL listed J-box with insulated removable cover; prewired 14 GA (NEC) with ½" and ¾" knockouts

## MRR-07550



Sealed Housing & Trim

#### Installation & Hardware

- Indoor/outdoor in ceilings up to 1½" thick
- Compatible with fire rated enclosures (by others)
- 27" galvanized hanger bars & adjusting brackets (2) supplied

#### UL, C-UL (Canada) Listings

- Wet, damp or dry locations, covered ceilings
- Type IC: for direct contact with insulation
- Through-branch conductors (4 #12 AWG 90°C)

#### IEC & FCC Compliance

- Meets IEC/EN 60601-1-2 electromagnetic compatibility standard for medical electrical equipment
- FCC Part 15 certified for EMI/RFI emissions

#### FIVE YEAR Limited Warranty

- Complete standard fixture

## Options and Ordering Configuration

(Example: MRR-07550-2000L-120-30K-MFL)



Must Specify			Optional											
Model	Lumens	Volts	CCT & CRI	Beam	Driver Options	Emergency	Trim & Lens Options	Other Options						
MRR-07550														
	-2000L -1500L	-120 -277  -97: Other voltage; consult factory	(Blank): 35K, 80+ CRI  <b>80+ CRI</b> -27K: 2700°K -30K: 3000°K -35K: 3500°K -41K: 4000°K -50K: 5000°K <b>90+ CRI</b> -27K-HC: 2700°K -30K-HC: 3000°K -35K-HC: 3500°K -41K-HC: 4000°K -50K-HC: 5000°K	(Blank): NFL  -MFL	(Blank): Standard 0-10V CCR 10% dim  -D1: 0-10V 1.0% dim -D2†: 0-10V 0.1% dim -D3†: DALI 1.0% dim -D4†: DALI 100-0.1% dim -D5†: DMX512A 0.1% dim	(Blank): None  -EI: Remote emergency inverter for 50% of rated lumens; 90+ minutes; 60Hz input only; N/A for option -FS -ERH: Remote emergency battery pack; delivers 1000 lumens; 90+ minutes (CEC Compliant)	(Blank): White trim, regressed prismatic lens  <b>Trim Finishes</b> -BKBG: BioGard™ anti-microbial black -94BG: BioGard™ anti-microbial custom color finish	(Blank): None  -99: Special modification; consult factory -AWN: Athena Wireless Node; N/A for Dimming Options -D5 -FS: Fused primary; One per fixture; not for use with option -EI -NS: NSF approved fixture  *Note: For other integrated control solutions, such as nLight, contact factory						
*See note next page														
<table><tr><td colspan="2">Projected L70** for Kirlin Luminaires</td></tr><tr><td>In Open Plenum</td><td>90,000 hours</td></tr><tr><td>In Insulation (Type IC)</td><td>60,000 hours</td></tr></table>			Projected L70** for Kirlin Luminaires		In Open Plenum	90,000 hours	In Insulation (Type IC)	60,000 hours						
Projected L70** for Kirlin Luminaires														
In Open Plenum	90,000 hours													
In Insulation (Type IC)	60,000 hours													
**Hours at 70% lumen maintenance			† Consult factory for use with -2000L lumen series											

## Dimensions

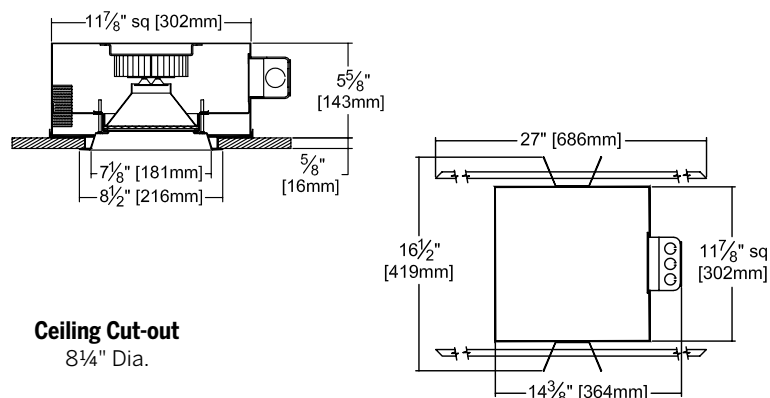

## Infection Control Levels

Level	Option	Infection Protection
3	Standard	  

## Performance Factors

NOMINAL LUMENS	LUMEN FACTOR	NOMINAL WATTS	LPW FACTOR
-2000L	1.26	1.37	0.92
-1500L	1.00	1.00	1.00

## Footcandle Distribution Data

### Notes:

- All lighting levels are expressed in average footcandles, with distances expressed in feet, as measured at the work plane (3'6")
- The work plane (3'6") is defined as: examination bed height, plus patient body depth

## Photometry - Installed Complete Fixture

Photometry from I.T.L., Boulder, CO

LM-79 IESNA Certified Photometry from Independent Lab

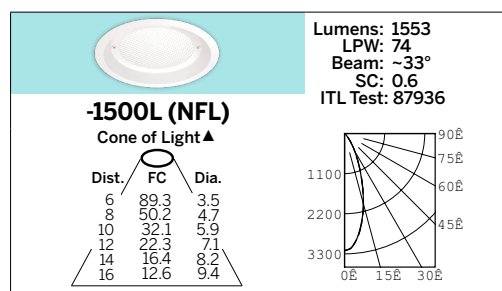

Total System Watts 20.9

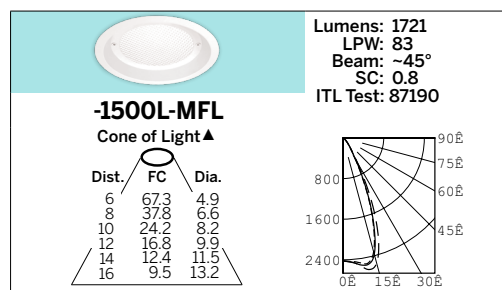
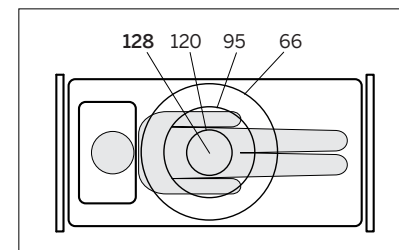
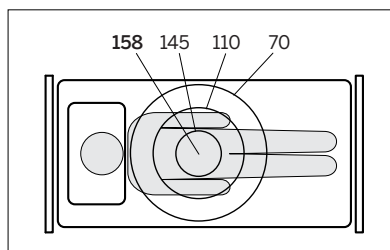

Total System Watts 20.8

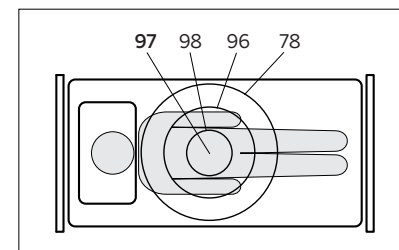
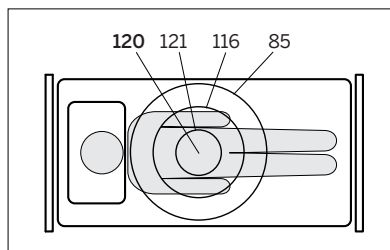

\*LED manufacturers maintain a tolerance of +/-7% on flux (lumens) and power (electrical) measurements.

▲ Cone of Light Key  
Dia. (in ft.) shown is where FC value is half the FC at nadir.

Dist. Distance (Ft.) from fixture  
FC Footcandles at nadir (0°)  
Dia. Circle of light at 50% of FC

LIMITED WARRANTY: KIRLIN LIGHTING FIXTURES ARE WARRANTED FREE OF DEFECTS IN WORKMANSHIP OR MATERIAL FOR FIVE YEARS FROM DATE OF PURCHASE. INSTALLATION, IN NORMAL USE, MANUFACTURER AT HIS OPTION WILL REPAIR OR REPLACE WITH NEW OR REPAIR OR REPLACE THE PURCHASE PRICE ON PRESENTATION OF PROOF OF PURCHASE AND DEFECTIVE FAILURE AT THE OFFICE OF MANUFACTURER WITHIN FIVE YEARS OF ORIGINAL SHIPMENT. LIABILITY OF MANUFACTURER IS LIMITED TO THE FOREGOING AND MANUFACTURER SHALL NOT BE LIABLE FOR ANY OTHER DAMAGES, DIRECT OR INDIRECT, SUSTAINED OR SUFFERED BY PURCHASER OR ANY PERSON. THIS WARRANTY IS SUPPLIED TO THE BUYER IN PLACE OF ALL OTHER WARRANTIES, EXPRESSED OR IMPLIED. SELLER DOES NOT WARRANT AS TO MERCHANTABILITY OR FITNESS FOR A PARTICULAR USE, NOR WILL ANY ORAL STATEMENT CONSTITUTE A WARRANTY OR AMEND THIS SPECIFIC WARRANTY. ABNORMAL USE, ABUSE OF THE FIXTURE, IMPROPER INSTALLATION, OR REPAIR OR MODIFICATION OF THE FIXTURE WITHOUT PRIOR WRITTEN AUTHORIZATION FROM THE MANUFACTURER WILL RENDER THE WARRANTY VOID.

PATENT SPACES  
NOVEMBER 2024