

CATALOG #	TYPE	
JOB NAME	WATTAGE	VOLTAGE

Lighting for Patient Spaces

Mini-Rectangle 3" x 5" Steplight • LED

50,000 Hour Rated Life • Type IC • Optional LED Filter Colors

Specifications

LED

- White module (colored filters optional)
- 3500°K standard
- 4 system watts - energy efficient, uniform, cool

LED Power Supply/Driver

- Max 13 volt DC and 4 watt fixed output; electronically stabilized
- Minimum operating temperature -4°F (-20°C)
- 120-277 volt standard; load insensitive

Lens

- Translucent white 1/8" polycarbonate sealed to trim

Faceplate

- Rustproof aluminium trim
- White finish standard; optional colors
- Optional (white only) antimicrobial Kirlin BioGard™ finish; see Option-BG
- Secured to housing with two screws and captive nuts
- Removable for servicing

Housing: Shallow 3½" Depth

- 2" x 3" x 3½" standard U. L. listed galvanized steel outlet box

Installation

- Recesses indoor or outdoor, covered locations; versatile 3½" depth
- Mounting holes on top and bottom

MNT-03926



UL, C-UL (Canada) Listings

- Damp or dry locations
- Type IC; approved for direct contact with insulation

FIVE YEAR Limited Warranty

- Complete standard fixture

Options and Ordering Configuration

(Example: MNT-03926-BL-37-26)

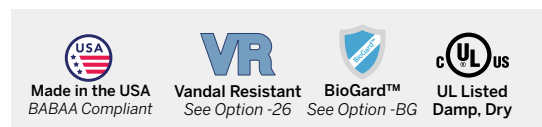

Required	Optional				
Model	CCT	Voltage/Battery Pack	Filter Colors	Faceplate Finishes	Other Options
MNT-03926	(Blank): 3500°K -27K: 2700°K	(Blank): Universal 120-277 V -97: Other voltage input; consult factory -EI: Remote emergency inverter for 100% of rated lumens; Run time: 90+ minutes; 120 or 277V, 60Hz input only; specify voltage	(Blank): None -BL: Blue filter -GE: Green filter -OR: Orange filter -RA: Red/Amber filter -YE: Yellow filter -CF: Custom color filter (Rosco); specify	(Blank): Standard white finish -35: Silver (natural aluminum) acrylic enamel -37: Dark bronze acrylic enamel -38: Black acrylic enamel -BG: BioGard™ anti-microbial white -BKBG: BioGard™ anti-microbial black -94: Custom color; consult factory -94BG: BioGard™ anti-microbial custom color finish	(Blank): None -26: Faceplate secured to housing with two center pin tamperproof screws; tamperproof tool included -99: Special modification; consult factory

Performance

Footcandle Performance Opposite Fixture Installed Top View

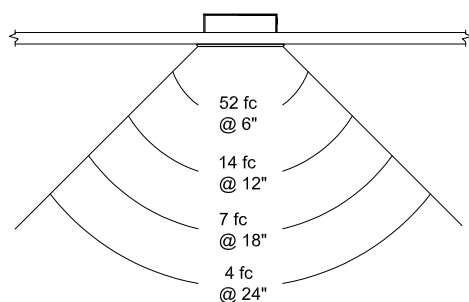

Dimensions

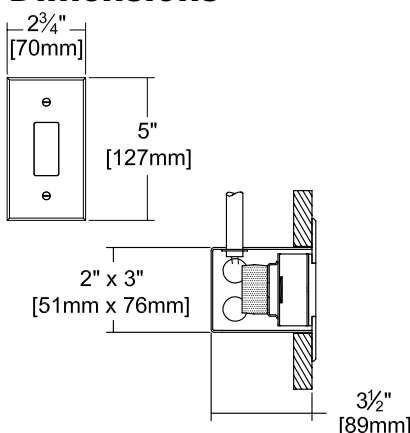

LED Filter Colors

