

CATALOG #	TYPE	
JOB NAME	WATTAGE	VOLTAGE

## Latitudes Series

### Vandal Sealed & Gasketed 8" Downlight • LED

Up to 60,000 Hour Rated Life • Wet Listed

LM-79 Certified • LM-80 Qualified

## LRV-08468



## Specifications

### Delivered System Performance

- Lumen Series: **Must Specify**

#### Non-IC

-6500L

-5000L

-3500L

-2500L

- Select trim & beam distribution: see chart
- Select color (CCT): see chart; 80+ CRI standard; Option -HC for 90+ (15% lumen loss)
- 60,000 Hour Rated Life (L70)
- Fully sustainable: removable for servicing

### Thermal Protection: SPECIFY VOLTAGE

- Thermal protector for insulation detection per UL/NEC. Must specify input voltage

### Thermal Management System

- Aluminum heat sink and components for cool operation, long life, and low maintenance

### LED Driver - INTERNAL

- Indoor/Outdoor: -30°C to 60°C (-22°F to 140°F)
- 0-10V CCR 10% dimming standard
- 120-277V / 50-60 Hz standard; load insensitive

### Trim Assembly

- Vandal resistant smooth white seamless tapered aluminum self-flanged flare trim (field paintable)

- Flush center pin tamperproof hex screws and captive nuts secure trim to housing
- High strength prismatic acrylic above 1/8" clear flat polycarbonate
- Continuous ring secures lens to trim
- Tamperproof tool included

### IP65 Sealed and Gasketed

- Liquid silicone seal between trim and lens
- Closed cell housing flange gasketing seals trim to housing
- Closed cell trim flange gasketing seals flange to ceiling
- Closed cell gasketing on bottom pan seals housing to ceiling
- O-rings seal stainless steel fasteners to trim

### Acrylic Enameled Aluminum Housing

- Rustproof and corrosion resistant: exceeds 1000 hour ASTM 5% salt spray test
- Shallow depth fits restricted plenums
- Cool operation extends component life
- Modular design; visible and fully serviceable through aperture
- Built-in plaster flange

### Outlet Box (Galvanized)

- UL Listed, 14GA, insulated, removable cover
- 1/2" and 3/4" knockouts

### Installation & Hardware

- Indoor/outdoor in ceilings up to 1 1/8" thick
- Compatible with fire rated enclosures (by others)
- 27" hanger bars & adjusting brackets (2) supplied

### UL, C-UL (Canada) Listings

- UL Listed: wet, damp or dry locations, covered ceilings
- Through-branch conductors (4 #12 AWG 90°C)

### IEC & FCC Compliance

- Meets IEC/EN 60601-1-2 electromagnetic compatibility standard for medical electrical equipment
- FCC Part 15 certified for EMI/RFI emissions

### FIVE YEAR Limited Warranty

- Complete standard fixture

## Options and Ordering Configuration

(Example: LRV-08468-3500L-120-MFL-35K-23-RH-NAT)

Must Specify					Optional			
Model	Lumens	Volts	Beam	CCT <sup>†</sup> & CRI	Driver Options	Emergency Options	Trim Options	Other Options
LRV-08468								
	-6500L -5000L -3500L -2500L	-120 -277 -97 <sup>†</sup> : Other Voltage	(Blank): MFL  -NFL -MFL -WFL	(Blank): 3500K, 80+ CRI  80+ CRI* -27K: 2700°K -30K: 3000°K -35K: 3500°K -41K: 4000°K -50K: 5000°K  *Note: Lumen Factor = 0.93 for -27K 90+ CRI** -27K-HC: 2700°K -30K-HC: 3000°K -35K-HC: 3500°K -41K-HC: 4000°K -50K-HC: 5000°K  **Note: Lumen Factor = 0.79 for -27K-HC; All Others = 0.85; Consult factory	(Blank): Standard 0-10V CCR 10% dim  -D1: 0-10V 1.0% dim -D2: 0-10V 0.1% dim -D3: DALI 1.0% dim -D4: DALI 100-0.1% dim -D5: DMX512A 0% dimming instead. Consult factory for -6500L lumen series -D40: -40°C (-40°F) driver; 0-10V 10% dimming instead for -3500L and -2500L -ECO: Digital driver for Lutron EcoSystem controls. Dims to 1% or consult factory -3500L max	(Blank): None  -EI: Remote emergency inverter for 40% of rated lumens for -6500L, 50% for -5000L, and -3500L. Not available for -2500L. Run time: 90+ minutes. 120 or 277V, 60 Hz input only. Specify voltage. Not for use with option -FS  -EM: Internal emergency battery pack; Delivers 500 lumens; Run time: 90+ minutes. Not available with -6500L  -ERH: Remote emergency battery pack; Delivers 1000 lumens; CEC Compliant; Run time: 90+ minutes	(Blank): Standard clear specular cone; microprismatic lens  Trim Finishes -35T: Silver enamel (complete trim) -37T: Dark bronze enamel (complete trim) -38T: Black enamel (complete trim) -94: Custom color; consult factory  Other Trim Features -23: Frosted microprismatic lens -CF: Custom color filter (Rosco); Specify -WA: White acrylic (flat) diffuser instead; will produce wide flood distribution	(Blank): None  Mounting -RH: Joist mounting hardware instead  Other Options -99: Special modification; consult factory -AWN: Athena Wireless Node; N/A for Dimming Options -D5, -D40, -ECO -FS: Fused primary; One per fixture; N/A for option -EI -NAT: Modified for natatorium use -SH: Sealed housing and junction box. CCEA Chicago Plenum Approved



IP65



Chicago Plenum Approved



Made in the USA



Natatorium



FCC Part 15 Certified



UL Listed

Wet, Damp, Dry

## Performance Factors

NOMINAL LUMENS	LUMEN FACTOR	NOMINAL WATTS	LPW FACTOR
-6500L	1.00	72.6	1.00
-5000L	0.93	59.8	1.13
-3500L	0.75	44.7	1.21
-2500L	0.53	37.0	1.03

## Dimensions

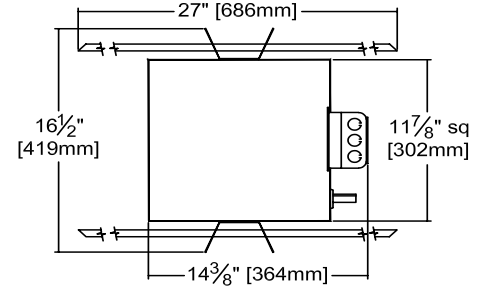
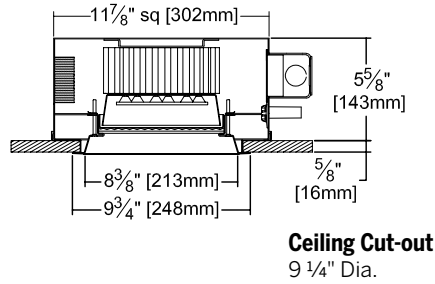

\* See notes on page 1 for additional info on Lumen Factors

## Photometry - Installed Complete Fixture

LM-79 IESNA Certified Photometry from Independent Lab

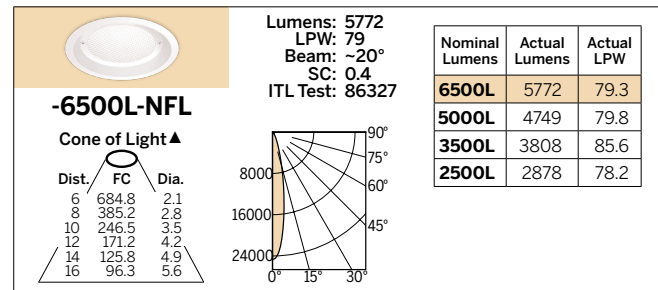
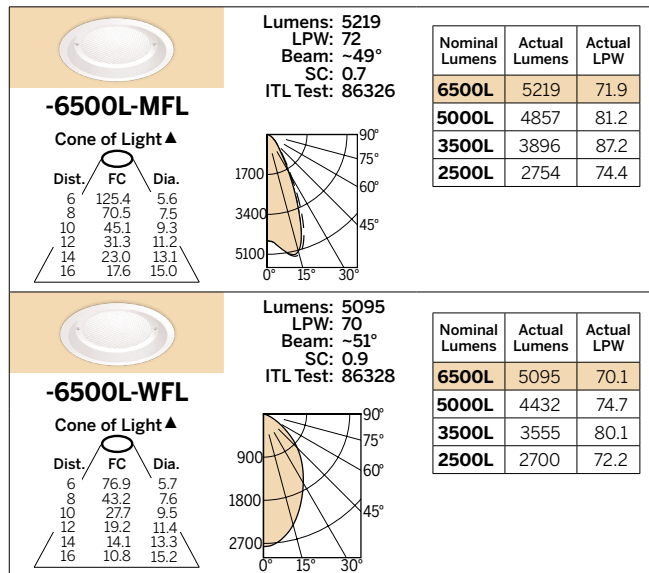

LED manufacturers maintain a tolerance of +/-7% on flux (lumens) and power (electrical) measurements.

▲ **Cone of Light Key**  
Dia. (in ft.) shown is where FC value is half the FC at nadir.  
**Dist.** Distance (Ft.) from fixture  
**FC** Footcandles at nadir (0°)  
**Dia.** Circle of light at 50% of FC