

CATALOG #	TYPE	
JOB NAME	WATTAGE	VOLTAGE

# Latitudes Series

## Vandal Sealed & Gasketed 7" Downlight • LED

Up to 60,000 Hour Rated Life • Wet Listed

LM-79 Certified • LM-80 Qualified

# LRV-07465



## Specifications

### Delivered System Performance

- Lumen Series: **Must Specify Non-IC -2500L**
- Select trim & beam distribution: see chart
- Select color (CCT): see chart; 80+ CRI standard; Option -HC for 90+ (15% lumen loss)
- 60,000 Hour Rated Life (L70)

### Thermal Protection: SPECIFY VOLTAGE

- Thermal protector for insulation detection per UL/NEC. Must specify input voltage

### Thermal Management System

- Aluminum heat sink and components for cool operation, long life, and low maintenance

### LED Driver - INTERNAL

- Indoor/Outdoor: -30°C to 60°C (-22°F to 140°F)
- 0-10V CCR 10% dimming standard
- 120-277V / 50-60 Hz standard; load insensitive

### Trim Assembly

- Vandal resistant smooth white seamless tapered aluminum self-flanged flare trim (field paintable)

- Flush center pin tamperproof hex screws and captive nuts secure trim to housing
- High strength prismatic acrylic above 1/8" clear flat polycarbonate
- Continuous ring secures lens to trim
- Tamperproof tool included

### IP65 Sealed and Gasketed

- Liquid silicone seal between trim and lens
- Closed cell housing flange gasketing seals trim to housing
- Closed cell trim flange gasketing seals flange to ceiling
- Closed cell gasketing on bottom pan seals housing to ceiling
- O-rings seal stainless steel fasteners to trim

### Acrylic Enameled Aluminum Housing

- Rustproof and corrosion resistant: exceeds 1000 hour ASTM 5% salt spray test
- Shallow depth fits restricted plenums
- Cool operation extends component life
- Modular design; visible and fully serviceable through aperture
- Built-in plaster flange

### Outlet Box (Galvanized)

- UL Listed, 14GA, insulated, removable cover
- 1/2" and 3/4" knockouts

### Installation & Hardware

- Indoor/outdoor in ceilings up to 1 1/8" thick
- Compatible with fire rated enclosures (by others)
- 27" hanger bars & adjusting brackets (2) supplied

### UL, C-UL (Canada) Listings

- UL Listed: wet, damp or dry locations, covered ceilings
- Through-branch conductors (4 #12 AWG 90°C)

### IEC & FCC Compliance

- Meets IEC/EN 60601-1-2 electromagnetic compatibility standard for medical electrical equipment
- FCC Part 15 certified for EMI/RFI emissions

### FIVE YEAR Limited Warranty

- Complete standard fixture

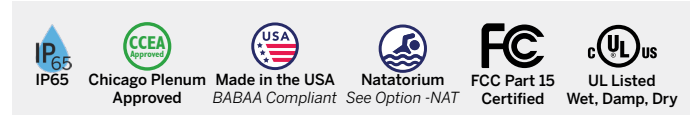

## Options and Ordering Configuration

(Example: LRV-07465-2500L-120-MFL-30K-37T-RH-NAT)

Must Specify					Optional			
Model	Lumens	Volts	Beam	CCT <sup>†</sup> & CRI	Driver Options	Emergency Options	Trim Options	Other Options
LRV-07465	-2500L	-120 -277 -97 <sup>†</sup> : Other Voltage	(Blank): MFL  -NFL -MFL	(Blank): 3500K, 80+ CRI  <b>80+ CRI*</b> -27K: 2700°K -30K: 3000°K -35K: 3500°K -41K: 4000°K -50K: 5000°K  *Note: Lumen Factor = 0.93 for -27K <b>90+ CRI**</b> -27K-HC: 2700°K -30K-HC: 3000°K -35K-HC: 3500°K -41K-HC: 4000°K -50K-HC: 5000°K  **Note: Lumen Factor = 0.79 for -27K-HC; All Others = 0.85; Consult factory	(Blank): Standard 0-10V CCR 10% dim  -D1: 0-10V 1.0% dim -D2: 0-10V 0.1% dim -D3: DALI 1.0% dim -D4: DALI 100-0.1% dim -D5: DMX512A 0% dimming instead. -D40: -40°C (-40°F) driver; 0-10V 10% dim  -ECO: Digital driver for Lutron EcoSystem controls. Dims to 1% or consult factory	(Blank): None  -EM: Internal emergency battery pack; Delivers 500 lumens; Run time: 90+ minutes  -ERH: Remote emergency battery pack; Delivers 1000 lumens; CEC Compliant; Run time: 90+ minutes	(Blank): Vandal resistant smooth white seamless tapered aluminum self-flanged trim  <b>Trim Finishes</b> -35T: Silver enamel (complete trim) -37T: Dark bronze enamel (complete trim) -38T: Black enamel (complete trim) -94: Custom color; consult factory  <b>Other Trim Features</b> -23: Frosted microprismatic lens -CF: Custom color filter (Rosco); Specify -WA: White acrylic (flat) diffuser instead; will produce wide flood distribution	(Blank): None  <b>Mounting</b> -RH: Joist mounting hardware instead  <b>Other Options</b> -99: Special modification; consult factory -AWN: Athena Wireless Node; N/A for Dimming Options -D5, -D40, -ECO -FS: Fused primary; One per fixture -NAT: Modified for natatorium use -SH: Sealed housing and junction box  *Note: For other integrated control solutions, such as nLight, contact factory

## Dimensions

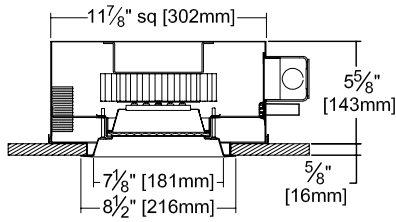

**Ceiling Cut-out**  
8 1/4" Dia.

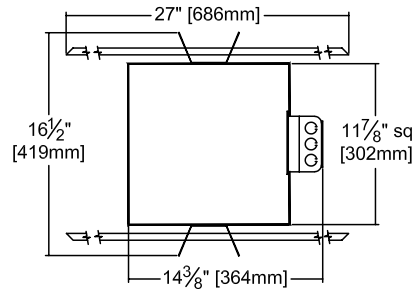

## Photometry - Installed Complete Fixture

LM-79 IESNA Certified Photometry from Independent Lab

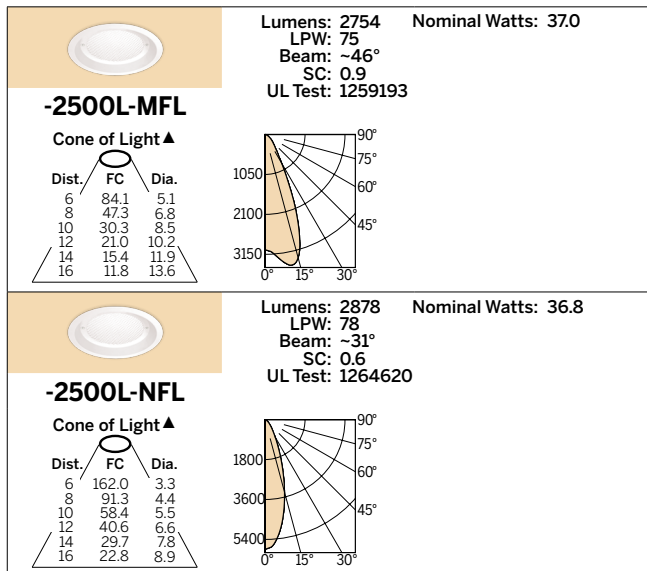

\* See notes on page 1 for additional info on Lumen Factors

LED manufacturers maintain a tolerance of +/-7% on flux (lumens) and power (electrical) measurements.

▲ **Cone of Light Key** Dist. Distance (Ft.) from fixture  
 Dia. (in ft.) shown is where FC FC Footcandles at nadir (0°)  
 value is half the FC at nadir. Dia. Circle of light at 50% of FC