

CATALOG #	TYPE	
JOB NAME	WATTAGE	VOLTAGE

8" LED 2450 LUMENS 38 SYSTEM WATTS LRS-08340

Regressed Lens LED Downlight • Square

50,000+ Hour Life (L70) • Sealed Housing Optional
LM-80 Qualified • LM-79 Certified Photometry

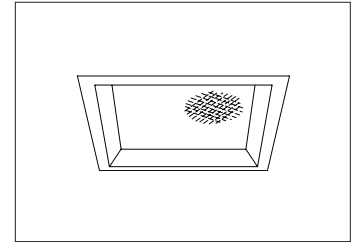

Specifications

LED Light Engine*

- 38 watt LED array. 3500°K standard (or see Option -41K).
- 2450* lumens, 65 lumens per watt (total system).
- 81 CRI, 50,000+ hour life (L70).**
- Fully sustainable: removable for servicing.

Thermal Management System

- All-aluminum proprietary heat sink, components and housing maximize cool operation and long life while minimizing maintenance.

LED Power Supply

- Suitable for outdoor / indoor use -30°C (-22°F) to 70°C (158°F).
- Specify 120V or 277V (50-60Hz). Load insensitive.
- 0-10 volt dimming standard.
- Kirlin remote SmartSupply™ driver instead (up to 6 luminaires). See Option -SS.

Thermal Protection

- Thermal protector (per current NEC)

provides automatic cut-off if rated temperature is exceeded. Must specify input voltage.

Trim Assembly

- Tapered aluminum all white smooth self-flanged trim.
- Clear specular Alzak reflector above.
- Regressed tempered, prismatic C#72 lens.

Acrylic Enamelled Aluminum Housing

- Rust proof and corrosion resistant: Exceeds 1000 hour ASTM 5% salt spray test.
- Shallow depth fits restricted plenums.
- Cool operation: Extends life of all components.
- Fully sustainable: Entire luminaire, including LED light engine, easily visible and serviced through aperture.
- Built-in plaster flange.
- Sealed housing design available, see -SH.

Outlet Box

- UL listed J-box with insulated removable cover. Prewired 14 GA (NEC) with 1/2" and 3/4" knockouts.

Installation

- Recesses indoor/outdoor in covered locations.
- Accommodates ceilings up to 1-1/8" thick or see Option -79.
- 27" galvanized hanger bars with adjustable mounting brackets (2) supplied.
- For residential mounting hardware for wood joist ceilings, see Option -RH.

UL C-UL (Canada) Listings

- Wet, damp or dry locations, covered ceilings.
- Through branch conductors (4 #12 AWG 90°C).

CE & FCC Compliance

- Certified to meet IES 60601-1-2 & EN 60601-1-2 electromagnetic compatibility standard for medical electrical equipment.
- FCC Part 15 certified for EMI/RFI emissions.



FIVE YEAR Limited Warranty

- Complete standard fixture.

Performance at a Glance

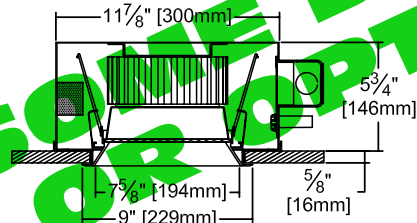

Ceiling Cut-out
8 1/2" Sq.

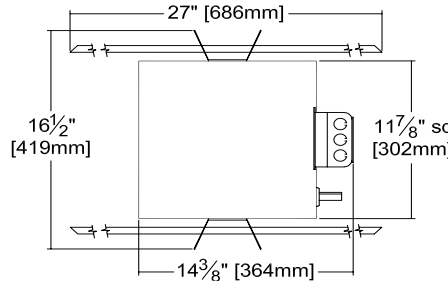

Lumens: 1756
Beam: ~87°
SC: 1.3
Efficiency: 71.5%
ITL Test: 69146

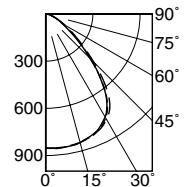

Exceptional Energy Efficiency

THE KIRLIN COMPANY

3401 EAST JEFFERSON AVENUE • DETROIT, MICHIGAN 48207-4232
(313) 259-6400 • Fax: (313) 259-9409 OR (313) 259-3121 • www.kirlinlighting.com

* See note next page
** See note next page

MAX. LUMENS MAX. SYSTEM WATTS CATALOG NUMBER

LED LIGHTING

2450

38

LRS-08340

Detailed Photometry - Installed Fixture

Photometry from I.T.L., Boulder, CO

Photometric testing done in accordance with IESNA LM-79-08

LRS-08340

Lumens: 1756
Beam: ~87°
SC: 1.3
Effic: 71.5%
ITL Test: 69146



Cone of Light ▲

Dist.	FC	Dia.
6	23.7	7.8
8	13.3	10.4
10	8.5	13.1
12	5.9	15.7
14	4.4	18.3
16	3.3	20.9

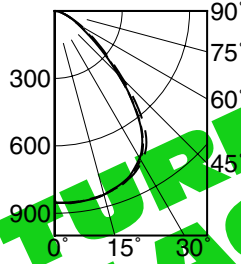

CANDLEPOWER DISTRIBUTION					
	0.0	22.5	45.0	67.5	90.0
0	853	853	853	853	853
5	853	851	854	856	858
15	844	846	846	846	846
25	806	809	811	804	802
35	682	696	711	692	677
45	402	417	431	415	398
55	193	208	208	198	179
65	83	85	91	87	86
75	34	34	32	33	33
85	5	5	5	5	5
90	0	0	0	0	0

LM-80 Qualified • LM-79 Certified Photometry

▲ Cone of Light Key

- Ft. Distance from fixture
 - FC Footcandles at nadir (0°)
 - Dia. Circle of light at 50% of FC
- Dia. (in ft.) shown is where FC value is half the FC at nadir.

* LED manufacturers maintain a tolerance of ±7% on flux (lumens) and power (electrical) measurements. Kirlin photometrics are actual test data from Independent Testing Laboratories (ITL).
** LED Operating Characteristics: 50,000 Hours at 70% lumen maintenance (L70)

Options

LED Power Supply

- 120 Power supply and thermal protector rated for 120V (50-60Hz) input.
- 277 Power supply and thermal protector rated for 277V (50-60Hz) input.
- 39 Specify "-39Lutron" for Hi-Lume 3 wire full range (0-100%) dimming power supply instead of standard 0-10V dimming.
- 98 347V 50 Hz. instead. Consult factory.
- EI Remote emergency inverter for 100% rated lumen output. Run time: 90 minutes. Not for use with -SS SmartSupply™ driver.

- SS Remote mounted Kirlin SmartSupply™ driver, sold separately. Drives up to 6 fixtures at 38 watts each. Order LPS-1220A (0-10V analog dimming) or LPS-1220D (DMX dimming). See kirlinlighting.com or consult factory for more information.

Color Temperature (CCT)

- 41K Color temperature 4100°K. Consult factory.

Lenses and Trims

- 45 Gasket between trim flange and ceiling.
- 46 Gasket between trim and lens.
- 94 Custom color/finish. Specify. Consult factory.

Other

- 79 Extension collar for ceilings up to 2" thick.
- 99 Special modification. Consult factory.
- RH Residential mounting hardware instead. Suitable for wood joist ceilings with spacing from 14 1/8" to 25 5/8" with 5/8" vertical adjustability.
- SH Sealed housing and junction box.

SUBMITTAL DATA

APPROVAL STAMP

JOB NAME _____
TYPE _____
WATTAGE _____ VOLTAGE _____
CATALOG NUMBER _____

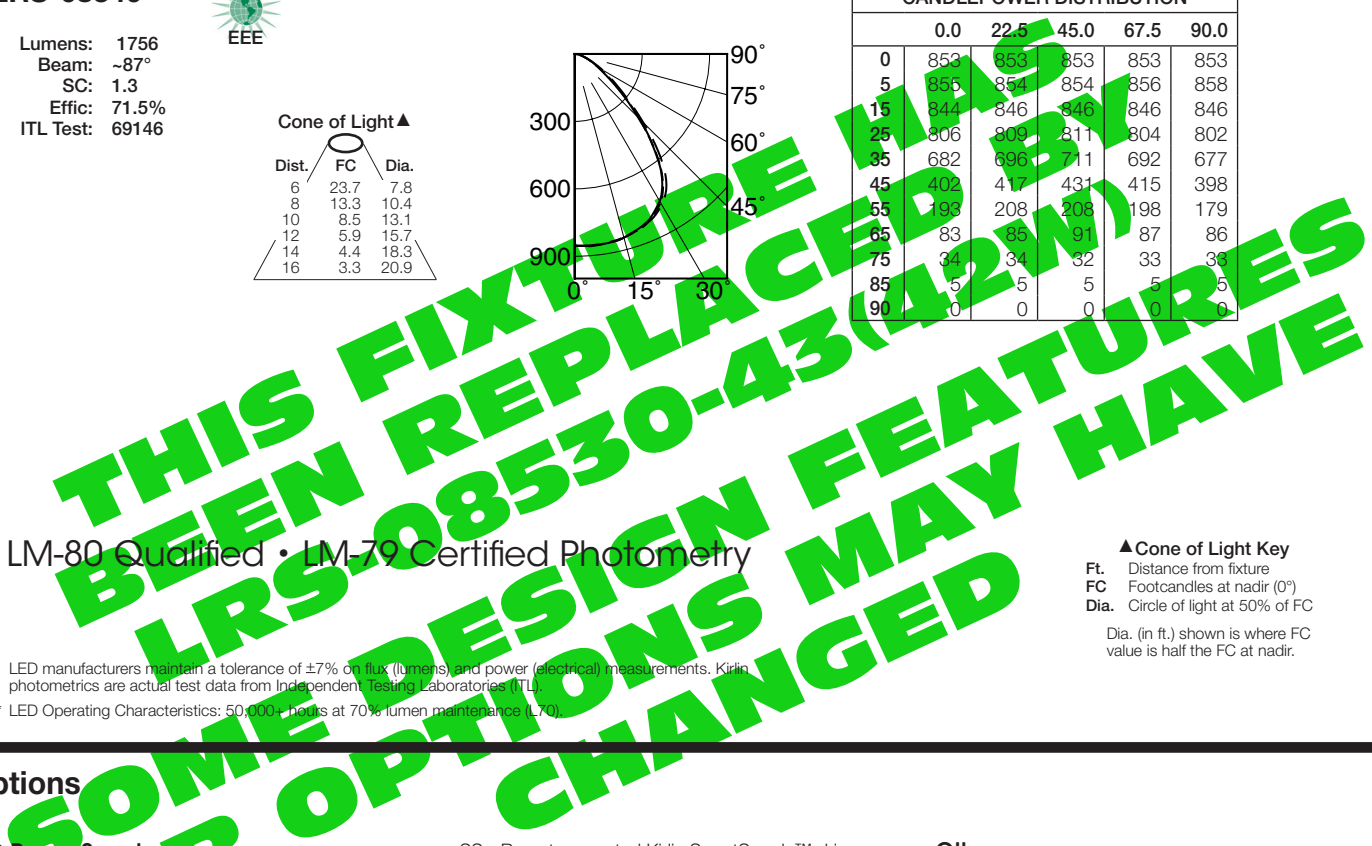

LIMITED WARRANTY: CATALOGED KIRLIN FIXTURES ARE WARRANTED FREE OF DEFECTS IN WORKMANSHIP OR MATERIAL FOR THREE YEARS FROM DATE OF PURCHASE. INSTALL TO N.E.C. IN NORMAL USE. Manufacturer of the option will replace or repair such fixture or refund the purchase price on presentation of proof of purchase and defective fixture at the offices of manufacturer within three years of original shipment. Liability of manufacturer is limited to the foregoing and manufacturer shall not be liable for any other damages, direct or indirect, sustained or suffered by purchaser or any person. This warranty is supplied in place of all other warranties, expressed or implied. Seller does not warrant as to merchantability or fitness for a particular use, nor will any oral statement constitute a warranty or amend this specific warranty. Abnormal use, abuse of the fixture, improper installation, or repair, or modification of the fixture without prior written authorization from the manufacturer will render the warranty void.