

CATALOG #	TYPE	
JOB NAME	WATTAGE	VOLTAGE

Latitudes Series

Open Appearance 6" Square • LED

Up to 60,000 Hour Rated Life • Wet Listed

LM-79 Certified • LM-80 Qualified

LRS-06505

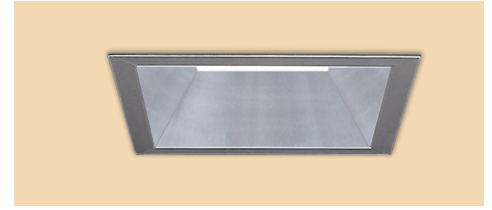

Specifications

Delivered System Performance

- Nominal Lumens: **Must Specify**

Non-IC
-6500L
-5000L
-3500L
-2500L

- Select trim & beam distribution: see chart
- Select color (CCT): see chart; 80+ CRI standard; Option -HC for 90+ (15% lumen loss)
- 60,000 Hour Rated Life (L70**)

Thermal Protection: SPECIFY VOLTAGE

- Thermal protector for insulation detection per UL/NEC Must specify input voltage

Thermal Management System

- Aluminum heat sink and components for cool operation, long life, and low maintenance

LED Driver - INTERNAL

- Indoor/Outdoor: -30°C to 60°C (-22°F to 140°F)

- 0-10V CCR 10% dimming standard
- 120-277V / 50-60 Hz standard; load insensitive

Trim Assembly

- Specular clear aluminum self-flanged square downlight cone with tempered glass above
- Optional colors and finishes available

Acrylic Enameled Aluminum Housing

- Rustproof and corrosion resistant: exceeds 1000 hour ASTM 5% salt spray test
- Shallow depth fits restricted plenums
- Cool operation extends component life
- Modular design; visible and fully serviceable through aperture
- Built-in plaster flange

Outlet Box (Galvanized)

- UL Listed, 14GA, insulated, removable cover
- 1/2" and 3/4" knockouts

Installation & Hardware

- Indoor/outdoor in ceilings up to 1/4" thick or see option -79
- Compatible with fire rated enclosures (by others)
- 27" hanger bars & adjusting brackets (2) supplied

UL, C-UL (Canada) Compliance

- UL Listed: wet, damp or dry locations, covered ceilings
- Through-branch conductors (4 #12 AWG 90°C)

IEC & FCC Compliance

- Meets IEC/EN 60601-1-2 electromagnetic compatibility standard for medical electrical equipment
- FCC Part 15 certified for EMI/RFI emissions

FIVE YEAR Limited Warranty

- Complete standard fixture

Options and Ordering Configuration

(Example: LRS-06505-5000L-120-NFL-30K-37F-RH-NAT)



Must Specify					Optional			
Model	Lumens	Volts	Beam	CCT† & CRI	Driver Options	Emergency Options	Trim Options	Other Options
LRS-06505								
	-6500L -5000L -3500L -2500L	-120 -277 -97†: Other Voltage	(Blank): MFL -SPT -NFL -MFL -WFL	(Blank): 3500°K, 80+ CRI 80+ CRI* -27K: 2700°K -30K: 3000°K -35K: 3500°K -41K: 4100°K -50K: 5000°K *Note: Lumen Factor = 0.93 for -27K 90+ CRI** -27K-HC: 2700°K -30K-HC: 3000°K -35K-HC: 3500°K -41K-HC: 4100°K -50K-HC: 5000°K **Note: Lumen Factor = 0.79 for -27K-HC; All Others = 0.85; consult factory	(Blank): Standard 0-10V CCR 10% dim -D1: 0-10V 1.0% dim -D2: 0-10V 0.1% dim -D3: DALI 1.0% dim -D4: DALI 100-0.1% dim -D5: DMX512A 0% dimming instead. Consult factory for -6500L lumen series -D40: -40°C (-40°F) driver; 0-10V 10% dim; -3500L or -2500L only -ECO: Digital driver for Lutron EcoSystem controls. Dims to 1% or consult factory; -3500L max	(Blank): None -EI: Remote emergency inverter for 40% of rated lumens for -6500 L, 50% for -5000L and -3500L. Not available for -2500L. Run time: 90+ minutes. 120 or 277V, 60 Hz input only. Specify voltage. Not for use with -FS. -EM: Internal emergency battery pack. Delivers 500 lumens. Run time 90+ minutes. CEC compliant; N/A for -6500L -ERH: Remote emergency battery pack; Delivers 1000 lumens; CEC Compliant; Run time: 90+ minutes	(Blank): Standard clear aluminum self-flanged downlight square with lens above Trim Finishes -30: All white acrylic enameled cone -31: White acrylic enameled cone flange -37F: Dark bronze enamel flange -38F: Black enamel flange -70: SofTex™ clear self-flanged cone -94: Custom color; consult factory Other Trim Features -23: Frosted microprismatic lens -32: White trim extender, specify OD -33: Decorative Glow Ring; see last page for details -45: Gasket between trim & ceiling -WA: White acrylic lens, will produce wide flood distribution	(Blank): None Mounting -79: Extension collar for ceilings up to 2" thick -RH: Joist mounting hardware instead Other Options -99: Special modification; consult factory -AWN: Athena Wireless Node; N/A for Dimming Options -D5, -D40, -ECO -FS: Fused primary; One per fixture; N/A for option -EI -NAT: Modified for natatorium use -SH: Sealed housing and junction box *Note: For other integrated control solutions, such as nLight, contact factory

Performance Factors

NOMINAL LUMENS	LUMEN FACTOR	NOMINAL WATTS	LPW FACTOR
-6500L	1.00	73.3	1.00
-5000L	0.79	59.6	0.97
-3500L	0.63	44.6	1.04
-2500L	0.48	36.7	0.96

Dimensions

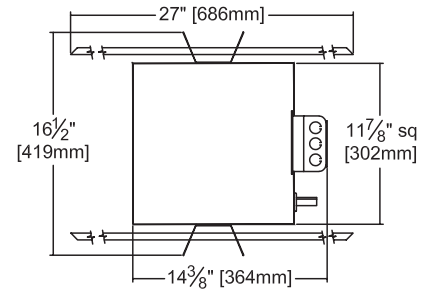
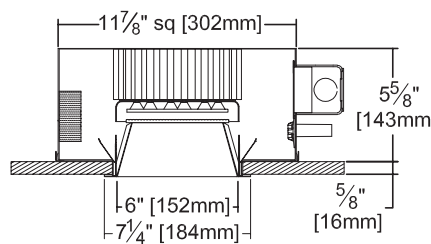

Ceiling Cut-out
6 3/4" Sq.

* See notes on page 1 for additional info on Lumen Factors

Photometry - Installed Complete Fixture

LM-79 IESNA Certified Photometry from Independent Lab

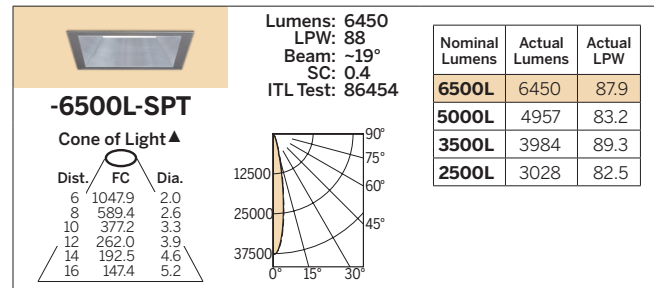
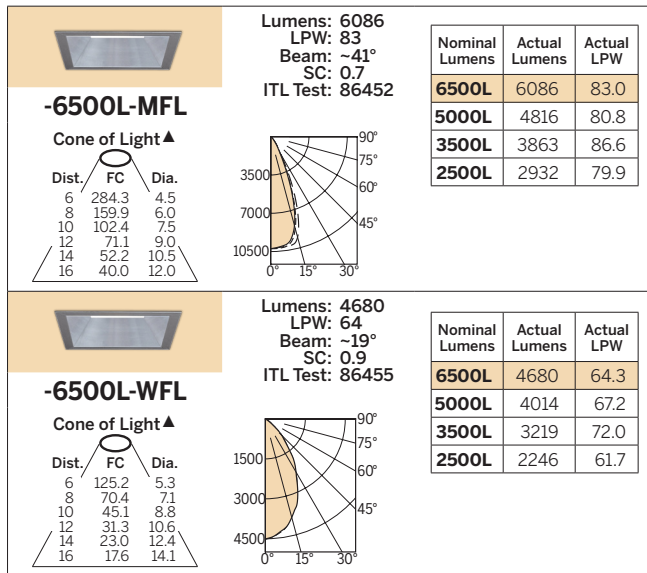

LED manufacturers maintain a tolerance of +/-7% on flux (lumens) and power (electrical) measurements.

▲ **Cone of Light Key** **Dist.** Distance (Ft.) from fixture
 Dia. (in ft.) shown is where FC **FC** Footcandles at nadir (0°)
 value is half the FC at nadir. **Dia.** Circle of light at 50% of FC

LIMITED WARRANTY: CATALOGED KIRLIN FIXTURES ARE WARRANTED FREE OF DEFECTS IN WORKMANSHIP OR MATERIAL FOR FIVE YEARS FROM DATE OF PURCHASE. INSTALLED TO N.E.C. IN NORMAL USE. Manufacturer at the option will replace or repair such fixture or refund the purchase price on presentation of proof of purchase and defective fixture at the office of manufacturer within the warranty period. This warranty is limited to the original purchaser and is not transferable. Liability of manufacturer is limited to the foregoing and manufacturer shall not be liable for any other damages, direct or indirect, sustained or suffered by purchaser or any person. This warranty is applied to the buyer in place of all other warranties, expressed or implied. Seller does not warrant as to merchantability or fitness for a particular use, nor will any oral statement constitute a warranty or amend this specific warranty. Abnormal use, abuse of the fixture, improper installation, or repair or modification of the fixture without prior written authorization from the manufacturer will render the warranty void.

Classic Glow Rings: Option -33 for Latitudes

To order a Kirlin Glow Ring, begin by adding -33 to the product number. Then, configure your Glow Ring by selecting each of the 7 design elements listed below:

(Example: LRS-06505-5000L-120-NFL-30K-33-GLM-1L-FRR-ROF-SIF-ROS-SIS)

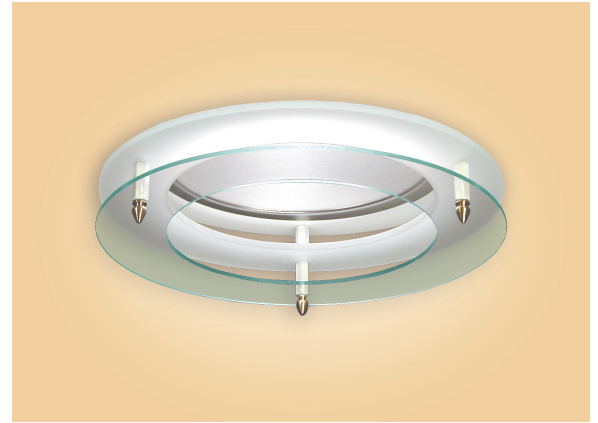

1. Ring Material
(choose one)

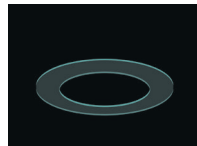

Glass (-GLM)



Acrylic (-ACM)



Custom (-CUM)

2. # of Rings
(choose one)



1 Ring (1L)

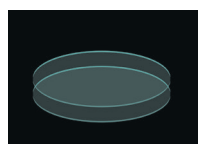

2 Rings (-2L)

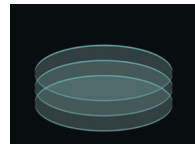

3 Rings (-3L)

3. Ring Design
(choose one)



Frosted Ring (-FRR)



Clear Ring (-CRR)

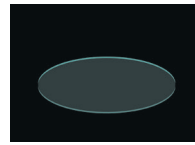

Solid Disk (-SDR)



Frosted Center (-FCR)



Frosted Disk (-FDR)

4. Finial Design
(choose one)

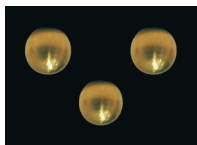

Round (-ROF)



Knurled (-KNF)

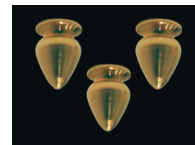

Cone (-COF)

5. Finial Color
(choose one)



Brass (-BRF)



Silver (-SIF)

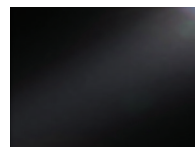

Black (-BLF)

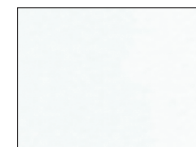

White (-WHF)



Custom (-CUF)

6. Standoff Design
(choose one)

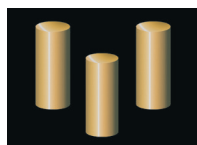

Round (-ROS)

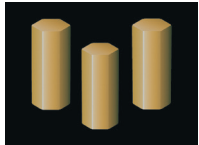

Hexagonal (-HOS)

7. Standoff Color
(choose one)



Brass (-BRS)



Silver (-SIS)



Black (-BLS)



White (-WHS)



Custom (-CFS)