

CATALOG #	TYPE	
JOB NAME	WATTAGE	VOLTAGE

6" LED 2450 LUMENS 38 SYSTEM WATTS

LRS-06330

Lensed LED Wall Wash • Square

50,000+ Hour Life (L70) • Sealed Housing Optional
LM-80 Qualified • LM-79 Certified Photometry

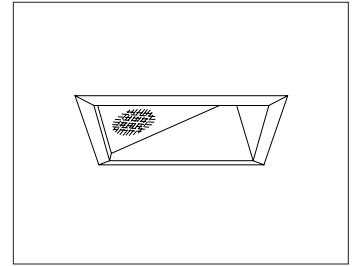

Specifications

LED Light Engine*

- 38 watt LED array. 3500°K standard (or see Option -41K).
- 2450* lumens, 65 lumens per watt (total system).
- 81 CRI, 50,000+ hour life (L70).**
- Fully sustainable: removable for servicing.

Thermal Management System

- All-aluminum proprietary heat sink, components and housing maximize cool operation and long life while minimizing maintenance.

LED Power Supply

- Suitable for outdoor / indoor use: -30°C (-22°F) to 70°C (158°F).
- Specify 120V or 277V (50-60Hz). Load insensitive.
- 0-10V dimming standard.
- Kirlin remote SmartSupply™ driver instead (up to 6 luminaires). See Option -SS.

Thermal Protection

- Thermal protector (per current NEC)

provides automatic cut-off if rated temperature is exceeded. Must specify input voltage.

Trim

- Specular clear aluminum self-flanged angle-cut cone with tempered prismatic C-73 lens above.
- Specular high efficiency reflector above.
- Optional colors and finishes available.

Acrylic Enameled Aluminum Housing

- Rustproof and corrosion resistant: Exceeds 1000 hour ASTM 5% salt spray test.
- Shallow depth fits restricted plenums.
- Cool operation: Extends life of all components.
- Fully sustainable: Entire luminaire including LED light engine, easily visible and serviced through aperture.
- Built-in plaster flange.
- Sealed housing design available, see -SH.

Outlet Box

- UL listed J-box with insulated removable cover. Prewired 14 GA (NEC) with 1/2" and 3/4" knockouts.

Installation

- Recesses indoor/outdoor in covered locations.
- Accommodates ceilings up to 1-1/8" thick.
- 27" galvanized hanger bars with adjustable mounting brackets (2) supplied.
- For residential mounting hardware for wood joist ceilings, see Option -PRT.
- Wet, damp or dry locations, covered ceilings.
- Through-branch conductors (4 #12 AWG 90°C).

UL, C-UL (Canada) Listings

- Certified to meet IES 60601-1-2 & EN 60601-1-2 electromagnetic compatibility standard for medical electrical equipment.
- FCC Part 15 certified for EMI/RFI emissions.

5 Year Limited Warranty

- Complete standard fixture.

Performance at a Glance

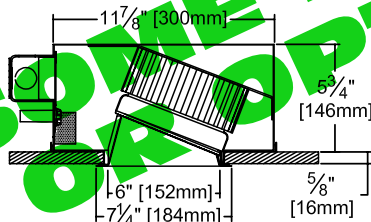

Ceiling Cut-out
6 3/4" Sq.

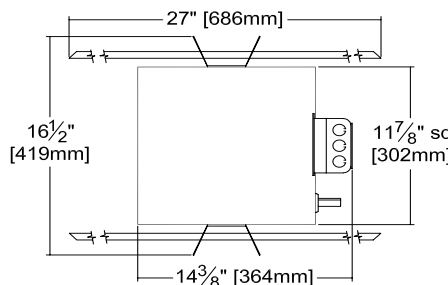

Lumens: 1568
Efficiency: 63.9%
ITL Test: 69144

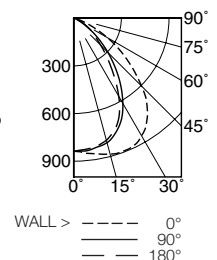

**Exceptional
Energy
Efficiency**

THE KIRLIN COMPANY

3401 EAST JEFFERSON AVENUE • DETROIT, MICHIGAN 48207-4232
(313) 259-6400 • Fax: (313) 259-9409 OR (313) 259-3121 • www.kirlinlighting.com

* See note next page
** See note next page

LED LIGHTING

MAX. LUMENS

2450

MAX. SYSTEM WATTS

38

CATALOG NUMBER

LRS-06330

DUE TO OUR CONTINUING EFFORT TO IMPROVE PRODUCTS, TECHNICAL INFORMATION IS SUBJECT TO CHANGE WITHOUT NOTICE. THE KIRLIN COMPANY EXPECTS PHOTOMETRIC PERFORMANCE TO IMPROVE SIGNIFICANTLY AND FREQUENTLY AS LED SOURCE TECHNOLOGY IMPROVES.

LRS-06330

6" LED 2450 LUMENS 38 SYSTEM WATTS

KIRLIN
 Since 1895

Detailed Photometry - Installed Fixture

Photometry from I.T.L., Boulder, CO

Photometric testing done in accordance with IESNA LM-79-08

LRS-06330

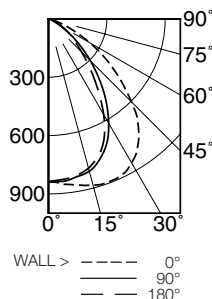
 Lumens: 1568
 Effic: 63.9%
 ITL Test: 69144

DISTANCE FROM CEILING IN FEET	SINGLE FIXTURE					MULTIPLE FIXTURES					
	1'	2'	3'	4'		2' CENTERS		3' CENTERS			
	FOOTCANDLE DISTRIBUTION ON WALL SURFACE										
1	45.6	24.1	6.6	2.0	0.8	42.8	42.8	25.9	34.4	18.6	34.4
2	61.8	42.7	17.5	5.5	1.9	88.7	88.8	88.8	64.8	54.1	64.8
3	38.9	31.1	17.6	8.2	3.4	79.2	79.3	79.3	52.1	53.5	52.1
4	22.5	19.5	13.2	7.7	4.1	58.7	58.8	58.8	38.3	39.3	38.3
5	13.6	12.3	9.3	6.2	3.9	42.5	42.6	42.6	27.6	28.2	27.6
6	8.7	8.1	6.6	4.9	3.4	32.5	32.6	32.6	20.9	21.4	20.9
7	6.0	5.7	4.9	3.6	2.8	25.6	25.7	25.7	16.8	16.8	16.6
8	4.1	4.2	3.9	2.7	2.4	21.4	21.5	21.5	13.7	13.8	13.7
9	2.8	3.4	3.1	2.7	2.1	18.6	18.9	18.9	11.8	12.0	11.8

LM-80 Qualified • LM-79 Certified Photometry

▲ Cone of Light Key

Ft. Distance from fixture
 FC Footcandles at nadir (0°)
 Dia. Circle of light at 50% of FC
 Dia. (in ft.) shown is where FC value is half the FC at nadir.

Options

LED Power Supply

- 120 Power supply and thermal protector rated for 120V (50-60Hz) input.
- 277 Power supply and thermal protector rated for 277V (50-60Hz) input.
- 39 Specify "-39Lutron" for Hi-Lume 3 wire full range (0-100%) dimming power supply instead of standard 0-10V dimming.
- 98 347V 50 Hz. instead. Consult factory.
- EI Remote emergency inverter for 100% rated lumen output. Run time: 90 minutes. Not for use with -SS SmartSupply™ driver.
- SS Remote mounted Kirlin SmartSupply™ driver, sold separately. Drives up to 6 fixtures at 38 watts each. Order LPS-1220A (0-10V analog

dimming) or LPS-1220D (DMX dimming). See kirlinlighting.com or consult factory for more information.

Color Temperature (CCT)

-41K Color temperature 4100°K. Consult factory.

Trims

- 30 All white acrylic enameled cone. (CP x .95)
- 31 White acrylic enameled cone flange.
- 32 White oversize trim ring. Specify O.D.
- 45 Gasket between trim flange and ceiling.
- 59 Dark Bronze specular self-flanged cone. (CP x .80)
- 60 Softex Dark Bronze self-flanged cone. (CP x .75)
- 63 Dune specular self-flanged cone. (CP x .93)
- 68 Matte black self-flanged cone. (CP x .70)
- 69 Wheat specular self-flanged cone. (CP x .92)

- 70 Softex Clear self-flanged cone. (CP x .93)
- 71 Softex Dune self-flanged cone. (CP x .89)
- 72 Black specular self-flanged cone. (CP x .80)
- 77 Softex Pewter self-flanged cone. (CP x .85)
- 91 Softex Wheat self-flanged cone. (CP x .88)
- 93 Pewter specular self-flanged cone. (CP x .88)
- 94 Custom color/finish. Specify. Consult factory.

Other

- 99 Special modification. Consult factory.
- RH Residential mounting hardware instead. Suitable for wood joist ceilings with spacing from 14 1/8" to 25 7/8" with 5/8" vertical adjustability.
- SH Sealed housing and junction box.

SUBMITTAL DATA

APPROVAL STAMP

JOB NAME

TYPE

WATTAGE

VOLTAGE

CATALOG NUMBER