

CATALOG #	TYPE
JOB NAME	VOLTAGE

Lensed 4" Square Wall Wash • LED • Type IC

1% Dimming • WFL • 3 CCT • 3-Step Binning
Integrated Module • LM-80 Qualified • LM-79 Photometry

LRS-04172-2000L
LRS-04172-1500L
LRS-04172-1100L



KIRLIN Select

Specifications

Delivered System Performance*

- Lumen Series: **MUST SPECIFY**
- 2000L: 2000 nominal lumens (20W).
- 1500L: 1500 nominal lumens (15W).
- 1100L: 1100 nominal lumens (11W).
- Color temperature: 3500°K standard.
- Optional: -30K.
- CRI: 80+.
- 50,000 hour life (L70**).
- Fully sustainable: removable for servicing.
- Center beam optics positioned at 30°.

Thermal Management System

- All aluminum heat sink, components and housing maximize cool operation and long life while minimizing maintenance.

LED Power Supply - INTERNAL

- 0-10V linear dimming standard. (100-1%)**
- 120-277V / 50-60Hz standard. Load insensitive or see Option -97.

- Suitable for outdoor / indoor use: -30°C (-22°F) to 60°C (140°F).

Trim Assembly

- White aluminum self-flanged angle cut cone with tempered prismatic glass lens above.

Acrylic Enameled Aluminum Housing

- Rustproof and corrosion resistant: Exceeds 1000 hour ASTM 5% salt spray test.
- Shallow depth fits restricted plenums.
- Cool operation: Extends life of all components.
- Entire luminaire is modular, easily visible and serviced through aperture.
- Built-in plaster flange.

Outlet Box

- UL listed J-box with insulated removable cover. Prewired 14 GA (NEC) with 1/2" and 3/4" knockouts.

Installation

- Recess indoor or outdoor.
- Accommodates ceilings up to 1-1/8" thick.
- Compatible with fire rated enclosures (by others).
- 27" galvanized hanger bars with adjustable mounting brackets (2) supplied.

UL, C-UL (Canada) Listings

- Wet, damp or dry locations, covered ceilings.
- Type IC: for direct contact with insulation.
- Through-branch conductors (4 #12 AWG 90°C) for Type IC Listing.

IEC & FCC Compliance

- Meets IEC/EN 60601-1-2 electromagnetic compatibility standard for medical electrical equipment.
- FCC Part 15 certified for EMI/RFI emissions.
- FIVE YEAR Limited Warranty**
- Complete standard fixture.

MUST SPECIFY	OPTIONAL	Ordering Example: LRS-04172-2000L-30K-FS
Product Number	Options	
LRS-04172-2000L LRS-04172-1500L LRS-04172-1100L	See "Options" below	

Options

LED Power Supply

- 97 Specify other voltage. Consult factory.
- EI Remote emergency inverter for 100% of rated lumens. Run time: 90+ minutes. 120 **or** 277V, 60Hz input only. Specify voltage. Not for use with Option -FS.

Color Temperature (CCT) - 35K Std.

- 30K Color temperature 3000°K instead.

Trim

- 31 White acrylic enameled flange. For use with optional trim finishes only.
- 32 White oversize trim ring. Specify O.D.
- 35F Silver acrylic enameled flange.
- 35T Silver acrylic enameled trim instead.
- 37F Dark bronze acrylic enameled flange.
- 37T Dark bronze acrylic enameled trim instead.
- 38F Black acrylic enameled flange.
- 38T Black acrylic enameled trim instead.
- 45 Gasket between trim flange and ceiling.
- 94 Custom color/finish. Specify. Consult factory.
- CF Custom color filter (Rosco). Specify.

Other

- 79 Extension collar for up to 2" thick ceiling.
- 99 Special modification. Consult factory.
- FS Single in-line fuse. Not for use with Option -EI.
- RH Residential mounting hardware instead. Suitable for wood joist ceilings with spacing from 14 1/8" to 25 1/8" with 5/8" vertical adjustability.
- NAT Modified for natatorium use.

Projected L70** for Kirlin Luminaires	
In Open Plenum	50,000 hours
In Insulation (Type IC)	50,000 hours

** Hours at 70% lumen maintenance

Dimensions

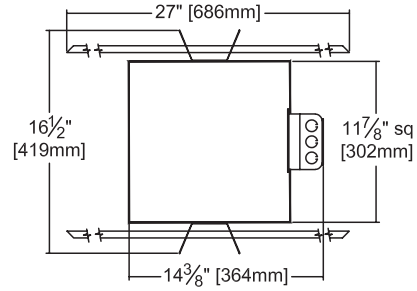
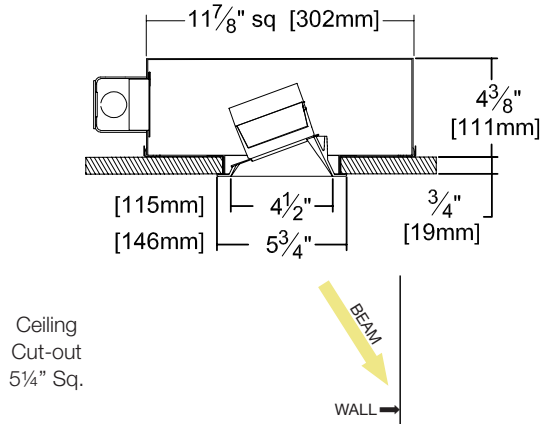

Detailed Photometry - Installed Fixture

Photometric testing done in accordance with IESNA LM-79

Photometry from I.T.L., Boulder, CO

-2000L (WFL)

Lumens: 1956
LPW: 97
Efficiency: 97.8%
ITL Test: 92141



Total System Watts 20.1

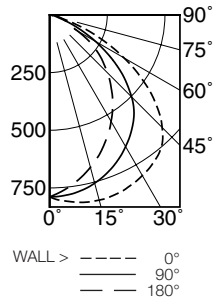

DISTANCE FROM CEILING IN FEET	SINGLE FIXTURE					MULTIPLE FIXTURES					
	1"	2"	3"	4"		2" CENTERS		3" CENTERS			
1	51.6	34.5	10.7	2.5	0.9	76.2	76.3	76.2	57.7	42.9	57.7
2	62.3	48.0	25.3	9.8	3.5	122.4	122.5	122.4	83.3	78.3	83.2
3	34.7	29.5	19.5	11.2	5.5	88.4	89.5	89.5	60.6	57.9	60.6
4	19.0	17.1	12.9	8.7	5.4	61.7	61.8	61.8	41.0	40.3	41.0
5	11.2	10.4	8.5	6.4	4.5	44.6	44.7	44.7	28.8	29.4	28.8
6	7.1	6.8	5.9	4.7	3.6	33.4	33.8	33.8	21.7	21.9	21.7
7	4.9	4.7	4.2	3.6	2.9	26.5	27.0	27.0	16.9	17.1	16.9
8	3.6	3.5	3.2	2.8	2.3	21.8	22.3	22.3	13.8	13.9	13.8
9	2.9	2.9	2.7	2.4	2.0	19.0	19.3	19.3	11.8	11.9	11.8

LUMEN SERIES	LUMEN FACTOR	WATTAGE FACTOR	LPW FACTOR
-1500L	0.75	0.75	1.00
-1100L	0.55	0.55	1.00

LM-80 Qualified • LM-79 Certified Photometry

* LED manufacturers maintain a tolerance of ±7% on flux (lumens) and power (electrical) measurements. Kirlin photometrics are actual test data from Independent Testing Laboratories (ITL) where photometry was measured from 2000 lumen (-2000L) light engines (within the established tolerance).

SUBMITTAL DATA

JOB NAME

TYPE

CATALOG NUMBER

VOLTAGE

APPROVAL STAMP



LIMITED WARRANTY: CATALOGED KIRLIN FIXTURES ARE WARRANTED FREE OF DEFECTS IN WORKMANSHIP OR MATERIAL FOR FIVE YEARS FROM DATE OF PURCHASE. INSTALLATION TO N.E.C. IN NORMAL USE. Manufacturer at the option will replace or repair such fixture or refund the purchase price on presentation of proof of purchase and defective fixture to the office of manufacturer within five years of original shipment. Liability of manufacturer is limited to the original purchase price and manufacturer shall not be liable for any other damages, direct or indirect, sustained or suffered by purchaser or any person. This warranty is subject to the buyer's acceptance of all other warranties, expressed or implied. Seller does not warrant as to merchantability or fitness for a particular use, nor will any oral statement constitute a warranty or amend this specific warranty. Abnormal use, abuse of the fixture, improper installation, or repair or modification of the fixture without prior written authorization from the manufacturer will render the warranty void.