

CATALOG #	TYPE	
JOB NAME	WATTAGE	VOLTAGE

Latitudes Series

Open Appearance 7" Downlight • LED

Up to 60,000 Hour Rated Life • Wet Listed

LM-79 Certified • LM-80 Qualified

LRR-07410



Specifications

Delivered System Performance

- Nominal Lumens: **Must Specify**

Non-IC
-6500L
-5000L
-3500L
-2500L

- Select trim & beam distribution: see chart
- Select color (CCT): see chart; 80+ CRI standard; Option -HC for 90+ (15% lumen loss)
- 60,000 Hour Rated Life (L70)

Thermal Protection: SPECIFY VOLTAGE

- Thermal protector for insulation detection per UL/NEC. Must specify input voltage

Thermal Management System

- Aluminum heat sink and components for cool operation, long life, and low maintenance

LED Driver - INTERNAL

- Indoor/Outdoor: -30°C to 60°C (-22°F to 140°F)

- 0-10V CCR 10% dimming standard
- 120-277V / 50-60 Hz standard; load insensitive

Trim Assembly

- Clear specular aluminum trim
- Self-flanged, low glare cone with lens above
- Optional colors and finishes available

Acrylic Enameled Aluminum Housing

- Rustproof and corrosion resistant: exceeds 1000 hour ASTM 5% salt spray test
- Shallow depth fits restricted plenums
- Cool operation extends component life
- Modular design; visible and fully serviceable through aperture
- Built-in plaster flange

Outlet Box (Galvanized)

- UL Listed, 14GA, insulated, removable cover
- ½" and ¾" knockouts

Installation & Hardware

- Indoor/outdoor in ceilings up to 1½" thick or see Option -79
- Compatible with fire rated enclosures (by others)
- 27" hanger bars & adjusting brackets (2) supplied

UL, C-UL (Canada)

- UL Listed: wet, damp or dry locations, covered ceilings
- Through-branch conductors (4 #12 AWG 90°C)

IEC & FCC Compliance

- Meets IEC/EN 60601-1-2 electromagnetic compatibility standard for medical electrical equipment
- FCC Part 15 certified for EMI/RFI emissions

FIVE YEAR Limited Warranty

- Complete standard fixture



Options and Ordering Configuration

(Example: LRR-07410-3500L-120-MFL-35K-30T-RH-NAT)

Must Specify					Optional			
Model	Lumens	Volts	Beam	CCT† & CRI	Driver Options	Emergency Options	Trim Options	Other Options
LRR-07410								
	-6500L -5000L -3500L -2500L	-120 -277 -97†: Other Voltage	(Blank): MFL -SPT -MFL -WFL	(Blank): 3500K, 80+ CRI 80+ CRI* -27K: 2700°K -30K: 3000°K -35K: 3500°K -41K: 4000°K -50K: 5000°K *Note: Lumen Factor = 0.93 for -27K 90+ CRI** -27K-HC: 2700°K -30K-HC: 3000°K -35K-HC: 3500°K -41K-HC: 4000°K -50K-HC: 5000°K **Note: Lumen Factor = 0.79 for -27K-HC; All Others = 0.85; Consult Factory	(Blank): Standard 0-10V CCR 10% dim -D1: 0-10V 1.0% dim -D2: 0-10V 0.1% dim -D3: DALI 1.0% dim -D4: DALI 100-0.1% dim -D5: DMX512A 0% dimming instead for -3500L or -2500L only -D40: -40°C (-40°F) driver; 0-10V 10% dim -ECO: Digital driver for Lutron EcoSystem controls. Dims to 1% or consult factory; -3500L max	(Blank): None -EI: Remote emergency inverter for 40% of rated lumens for -6500L, 50% for -5000L and -3500L. Not available for -2500L. Run time: 90+ minutes. 120 or 277V, 60 Hz input only. Not for use with -FS -EM: Internal emergency battery pack; Delivers 500 lumens; Run time: 90+ minutes -ERH: Remote emergency battery pack; Delivers 1000 lumens; CEC Compliant; Run time: 90+ minutes	(Blank): Standard clear specular trim; low glare cone with lens above Trim Finishes -30F: White enamel (flange only) -30T: White enamel (complete trim) -35F: Silver enamel (flange only) -35T: Silver enamel (complete trim) -37F: Dark bronze enamel (flange only) -37T: Dark bronze enamel (complete trim) -38F: Black enamel (flange only) -38T: Black enamel (complete trim) -70T: Clear semi-specular SofTex™ (complete trim) -94: Custom color; consult factory Other Trim Features -13: Clear poly lens below lens. Photometric distribution unaffected -23: Frosted microprismatic lens -32: White trim extender, specify OD -33: Decorative Glow Ring; see last page for details -45: Gasket between trim & ceiling -WA: White acrylic lens	(Blank): None Mounting -79: Extension collar for ceilings up to 2" thick -RH: Joist mounting hardware instead Other Options -99: Special modification; consult factory -AWN: Athena Wireless Node; N/A for Dimming Options -D5, -D40, -ECO -FS: Fused primary; One per fixture; N/A for option -EI -NAT: Modified for natorium use -SH: Sealed housing and junction box -TA: Top access for servicing from above ceiling *Note: For other integrated control solutions, such as nLight, contact factory

Performance Factors

NOMINAL LUMENS	LUMEN FACTOR	NOMINAL WATTS	LPW FACTOR
-6500L	1.00	72.7	1.00
-5000L	0.87	59.4	1.07
-3500L	0.67	44.7	1.08
-2500L	0.48	36.9	0.94

Dimensions

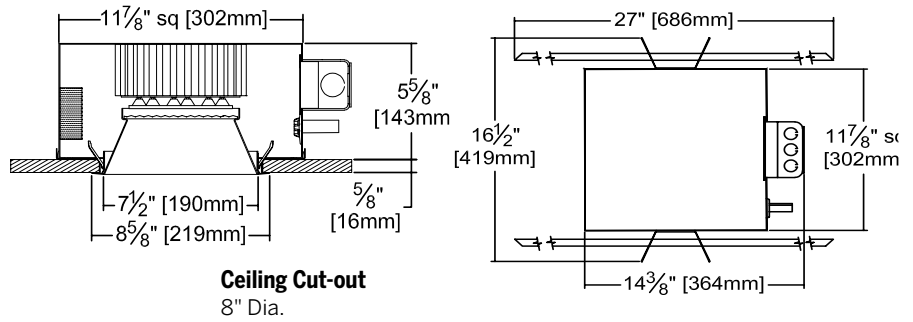

Ceiling Cut-out
8" Dia.

* See notes on page 1 for additional info on Lumen Factors

Photometry - Installed Complete Fixture

LM-79 IESNA Certified Photometry from Independent Lab

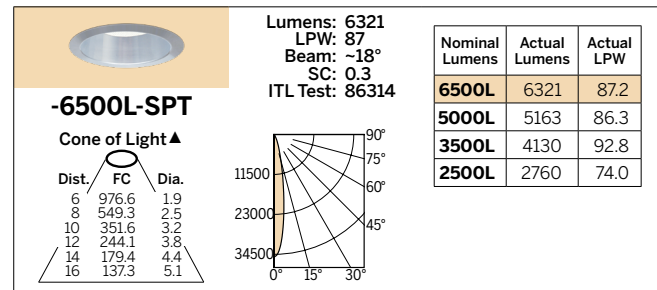
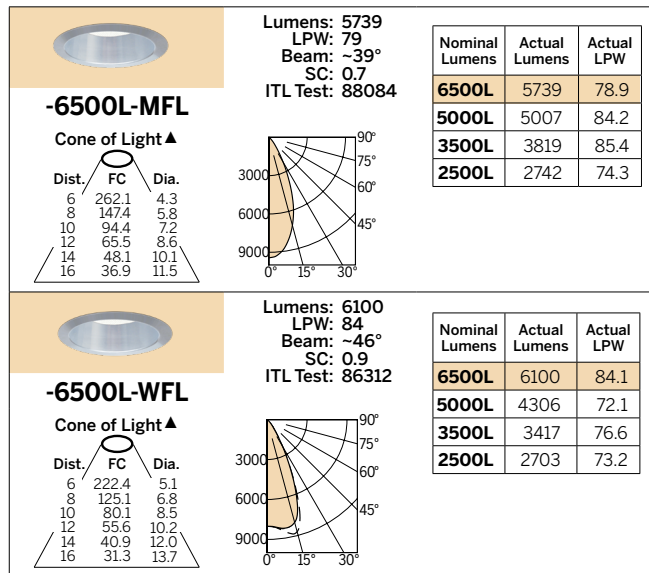

LED manufacturers maintain a tolerance of +/-7% on flux (lumens) and power (electrical) measurements.

▲ **Cone of Light Key** **Dist.** Distance (Ft.) from fixture
Dia. (in ft.) shown is where FC **FC** Footcandles at nadir (0°)
 value is half the FC at nadir. **Dia.** Circle of light at 50% of FC

Classic Glow Rings: Option -33 for Latitudes

To order a Kirlin Glow Ring, begin by adding -33 to the product number. Then, configure your Glow Ring by selecting each of the 7 design elements listed below:

(Example: LRR-07410-5000L-120-30K-WFL-33-GLM-1L-FRR-ROF-SIF-ROS-SIS)

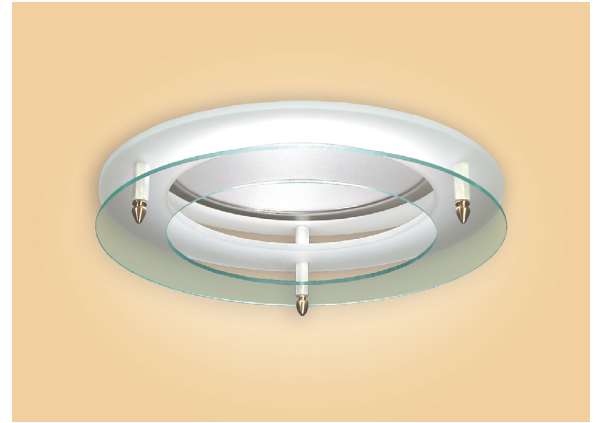

1. Ring Material
(choose one)

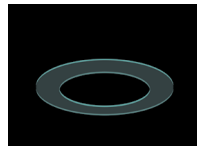

Glass (-GLM)

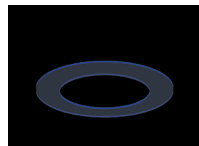

Acrylic (-ACM)



Custom (-CUM)

2. # of Rings
(choose one)

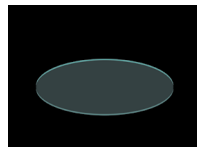

1 Ring (1L)

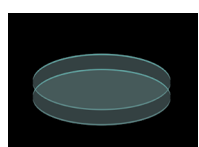

2 Rings (-2L)

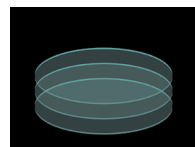

3 Rings (-3L)

3. Ring Design
(choose one)

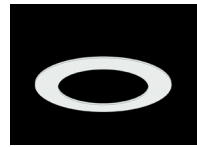

Frosted Ring (-FRR)



Clear Ring (-CRR)

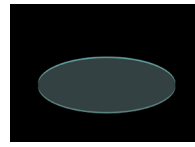

Solid Disk (-SDR)

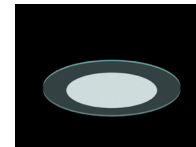

Frosted Center (-FCR)

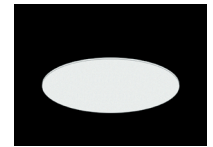

Frosted Disk (-FDR)

4. Finial Design
(choose one)

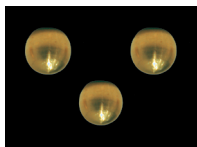

Round (-ROF)

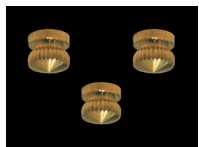

Knurled (-KNF)



Cone (-COF)

5. Finial Color
(choose one)



Brass (-BRF)



Silver (-SIF)



Black (-BLF)

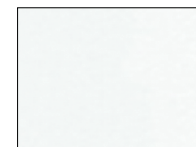

White (-WHF)



Custom (-CUF)

6. Standoff Design
(choose one)

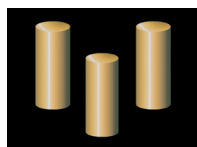

Round (-ROS)

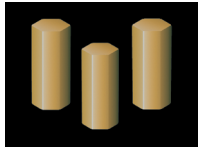

Hexagonal (-HOS)

7. Standoff Color
(choose one)



Brass (-BRS)



Silver (-SIS)



Black (-BLS)

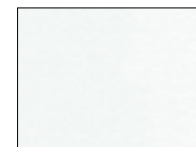

White (-WHS)



Custom (-CFS)