

CATALOG #	TYPE	
JOB NAME	WATTAGE	VOLTAGE

6" LED 2450 LUMENS 38 SYSTEM WATTS LRR-06301

Super Shallow Lensed Downlight

50,000+ Hour Life (L70) • Sealed Housing Optional
LM-80 Qualified • LM-79 Certified Photometry

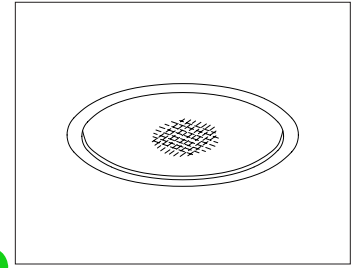

Specifications

LED Light Engine*

- 2450* lumens, 65 lumens per watt (total system).
- 38 watt LED array. 3500°K standard (or see Option -41K).
- 81 CRI, 50,000+ hour life (L70).**
- Fully sustainable: removable for servicing.

Thermal Management System

- All-aluminum proprietary heat sink, components and housing maximize cool operation and long life while minimizing maintenance.

LED Power Supply

- **0-10 volt dimming standard.**
- Specify 120V or 277V (50-60Hz). Load insensitive.
- Suitable for outdoor / indoor use: -30°C (-22°F) to 70°C (158°F).
- Kirlin remote SmartSupply™ driver instead (up to 6 luminaires). See Option -SS.

Thermal Protection

- Thermal protector (per current NEC) provides automatic cut-off if rated

temperature is exceeded. Must specify input voltage.

Trim Assembly

- White flat seamless aluminum, one piece self-flanged.
- Tempered prismatic G#73 spread distribution lens or see optional lenses.
- Gasketing available. See Options -45, -46.

Acrylic Enameled Aluminum Housing:

Super Shallow Depth

- Rustproof and corrosion resistant: Exceeds 1000 hour ASTM 5% salt spray test.
- Shallow depth fits restricted plenums.
- Cool operation: Extends life of all components.
- Fully sustainable: Entire luminaire, including LED light engine, easily visible and serviced through aperture.
- Built-in plaster flange.
- Sealed housing design available, see -SH.

Outlet Box

- UL listed J-box with removable cover.

Wired 14 GA (NEC) with eight 1/2" knockouts.

Installation

- Recesses indoor/outdoor in covered locations.
- Accommodates ceilings up to 1-1/8" thick.
- 27" galvanized hanger bars with adjustable mounting brackets (2) supplied.

UL, C-UL (Canada) Listings

- Wet, damp or dry locations, covered ceilings.
- Through-branch conductors (4 #12 AWG 90°C).

CE & FCC Compliance

- Certified to meet IES 60601-1-2 & EN 60601-1-2 electromagnetic compatibility standard for medical electrical equipment.
- FCC Part 15 certified for EMI/RFI emissions.

5 FIVE YEAR
year Limited Warranty

- Complete standard fixture.

Performance at a Glance

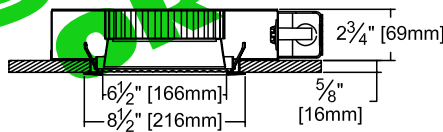

Ceiling Cut-out
8" Dia.

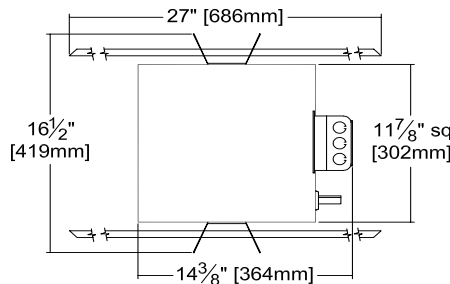

Lumens: 1927
Beam: ~67°
SC: 1.2
Effic: 78.6%
ITL Test: 72324

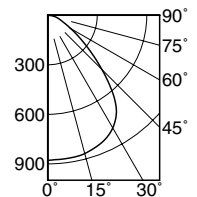

THE KIRLIN COMPANY

3401 EAST JEFFERSON AVENUE • DETROIT, MICHIGAN 48207-4232
(313) 259-6400 • Fax: (313) 259-9409 OR (313) 259-3121 • www.kirlinlighting.com

* See note next page
** See note next page

MAX. LUMENS MAX. SYSTEM WATTS CATALOG NUMBER

LED LIGHTING

2450

38

LRR-06301

DUE TO OUR CONTINUING EFFORT TO IMPROVE PRODUCTS, TECHNICAL INFORMATION IS SUBJECT TO CHANGE WITHOUT NOTICE. THE KIRLIN COMPANY EXPECTS PHOTOMETRIC PERFORMANCE TO IMPROVE SIGNIFICANTLY AND FREQUENTLY AS LED SOURCE TECHNOLOGY IMPROVES.

Detailed Photometry - Installed Fixture

Photometry from I.T.L., Boulder, CO

Photometric testing done in accordance with IESNA LM-79-08

LRR-06301

Lumens: 1927
Beam: ~67°
SC: 1.2
Effic: 78.6%
ITL Test: 72324

Cone of Light ▲

Dist.	FC	Dia.
6	24.4	7.9
8	13.7	10.5
10	8.8	13.1
12	6.1	15.7
14	4.5	18.3
16	3.4	21.0

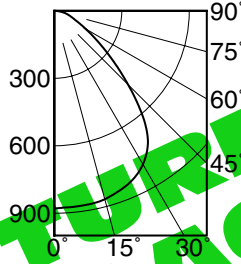

	CANDLEPOWER DISTRIBUTION				
	0.0	22.5	45.0	67.5	90.0
0	879	879	879	879	879
5	878	876	876	876	876
15	867	867	867	867	867
25	827	827	827	827	827
35	725	725	725	725	725
45	464	464	464	464	464
55	234	234	234	234	234
65	112	112	112	112	112
75	61	61	61	61	61
85	16	16	16	16	16
90	0	0	0	0	0

LM-80 Qualified • LM-79 Certified Photometry

▲ Cone of Light Key

- Ft. Distance from fixture
 - FC Footcandles at nadir (0°)
 - Dia. Circle of light at 50% of FC
- Dia. (in ft.) shown is where FC value is half the FC at nadir.

* LED manufacturers maintain a tolerance of ±7% on flux (lumens) and power (electrical) measurements. Kirlin photometrics are actual test data from Independent Testing Laboratories (ITL).
** LED Operating Characteristics: 50,000+ hours at 70% lumen maintenance (L70).

Options

LED Power Supply

- 120 Power supply and thermal protector rated for 120V (50-60Hz) input.
- 277 Power supply and thermal protector rated for 277V (50-60Hz) input.
- 39 Specify "-39Lutron" for Hi-Lume 3 wire full range (0-100%) dimming power supply instead of standard 0-10V dimming.
- 98 347V 50 Hz. instead. Consult factory for availability.
- EI Remote emergency inverter for 100% rated lumen output. Run time: 90 minutes. Not for use with -SS SmartSupply™ driver.

- SS Remote mounted Kirlin SmartSupply™ driver, sold separately. Drives up to 6 fixtures at 38 watts each. Order LPS-1220A (0-10V analog dimming) or LPS-1220D (DMX dimming). See kirlinighting.com or consult factory for more information.

Color Temperature (CCT)

- 41K Color temperature 4100°K. Consult factory.

Trims

- 13 Vandal resistant tempered prismatic C#73 spread lens above 1/8" flat polycarbonate.
- 17 .187" prismatic flat high strength acrylic.

- 18 Opal flat glass diffuser.
- 21 White flat polycarbonate diffuser.
- 32 White oversize trim ring. Specify O.D.
- 45 Gasket between ceiling and trim flange.
- 46 Gasket between trim and lens.
- 94 Custom color/finish. Specify. Consult factory.
- DF Electrically isolated "dead front" gasketed trim.

Other

- 99 Special modification. Consult factory.
- SH Sealed housing and junction box.

SUBMITTAL DATA

APPROVAL STAMP

JOB NAME _____
TYPE _____
WATTAGE _____ VOLTAGE _____
CATALOG NUMBER _____

THIS FIXTURE HAS BEEN REPLACED BY LRR-05440. SOME DESIGN FEATURES MAY HAVE CHANGED.

LIMITED WARRANTY: CATALOGED KIRLIN FIXTURES ARE WARRANTED FREE OF DEFECTS IN WORKMANSHIP OR MATERIAL FOR THREE YEARS FROM DATE OF PURCHASE. INSTALL TO N.E.C. IN NORMAL USE. Manufacturer of the option will replace or repair such fixture or refund the purchase price on presentation of proof of purchase and defective fixture at the offices of manufacturer within three years of original shipment. Liability of manufacturer is limited to the foregoing and manufacturer shall not be liable for any other damages, direct or indirect, sustained or suffered by purchaser or any person. This warranty is supplied in place of all other warranties, expressed or implied. Seller does not warrant as to merchantability or fitness for a particular use, nor will any oral statement constitute a warranty or amend this specific warranty. Abnormal use, abuse of the fixture, improper installation, or repair, or modification of the fixture without prior written authorization from the manufacturer will render the warranty void.