

CATALOG #	TYPE	
JOB NAME	WATTAGE	VOLTAGE

Latitudes Series

IP66 Rated 6" Downlight • LED

LM-79 Certified • LM-80 Qualified

Type IC • Wet Listed

Specifications

Delivered System Performance

- Nominal Lumens: **Must Specify**

Type-IC

-2000L

-1500L

-1100L

- Distribution: WFL
- Color temperature: 3500°K standard
- Optional: -30K; CRI 80+
- 50,000 Hour Rated Life (L70**)

Thermal Management System

- Aluminum heat sink and components for cool operation, long life, and low maintenance

LED Driver - INTERNAL

- Indoor/Outdoor: -30°C to 60°C (-22°F to 140°F)
- 0-10V linear dimming standard (100-1%)
- 120-277V / 50-60 Hz standard; load insensitive

Trim Assembly

- Smooth white seamless tapered aluminum self-flanged rigid cast trim (field paintable)
- High strength prismatic acrylic above .125" clear flat polycarbonate lens. Also see -DA
- Vandal and ligature resistant, see Option -25
- BioGard antimicrobial trim, see Option -BGT



IP66 Sealed and Gasketed Trim

- Silicone seal between trim and lens seals lens to trim
- Closed cell gasketing on trim flange seals flange to ceiling
- O-rings on stainless steel fasteners seal fasteners to trim
- Meets ASTM E283 restricted airflow of 2CFM maximum
- Compliant with NSF/ANSI 2

Acrylic Enameled Aluminum Housing

- Rustproof and corrosion resistant: exceeds 1000 hour ASTM 5% salt spray test
- Shallow depth fits restricted plenums
- Cool operation extends component life
- Modular design; visible and fully serviceable through aperture
- Built-in plaster flange

Outlet Box (Galvanized)

- UL Listed, 14GA, insulated, removable cover
- ½" and ¾" knockouts

LRR-06120



Installation & Hardware

- Indoor/outdoor in covered ceilings up to 1½" thick
- Compatible with fire rated enclosures (by others)
- 27" hanger bars & adjusting brackets (2) supplied
- For concrete housing, see Option -78

UL, C-UL (Canada) Listings

- UL Listed: wet, damp or dry locations, covered ceilings
- Type IC for direct contact with insulation
- Through-branch conductors (4 #12 AWG 90°C) for Type IC Listing

IEC & FCC Compliance

- Meets IEC/EN 60601-1-2 electromagnetic compatibility standard for medical electrical equipment
- FCC Part 15 certified for EMI/RFI emissions

FIVE YEAR Limited Warranty

- Complete standard fixture

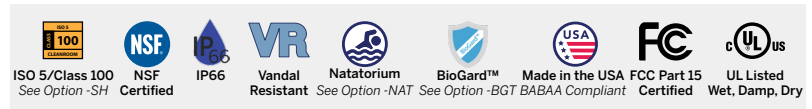

Options and Ordering Configuration

(Example: LRR-06120-1500L-120-WFL-30K-BN-25-SH)

Must Specify				Optional		
Model	Lumens	Volts	CCT [†] & CRI	Emergency Options	Trim Options	Other Options
LRR-06120						
	-2000L	(Blank): 120-277	(Blank): 3500K, 80+ CRI	(Blank): None	(Blank): White self-flanged downlight trim	(Blank): None
	-1500L					
	-1100L					
		-120	-30K: 3000°K	-EI: Remote emergency inverter for 100% rated lumens; 120 or 277V, 60 Hz input only. Specify voltage. Run time: 90+ minutes; N/A for option -FS	Trim Finishes	-78: Concrete pour housing with 2" collar
		-277	-35K: 3500°K		-35T: Silver enamel (complete trim) -BGT: BioGard™ anti-microbial white -BKBG: BioGard™ anti-microbial black -94: Custom color; consult factory -94BG: BioGard™ anti-microbial custom color finish -BN: Brushed nickel cast trim Other Trim Features -25: Vandal resistant trim, hardware and lensing. Provides ligature and vandal resistance. Not available with NSF rating -CF: Custom color filter (Rosco); Specify -DA: Diffuse acrylic lens above poly instead of prismatic acrylic	-99: Special modification; consult factory -FS: Fused primary; One per fixture; N/A for option -EI -NAT: Modified for natatorium use -SH: Sealed housing and junction box. Provides Cleanroom Rated luminaire (ISO 5 Class 100) Note: Housing depth increases to 5.66"
Projected L70** for Kirlin Luminaires						
In Open Plenum		50,000 hours				
In Insulation (Type IC)		50,000 hours				
**Hours at 70% lumen maintenance						

Dimensions

NOMINAL LUMENS	LUMEN FACTOR	NOMINAL WATTS	LPW FACTOR
-2000L	1.00	20.3	1.00
-1500L	0.75	15.2	1.00
-1100L	0.55	11.2	1.00

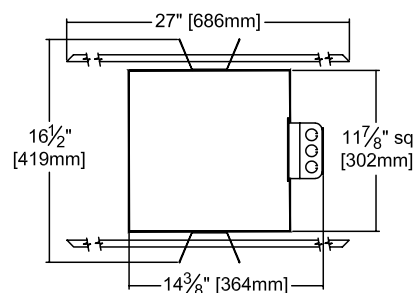
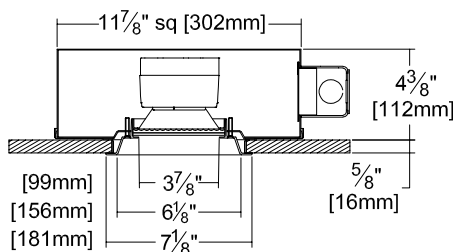

Ceiling Cut-out
6¾" Dia.

* See notes on page 1 for additional info on Lumen Factors

LM-79 IESNA Certified Photometry from Independent Lab

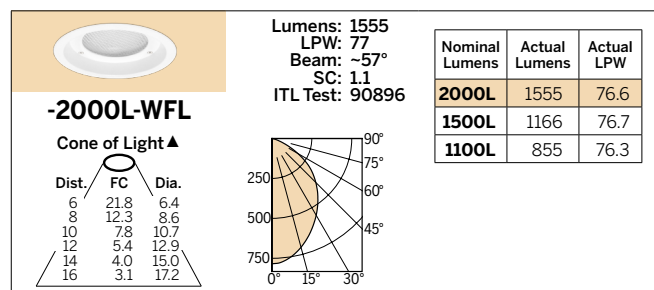

▲ **Cone of Light Key**
 Dia. (in ft.) shown is where FC value is half the FC at nadir.

Dist. Distance (Ft.) from fixture
FC Footcandles at nadir (0°)
Dia. Circle of light at 50% of FC

[illegible]