

CATALOG #	TYPE	
JOB NAME	WATTAGE	VOLTAGE

Latitudes Series

6" Downlight • LED • Type IC

LM-79 Certified • LM-80 Qualified



For
QuickShip see
GRR-06103¹



Specifications

Delivered System Performance

- Nominal Lumens: **Must Specify**

Type-IC

-2000L

-1500L

-1100L

- Distribution: WFL
- Color temperature: 3500°K standard
- Optional: -30K; CRI 80+
- 50,000 Hour Rated Life (L70**)

Thermal Management System

- Aluminum heat sink and components for cool operation, long life, and low maintenance

LED Driver - INTERNAL

- Indoor/Outdoor: -30°C to 60°C (-22°F to 140°F)
- 0-10V linear dimming standard (100-1%)
- 120-277V / 50-60 Hz standard; load insensitive or see Option -97

Trim Assembly

- White aluminum self-flanged downlight trim.
- Optional finishes available (field paintable)

Shallow 4¼" Aluminum Housing

- Rustproof and corrosion resistant: exceeds 1000 hour ASTM 5% salt spray test
- Shallow depth fits restricted plenums
- Cool operation extends component life
- Modular design; visible and fully serviceable through aperture
- Built-in plaster flange

Outlet Box (Galvanized)

- UL Listed, 14GA, insulated, removable cover
- ½" and ¾" knockouts

Installation & Hardware

- Indoor/outdoor in ceilings up to 1½" thick or see Option -79
- Compatible with fire rated enclosures (by others)

LRR-06103



- 27" hanger bars & adjusting brackets (2) supplied
- For concrete housing, see Option -78

UL, C-UL (Canada) Listings

- UL Listed: wet, damp or dry locations, covered ceilings
- Type IC for direct contact with insulation
- Through-branch conductors (4 #12 AWG 90°C) for Type IC Listing

IEC & FCC Compliance

- Meets IEC/EN 60601-1-2 electromagnetic compatibility standard for medical electrical equipment
- FCC Part 15 certified for EMI/RFI emissions

FIVE YEAR Limited Warranty

- Complete standard fixture

Options and Ordering Configuration

(Example: LRR-06103-1100L-277-WFL-30K-37F-RH-NAT)



Must Specify				Optional		
Model	Lumens	Volts	CCT [†] & CRI	Emergency Options	Trim Options	Other Options
LRR-06103						
	-2000L -1500L -1100L	(Blank): 120-277 -120 -277 -97[†]: Other Voltage	(Blank): 3500K, 80+ CRI -30K: 3000°K -35K: 3500°K	(Blank): None -EI: Remote emergency inverter for 100% rated lumens; Run time: 90+ minutes; 120 or 277V, 60 Hz input only. Specify voltage. N/A for option -FS	(Blank): White aluminum self-flanged downlight trim	(Blank): None
						Mounting
					Trim Finishes	-78: Concrete pour housing with 2" collar -79: Extension collar for ceilings up to 2" thick -RH: Joist mounting hardware instead
						Other Options
						-99: Special modification; consult factory -FS: Fused primary; One per fixture; N/A for option -EI
Projected L70** for Kirlin Luminaires						
In Open Plenum		50,000 hours				
In Insulation (Type IC)		50,000 hours				
**Hours at 70% lumen maintenance						
		†Consult factory				

Performance Factors

NOMINAL LUMENS	LUMEN FACTOR	NOMINAL WATTS	LPW FACTOR
-2000L	1.00	19.9	1.00
-1500L	0.75	14.9	1.00
-1100L	0.55	10.9	1.00



For
QuickShip see
GRR-06103¹

* See notes on page 1 for additional info on Lumen Factors

Dimensions

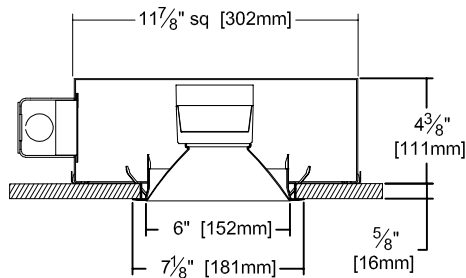

Ceiling Cut-out
6 1/2" Dia.

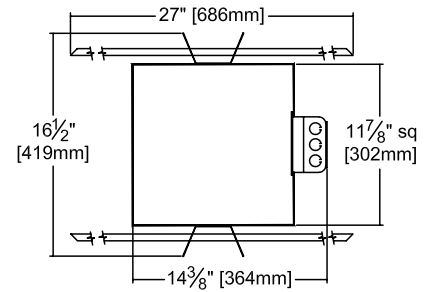

Photometry - Installed Complete Fixture

LM-79 IESNA Certified Photometry from Independent Lab

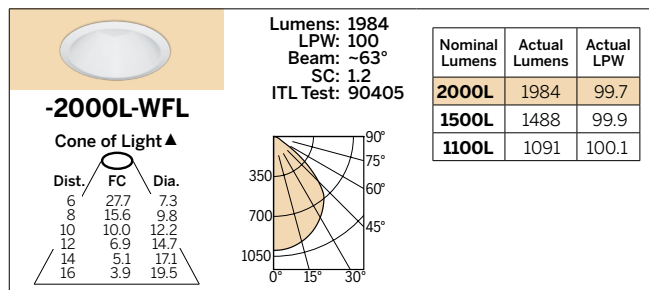

UNITED WARRANTY CATALOGUE. RULIN IS A **WARRANTED FREE OF DEFECTS IN WORKMANSHIP OR MATERIAL FOR FIVE YEARS FROM DATE OF PURCHASE**. INSTALLED TO N.E.C. IN NORMAL USE. Manufacturer at this option will replace or repair such failure or defect at the purchase price on presentation of proof of purchase and defective nature at the offices of manufacturer within five years of original shipment. Liability of manufacturer is limited to the foregoing and manufacturer shall not be liable for any other damages, direct or indirect, sustained or suffered by purchaser or any person. This warranty shall apply to the buyer in place of all other warranties, expressed or implied. Seller does not warrant as to merchantability or fitness for a particular use, nor will any oral statement constitute a warranty or amend this specific warranty. Abnormal use, abuse of the future, improper installation or repair, or modification of the future without prior written authorization from the manufacturer will render the warranty void.

¹See GRR-06103 specification sheet or "Gazelle Express Program" brochure for complete details. Limited option availability

LED manufacturers maintain a tolerance of +/-7% on flux (lumens) and power (electrical) measurements.

▲ Cone of Light Key

Dia. (in ft.) shown is where FC value is half the FC at nadir.

Dist. Distance (Ft.) from fixture

FC Footcandles at nadir (0°)
Dia. Circle of light at 50% of FC