

CATALOG #	TYPE	
JOB NAME	WATTAGE	VOLTAGE

# Latitudes Series

## Super Shallow Lensed Downlight • LED

Up to 60,000 Hour Rated Life • Wet Listed

LM-79 Certified • LM-80 Qualified

# LRR-05440



## Specifications

### Delivered System Performance

- Nominal Lumens: **Must Specify**

#### Non-IC -2500L

- Select trim & beam distribution: see chart
- Select color (CCT): see chart; 80+ CRI standard; Option -HC for 90+ (15% lumen loss)
- 60,000 Hour Rated Life (L70)

### Thermal Protection: SPECIFY VOLTAGE

- Thermal protector for insulation detection per UL/NEC. Must specify input voltage

### Thermal Management System

- Aluminum heat sink and components for cool operation, long life, and low maintenance

### LED Driver - INTERNAL

- Indoor/Outdoor: -30°C to 60°C (-22°F to 140°F)
- 0-10V CCR 10% dimming standard
- 120-277V / 50-60 Hz standard; load insensitive

### Trim Assembly

- High efficiency reflector
- Frosted microprismatic tempered lens at ceiling, or see Options
- White flat seamless aluminum one piece self-flanged trim (field paintable)
- Gasketing available. See Options -45, -46

### Acrylic Enameled Aluminum Housing

- Rustproof and corrosion resistant: exceeds 1000 hour ASTM 5% salt spray test
- Shallow depth fits restricted plenums
- Cool operation extends component life
- Modular design; visible and fully serviceable through aperture
- Built-in plaster flange

### Outlet Box (Galvanized)

- UL Listed J-box with removable cover. Prewired 14 GA (NEC) with eight 1/2" knockouts

### Installation & Hardware

- Indoor/outdoor in ceilings up to 1 1/8" thick
- Compatible with fire rated enclosures (by others)
- 27" hanger bars & adjusting brackets (2) supplied

### UL, C-UL (Canada)

- UL Listed: wet, damp or dry locations, covered ceilings
- Through-branch conductors (4 #12 AWG 90°C)

### IEC & FCC Compliance

- Meets IEC/EN 60601-1-2 electromagnetic compatibility standard for medical electrical equipment
- FCC Part 15 certified for EMI/RFI emissions

### FIVE YEAR Limited Warranty

- Complete standard fixture

## Options and Ordering Configuration

(Example: LRR-05440-2500L-120-WFL-30K-45-NAT)



Must Specify					Optional			
Model	Lumens	Volts	Beam	CCT† & CRI	Driver Options	Emergency Options	Trim Options	Other Options
LRR-05440	-2500L	-120 -277 -97†: Other Voltage	(Blank): WFL  -WFL	(Blank): 3500K, 80+ CRI  <b>80+ CRI*</b> -27K: 2700°K -30K: 3000°K -35K: 3500°K -41K: 4000°K -50K: 5000°K  *Note: Lumen Factor = 0.93 for -27K  <b>90+ CRI**</b> -27K-HC: 2700°K -30K-HC: 3000°K -35K-HC: 3500°K -41K-HC: 4000°K -50K-HC: 5000°K  **Note: Lumen Factor = 0.79 for -27K-HC; All Others = 0.85; Consult Factory	(Blank): Standard 0-10V CCR 10% dim  -D1: 0-10V 1.0% dim  -ECO: Digital driver for Lutron EcoSystem controls. Dims to 1% or consult factory. Requires 5" deep housing, including plaster flange depth	(Blank): None  -ERH: Remote emergency battery pack; Delivers 1000 lumens; CEC Compliant; Run time: 90+ minutes	(Blank): Standard clear specular cone; microprismatic lens  <b>Trim Finishes</b> -35T: Silver enamel (complete trim) -37T: Dark bronze enamel (complete trim) -38T: Black enamel (complete trim) -94: Custom color; consult factory  <b>Other Trim Features</b> -32: White trim extender, specify OD -33: Decorative Glow Ring; see last page for details -45: Gasket between trim & ceiling -46: Gasket between trim & lens -DF: Electrically isolated "dead front" gasketed trim. Also requires option -45 -WA: White acrylic lens; will produce wide flood distribution	(Blank): None  <b>Other Options</b> -99: Special modification; consult factory -FS: Fused primary; One per fixture -NAT: Modified for natatorium use -SH: Sealed housing and junction box -TA: Top access for servicing from above ceiling

## Dimensions

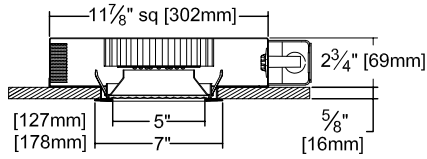

**Ceiling Cut-out**  
6 1/2" Dia.

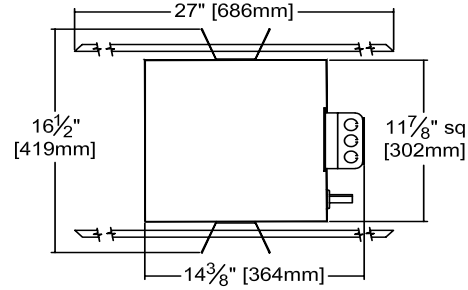

\* See notes on page 1 for additional info on Lumen Factors

## Photometry - Installed Complete Fixture

LM-79 IESNA Certified Photometry from Independent Lab

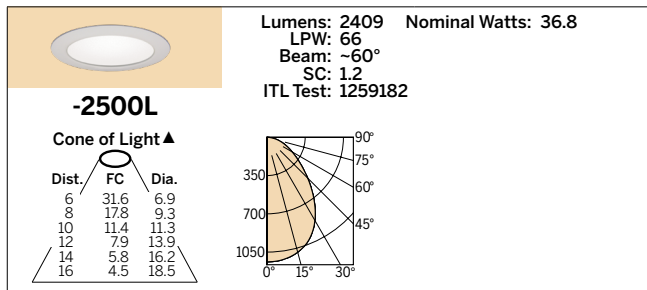

LED manufacturers maintain a tolerance of +/-7% on flux (lumens) and power (electrical) measurements.

▲ **Cone of Light Key**    Dist. Distance (Ft.) from fixture  
Dia. (in ft.) shown is where FC    FC Footcandles at nadir (0°)  
value is half the FC at nadir.    Dia. Circle of light at 50% of FC

# Classic Glow Rings: Option -33 for Latitudes

To order a Kirlin Glow Ring, begin by adding -33 to the product number. Then, configure your Glow Ring by selecting each of the 7 design elements listed below:

**(Example: LRR-05440-2500L-120-30K-WFL-33-GLM-1L-FRR-ROF-SIF-ROS-SIS)**

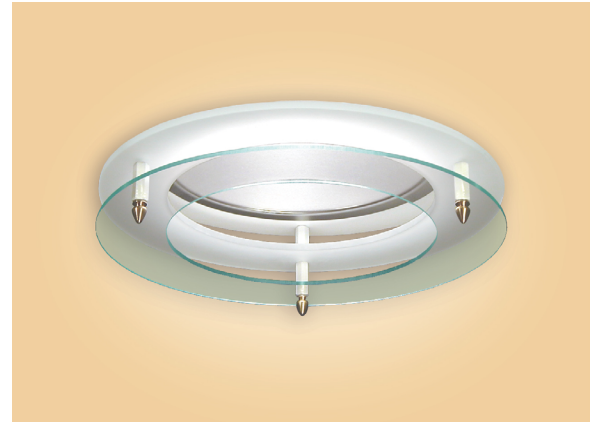

1. Ring Material  
(choose one)

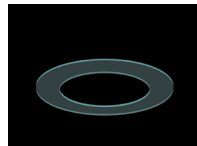

Glass (-GLM)

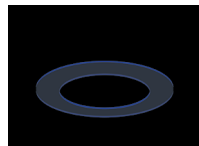

Acrylic (-ACM)



Custom (-CUM)

2. # of Rings  
(choose one)

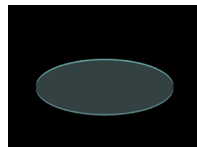

1 Ring (1L)

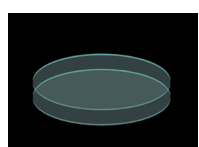

2 Rings (-2L)

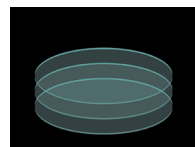

3 Rings (-3L)

3. Ring Design  
(choose one)



Frosted Ring (-FRR)

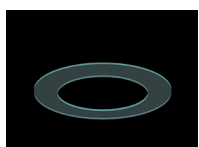

Clear Ring (-CRR)

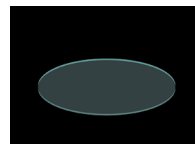

Solid Disk (-SDR)

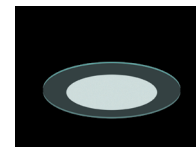

Frosted Center (-FCR)

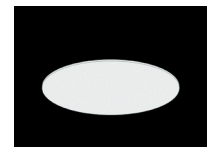

Frosted Disk (-FDR)

4. Finial Design  
(choose one)

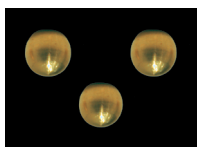

Round (-ROF)

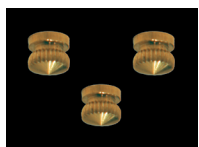

Knurled (-KNF)

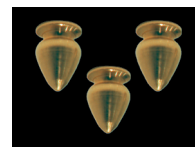

Cone (-COF)

5. Finial Color  
(choose one)



Brass (-BRF)



Silver (-SIF)



Black (-BLF)

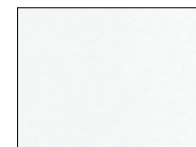

White (-WHF)



Custom (-CUF)

6. Standoff Design  
(choose one)

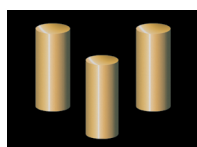

Round (-ROS)

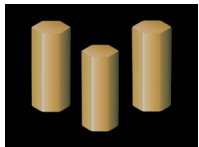

Hexagonal (-HOS)

7. Standoff Color  
(choose one)



Brass (-BRS)



Silver (-SIS)



Black (-BLS)

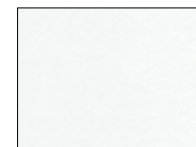

White (-WHS)



Custom (-CFS)