

CATALOG #	TYPE
JOB NAME	VOLTAGE

“Dead Front” LED Showerlight • 5” • Type IC

LRR-05010-1500L
LRR-05010-1000L

Up to 90,000 Hour Life • Air Tight Optional • Wet Location
10% Dimming • 5 CCT • 3-Step Binning
LM-80 Qualified • LM-79 Certified



Specifications

Delivered System Performance*

- Lumen Series: **MUST SPECIFY**
- 1500L: 1500 nominal lumens (20W).
- 1000L: 1000 nominal lumens (11W).
- Color temperature: 3500°K standard. Optional: -27K, -30K, -41K or -50K.
- CRI: 80+ standard. Optional: -HC (90+).
- 90,000 hour life (L70**).
- Fully sustainable: removable for servicing.

Thermal Management System

- All aluminum heat sink, components and housing maximize cool operation and long life while minimizing maintenance.

LED Power Supply - INTERNAL

- Suitable for outdoor / indoor use: -30°C (-22°F) to 60°C (140°F).
- 120-277V / 50-60Hz standard. Load insensitive.
- 0-10V CCR dimming standard. (100-10%)**

Trim Assembly

- Electrically non-conducting “dead front” design.
- Rustproof. Gasketed.
- White polycarbonate trim with radial clear polycarbonate lens.

Acrylic Enameled Aluminum Housing

- Rustproof and corrosion resistant: Exceeds 1000 hour ASTM 5% salt spray test.
- Shallow depth fits restricted plenums.
- Cool operation: Extends life of all components.
- Entire luminaire, including LED light engine, is modular, easily visible and serviced through aperture.
- Built-in plaster flange.

Outlet Box

- UL listed J-box with insulated removable cover. Prewired 14 GA (NEC) with ½” and ¾” knockouts.

Installation

- Recess indoor or outdoor.

- Accommodates ceilings up to 1-1/8” thick.
- Compatible with fire rated enclosures (by others).
- 27” galvanized hanger bars with adjustable mounting brackets (2) supplied.

UL, C-UL (Canada) Listings

- Wet, damp or dry locations, covered ceilings.
- Type IC: for direct contact with insulation.
- Through-branch conductors (4 #12 AWG 90°C) for Type IC Listing.

IEC & FCC Compliance

- Meets IEC/EN 60601-1-2 electromagnetic compatibility standard for medical electrical equipment.
- FCC Part 15 certified for EMI/RFI emissions.



**FIVE YEAR
Limited Warranty**

- Complete standard fixture.

MUST SPECIFY		OPTIONAL	Ordering Example: LRR-05010-1500L-120-30K-32
Product Number	Voltage	Options	
LRR-05010-1500L LRR-05010-1000L	-120 (120 volts) -277 (277 volts) -97 (Specify other)	See “Options” below	

Options

Input Power: SPECIFY

- 120 120V (50-60Hz) input.
- 277 277V (50-60Hz) input.
- 97 Specify other voltage. Consult factory.

LED Power Supply

- D1 0-10V 1.0% dimming instead.
- D2 0-10V 0.1% dimming instead.
- EI Remote emergency inverter for 100% of rated lumens. Run time: 90+ minutes. 120 or 277V, 60 Hz input only. Specify voltage. Not for use with Options -FS.
- ERH REMOTE emergency battery pack. Delivers 1000 lumens. Run time: 90+ minutes. CEC Compliant.

Color (CCT and CRI)

- 27K Color temperature 2700°K instead.
- 30K Color temperature 3000°K instead.
- 41K Color temperature 4100°K instead.
- 50K Color temperature 5000°K instead.
- HC 90+ CRI instead. Consult factory.

Lens and Trim

- 32 White oversize trim ring. Specify O.D.

Other

- 79 Extension collar for ceilings up to 2” thick.
- 99 Special modification. Consult factory.
- AT Air tight version. Meets ASTM E283 restricted airflow of 2 CFM maximum.
- FS Single in-line fuse. Not for use with Option -EI.

- RH Residential mounting hardware instead. Suitable for wood joist ceilings with spacing from 14 ½” to 25 ½” with ½” vertical adjustability.

Projected L70** for Kirlin Luminaires	
In Open Plenum	90,000 hours
In Insulation (Type IC)	60,000 hours

**Hours at 70% lumen maintenance

LRR-05010-1500L

PERFORMANCE



Lighting the Future Since 1895

Dimensions

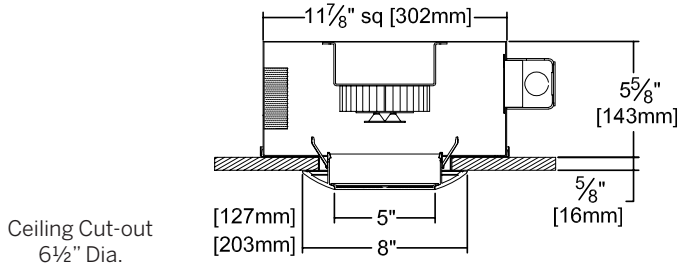

Ceiling Cut-out
6 1/2" Dia.

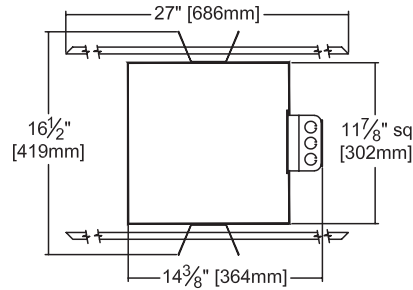

Detailed Photometry - Installed Fixture

Photometric testing done in accordance with IESNA LM-79

Photometry from I.T.L., Boulder, CO

-1500L STANDARD (MFL)

Lumens: 1078
Beam: ~41°
SC: 0.7
LPW: 52
Efficiency: 53.3%
ITL Test: 87222



Cone of Light ▲

Dist.	FC	Dia.
6	17.9	4.5
8	10.1	5.9
10	6.5	7.4
12	4.5	8.9
14	3.3	10.4
16	2.5	11.9

Total System Watts 20.9

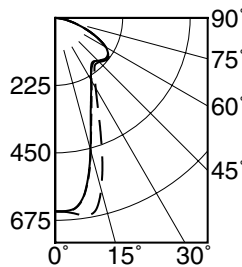

	CANDLEPOWER DISTRIBUTION				
	0.0	22.5	45.0	67.5	90.0
0	645	645	645	645	645
5	643	648	653	648	642
15	457	520	592	526	455
25	287	309	339	310	283
35	211	219	229	218	208
45	201	205	208	204	202
55	214	217	219	217	216
65	155	155	154	153	154
75	67	68	69	68	67
85	11	11	11	11	11
90	0	0	0	0	0

LUMEN SERIES	LUMEN FACTOR	WATTAGE FACTOR	LPW FACTOR
-1000L	0.579	0.495	1.17

LM-80 Qualified • LM-79 Certified Photometry

* LED manufacturers maintain a tolerance of ±7% on flux (lumens) and power (electrical) measurements. Kirlin photometrics are actual test data from Independent Testing Laboratories (ITL) where photometry was measured from 2022 lumen (-1500L) light engines (within the established tolerance).

▲ Cone of Light Key
Dia. (in ft.) shown is where FC value is half the FC at nadir.

Dist. Distance (Ft.) from fixture
FC Footcandles at nadir (0°)
Dia. Circle of light at 50% of FC

SUBMITTAL DATA

JOB NAME

TYPE

VOLTAGE

CATALOG NUMBER

APPROVAL STAMP



LIMITED WARRANTY: CATALOGED KIRLIN FIXTURES ARE WARRANTED FREE OF DEFECTS IN WORKMANSHIP OR MATERIAL FOR FIVE YEARS FROM DATE OF PURCHASE. INSTALLATION TO N.E.C. IN NORMAL USE. Manufacturer at the option will replace or repair such fixture or refund the purchase price on presentation of proof of purchase and defective fixture at the offices of manufacturer within five years of original shipment. Liability of manufacturer is limited to the foregoing, and manufacturer shall not be liable for any other damages, direct or indirect, sustained or suffered by purchaser or any person. This warranty is applied to the buyer in place of all other warranties, expressed or implied. Seller does not warrant as to merchantability or fitness for a particular use, nor will any oral statement constitute a warranty or amend this specific warranty. Abnormal use, abuse of the fixture, improper installation, or repair or modification of the fixture without prior written authorization from the manufacturer will render the warranty void.