

CATALOG #	TYPE	
JOB NAME	WATTAGE	VOLTAGE

Latitudes Series

Lensed 4" Wall Wash • LED • Type IC

LM-79 Certified • LM-80 Qualified

LRR-04137

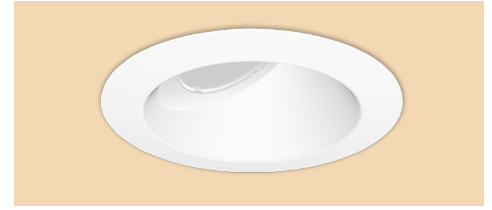

Specifications

Delivered System Performance

- Nominal Lumens: **Must Specify**

Type-IC

-2000L

-1500L

-1100L

- Color temperature: 3500°K standard
-Optional: -30K; CRI 80+
- 50,000 Hour Rated Life (L70**)
- Center beam optics positioned at 30°

Thermal Management System

- Aluminum heat sink and components for cool operation, long life, and low maintenance

LED Driver - INTERNAL

- Indoor/Outdoor: -30°C to 60°C (-22°F to 140°F)
- 0-10V linear dimming standard (100-1%)
- 120-277V / 50-60 Hz standard; load insensitive or see Option -97



Trim Assembly

- White aluminum self-flanged angle cut cone with tempered prismatic glass lens above

Acrylic Enameled Aluminum Housing

- Rustproof and corrosion resistant: exceeds 1000 hour ASTM 5% salt spray test
- Shallow depth fits restricted plenums
- Cool operation extends component life
- Modular design; visible and fully serviceable through aperture
- Built-in plaster flange

Outlet Box (Galvanized)

- UL Listed, 14GA, insulated, removable cover
- 1/2" and 3/4" knockouts

Installation & Hardware

- Indoor/outdoor in ceilings up to 1 1/8" thick
- Compatible with fire rated enclosures (by others)
- 27" hanger bars & adjusting brackets (2) supplied

UL, C-UL (Canada) Listings

- UL Listed: wet, damp or dry locations, covered ceilings
- Type IC for direct contact with insulation
- Through-branch conductors (4 #12 AWG 90°C) for Type IC Listing

IEC & FCC Compliance

- Meets IEC/EN 60601-1-2 electromagnetic compatibility standard for medical electrical equipment
- FCC Part 15 certified for EMI/RFI emissions

FIVE YEAR Limited Warranty

- Complete standard fixture

Options and Ordering Configuration

(Example: LRR-04137-2000L-120-38F-RH-NAT)



Must Specify				Optional						
Model	Lumens	Volts	CCT† & CRI	Emergency Options	Trim Options	Other Options				
LRR-04137	-2000L -1500L -1100L	(Blank): 120-277 -120 -277 -97†: Other Voltage	(Blank): 3500K, 80+ CRI -30K: 3000°K -35K: 3500°K	(Blank): None -EI: Remote emergency inverter for 100% rated lumens; Run time: 90+ minutes; 120 or 277V, 60 Hz input only. Specify voltage. N/A for option -FS	(Blank): White aluminum self-flanged cone with tempered prismatic glass lens Trim Finishes -31: White acrylic enameled flange. For use with optional trim finishes only -32: White trim extender, specify OD -35F: Silver enamel (flange only) -37F: Dark bronze enamel (flange only) -38F: Black enamel (flange only) -70: SofTex™ clear self-flanged cone -94: Custom color; consult factory Other Trim Features -45: Gasket between trim & ceiling -CF: Custom color filter (Rosco); Specify	(Blank): None Mounting -RH: Joist mounting hardware instead Other Options -99: Special modification; consult factory -FS: Fused primary; One per fixture; N/A for option -EI				
<p>Projected L70** for Kirlin Luminaires</p> <table border="1"> <tr> <td>In Open Plenum</td> <td>50,000 hours</td> </tr> <tr> <td>In Insulation (Type IC)</td> <td>50,000 hours</td> </tr> </table> <p>**Hours at 70% lumen maintenance</p> <p>†Consult factory</p>							In Open Plenum	50,000 hours	In Insulation (Type IC)	50,000 hours
In Open Plenum	50,000 hours									
In Insulation (Type IC)	50,000 hours									

Performance Factors

NOMINAL LUMENS	LUMEN FACTOR	NOMINAL WATTS	LPW FACTOR
-2000L	1.00	20.1	1.00
-1500L	0.75	15.1	1.00
-1100L	0.55	11.1	1.00

Dimensions

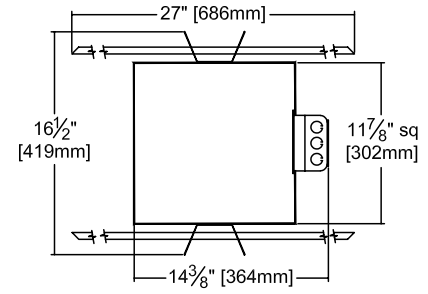
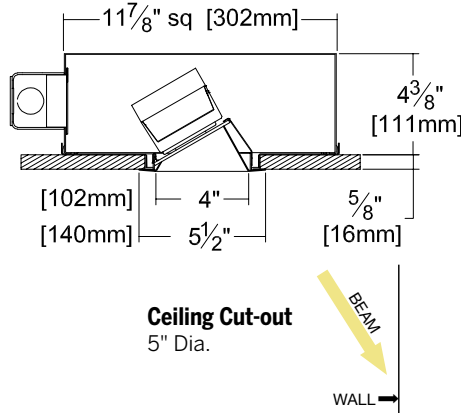

* See notes on page 1 for additional info on Lumen Factors

Photometry - Installed Complete Fixture

LM-79 IESNA Certified Photometry from Independent Lab

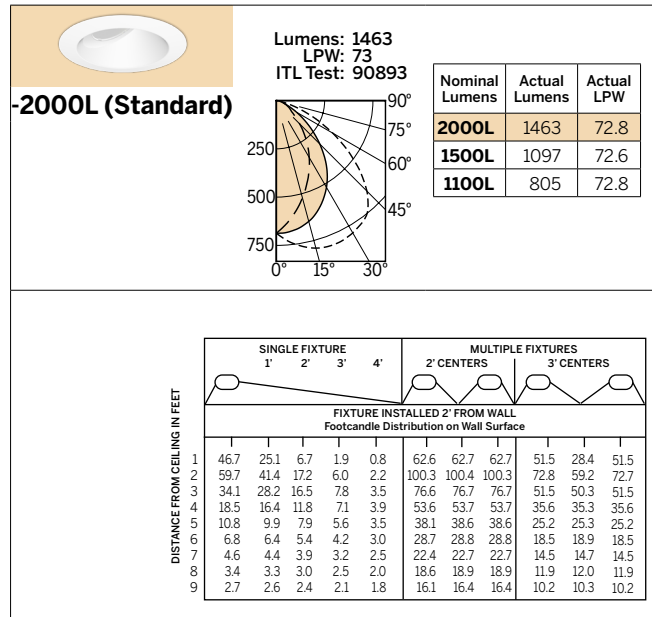

LED manufacturers maintain a tolerance of +/-7% on flux (lumens) and power (electrical) measurements.

LED manufacturers maintain a tolerance of +/-7% on flux (lumens) and power (electrical) measurements.

▲ **Cone of Light Key** **Dist.** Distance (Ft.) from fixture
 Dia. (in ft.) shown is where FC **FC** Footcandles at nadir (0°)
 value is half the FC at nadir. **Dia.** Circle of light at 50% of FC

LIMITED WARRANTY: CATALOGED KIRLIN FIXTURES ARE WARRANTED FREE OF DEFECTS IN WORKMANSHIP OR MATERIAL FOR FIVE YEARS FROM DATE OF PURCHASE. INSTALLED TO N.E.C. IN NORMAL USE. Manufacturer at the option will replace or repair such fixture or refund the purchase price on presentation of proof of purchase and defective fixture at the offices of manufacturer within the years of original shipment. Liability of manufacturer is limited to the foregoing and manufacturer shall not be liable for any other damages, direct or indirect, sustained or suffered by purchaser or any person. This warranty is applied to the buyer in place of all other warranties, expressed or implied. Seller does not warrant as to merchantability or fitness for a particular use, nor will any oral statement constitute a warranty or amend this specific warranty. Abnormal use, abuse of the fixture, improper installation, or repair or modification of the fixture without prior written authorization from the manufacturer will render the warranty void.