

CATALOG #	TYPE	
JOB NAME	WATTAGE	VOLTAGE

Kirlin Select Series

4" Downlight • LED • Type IC

LM-79 Certified • LM-80 Qualified

LRR-04102



Specifications

Delivered System Performance

- Nominal Lumens: **Must Specify**
Type-IC
-2000L
-1500L
-1100L
- Distribution: WFL
- Color temperature: 3500°K standard
 -Optional: -30K, -40K; CRI 80+
- 50,000 hour rated life (L70**)

Thermal Management System

- Aluminum heat sink and components for cool operation, long life, and low maintenance

LED Driver - INTERNAL

- Indoor/Outdoor: -30°C to 60°C (-22°F to 140°F)
- 0-10V linear dimming standard (100-1%)
- 120-277V / 50-60 Hz standard; load insensitive or see Option -97

Trim Assembly

- White aluminum self-flanged downlight trim.
 Optional finishes available (field paintable)

Acrylic Enameled Aluminum Housing

- Rustproof and corrosion resistant: exceeds 1000 hour ASTM 5% salt spray test
- Shallow depth fits restricted plenums
- Cool operation extends component life
- Modular design; visible and fully serviceable through aperture
- Built-in plaster flange

Outlet Box (Galvanized)

- UL Listed, 14GA, insulated, removable cover
- ½" and ¾" knockouts

Installation & Hardware

- Indoor/outdoor in ceilings up to 1½" thick or see Option -79
- Compatible with fire rated enclosures (by others)
- 27" hanger bars & adjusting brackets (2) supplied
- For concrete housing, see Option -78

UL, C-UL (Canada) Listings

- UL Listed: wet, damp or dry locations, covered ceilings
- Type IC for direct contact with insulation
- Through-branch conductors (4 #12 AWG 90°C) for Type IC Listing

IEC & FCC Compliance

- Meets IEC/EN 60601-1-2 electromagnetic compatibility standard for medical electrical equipment
- FCC Part 15 certified for EMI/RFI emissions

FIVE YEAR Limited Warranty

- Complete standard fixture

Options and Ordering Configuration

(Example: LRR-04102-1500L-120-WFL-30K-30F-RH-NAT)



Must Specify				Optional						
Model	Lumens	Volts	CCT† & CRI	Emergency Options	Trim Options	Other Options				
LRR-04102	-2000L -1500L -1100L	(Blank): 120-277 -120 -277 -97†: Other Voltage	(Blank): 3500K, 80+ CRI -30K: 3000°K -35K: 3500°K -40K: 4000°K	(Blank): None -EI: Remote emergency inverter for 100% rated lumens; Run time: 90+ minutes; 120 or 277V, 60 Hz input only. Specify voltage. N/A for option -FS	(Blank): White self-flanged downlight trim Trim Finishes -30F: White enamel (flange only) -35F: Silver enamel (flange only) -35T: Silver enamel (complete trim) -37F: Dark bronze enamel (flange only) -37T: Dark bronze enamel (complete trim) -38F: Black enamel (flange only) -38T: Black enamel (complete trim) -70T: Clear semi-specular SofTex™ (complete trim) -94: Custom color; consult factory Other Trim Features -32: White trim extender, specify OD -45: Gasket between trim & ceiling -CF: Custom color filter (Rosco); Specify	(Blank): None Mounting -78: Concrete pour housing with 2" collar -79: Extension collar for ceilings up to 2" thick -RH: Joist mounting hardware instead Other Options -99: Special modification; consult factory -FS: Fused primary; One per fixture; N/A for option -EI -NAT: Modified for natatorium use				
Projected L70** for Kirlin Luminaires <table border="1"> <tr> <td>In Open Plenum</td> <td>50,000 hours</td> </tr> <tr> <td>In Insulation (Type IC)</td> <td>50,000 hours</td> </tr> </table>				In Open Plenum	50,000 hours	In Insulation (Type IC)	50,000 hours			
In Open Plenum	50,000 hours									
In Insulation (Type IC)	50,000 hours									
**Hours at 70% lumen maintenance										
				†Consult factory						

Performance Factors

NOMINAL LUMENS	LUMEN FACTOR	NOMINAL WATTS	LPW FACTOR
-2000L	1.00	20.3	1.00
-1500L	0.75	15.2	1.00
-1100L	0.55	11.2	1.00



For QuickShip see GRR-04102¹

Dimensions

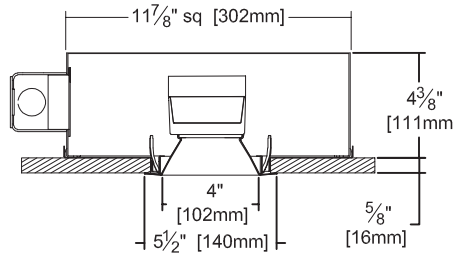

Ceiling Cut-out
5" Dia.

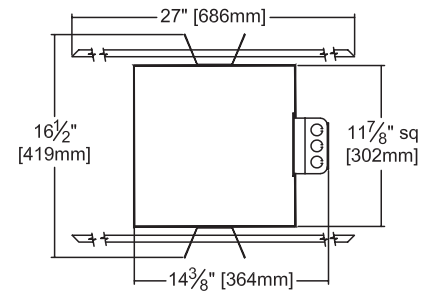

* See notes on page 1 for additional info on Lumen Factors

Photometry - Installed Complete Fixture

LM-79 IESNA Certified Photometry from Independent Lab

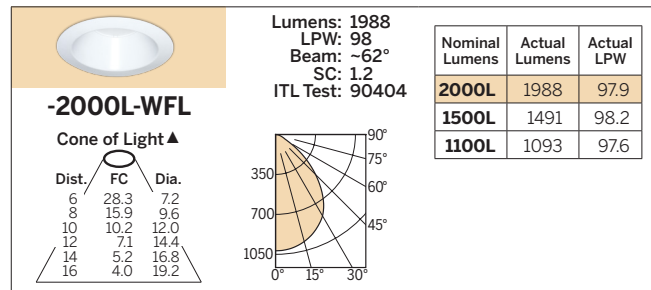

¹See GRR-04102 specification sheet or "Gazelle Express Program" brochure for complete details. Limited option availability

LED manufacturers maintain a tolerance of +/-7% on flux (lumens) and power (electrical) measurements.

▲ Cone of Light Key
Dia. (in ft.) shown is where FC value is half the FC at nadir.

Dist. Distance (Ft.) from fixture
FC Footcandles at nadir (0°)
Dia. Circle of light at 50% of FC

LIMITED WARRANTY: CATALOGUED KIRLIN FIXTURES ARE WARRANTED FREE OF DEFECTS IN WORKMANSHIP OR MATERIAL FOR FIVE YEARS FROM DATE OF PURCHASE. INSTALLATION, IN NORMAL USE. Manufacturer at the option will replace or repair such fixture or refund the purchase price on presentation of proof of purchase and defective fixture to the office of manufacturer within the warranty period. Liability of manufacturer is limited to the foregoing and manufacturer shall not be liable for any other damages, direct or indirect, sustained or suffered by purchaser or any person. This warranty is applied to the buyer in place of all other warranties, expressed or implied. Seller does not warrant as to merchantability or fitness for a particular use, nor will any oral statement constitute a warranty or amend this specific warranty. Abnormal use, abuse of the fixture, improper installation, or repair or modification of the fixture without prior written authorization from the manufacturer will render the warranty void.

SELECT JUNE 2024