

CATALOG #	TYPE	
JOB NAME	WATTAGE	VOLTAGE

Latitudes Series

Porthole 4" Downlight • LED

Up to 90,000 Hour Rated Life • Type IC • AirTight Optional
Wet Listed • LM-79 Certified • LM-80 Qualified

LRR-04017

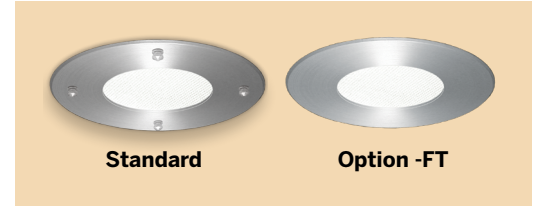

Specifications

Delivered System Performance

- Nominal Lumens: **Must Specify**

Type IC

-2000L

-1500L

-1000L

- Select trim & beam distribution: see chart
- Select color (CCT): see chart; 80+ CRI standard; Option -HC for 90+ (15% lumen loss)
- 90,000 Hour Rated Life (L70**)

Thermal Management System

- Aluminum heat sink and components for cool operation, long life, and low maintenance

LED Driver - INTERNAL

- Indoor/Outdoor: -30°C to 60°C (-22°F to 140°F)
- 0-10V CCR 10% dimming standard
- 120-277V / 50-60 Hz standard; load insensitive

Porthole Trim with Brushed Nickel Finish

- Cast aluminum, brushed satin nickel finish porthole flat trim and (4) silver knurled finials with frosted prismatic tempered spread lens
- Finial finish will match trim finish unless otherwise specified**
- Low brightness reflector above trim

Acrylic Enameled Aluminum Housing

- Rustproof and corrosion resistant: exceeds 1000 hour ASTM 5% salt spray test
- Shallow depth fits restricted plenums
- Cool operation extends component life
- Modular design; visible and fully serviceable through aperture
- Built-in plaster flange

Outlet Box (Galvanized)

- UL Listed, 14GA, insulated, removable cover
- ½" and ¾" knockouts

Installation & Hardware

- Indoor/outdoor in ceilings up to 1½" thick or see Option -79
- 27" hanger bars & adjusting brackets (2) supplied

UL, C-UL (Canada) Compliance

- Wet, damp or dry locations, covered ceilings
- Type IC for direct contact with insulation
- Through-branch conductors (4 #12 AWG 90°C) for Type IC Listing

IEC & FCC Compliance

- Meets IEC/EN 60601-1-2 electromagnetic compatibility standard for medical electrical equipment
- FCC Part 15 certified for EMI/RFI emissions

FIVE YEAR Limited Warranty

- Complete standard fixture



Options and Ordering Configuration

(Example: LRR-04017-1500L-277-WFL-35K-30T-RH-AT)

Must Specify					Optional			
Model	Lumens	Volts	Beam	CCT [†] & CRI	Driver Options	Emergency Options	Trim Options	Other Options
LRR-04017								
	-2000L -1500L -1000L	-120 -277 -97 [†] : Other Voltage	(Blank): MFL -MFL -WFL	(Blank): 3500°K, 80+ CRI 80+ CRI* -27K: 2700°K -30K: 3000°K -35K: 3500°K -41K: 4000°K -50K: 5000°K *Note: Lumen Factor = 0.93 for -27K	(Blank): Standard 0-10V CCR 10% dim -D1 [†] : 0-10V 1.0% dim -D2 [†] : 0-10V 0.1% dim -D3 [†] : DALI 1.0% dim -D4 [†] : DALI 100- 0.1% dim -D5 [†] : DMX512A 0.1% dim -D40: -40°C (-40°F) driver; 0-10V 10% dim	(Blank): None -EI: Remote emergency inverter for 100% rated lumens; Run time: 90+ minutes; N/A for options -FS, -97 -EM: Internal emergency battery pack; Delivers 500 lumens; Run time: 90+ minutes -ERH: Remote emergency battery pack; Delivers 1000 lumens; CEC Compliant; Run time: 90+ minutes	(Blank): Cast aluminum, brushed satin nickel finish porthole flat trim with frosted prismatic spread lens Trim Finishes -30T: White enamel trim -35T: Silver enamel trim -37T: Dark bronze enamel trim -38T: Black enamel trim -94: Custom color; consult factory Other Trim Features -32: White trim extender, specify OD -33: Decorative Glow Ring; see last page for details -45: Gasket between trim & ceiling -BLF: Black finial finish -BRF: Brass finial finish -FT: Flat trim (without finials) brushed nickel unless otherwise specified -COF: Cone shaped finials. Silver finish standard or select optional finish -CUF: Custom color finial finish -DF: Electrically isolated trim -ROF: Round shaped finials. Silver finish standard or select optional finish. -WHF: White finial finish	(Blank): None Mounting -79: Extension collar for ceilings up to 2" thick -RH: Joist mounting hardware instead Other Options -99: Special modification; consult factory -AT: Air Tight version; Meets ASTM E283 airflow restriction of 2CFM max -AWN: Athena Wireless Node; N/A for Dimming Options D5, -D40 -FS: Fused primary; One per fixture; N/A for option -EI *Note: For other integrated control solutions, such as nLight, contact factory
Projected L70** for Kirlin Luminaires								
In Open Plenum		90,000 hours						
In Insulation (Type IC)		70,000 hours						
**Hours at 70% lumen maintenance								
					†Consult factory for use with -2000L			
					†Consult factory			

Performance Factors

NOMINAL LUMENS	LUMEN FACTOR	NOMINAL WATTS	LPW FACTOR
-2000L	1.257	28.7	0.92
-1500L	1.00	21.0	1.00
-1000L	.579	10.4	1.17

Dimensions

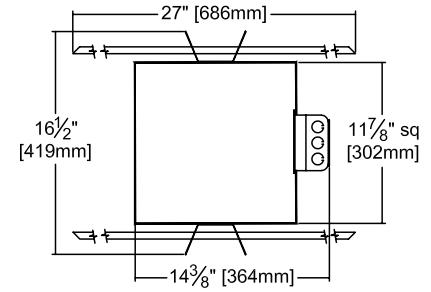
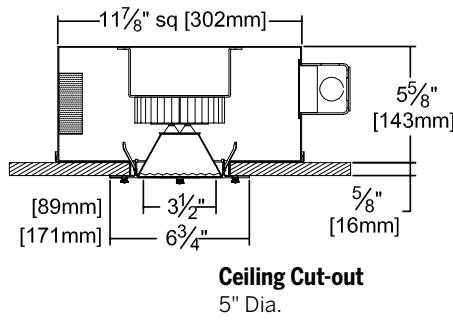

* See notes on page 1 for additional info on Lumen Factors

Photometry - Installed Complete Fixture

LM-79 IESNA Certified Photometry from Independent Lab

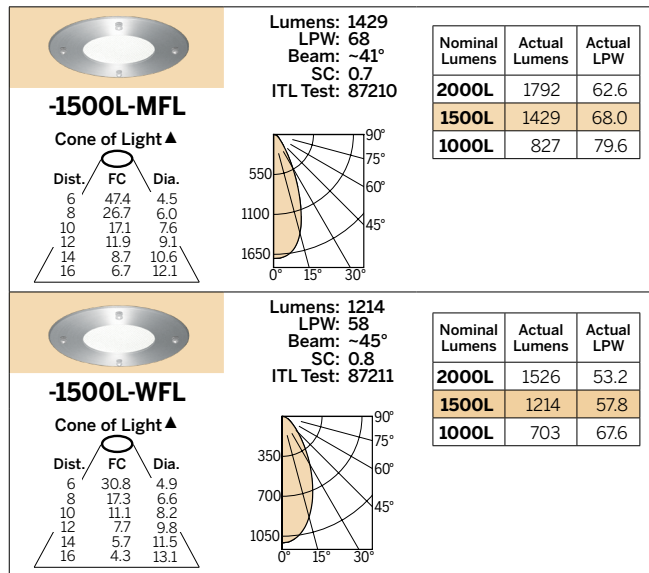

LED manufacturers maintain a tolerance of +/-7% on flux (lumens) and power (electrical) measurements.

▲ **Cone of Light Key** Dia. (in ft.) shown is where FC value is half the FC at nadir. **Dist.** Distance (Ft.) from fixture
FC Footcandles at nadir (0°) **Dia.** Circle of light at 50% of FC

Classic Glow Rings: Option -33 for Latitudes

To order a Kirlin Glow Ring, begin by adding -33 to the product number. Then, configure your Glow Ring by selecting each of the 7 design elements listed below:

(Example: LRR-04017-2000L-120-30K-MFL-33-GLM-1L-FRR-ROF-SIF-ROS-SIS)

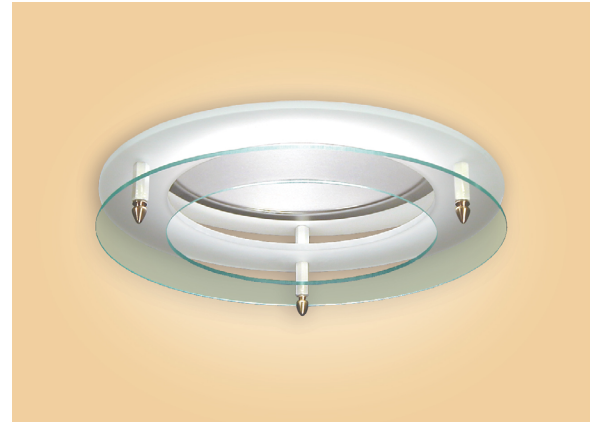

1. Ring Material
(choose one)

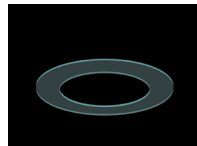

Glass (-GLM)

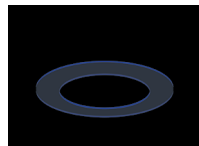

Acrylic (-ACM)



Custom (-CUM)

2. # of Rings
(choose one)

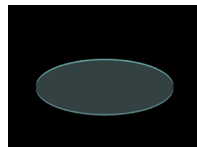

1 Ring (1L)

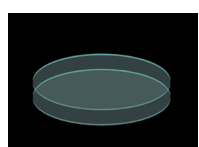

2 Rings (-2L)

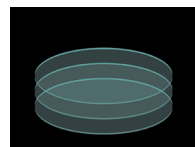

3 Rings (-3L)

3. Ring Design
(choose one)

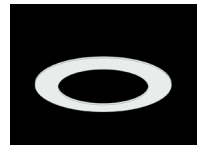

Frosted Ring (-FRR)



Clear Ring (-CRR)

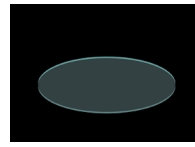

Solid Disk (-SDR)

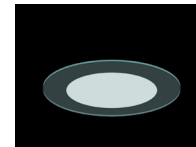

Frosted Center (-FCR)

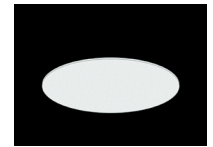

Frosted Disk (-FDR)

4. Finial Design
(choose one)

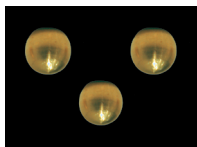

Round (-ROF)

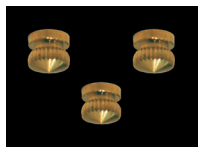

Knurled (-KNF)



Cone (-COF)

5. Finial Color
(choose one)



Brass (-BRF)



Silver (-SIF)



Black (-BLF)

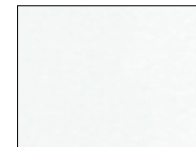

White (-WHF)



Custom (-CUF)

6. Standoff Design
(choose one)

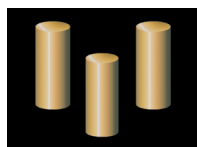

Round (-ROS)

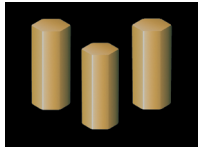

Hexagonal (-HOS)

7. Standoff Color
(choose one)



Brass (-BRS)



Silver (-SIS)



Black (-BLS)

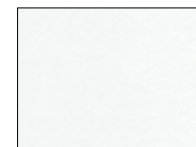

White (-WHS)



Custom (-CFS)