

CATALOG #	TYPE	
JOB NAME	WATTAGE	VOLTAGE

## Latitudes Series

### Super Shallow Lensed 4" Downlight • LED

Up to 90,000 Hour Rated Life • Type IC • Wet Listed  
3-Step Binning • LM-79 Certified • LM-80 Qualified

## Specifications

### Delivered System Performance

- Nominal Lumens: **Must Specify**

#### Type IC

-1500L

-1000L

- Select trim & beam distribution: see chart
- Select color (CCT): see chart; 80+ CRI standard; Option -HC for 90+ (15% lumen loss)
- 90,000 Hour Rated Life (L70\*\*)

### Thermal Management System

- Aluminum heat sink and components for cool operation, long life, and low maintenance

### LED Driver - INTERNAL

- Indoor/Outdoor: -30°C to 60°C (-22°F to 140°F)
- 0-10V CCR 10% dimming standard
- 120-277V / 50-60 Hz standard; load insensitive

### Trim Assembly

- Seamless tapered aluminum self-flanged trim with white finish (field paintable)
- Regressed tempered prismatic spread lens

### Acrylic Enameled Aluminum Housing: Super Shallow Depth

- Rustproof and corrosion resistant: exceeds 1000 hour ASTM 5% salt spray test
- Shallow depth fits restricted plenums
- Cool operation extends component life
- Modular design; visible and fully serviceable through aperture
- Built-in plaster flange

### Outlet Box (Galvanized)

- UL Listed, 14GA, insulated, removable cover
- 1/2" and 3/4" knockouts

### Installation & Hardware

- Indoor/outdoor in ceilings up to 1 1/8" thick or see Option -79
- Compatible with fire rated enclosures (by others)
- 27" hanger bars & adjusting brackets (2) supplied

## LRR-04006



### Quick Ship Eligible

- Eligible for Quick Ship of 2 weeks or less
- Quantity requirements: 10 - 100 pieces
- Requires choosing options in **red** on the next page and including the -QS option code

### UL, C-UL (Canada) Compliance

- Wet, damp or dry locations, covered ceilings
- Type IC for direct contact with insulation
- Through-branch conductors (4 #12 AWG 90°C) for Type IC Listing

### IEC & FCC Compliance

- Meets IEC/EN 60601-1-2 electromagnetic compatibility standard for medical electrical equipment
- FCC Part 15 certified for EMI/RFI emissions

### FIVE YEAR Limited Warranty

- Complete standard fixture



## Dimensions

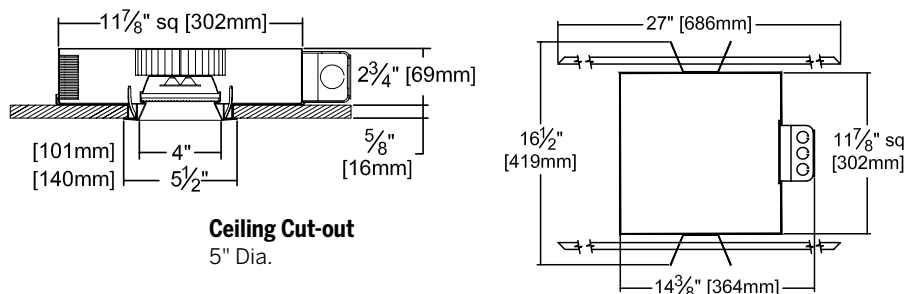

Options and Ordering Configuration

 **Red text = Quick Ship Eligible**

(Example: LRR-04006-1500L-120-MFL-35K-30T-RH-NAT)

Must Specify					Optional			
Model	Lumens	Volts	Beam	CCT <sup>†</sup> & CRI	Driver Options	Emergency Options	Trim Options	Other Options
LRR-04006								
	-1500L -1000L	-120 -277  -97 <sup>†</sup> : Other Voltage	(Blank): MFL  -NFL -MFL -WFL	(Blank): 3500°K, 80+ CRI  80+ CRI* -27K: 2700°K -30K: 3000°K -35K: 3500°K -41K: 4000°K -50K: 5000°K  *Note: Lumen Factor = 0.93 for -27K  90+ CRI** -27K-HC: 2700°K -30K-HC: 3000°K -35K-HC: 3500°K -41K-HC: 4000°K -50K-HC: 5000°K  **Note: Lumen Factor = 0.79 for -27K-HC; All Others = 0.85; consult factory	(Blank): Standard 0-10V CCR 10% dim  -D1: 0-10V 1.0% dim  -D40: -40°C (-40°F) driver; 0-10V 10% dim	(Blank): None  -EI: Remote emergency inverter for 100% rated lumens; Run time: 90+ minutes; N/A for options -FS, -97  -ERH: Remote emergency battery pack; Delivers 1000 lumens; CEC Compliant; Run time: 90+ minutes	(Blank): Seamless tapered aluminum self-flanged trim with white finish; prismatic spread lens  Trim Finishes -30F: White enamel flange (flange only) -35F: Silver enamel flange (flange only) -35T: Silver enamel trim (complete trim) -37F: Dark bronze enamel flange (flange only) -37T: Dark bronze enamel trim (complete trim) -38F: Black enamel flange (flange only) -38T: Black enamel trim (complete trim) -62T: Clear Specular (complete trim) -70T: Clear semi-specular SofTex™ trim -94: Custom color; consult factory  Other Trim Features -23: Frosted microprismatic lens -32: White trim extender, specify OD -33: Decorative Glow Ring; see last page for details -45: Gasket between trim & ceiling -CF: Custom color filter (Rosco); Specify -DF: Electrically isolated trim -WA: White acrylic (flat) diffuser instead; will produce wide flood distribution	(Blank): None  Mounting -79: Extension collar for ceilings up to 2" thick  Other Options -99: Special modification; consult factory -AWN: Athena Wireless Node; N/A for Dimming Options D5, -D40 -FS: Fused primary; One per fixture; N/A for option -EI -NAT: Modified for natatorium use -QS: Quick Ship; Options must be only red items; Quantities of 10-100  *Note: For other integrated control solutions, such as nLight, contact factory
Projected L70** for Kirlin Luminaires								
In Open Plenum		90,000 hours						
In Insulation (Type IC)		70,000 hours						
**Hours at 70% lumen maintenance		†Consult factory						

LIMITED WARRANTY CATALOGUE KRILLIUM ARE WARRANTED FREE OF DEFECTS IN WORKMANSHIP OR MATERIAL FOR FIVE YEARS FROM DATE OF PURCHASE. INSTALLED TO N.E.C. (NORMAL USE). Manufacturer at its option will replace or repair such failure or defect at the purchase price on presentation of proof of purchase and defective nature at the office of manufacturer within the terms of original shipment. Liability of manufacturer is limited to the foregoing and manufacturer shall not be liable for any other damages, direct or indirect, sustained or suffered by purchaser or any person. This warranty is given to the buyer in place of the ordinary warranties, expressed or implied. Seller does not warrant as to merchantability or fitness for a particular use, nor will any oral statement constitute a warranty or amend this specific warranty. Abnormal use, abuse of the fixture, improper installation or repair, or modification of the fixture without prior written approval from the manufacturer will render the warranty null and void.

\* See notes on page 1 for additional info on Lumen Factors

## LM-79 IESNA Certified Photometry from Independent Lab

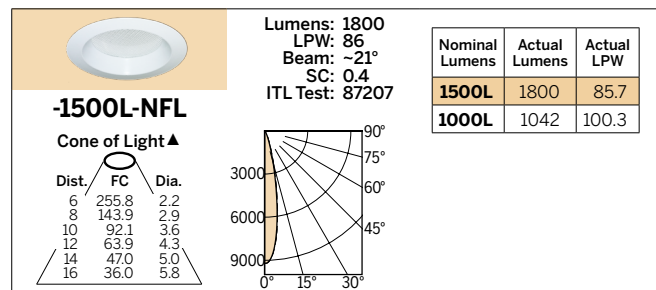

**▲ Cone of Light Key**  
Dia. (in ft.) shown is where FC value is half the FC at nadir.

**Dist.** Distance (Ft.) from fixture  
**FC** Footcandles at nadir (0°)  
**Dia.** Circle of light at 50% of FC

## Classic Glow Rings: Option -33 for Latitudes

To order a Kirlin Glow Ring, begin by adding -33 to the product number. Then, configure your Glow Ring by selecting each of the 7 design elements listed below:

(**Example:** LRR-04006-1500L-120-30K-NFL-**33**-GLM-1L-FRR-ROF-SIF-ROS-SIS)

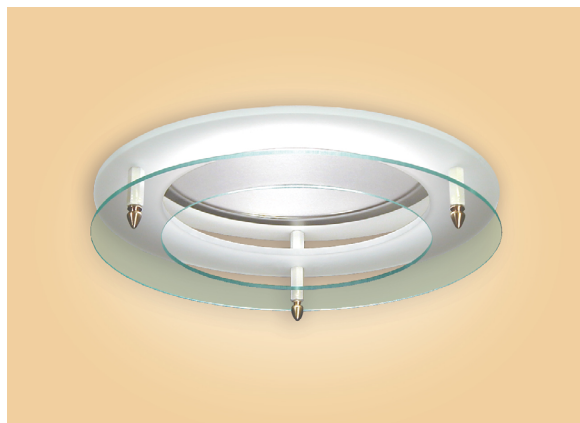

1. Ring Material  
(choose one)

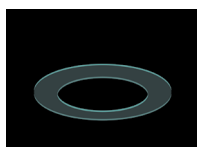

Glass (-GLM)



Acrylic (-ACM)



Custom (-CUM)

2. # of Rings  
(choose one)

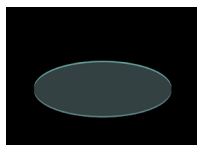

1 Ring (1L)

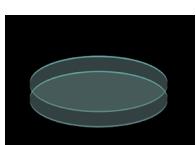

2 Rings (-2L)

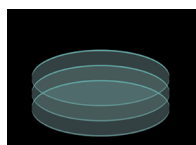

3 Rings (-3L)

3. Ring Design  
(choose one)



Frosted Ring (-FRR)



Clear Ring (-CRR)

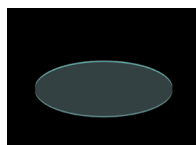

Solid Disk (-SDR)

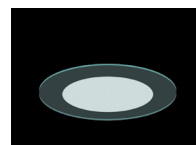

Frosted Center (-FCR)

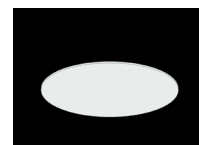

Frosted Disk (-FDR)

4. Finial Design  
(choose one)

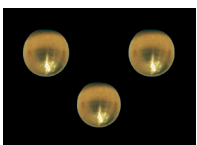

Round (-ROF)



Knurled (-KNF)



Cone (-COF)

5. Finial Color  
(choose one)



Brass (-BRF)



Silver (-SIF)



Black (-BLF)

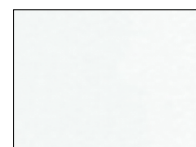

White (-WHF)



Custom (-CUF)

6. Standoff Design  
(choose one)

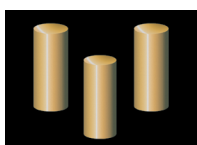

Round (-ROS)

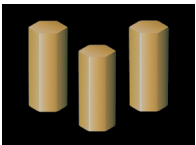

Hexagonal (-HOS)

7. Standoff Color  
(choose one)



Brass (-BRS)



Silver (-SIS)



Black (-BLS)

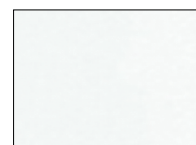

White (-WHS)



Custom (-CFS)