

CATALOG #	TYPE	
JOB NAME	WATTAGE	VOLTAGE

# Choice Series

## Super Shallow 5-6" Downlight • COB LED

50,000+ Hours • Type IC • 1.0% Dimming, 0-10V

2 or 3 Step Binning • Wet Listed • LM-80 and LM-79 Certified

### Specifications

#### Delivered System Performance

• Lumen Series: **Must Specify**

Type IC	Non-IC
-3000L	-4000L
-2500L	
-2000L	
-1500L	
-1000L	

- Select trim & beam distribution: see chart
- Select color (CCT): see chart; 80+ CRI standard; Option -HC for 90+ (15% lumen loss)
- 60,000 hour life, 50,000 in insulation

#### Thermal Management System

- Aluminum heat sink and components for cool operation, long life, and low maintenance

#### LED Driver - INTERNAL

- Indoor/Outdoor: -30°C to 60°C (-22°F to 140°F)
- 0-10V CCR 1.0% dimming standard
- Voltage Options: **Must Specify**
- UNV: -120-277/50-60Hz; load insensitive
- 120: -120V input (50-60Hz); for -29 only

#### Trim Assembly

- White self-flanged regressed trim with microprismatic lens (-FLR)

- Alternate white self-flanged flat trim with frosted microprismatic lens (-FLT)
- Alternate white self-flanged regressed trim with frosted microprismatic lens (-RDL)
- Optional colors and finishes available

#### Acrylic Enameled Aluminum Housing

- Rustproof: exceeds 1000 hour ASTM 5% salt spray test; all components fully sustainable
- Only 2.75" deep for restricted or shallow plenums
- Cool operation extends component life
- Modular design; visible and fully serviceable through aperture

#### Outlet Box (Galvanized)

- UL Listed, 14GA, insulated, removable cover
- ½" and ¾" knockouts
- Up to 4 #12 AWG through-branch conductors

#### Installation & Hardware

- Indoor/outdoor in ceilings up to 1½" thick
- Compatible with fire rated enclosures (by others)

# LRC-05SDN

### Trim Options



- 27" hanger bars & adjusting brackets (2) supplied

#### UL, C-UL (Canada) & FCC Compliance

- UL Listed: wet, damp or dry locations, covered ceilings
- Type IC up to -3000L; Non-IC for -4000L
- FCC Part 15 certified for EMI/RFI emissions

#### FIVE YEAR Limited Warranty

- Complete standard fixture



## Options and Ordering Configuration

(Example: LRC-05SDN-3000L-UNV-FLR-NFL-30K-62T-FS)

Must Specify						Optional			
Model	Lumens	Volts	Trim	Beam	CCT† & CRI	Driver Options	Emergency Options	Trim Options	Other Options
LRC-05SDN									
	<b>Non-IC</b>	<b>-UNV</b>	<b>-FLR</b>	<b>-FLR Only</b>	<b>80+ CRI*</b>	<b>(Blank):</b> Standard 0-10V CCR 1.0% dim	<b>(Blank):</b> None	<b>(Blank):</b> Standard white enamel	<b>(Blank):</b> None
	-4000L	-120	-FLT	-NFL	-27K: 2700°K				
	<b>Type IC</b>		<b>-RDL</b>	<b>-MFL</b>	<b>-30K:</b> 3000°K	<b>Consult Factory:</b>	<b>-EI:</b> Remote emergency inverter for 100% rated lumens up to -3000L; 90+ minutes; N/A for options -29 or -FS	<b>Trim Finishes</b>	<b>Mounting</b>
	-3000L			-WFL	-35K: 3500°K	<b>-D2:</b> 0-10V 0.1% dim	<b>-E14:</b> Remote emergency inverter for 100% rated lumens up to -4000L; 90+ minutes; N/A for options -29 or -FS (CEC Compliant)	<b>-35T:</b> Silver enamel trim	<b>-79:</b> Extension collar; ceilings up to 2" thick
	-2500L			<b>-FLT &amp; -RDL</b>	<b>-40K:</b> 4000°K	<b>-D3:</b> DALI 1.0% dim	<b>-ERH:</b> Remote emergency battery pack; Delivers 1000 lumens; 90+ minutes (CEC Compliant)	<b>-37T:</b> Dark bronze enamel trim	<b>Other Options</b>
	-2000L			<b>-WFL</b>	<b>-50K:</b> 5000°K	<b>-D4:</b> DALI 100-0.1% dim		<b>-38T:</b> Black enamel trim	<b>-99:</b> Special modification; consult factory
	-1500L				<b>*Note:</b> Lumen Factor = 0.93 for -27K	<b>-D5:</b> DMX512A 0.1% dim		<b>-62T:</b> Clear specular trim instead (-FLR & -RDL only)	<b>-FS:</b> Fused primary; One per fixture; N/A for Options -EI, -E14
	-1000L				<b>90+ CRI**</b>	<b>-D6:</b> Triac/ELV dim - 120 volt only		<b>-70T:</b> Clear semi-specular SofTex™ diffuse trim instead (-FLR only)	<b>-NAT:</b> Modified for natatorium use
					<b>-27K-HC:</b> 2700°K	<b>-ECO:</b> Lutron EcoSys; Dim-to-black		<b>-94:</b> Custom color; consult factory	
					<b>-30K-HC:</b> 3000°K	<b>-29:</b> Lutron 2-wire PWM dim - 120 volt only		<b>-BG:</b> BioGard™ anti-microbial white	
					<b>-35K-HC:</b> 3500°K			<b>Other Trim Features</b>	
					<b>-40K-HC:</b> 4000°K			<b>-13:</b> .125" clear poly. lens overlay	
					<b>-50K-HC:</b> 5000°K (-2500L or below)			<b>-23:</b> Frosted microprismatic lens (standard for -FLT & -RDL trims)	
					<b>**Note:</b> Lumen Factor = 0.79 for -27K-HC; All Others = 0.85			<b>-32:</b> White trim extender; specify OD	
								<b>-33:</b> Decorative Glow Ring; see last page for details	
								<b>-45:</b> Gasket between trim & ceiling	
								<b>-46:</b> Gasket between lens & trim	
								<b>-DA:</b> Diffuse acrylic lens	
								<b>-DF:</b> Electrically isolated trim	
								<b>-WA:</b> White acrylic lens	

† For 2 SDCM, consult factory

## Performance Factors

NOMINAL LUMENS	LUMEN FACTOR	NOMINAL WATTS	LPW FACTOR
-4000L	1.33	39.2	0.93
<b>-3000L</b>	<b>1.00</b>	<b>27.5</b>	<b>1.00</b>
-2500L	0.89	24.7	0.99
-2000L	0.76	20.3	1.03
-1500L	0.56	14.4	1.06
-1000L	0.41	10.7	1.04

\* See notes on page 1 for additional info on Lumen Factors

## Dimensions

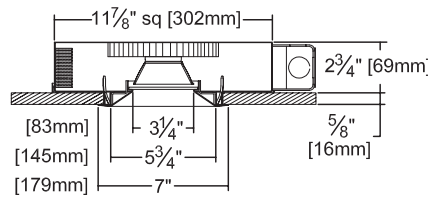

Ceiling Cut-out  
6 1/2" Dia.

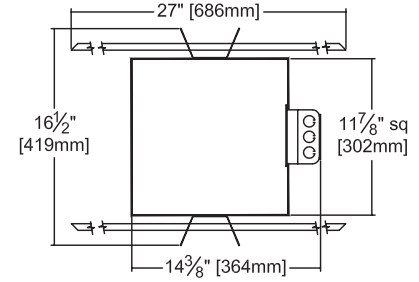

## Photometry - Installed Complete Fixture

Photometry from I.T.L., Boulder, CO

LM-79 IESNA Certified Photometry from Independent Lab

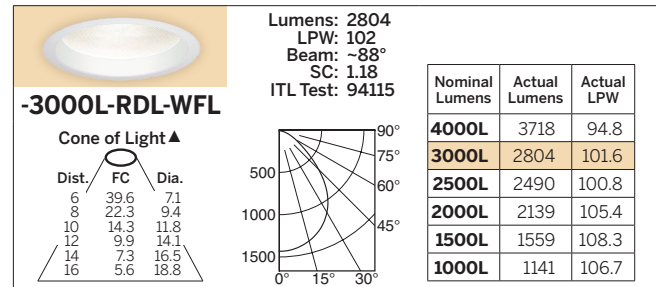
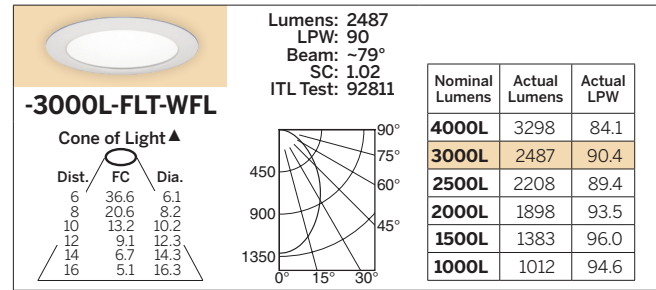
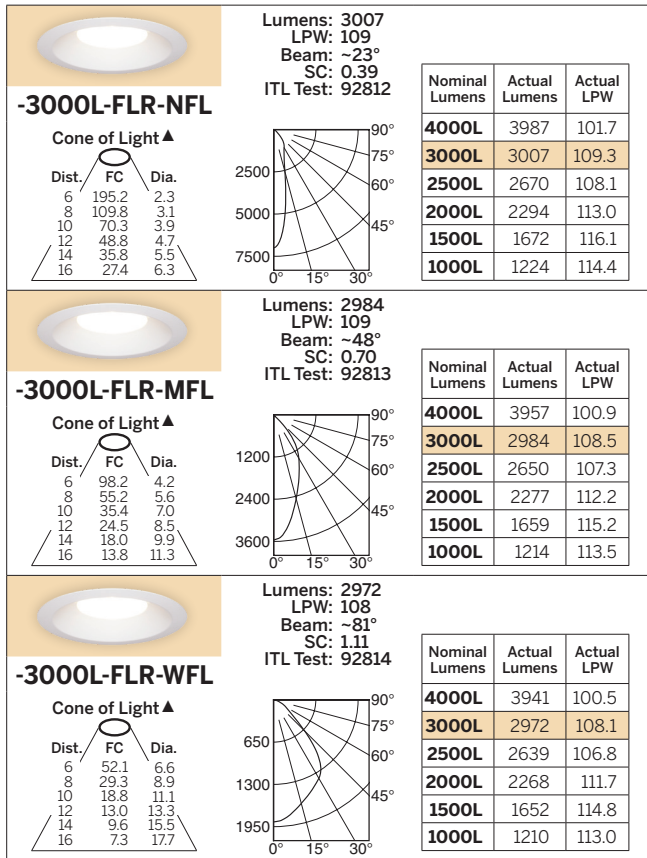

LED manufacturers maintain a tolerance of +/-7% on flux (lumens) and power (electrical) measurements.

▲ Cone of Light Key  
Dist. (in Ft.) from fixture  
Dia. (in ft.) shown is where FC value is half the FC at nadir.  
Dist. (Ft.) from fixture  
FC Footcandles at nadir (0°)  
Dia. Circle of light at 50% of FC

LIMITED WARRANTY: CATALOGUED KIRLIN FIXTURES ARE WARRANTED FREE OF DEFECTS IN WORKMANSHIP OR MATERIAL FOR YEARS FROM DATE OF PURCHASE. INSTALLED TO N.E.C. IN NORMAL USE. Manufacturer at the option will replace or repair such fixture or refund the purchase price on presentation of proof of purchase and defective fixture at the offices of manufacturer within the warranty period. Liability of manufacturer is limited to the foregoing and manufacturer shall not be liable for any other damages, direct or indirect, sustained or suffered by purchaser or any person. This warranty is supplied to the buyer in place of all other warranties, expressed or implied. Seller does not warrant as to merchantability or fitness for a particular use, nor will any oral statement constitute a warranty or amend this specific warranty. Abnormal use, abuse of the fixture, improper installation or repair or modification of the fixture without prior written authorization from the manufacturer will render the warranty void.

CHOICE SERIES  
APR 2021

# Classic Glow Rings: Option -33 for Choice Series

To order a Kirlin Glow Ring, begin by adding -33 to the product number. Then, configure your Glow Ring by selecting each of the 7 design elements listed below:

(Example: LRC-05SDN-3000L-UNV-FLR-NFL-30K-33-GLM-1L-FRR-ROF-SIF-ROS-SIS)

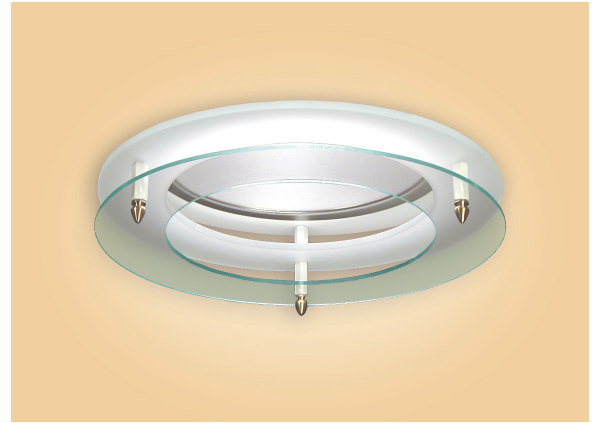

1. Ring Material  
(choose one)



Glass (-GLM)



Acrylic (-ACM)



Custom (-CUM)

2. # of Rings  
(choose one)



1 Ring (1L)

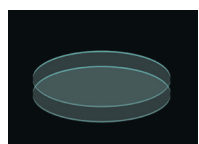

2 Rings (-2L)

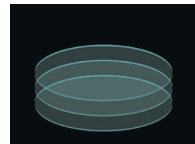

3 Rings (-3L)

3. Ring Design  
(choose one)



Frosted Ring (-FRR)



Clear Ring (-CRR)

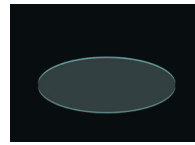

Solid Disk (-SDR)



Frosted Center (-FCR)



Frosted Disk (-FDR)

4. Finial Design  
(choose one)

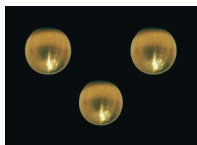

Round (-ROF)



Knurled (-KNF)



Cone (-COF)

5. Finial Color  
(choose one)



Brass (-BRF)



Silver (-SIF)

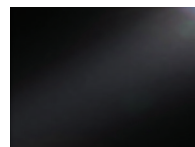

Black (-BLF)

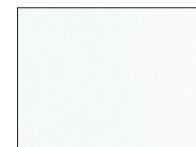

White (-WHF)



Custom (-CUF)

6. Standoff Design  
(choose one)

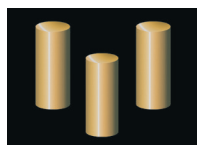

Round (-ROS)

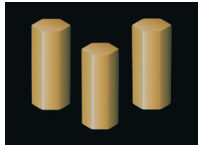

Hexagonal (-HOS)

7. Standoff Color  
(choose one)



Brass (-BRS)



Silver (-SIS)



Black (-BLS)



White (-WHS)



Custom (-CFS)

LED manufacturers maintain a tolerance of +/-7% on flux (lumens) and power (electrical) measurements.