

CATALOG #	TYPE	
JOB NAME	WATTAGE	VOLTAGE

Choice Series

Open 2" Pinhole Downlight • COB LED

50,000+ Hours • Type IC • 1.0% Dimming, 0-10V

2 or 3 Step Binning • Wet Listed • LM-80 and LM-79 Certified

Specifications

Delivered System Performance

• Lumen Series: **Must Specify**

Type IC

-2500L

-2000L

-1500L

-1200L

-1000L

- Select trim & beam distribution: see chart
- Select color (CCT): see chart; 80+ CRI standard; Option -HC for 90+ (15% lumen loss)
- 60,000 hour life, 50,000 in insulation

Thermal Management System

- Aluminum heat sink and components for cool operation, long life, and low maintenance

LED Driver - INTERNAL

- Indoor/Outdoor: -30°C to 60°C (-22°F to 140°F)
- 0-10V CCR 1.0% dimming standard
- Voltage Options: **Must Specify**
- UNV: -120-277/50-60Hz; load insensitive
- 120: -120V input (50-60Hz); for -29 only

Trim Assembly

- White die-cast aluminum; matte black inner cone above
- Optional colors and finishes available

Acrylic Enamelled Aluminum Housing

- Rustproof: exceeds 1000 hour ASTM 5% salt spray test; all components fully sustainable
- Shallow depth for restricted plenums
- Cool operation extends component life
- Modular design; visible and fully serviceable through aperture

Outlet Box (Galvanized)

- UL Listed, 14GA, insulated, removable cover
- ½" and ¾" knockouts
- Up to 4 #12 AWG through-branch conductors

Installation & Hardware

- Indoor/outdoor in ceilings up to 1½" thick
- Compatible with fire rated enclosures (by others)
- 27" hanger bars & adjusting brackets (2) supplied

LRC-02PND

Trim Options



-PNR



-PNS

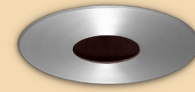

-PNR-BN
(Brushed Nickel Finish)

UL, C-UL (Canada) & FCC Compliance

- UL Listed: wet, damp or dry locations, covered ceilings
- Type IC up to -2500L
- FCC Part 15 certified for EMI/RFI emissions

FIVE YEAR Limited Warranty

- Complete standard fixture



Made in the USA



FCC Part 15 Certified



UL Listed Wet, Damp, Dry

Options and Ordering Configuration

(Example: LRC-02PND-2000L-UNV-PNR-NFL-30K-BN-AT)

Must Specify						Optional			
Model	Lumens	Volts	Trim	Beam	CCT† & CRI	Driver Options	Emergency Options	Trim Finish Options	Other Options
LRC-02PND									
	Type IC	-UNV	-PNR	-SPT	80+ CRI*	(Blank): Standard 0-10V CCR 1.0% dim	(Blank): None	(Blank): Standard white die-cast aluminum; with matte black inner cone	(Blank): None
	-2500L	-120	-PNS	-NFL	-27K: 2700°K	-D2: 0-10V 0.1% dim	-EI: Remote emergency inverter: For 100% rated lumens up to -2500L; 90+ minutes; N/A for options -29 or -FS	Trim Finishes	Mounting
	-2000L			-MFL	-30K: 3000°K	-D3: DALI 1.0% dim	-EM: Internal emergency battery pack; Delivers 700 lumens; 90+ minutes (CEC Compliant)	-35T: Silver enamel trim	-79: Extension collar; ceilings up to 2" thick
	-1500L			-WFL	-35K: 3500°K	-D4: DALI 100-0.1% dim	-ERH: Remote emergency battery pack; Delivers 1000 lumens; 90+ minutes (CEC Compliant)	-37T: Dark bronze enamel trim	-RH: Joist mounting hardware instead
	-1200L				-40K: 4000°K	-D5: DMX512A 0.1% dim	-ER: Remote emergency battery pack; Dim-to-black	-38T: Black enamel trim	Other Options
	-1000L				-50K: 5000°K	-D6: Triac/ELV dim - 120 volt only	-29: Lutron 2-wire PWM dim - 120 volt only	-94: Custom color; consult factory	-99: Special modification; consult factory
					*Note: Lumen Factor = 0.93 for -27K			-BN: Brushed satin nickel finish	-AT: Air Tight version; Meets ASTM E283 airflow restriction of 2CFM max
					90+ CRI**			Other Trim Features	-FS: Fused primary; One per fixture; N/A for Option -EI
					-27K-HC: 2700°K			-32: White trim extender; specify OD	
					-30K-HC: 3000°K			-45: Gasket between trim & ceiling	
					-35K-HC: 3500°K			-DF: Electrically isolated trim	
					-40K-HC: 4000°K				
					-50K-HC: 5000°K (-2500L or below)				
					**Note: Lumen Factor = 0.79 for -27K-HC; All Others = 0.85				

† For 2 SDCM, consult factory

Performance Factors

NOMINAL LUMENS	LUMEN FACTOR	NOMINAL WATTS	LPW FACTOR
-2500L	1.31	27.5	0.98
-2000L	1.16	24.7	0.96
-1500L	1.00	20.7	1.00
-1200L	0.73	14.4	1.03
-1000L	0.53	10.7	1.02

* See notes on page 1 for additional info on Lumen Factors

Dimensions

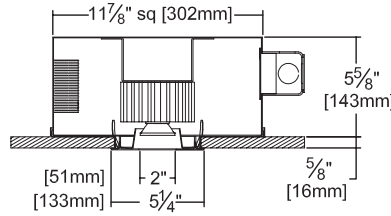

Ceiling Cut-out
5" Dia.

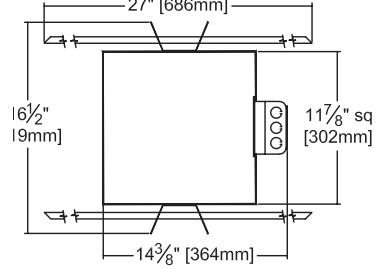

Photometry - Installed Complete Fixture

Photometry from I.T.L., Boulder, CO

LM-79 IESNA Certified Photometry from Independent Lab

-1500L-PNR-SPT

Dist.	FC	Dia.
6	133.2	2.7
8	74.9	3.6
10	47.9	4.5
12	33.3	5.4
14	24.5	6.3
16	18.7	7.2

Lumens: 1647
LPW: 80
Beam: ~27°
SC: 0.45
ITL Test: 94082

Nominal Lumens	Actual Lumens	Actual LPW
2500L	2158	78.5
2000L	1915	77.5
1500L	1647	79.6
1200L	1199	83.3
1000L	878	82.0

-1500L-PNS-SPT

Dist.	FC	Dia.
6	133.2	2.7
8	74.9	3.7
10	48.0	4.6
12	33.3	5.5
14	24.5	6.4
16	18.7	7.3

Lumens: 1747
LPW: 84
Beam: ~27°
SC: 0.46
ITL Test: 94084

Nominal Lumens	Actual Lumens	Actual LPW
2500L	2289	83.2
2000L	2032	82.3
1500L	1747	84.4
1200L	1272	88.3
1000L	931	87.0

-1500L-PNR-NFL

Dist.	FC	Dia.
6	70.6	3.9
8	39.7	5.2
10	25.4	6.5
12	17.6	7.8
14	13.0	9.0
16	9.9	10.3

Lumens: 1515
LPW: 73
Beam: ~40°
SC: 0.65
ITL Test: 94083

Nominal Lumens	Actual Lumens	Actual LPW
2500L	1985	72.2
2000L	1762	71.3
1500L	1515	73.2
1200L	1103	76.6
1000L	807	75.5

-1500L-PNS-NFL

Dist.	FC	Dia.
6	70.6	4.2
8	39.7	5.5
10	25.4	6.9
12	17.6	8.3
14	13.0	9.7
16	9.9	11.1

Lumens: 1729
LPW: 84
Beam: ~43°
SC: 0.69
ITL Test: 94085

Nominal Lumens	Actual Lumens	Actual LPW
2500L	2265	82.4
2000L	2011	81.4
1500L	1729	83.5
1200L	1259	87.4
1000L	922	86.1

-1500L-PNR-MFL

Dist.	FC	Dia.
6	64.4	4.6
8	36.2	6.2
10	23.2	7.7
12	16.1	9.3
14	11.8	10.8
16	9.1	12.4

Lumens: 1651
LPW: 80
Beam: ~49°
SC: 0.76
ITL Test: 94036

Nominal Lumens	Actual Lumens	Actual LPW
2500L	2163	78.6
2000L	1920	77.7
1500L	1651	79.8
1200L	1202	83.5
1000L	880	82.2

-1500L-PNS-MFL

Dist.	FC	Dia.
6	64.4	4.7
8	36.2	6.2
10	23.2	7.8
12	16.1	9.4
14	11.8	10.9
16	9.1	12.5

Lumens: 1757
LPW: 85
Beam: ~49°
SC: 0.78
ITL Test: 94038

Nominal Lumens	Actual Lumens	Actual LPW
2500L	2302	83.7
2000L	2043	82.7
1500L	1757	84.9
1200L	1279	88.8
1000L	936	87.5

-1500L-PNR-WFL

Dist.	FC	Dia.
6	48.7	5.5
8	27.4	7.4
10	17.5	9.2
12	12.2	11.0
14	8.9	12.9
16	6.9	14.7

Lumens: 1642
LPW: 79
Beam: ~60°
SC: 0.90
ITL Test: 94037

Nominal Lumens	Actual Lumens	Actual LPW
2500L	2151	78.2
2000L	1910	77.3
1500L	1642	79.3
1200L	1195	83.0
1000L	875	81.8

-1500L-PNS-WFL

Dist.	FC	Dia.
6	49.1	5.6
8	27.6	7.4
10	17.7	9.3
12	12.3	11.1
14	9.0	13.0
16	6.9	14.8

Lumens: 1774
LPW: 86
Beam: ~61°
SC: 0.93
ITL Test: 94039

Nominal Lumens	Actual Lumens	Actual LPW
2500L	2324	84.5
2000L	2063	83.5
1500L	1774	85.7
1200L	1291	89.7
1000L	946	88.4

LED manufacturers maintain a tolerance of +/-7% on flux (lumens) and power (electrical) measurements.

▲ Cone of Light Key Dist. Distance (Ft.) from fixture
Dia. (in ft.) shown is where FC FC Footcandles at nadir (0°)
value is half the FC at nadir. Dia. Circle of light at 50% of FC

LIMITED WARRANTY: CATALOGED KIRLIN FIXTURES ARE WARRANTED FREE OF DEFECTS IN WORKMANSHIP OR MATERIAL FOR 5 YEARS FROM DATE OF PURCHASE. INSTALLATION, USE, MANUFACTURER'S REPAIR, MAINTENANCE, OR REPAIR OF THE FIXTURE WITHOUT PROPER TRAINING OR SUPERVISION IS NOT COVERED. THE WARRANTY IS VOID IF THE FIXTURE IS NOT INSTALLED OR USED AS INTENDED. THE WARRANTY IS VOID IF THE FIXTURE IS NOT USED AS INTENDED. THE WARRANTY IS VOID IF THE FIXTURE IS NOT USED AS INTENDED. THE WARRANTY IS VOID IF THE FIXTURE IS NOT USED AS INTENDED.

CHOICE SERIES
APR 2021