

| | | |
|-----------|---------|---------|
| CATALOG # | TYPE | |
| JOB NAME | WATTAGE | VOLTAGE |

Choice Series

2" Pinhole Adjustable Downlight • COB LED

45° Max Tilt • 50,000+ Hours • Type IC • 1.0% Dimming, 0-10V
2 or 3 Step Binning • Wet Listed • LM-80 and LM-79 Certified

Specifications

Delivered System Performance

- Lumen Series: **Must Specify**
 - Type IC
 - 2500L
 - 2000L
 - 1500L
 - 1200L
 - 1000L
- Select trim & beam distribution: see chart
- Select color (CCT): see chart; 80+ CRI standard; Option -HC for 90+ (15% lumen loss)
- 60,000 hour life, 50,000 in insulation

Thermal Management System

- Aluminum heat sink and components for cool operation, long life, and low maintenance

LED Driver - INTERNAL

- Indoor/Outdoor: -30°C to 60°C (-22°F to 140°F)
- 0-10V CCR 1.0% dimming standard
- Voltage Options: **Must Specify**
 - UNV: -120-277/50-60Hz; load insensitive
 - 120: -120V input (50-60Hz); for -29 only

Trim Assembly/Optics

- White die-cast aluminum; matte black inner cone above
- Optional colors and finishes available
- Optics self-align with trim; hot aiming by hand
- Tilts 0-45°; rotates 360°; locks in place
- Accommodates sloped ceilings to 45°

Acrylic Enameled Aluminum Housing

- Rustproof: exceeds 1000 hour ASTM 5% salt spray test; all components fully sustainable
- Shallow depth for restricted plenums
- Cool operation extends component life
- Modular design; visible and fully serviceable through aperture

Outlet Box (Galvanized)

- UL Listed, 14GA, insulated, removable cover
- 1/2" and 3/4" knockouts
- Up to 4 #12 AWG through-branch conductors

Installation & Hardware

- Indoor/outdoor in ceilings up to 1 1/8" thick
- Compatible with fire rated enclosures (by others)
- 27" hanger bars & adjusting brackets (2) supplied

LRC-02PNA

Trim Options



-PNR



-PNS



-PNR-BN
(Brushed Nickel Finish)

UL, C-UL (Canada) & FCC Compliance

- UL Listed: wet, damp or dry locations, covered ceilings
- Type IC up to -2500L
- FCC Part 15 certified for EMI/RFI emissions

FIVE YEAR Limited Warranty

- Complete standard fixture



Made in the USA



FCC Part 15 Certified



UL Listed Wet, Damp, Dry

Options and Ordering Configuration

(Example: LRC-02PNA-2000L-UNV-PNR-NFL-30K-32-AT)

| Must Specify | | | | | | Optional | | | |
|--------------|---------|-------|------|------|--|--|---|--|---|
| Model | Lumens | Volts | Trim | Beam | CCT [†] & CRI | Driver Options | Emergency Options | Trim Finish Options | Other Options |
| LRC-02PNA | | | | | | | | | |
| | Type IC | -UNV | -PNR | -SPT | 80+ CRI* | (Blank): Standard 0-10V CCR 1.0% dim | (Blank): None | (Blank): Standard white die-cast aluminum; with matte black inner cone | (Blank): None |
| | -2500L | -120 | -PNS | -NFL | -27K: 2700°K | -D2: 0-10V 0.1% dim | -EI: Remote emergency inverter: For 100% rated lumens up to -2500L; 90+ minutes; N/A for options -29 or -FS | | |
| | -2000L | | | -MFL | -30K: 3000°K | -D3: DALI 1.0% dim | | Trim Finishes | -RH: Joist mounting hardware instead |
| | -1500L | | | -WFL | -35K: 3500°K | -D4: DALI 100-0.1% dim | -EM: Internal emergency battery pack; Delivers 700 lumens; 90+ minutes (CEC Compliant) | -35T: Silver enamel trim | Other Options |
| | -1200L | | | | -40K: 4000°K | -D5: DMX512A 0.1% dim | -ERH: Remote emergency battery pack; Delivers 1000 lumens; 90+ minutes (CEC Compliant) | -37T: Dark bronze enamel trim | -99: Special modification; consult factory |
| | -1000L | | | | -50K: 5000°K | -D6: Triac/ELV dim - 120 volt only | | -38T: Black enamel trim | -AT: Air Tight version; Meets ASTM E283 airflow restriction of 2CFM max |
| | | | | | *Note: Lumen Factor = 0.93 for -27K | -ECO: Lutron EcoSys; Dim-to-black | | -94: Custom color; consult factory | -FS: Fused primary; One per fixture; N/A for Option -EI |
| | | | | | 90+ CRI** | -29: Lutron 2-wire PWM dim - 120 volt only | | -BN: Brushed satin nickel finish | |
| | | | | | -27K-HC: 2700°K | | | Other Trim Features | |
| | | | | | -30K-HC: 3000°K | | | -32: White trim extender; specify OD | |
| | | | | | -35K-HC: 3500°K | | | -45: Gasket between trim & ceiling | |
| | | | | | -40K-HC: 4000°K | | | -DF: Electrically isolated trim | |
| | | | | | -50K-HC: 5000°K (-2500L or below) | | | | |
| | | | | | **Note: Lumen Factor = 0.79 for -27K-HC; All Others = 0.85 | | | | |
| | | | | | † For 2 SDCM, consult factory | | | | |

Performance Factors

| NOMINAL LUMENS | LUMEN FACTOR | NOMINAL WATTS | LPW FACTOR |
|----------------|--------------|---------------|-------------|
| -2500L | 1.31 | 27.5 | 0.98 |
| -2000L | 1.16 | 24.7 | 0.96 |
| -1500L | 1.00 | 20.7 | 1.00 |
| -1200L | 0.73 | 14.4 | 1.03 |
| -1000L | 0.53 | 10.7 | 1.02 |

* See notes on page 1 for additional info on Lumen Factors

Dimensions

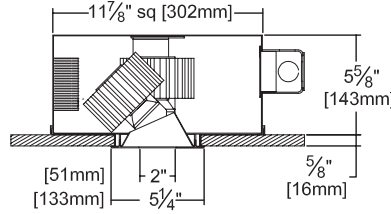

Ceiling Cut-out
5" Dia.

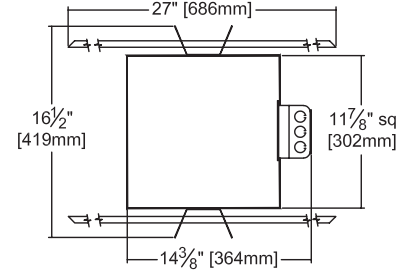

Photometry - Installed Complete Fixture

Photometry from I.T.L., Boulder, CO

LM-79 IESNA Certified Photometry from Independent Lab

-1500L-PNR-SPT

| Dist. | FC | Dia. |
|-------|-------|------|
| 6 | 133.2 | 2.7 |
| 8 | 74.9 | 3.6 |
| 10 | 47.9 | 4.5 |
| 12 | 33.3 | 5.4 |
| 14 | 24.5 | 6.3 |
| 16 | 18.7 | 7.2 |

Lumens: 1647
LPW: 80
Beam: ~27°
SC: 0.45
ITL Test: 94082

| Nominal Lumens | Actual Lumens | Actual LPW |
|----------------|---------------|------------|
| 2500L | 2158 | 78.5 |
| 2000L | 1915 | 77.5 |
| 1500L | 1647 | 79.6 |
| 1200L | 1199 | 83.3 |
| 1000L | 878 | 82.0 |

-1500L-PNR-MFL

| Dist. | FC | Dia. |
|-------|------|------|
| 6 | 64.4 | 4.6 |
| 8 | 36.2 | 6.2 |
| 10 | 23.2 | 7.7 |
| 12 | 16.1 | 9.3 |
| 14 | 11.8 | 10.8 |
| 16 | 9.1 | 12.4 |

Lumens: 1651
LPW: 80
Beam: ~49°
SC: 0.76
ITL Test: 94036

| Nominal Lumens | Actual Lumens | Actual LPW |
|----------------|---------------|------------|
| 2500L | 2163 | 78.6 |
| 2000L | 1920 | 77.7 |
| 1500L | 1651 | 79.8 |
| 1200L | 1202 | 83.5 |
| 1000L | 880 | 82.2 |

-1500L-PNR-WFL

| Dist. | FC | Dia. |
|-------|------|------|
| 6 | 48.7 | 5.5 |
| 8 | 27.4 | 7.4 |
| 10 | 17.5 | 9.2 |
| 12 | 12.2 | 11.0 |
| 14 | 8.9 | 12.9 |
| 16 | 6.9 | 14.7 |

Lumens: 1642
LPW: 79
Beam: ~60°
SC: 0.90
ITL Test: 94037

| Nominal Lumens | Actual Lumens | Actual LPW |
|----------------|---------------|------------|
| 2500L | 2151 | 78.2 |
| 2000L | 1910 | 77.3 |
| 1500L | 1642 | 79.3 |
| 1200L | 1195 | 83.0 |
| 1000L | 875 | 81.8 |

-1500L-PNS-SPT

| Dist. | FC | Dia. |
|-------|-------|------|
| 6 | 133.2 | 2.7 |
| 8 | 74.9 | 3.7 |
| 10 | 48.0 | 4.6 |
| 12 | 33.3 | 5.5 |
| 14 | 24.5 | 6.4 |
| 16 | 18.7 | 7.3 |

Lumens: 1747
LPW: 84
Beam: ~27°
SC: 0.46
ITL Test: 94084

| Nominal Lumens | Actual Lumens | Actual LPW |
|----------------|---------------|------------|
| 2500L | 2289 | 83.2 |
| 2000L | 2032 | 82.3 |
| 1500L | 1747 | 84.4 |
| 1200L | 1272 | 88.3 |
| 1000L | 931 | 87.0 |

-1500L-PNS-MFL

| Dist. | FC | Dia. |
|-------|------|------|
| 6 | 70.6 | 4.2 |
| 8 | 39.7 | 5.5 |
| 10 | 25.4 | 6.9 |
| 12 | 17.6 | 8.3 |
| 14 | 13.0 | 9.7 |
| 16 | 9.9 | 11.1 |

Lumens: 1729
LPW: 84
Beam: ~43°
SC: 0.69
ITL Test: 94085

| Nominal Lumens | Actual Lumens | Actual LPW |
|----------------|---------------|------------|
| 2500L | 2265 | 82.4 |
| 2000L | 2011 | 81.4 |
| 1500L | 1729 | 83.5 |
| 1200L | 1259 | 87.4 |
| 1000L | 922 | 86.1 |

-1500L-PNS-WFL

| Dist. | FC | Dia. |
|-------|------|------|
| 6 | 64.4 | 4.7 |
| 8 | 36.2 | 6.2 |
| 10 | 23.2 | 7.8 |
| 12 | 16.1 | 9.4 |
| 14 | 11.8 | 10.9 |
| 16 | 9.1 | 12.5 |

Lumens: 1757
LPW: 85
Beam: ~49°
SC: 0.78
ITL Test: 94038

| Nominal Lumens | Actual Lumens | Actual LPW |
|----------------|---------------|------------|
| 2500L | 2302 | 83.7 |
| 2000L | 2043 | 82.7 |
| 1500L | 1757 | 84.9 |
| 1200L | 1279 | 88.8 |
| 1000L | 936 | 87.5 |

LED manufacturers maintain a tolerance of +/-7% on flux (lumens) and power (electrical) measurements.

▲ Cone of Light Key Dist. Distance (Ft.) from fixture
Dia. (in ft.) shown is where FC FC Footcandles at nadir (0°)
value is half the FC at nadir. Dia. Circle of light at 50% of FC

LIMITED WARRANTY: CATALOGED KIRLIN FIXTURES ARE WARRANTED FREE OF DEFECTS IN WORKMANSHIP OR MATERIAL FOR A PERIOD OF TWO YEARS FROM DATE OF PURCHASE. INSTALLATION MUST BE BY AN INDEPENDENT CONTRACTOR. THE WARRANTY DOES NOT COVER DAMAGE TO THE FIXTURE OR TO THE SURFACE IT IS MOUNTED ON. THE WARRANTY IS VOID IF THE FIXTURE IS NOT INSTALLED AS SHOWN IN THE INSTALLATION MANUAL. THE WARRANTY IS VOID IF THE FIXTURE IS USED IN A MANNER NOT INTENDED BY THE MANUFACTURER. THE WARRANTY IS VOID IF THE FIXTURE IS USED IN A MANNER NOT INTENDED BY THE MANUFACTURER. THE WARRANTY IS VOID IF THE FIXTURE IS USED IN A MANNER NOT INTENDED BY THE MANUFACTURER.

CHOICE SERIES
APR 2021