

CATALOG #	TYPE	
JOB NAME	WATTAGE	VOLTAGE

11" 1 PS25 300 WATT MAXIMUM

IRR-11138

Higher Wattage • Uniform Lighting

Specifications

Lamp / Socket

- Designed for one horizontal frosted incandescent lamp (by others): 300W maximum PS25.
- Dimmable (controls by others).
- Glazed porcelain medium base socket.

Reflector

- Specular Alzak® aluminum.

Trim Assembly

- Tapered aluminum one piece black OptiGroove with white flange or all white smooth self-flanged trim (Option -40).
- Regressed tempered prismatic C#73 glass lens.
- Optional lenses and trims available.

Aluminum Housing

- Cool. Acrylic enameled 100% aluminum.
- Rustproof and corrosion resistant: Exceeds 1000 hour ASTM 5% salt spray test.
- Dissipates heat across entire surface area extending component life.

- Entire luminaire visible and serviceable from below through aperture.
- Built-in plaster frame. Also see Option -79.

Outlet Box and Thermal Protection

- UL listed J-box with insulated removable cover. Prewired 14 GA (NEC) with ½" and ¾" knockouts.
- Thermal protector (per current NEC) provides automatic cut-off if rated temperature is exceeded.

Installation

- 27" galvanized hanger bars supplied (2).
- Fully adjustable universal galvanized mounting brackets supplied (2).
- Recesses indoor or outdoor in covered ceilings.

UL, C-UL (Canada) Listings

- Wet, damp or dry locations, covered ceilings.
- Through-branch conductors (6 #12 AWG 90°C).

Three Year Limited Warranty

- Complete standard fixture.

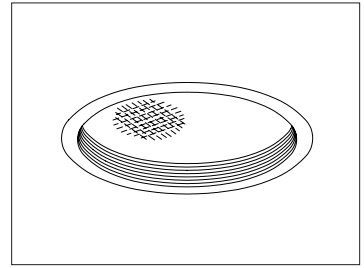

Recessed Round
Regressed
Lens

Performance at a Glance

IRR-11138



Exceptional
Energy
Efficiency

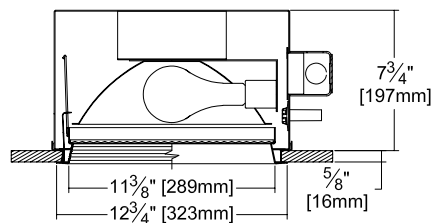

Option -40 Also Shown

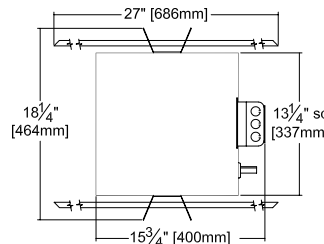

Ceiling Cut-out 8" Dia.

IRR-11138 (300 Watt)

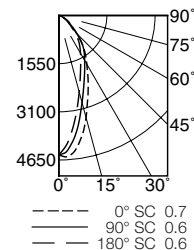

Cone of Light*

Dist.	FC	Dia.
6	124.7	3.8
8	70.1	5.1
10	44.9	6.3
12	31.2	7.6
14	22.9	8.8
16	17.5	10.1

EFFICIENCY: 66.6%

ITL TEST #44686

Cone of Light Key

- Ft. Distance from fixture
- FC Footcandles at nadir (0°)
- Dia. Circle of light at 50% of FC

* Dia. (in ft.) shown is where FC value is half the FC at nadir.

THE KIRLIN COMPANY

3401 EAST JEFFERSON AVENUE • DETROIT, MICHIGAN 48207-4232
(313) 259-6400 • Fax: (313) 259-9409 OR (313) 259-3121 • www.kirlinlighting.com

TUNGSTEN HALOGEN &
INCANDESCENT LIGHTING

MAXIMUM WATTAGE

300

CATALOG NUMBER

IRR-11138

DUE TO OUR CONTINUING EFFORT TO IMPROVE PRODUCTS, TECHNICAL INFORMATION IS SUBJECT TO CHANGE WITHOUT NOTICE.

Alzak® is a registered trademark of ALCOA.

Detailed Photometry - Installed Fixture

Photometry from I.T.L., Boulder, CO

IRR-11138 (300 Watt)

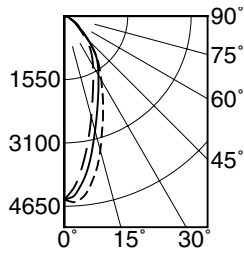

---- 0° SC 0.7
 ——— 90° SC 0.6
 ——— 180° SC 0.6



EFFICIENCY : 66.6%

CANDLEPOWER DISTRIBUTION					
	0.0	45.0	90.0	135.0	180.0
0	4489	4489	4489	4489	4489
5	4497	4422	4218	4059	3969
15	3398	3318	2901	2798	2546
25	2232	2229	1972	1853	1673
35	1477	1474	1423	1253	1172
45	834	855	818	722	683
55	429	371	415	331	356
65	196	195	184	171	172
75	72	74	72	68	63
85	3	5	3	5	3
90	0	0	0	0	0

COEFFICIENTS OF UTILIZATION							
RF	20						
RC	80				50		
RW	70	50	30	10	50	30	10
1	75	72	70	68	68	67	65
2	70	66	62	60	62	60	58
3	65	60	56	53	57	54	51
4	61	55	50	47	53	49	46
5	57	51	46	42	49	45	42
6	54	47	42	39	45	41	38
7	51	43	39	35	42	38	35
8	48	40	36	33	39	35	32
9	45	38	33	30	37	33	30
10	43	36	31	28	35	31	28

ITL TEST #44686

Options

Wattage and Voltage

- 58 277/120 volt stepdown transformer for 277 volt line input, prewired into fixture; with 277 volt thermal protector.

Lenses and Trims

- 18 Opal flat glass. Not enameled. Diffusing.
- 20 White 1/2" cube eggcrate aluminum louver.

- 32 White oversize trim ring. Specify O.D.
- 33 Decorative tempered glass Glow Ring suspended trim assembly.
- 40 White grooveless flare trim. (CP x 1.10)
- 45 Gasket between ceiling and trim flange.
- 46 Gasket between trim and lens.
- 94 Custom color/finish. Specify. Consult factory.
- FR Fresnel tempered glass lens.

- FT Flat white trim. With C#73 spread lens or specify optional lens.
- HO Holophane concave prismatic tempered lens.

Other

- 99 Special modification. Consult factory.

SUBMITTAL DATA

JOB NAME

TYPE

WATTAGE

VOLTAGE

CATALOG NUMBER

APPROVAL STAMP

LIMITED WARRANTY: CATALOGED KIRLIN FIXTURES ARE WARRANTED FREE OF DEFECTS IN WORKMANSHIP OR MATERIAL FOR THREE YEARS FROM DATE OF PURCHASE. INSTALLATION TO N.E.C. IN NORMAL USE. Manufacturer at the option will replace or repair such fixture or refund the purchase price on presentation of proof of purchase and defective fixture at the offices of manufacturer within three years of original shipment. Liability of manufacturer is limited to the foregoing, and manufacturer shall not be liable for any other damages, direct or indirect, sustained or suffered by purchaser or any person. This warranty is subject to the buyer in place of all other warranties, expressed or implied. Seller does not warrant as to merchantability or fitness for a particular use, nor will any oral statement constitute a warranty or amend this specific warranty. Abnormal use, abuse of the fixture, improper installation, or repair or modification of the fixture without prior written authorization from the manufacturer will render the warranty void.