

CATALOG #	TYPE	
JOB NAME	WATTAGE	VOLTAGE

11" 1 PAR 56 500 WATT MAXIMUM

IRR-11101

Dramatic Highlighting for High Ceilings

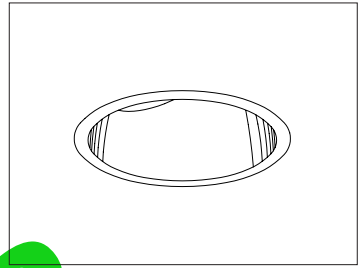

Specifications

Lamp Assembly

- Designed for 1 vertical tungsten halogen lamp (by others):
500W maximum PAR 56.
- Rated 4000 hour life. 100 CRI.
- Tilts 150° for relamping.
- Safety tempered clear flat glass provided.
- Optional safety tempered prismatic C#73 flat glass converts oval beam pattern to round. See Option -15 (for use with medium flood lamp).

Socket Assembly

- Adjustable. 360° rotation; 30° maximum tilt.
- Porcelain mogul end-prong socket.

Reflector

- Self-flanged parabolic specular Alzak® aluminum.
- Optional reflector finishes and colors available.

Aluminum Housing

- Cool. Acrylic enameled 100% aluminum.
- Rustproof and corrosion resistant: Exceeds 1000 hour ASTM 5% salt spray test.

- Dissipates heat across entire surface area extending component life.
- Entire luminaire visible and serviceable from below through aperture.
- For top access, see Option -TA.
- Built-in plaster frame.

Outlet Box and Thermal Protection

- UL listed J-box with insulated removable cover. Prewired 14 GA (NEC) with 1/2" and 3/4" knockouts.
- Thermal protector (per current NEC) provides automatic cut-off if rated temperature is exceeded.

Installation

- 27" galvanized hanger bars supplied (2).
- Fully adjustable universal galvanized mounting brackets supplied (2).
- Recesses indoor or outdoor in covered ceilings.

UL, C-UL (Canada) Listings

- Wet, damp or dry locations, covered ceilings.
- Through branch conductors (6 #12 AWG 105°C).

Three Year Limited Warranty

- Complete standard fixture.

Recessed Round
Open Appearance
Adjustable

Performance at a Glance

IRR-11101

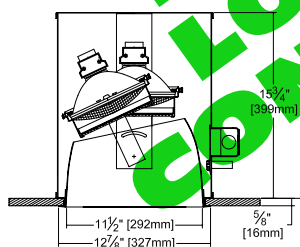

IRR-11101 (500W Narrow Spot)

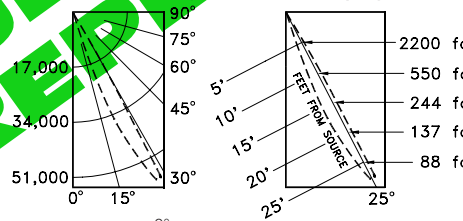

EFFICIENCY: 75.9%
ITL TEST #43326

IRR-11101-15 (500W Medium Flood)

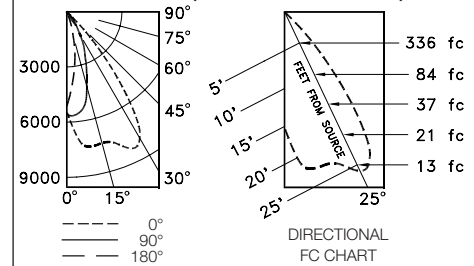

EFFICIENCY: 64.8%
ITL TEST #43324

Ceiling Cut-out
12 1/4" Dia.

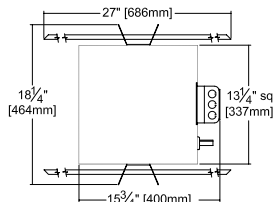

"MARKED SPACINGS CAUTION"

INSTALL WITH MINIMUM SPACINGS AS FOLLOWS:
2 FEET BETWEEN CENTERS OF ADJACENT FIXTURES;
1/2" BETWEEN FIXTURE TOP AND OVERHEAD BUILDING MEMBER;
1 FOOT BETWEEN FIXTURE CENTER AND SIDE WALL.



Exceptional
Energy
Efficiency

PHOTOMETRIC DATA SHOWN AT 25° TILT

THE KIRLIN COMPANY

3401 EAST JEFFERSON AVENUE • DETROIT, MICHIGAN 48207-4232
(313) 259-6400 • Fax: (313) 259-9409 OR (313) 259-3121 • www.kirlinlighting.com

TUNGSTEN HALOGEN &
INCANDESCENT LIGHTING

MAXIMUM WATTAGE

500

CATALOG NUMBER

IRR-11101

DUE TO OUR CONTINUING EFFORT TO IMPROVE PRODUCTS, TECHNICAL INFORMATION IS SUBJECT TO CHANGE WITHOUT NOTICE.

Alzak® is a registered trademark of ALCOA.

Detailed Photometry - Installed Fixture

Photometry from I.T.L., Boulder, CO

IRR-11101 (500W Narrow Spot)

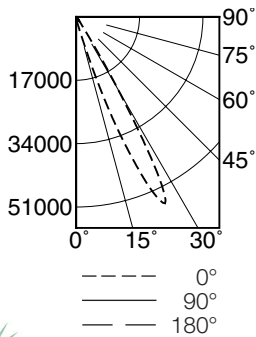

EFFICIENCY : 75.9%

CANDLEPOWER DISTRIBUTION					
	0.0	45.0	90.0	135.0	180.0
0	920	920	920	920	920
5	1041	1020	968	916	812
15	4476	1988	1072	833	770
25	55025	18571	1114	802	83
35	2290	3737	2186	1530	708
45	104	62	42	42	62
55	21	19	19	19	19
65	0	0	0	0	0
75	0	0	0	0	0
85	0	0	0	0	0
90	0	0	0	0	0

COEFFICIENTS OF UTILIZATION							
RF	20						
RC	80			50			
RW	70	50	30	10	50	30	10
1	86	84	82	80	79	78	76
2	81	77	74	71	74	71	69
3	77	72	68	64	69	65	63
4	72	66	62	58	64	60	57
5	68	61	57	53	59	55	52
6	64	57	52	48	55	51	48
7	60	53	48	44	51	47	44
8	57	49	44	41	48	43	40
9	54	46	41	37	44	40	37
10	50	42	37	34	41	37	34

ITL TEST #43326

IRR-11101 (500W Medium Flood)

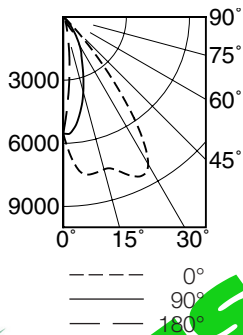

EFFICIENCY : 64.8%

CANDLEPOWER DISTRIBUTION					
	0.0	45.0	90.0	135.0	180.0
0	5537	5537	5537	5537	5537
5	7143	6974	6328	5375	3213
15	7495	6732	5270	3683	764
25	8366	5929	3401	2055	260
35	5880	4348	1708	1008	938
45	813	907	344	288	383
55	60	70	61	66	69
65	2	3	5	8	6
75	0	1	3	3	0
85	0	0	1	1	0
90	0	0	0	0	0

COEFFICIENTS OF UTILIZATION							
RF	20						
RC	80			50			
RW	70	50	30	10	50	30	10
1	73	72	70	68	68	66	65
2	70	66	64	61	63	61	59
3	66	62	58	56	59	56	54
4	62	57	54	51	55	52	50
5	59	53	49	47	52	48	46
6	56	50	46	43	48	45	43
7	53	47	43	40	45	42	39
8	50	44	40	37	43	39	37
9	48	41	37	35	40	37	34
10	45	39	35	32	38	35	32

ITL TEST #43324

Options

Lenses and Trims

- 15 Safety tempered prismatic C#73 flat glass for use with medium flood lamp. Converts oval beam pattern to round. See Option -LP.
- 16 Champagne Gold specular Alzak reflector. (CP x .98)
- 30 All white reflector. (CP x .98)
- 31 White flange (only) on self-flanged reflector.
- 32 White oversize trim ring. Specify O.D.

- 45 Gasket between ceiling and reflector flange.
- 63 Dune specular Alzak reflector. (CP x .97)
- 69 Wheat specular Alzak reflector. (CP x .98)
- 70 SofTex clear reflector. (CP x .98)
- 71 SofTex Dune reflector. (CP x .95)
- 72 Black specular Alzak reflector. (CP x .80)
- 91 SofTex Wheat reflector. (CP x .95)
- 93 Pewter specular Alzak reflector. (CP x .95)
- 94 Custom color/finish. Specify. Consult factory.

- OG OptiGroove black seamless tapered aluminum reflector. White trim, self-flanged. (CP x .82)

Other

- 99 Special modification. Consult factory.
- LP With PAR 56 lamp. Specify wattage and beam spread. With medium flood, also select -15.
- TA Top access for servicing from above.

SUBMITTAL DATA

APPROVAL STAMP

JOB NAME

TYPE

WATTAGE

VOLTAGE

CATALOG NUMBER

LIMITED WARRANTY: CATALOGED KIRLIN FIXTURES ARE WARRANTED FREE OF DEFECTS IN WORKMANSHIP OR MATERIAL FOR THREE YEARS FROM DATE OF PURCHASE. INSTALLATION TO N.E.C. IS NORMAL USE. Manufacturer of the fixture will replace or repair such fixture or refund the purchase price on presentation of proof of purchase and defective fixture at the offices of manufacturer within three years of original shipment. Liability of manufacturer is limited to the foregoing and manufacturer shall not be liable for any other damages, direct or indirect, sustained or suffered by purchaser or any person. This warranty is subject to the terms in place of all other warranties, expressed or implied. Seller does not warrant as to merchantability or fitness for a particular use, nor will any oral statement constitute a warranty or amend this specific warranty. Abnormal use, abuse of the fixture, improper installation, or repair, or modification of the fixture without prior written authorization from the manufacturer will render the warranty void.