

CATALOG #	TYPE	
JOB NAME	WATTAGE	VOLTAGE

8" 1 A23 200 WATT MAXIMUM

IRR-08137

## Higher Wattage • Uniform Lighting

### Specifications

#### Lamp / Socket

- Designed for one horizontal frosted incandescent lamp (by others): 200W maximum A23.
- Dimmable (controls by others).
- Glazed porcelain medium base socket.

#### Reflector

- Specular Alzak® aluminum.

#### Trim Assembly

- Tapered aluminum one piece black OptiGroove with white flange or all white smooth self-flanged trim (Option -40).
- Regressed tempered prismatic C#73 glass lens.
- Optional lenses and trims available.

#### Aluminum Housing

- Cool. Acrylic enameled 100% aluminum.
- Rustproof and corrosion resistant: Exceeds 1000 hour ASTM 5% salt spray test.
- Dissipates heat across entire surface area extending component life.

- Entire luminaire visible and serviceable from below through aperture.
- Built-in plaster frame. Also see Option -79.

#### Outlet Box and Thermal Protection

- UL listed J-box with insulated removable cover. Prewired 14 GA (NEC) with ½" and ¾" knockouts.
- Thermal protector (per current NEC) provides automatic cut-off if rated temperature is exceeded.

#### Installation

- 27" galvanized hanger bars supplied (2).
- Fully adjustable universal galvanized mounting brackets supplied (2).
- Recesses indoor or outdoor in covered ceilings.

#### UL, C-UL (Canada) Listings

- Wet, damp or dry locations, covered ceilings.
- Through-branch conductors (6 #12 AWG 90°C).

#### Three Year Limited Warranty

- Complete standard fixture.

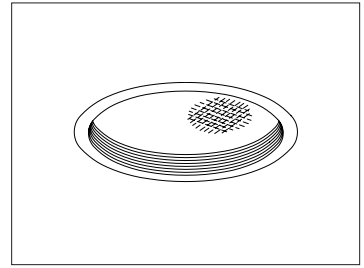

Recessed Round  
Regressed Lens  
Shallow Plenum

### Performance at a Glance

IRR-08137

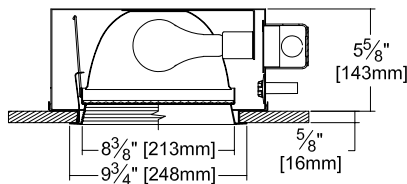

Option -40 Also Shown

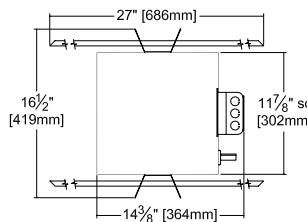

Ceiling Cut-out  
6 1/2" Dia.

IRR-08137 (200 Watt)

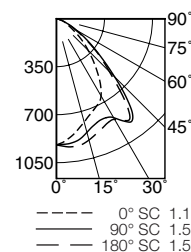

#### Cone of Light\*

Dist.	FC	Dia.
6	25.6	7.5
8	14.4	10.0
10	9.2	12.6
12	6.4	15.1
14	4.7	17.6
16	3.6	20.1

EFFICIENCY: 48.9%

ITL TEST #39089

#### Cone of Light Key

- Ft. Distance from fixture
- FC Footcandles at nadir (0°)
- Dia. Circle of light at 50% of FC

\* Dia. (in ft.) shown is where FC value is half the FC at nadir.

## THE KIRLIN COMPANY

3401 EAST JEFFERSON AVENUE • DETROIT, MICHIGAN 48207-4232  
(313) 259-6400 • Fax: (313) 259-9409 OR (313) 259-3121 • www.kirlinlighting.com

TUNGSTEN HALOGEN &  
INCANDESCENT LIGHTING

MAXIMUM WATTAGE

200

CATALOG NUMBER

IRR-08137

DUE TO OUR CONTINUING EFFORT TO IMPROVE PRODUCTS, TECHNICAL INFORMATION IS SUBJECT TO CHANGE WITHOUT NOTICE.

Alzak® is a registered trademark of ALCOA.

## Detailed Photometry - Installed Fixture

Photometry from I.T.L., Boulder, CO

## IRR-08137 (150 Watt)

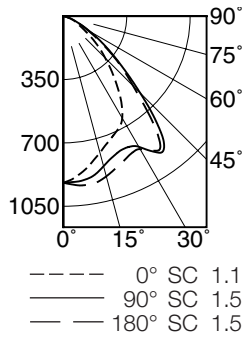

EFFICIENCY : 48.9%

CANDLEPOWER DISTRIBUTION					
	0.0	45.0	90.0	135.0	180.0
0	920	920	920	920	920
5	885	896	917	934	938
15	781	805	858	895	916
25	399	732	805	860	852
35	550	738	921	1012	907
45	327	454	600	604	545
55	159	214	273	271	256
65	73	86	97	97	95
75	20	24	26	20	19
85	0	0	0	0	0
90	0	0	0	0	0

COEFFICIENTS OF UTILIZATION							
RF	20						
RC	80				50		
RW	70	50	30	10	50	30	10
1	55	53	51	50	50	48	47
2	51	47	45	42	45	43	41
3	47	43	39	37	40	38	36
4	43	38	35	32	37	34	31
5	40	35	31	28	33	30	28
6	37	32	28	25	30	27	25
7	35	29	25	22	28	24	22
8	32	26	23	20	25	22	20
9	30	24	21	18	24	20	18
10	28	22	19	17	22	19	16

ITL TEST #39089

## Options

## Wattage and Voltage

- 58 277/120 volt stepdown transformer for 277 volt line input, prewired into fixture; with 277 volt thermal protector.

## Lenses and Trims

- 18 Opal flat glass. Not enameled. Diffusing.
- 20 White 1/2" cube eggcrate aluminum louver.

- 32 White oversize trim ring. Specify O.D.
- 33 Decorative tempered glass Glow Ring suspended trim assembly.
- 40 White grooveless flare trim. (CP x 1.10)
- 45 Gasket between ceiling and trim flange.
- 46 Gasket between trim and lens.
- 82 Sloped ceiling adapter. Specify slope in 5° increments up to 30°.

- 94 Custom color/finish. Specify. Consult factory.
- FR Fresnel tempered glass lens.
- FT Flat white trim. With C#73 spread lens or specify optional lens.
- HO Holophane concave prismatic tempered lens.

## Other

- 99 Special modification. Consult factory.

## SUBMITTAL DATA

JOB NAME

TYPE

WATTAGE

VOLTAGE

CATALOG NUMBER

## APPROVAL STAMP

LIMITED WARRANTY: CATALOGED KIRLIN FIXTURES ARE WARRANTED FREE OF DEFECTS IN WORKMANSHIP OR MATERIAL FOR THREE YEARS FROM DATE OF PURCHASE. INSTALLATION TO N.E.C. IN NORMAL USE. Manufacturer at the option will replace or repair such fixture or refund the purchase price on presentation of proof of purchase and defective fixture at the offices of manufacturer within three years of original shipment. Liability of manufacturer is limited to the foregoing, and manufacturer shall not be liable for any other damages, direct or indirect, sustained or suffered by purchaser or any person. This warranty is subject to the buyer in place of all other warranties, expressed or implied. Seller does not warrant as to merchantability or fitness for a particular use, nor will any oral statement constitute a warranty or amend this specific warranty. Abnormal use, abuse of the fixture, improper installation, or repair or modification of the fixture without prior written authorization from the manufacturer will render the warranty void.