

CATALOG #	TYPE	
JOB NAME	WATTAGE	VOLTAGE

7" 1 A21 150 WATT MAXIMUM

IRR-07136

Regressed Lens: Streamlined 6¼" Depth

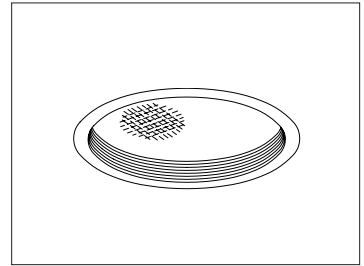

Specifications

Lamp / Socket

- Designed for one horizontal frosted incandescent lamp (by others): 150W maximum A21.
- Dimmable (controls by others).
- Glazed porcelain medium base socket.

Reflector

- Specular Alzak® aluminum.

Trim Assembly

- Tapered aluminum one piece black OptiGroove with white flange or all white smooth self-flanged trim (Option -40).
- Regressed tempered prismatic C#73 glass lens.
- Optional lenses and trims available.

Aluminum Housing

- Cool. Acrylic enameled 100% aluminum.
- Rustproof and corrosion resistant: Exceeds 1000 hour ASTM 5% salt spray test.
- Dissipates heat across entire surface area extending component life.

- Entire luminaire visible and serviceable from below through aperture.
- Built-in plaster frame. Also see Option -79.

Outlet Box and Thermal Protection

- UL listed J-box with insulated removable cover. Prewired 14 GA (NEC) with ½" and ¾" knockouts.
- Thermal protector (per current NEC) provides automatic cut-off if rated temperature is exceeded.

Installation

- 27" galvanized hanger bars supplied (2).
- Fully adjustable universal galvanized mounting brackets supplied (2).
- Recesses indoor or outdoor in covered ceilings.

UL, C-UL (Canada) Listings

- Wet, damp or dry locations, covered ceilings.
- Through-branch conductors (6 #12 AWG 90°C).

Three Year Limited Warranty

- Complete standard fixture.

Recessed Round
Regressed Lens
Shallow Plenum

Performance at a Glance

IRR-07136

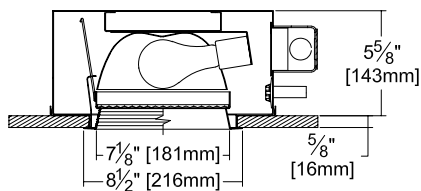

Option -40 Also Shown

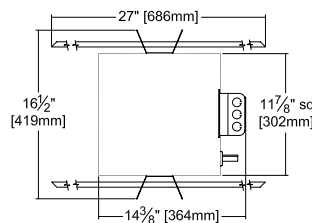

Ceiling Cut-out
8" Dia.

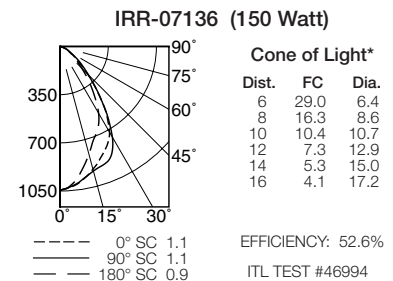

Cone of Light Key

- Ft. Distance from fixture
- FC Footcandles at nadir (0°)
- Dia. Circle of light at 50% of FC

* Dia. (in ft.) shown is where FC value is half the FC at nadir.

THE KIRLIN COMPANY

3401 EAST JEFFERSON AVENUE • DETROIT, MICHIGAN 48207-4232
(313) 259-6400 • Fax: (313) 259-9409 OR (313) 259-3121 • www.kirlinlighting.com

TUNGSTEN HALOGEN &
INCANDESCENT LIGHTING

MAXIMUM WATTAGE

150

CATALOG NUMBER

IRR-07136

Detailed Photometry - Installed Fixture

Photometry from I.T.L., Boulder, CO

IRR-07136 (150 Watt)

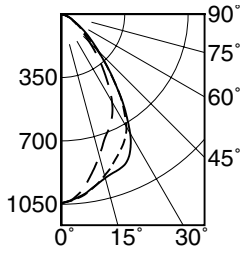

--- 0° SC 1.1
 — 90° SC 1.1
 - - 180° SC 0.9



EFFICIENCY : 52.6%

CANDLEPOWER DISTRIBUTION					
	0.0	45.0	90.0	135.0	180.0
0	1044	1044	1044	1044	1044
5	1021	1031	1017	1012	1004
15	923	966	937	861	810
25	801	921	877	754	652
35	581	599	588	488	434
45	282	297	291	252	222
55	122	142	138	127	109
65	53	60	59	61	62
75	13	18	21	20	19
85	2	6	6	6	6
90	0	0	0	0	0

COEFFICIENTS OF UTILIZATION							
RF	20						
RC	80				50		
RW	70	50	30	10	50	30	10
1	59	57	55	54	54	53	51
2	55	52	49	47	49	47	45
3	51	47	44	41	45	42	40
4	48	43	39	37	41	38	36
5	45	39	36	33	38	35	32
6	42	36	32	30	35	32	29
7	39	34	30	27	32	29	27
8	37	31	27	25	30	27	25
9	35	29	25	23	28	25	23
10	33	27	23	21	26	23	21

ITL TEST #46994

Options

Wattage and Voltage

- 58 277/120 volt stepdown transformer for 277 volt line input, prewired into fixture; with 277 volt thermal protector.

Lenses and Trims

- 18 Opal flat glass. Not enameled. Diffusing.
- 20 White 1/2" cube eggcrate aluminum louver.

- 32 White oversize trim ring. Specify O.D.
- 33 Decorative tempered glass Glow Ring suspended trim assembly.
- 40 White grooveless flare trim. (CP x 1.10)
- 45 Gasket between ceiling and trim flange.
- 46 Gasket between trim and lens.
- 94 Custom color/finish. Specify. Consult factory.

- FR Fresnel tempered glass lens.
- FT Flat white trim. With C#73 spread lens or specify optional lens.

Other

- 99 Special modification. Consult factory.

SUBMITTAL DATA

JOB NAME
 TYPE
 WATTAGE VOLTAGE
 CATALOG NUMBER

APPROVAL STAMP

LIMITED WARRANTY: CATALOGED KIRLIN FIXTURES ARE WARRANTED FREE OF DEFECTS IN WORKMANSHIP OR MATERIAL FOR THREE YEARS FROM DATE OF PURCHASE. INSTALL TO N.E.C. IN NORMAL USE. Manufacturer of the option will replace or repair such fixture or refund the purchase price on presentation of proof of purchase and defective fixture at the offices of manufacturer within three years of original shipment. Liability of manufacturer is limited to the foregoing and manufacturer shall not be liable for any other damages, direct or indirect, sustained or suffered by purchaser or any person. This warranty is supplied in place of all other warranties, expressed or implied. Seller does not warrant as to merchantability or fitness for a particular use, nor will any oral statement constitute a warranty or amend this specific warranty. Abnormal use, abuse of the fixture, improper installation, or repair or modification of the fixture without prior written authorization from the manufacturer will render the warranty void.