

CATALOG #	TYPE	
JOB NAME	WATTAGE	VOLTAGE

7" 1 PAR 38 250 WATT MAXIMUM

IRR-07096

## Dramatic Adjustable PAR 38 Highlight

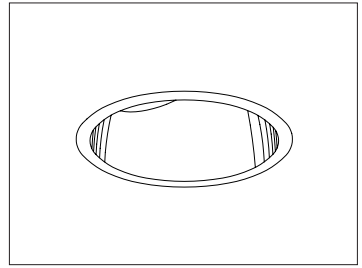

Recessed Round  
Open  
Adjustable

### Specifications

#### Lamp / Socket Assembly

- Designed for tungsten halogen lamp (by others): 250W maximum PAR 38.
- Rated 4200 hour life. 100 CRI.
- Dimmable (controls by others).
- Swivels 358° and tilts up to 45°.
- Glazed porcelain medium base socket.

#### Reflector

- Self-flanged parabolic specular Alzak® aluminum.
- Optional reflector finishes and colors available.

#### Aluminum Housing

- Cool. Acrylic enameled 100% aluminum.
- Rustproof and corrosion resistant: Exceeds 1000 hour ASTM 5% salt spray test.
- Dissipates heat across entire surface area extending component life.

- Entire luminaire visible and serviceable from below through aperture.
- Built-in plaster frame. Also see Option -79.

#### Outlet Box and Thermal Protection

- UL listed J-box with insulated removable cover. Prewired 14 GA (NEC) with 1/2" and 3/4" knockouts.
- Thermal protector (per current NEC) provides automatic cut-off if rated temperature is exceeded.

#### Installation

- 27" galvanized hanger bars supplied (2).
- Fully adjustable universal galvanized mounting brackets supplied (2).
- Recesses indoor or outdoor in covered ceilings.

#### UL, C-UL (Canada) Listings

- Wet, damp or dry locations, covered ceilings.
- Through-branch conductors (6 #12 AWG 90°C).

#### Three Year Limited Warranty

- Complete standard fixture.

### Performance at a Glance

IRR-07096

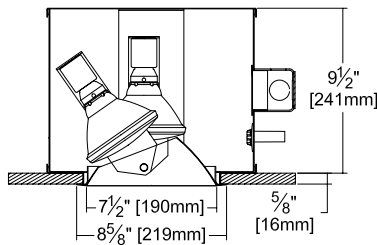

Ceiling  
Cut-out  
8" Dia.

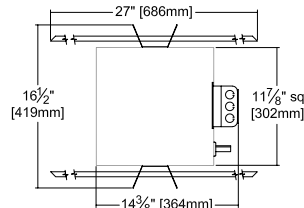

IRR-07096 (250W Spot)

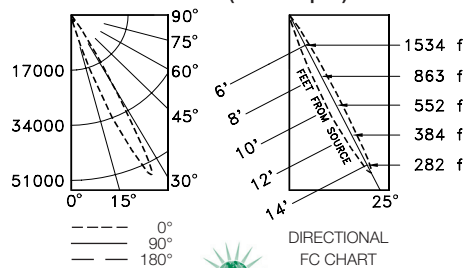

EFFICIENCY: 84.9%  
ITL TEST #46958



IRR-07096 (250W Flood)

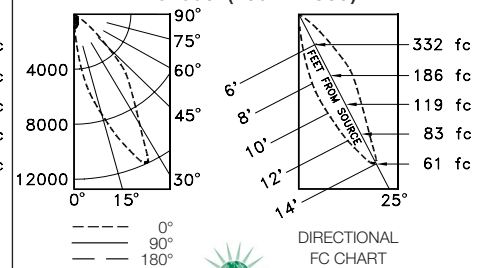

EFFICIENCY: 83.4%  
ITL TEST #46957



Exceptional  
Energy  
Efficiency

PHOTOMETRIC DATA  
SHOWN AT 25° TILT

## THE KIRLIN COMPANY

3401 EAST JEFFERSON AVENUE • DETROIT, MICHIGAN 48207-4232  
(313) 259-6400 • Fax: (313) 259-9409 OR (313) 259-3121 • www.kirlinlighting.com

TUNGSTEN HALOGEN &  
INCANDESCENT LIGHTING

MAXIMUM WATTAGE

250

CATALOG NUMBER

IRR-07096

DUE TO OUR CONTINUING EFFORT TO IMPROVE PRODUCTS, TECHNICAL INFORMATION IS SUBJECT TO CHANGE WITHOUT NOTICE.

Alzak® is a registered trademark of ALCOA.

Detailed Photometry - Installed Fixture

Photometry from I.T.L., Boulder, CO

**IRR-07096 (250W Spot)**

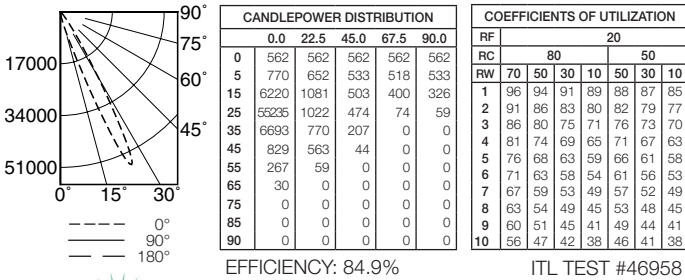

**IRR-07096 (250W Flood)**

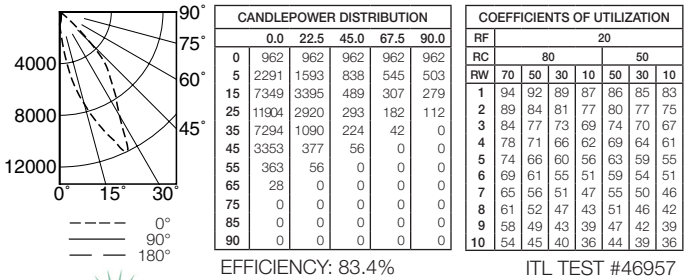

**IRR-07096 (120W Narrow Spot)**

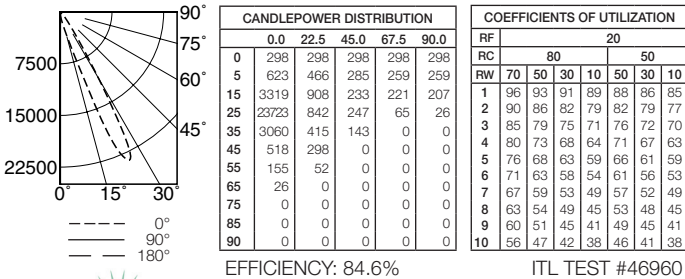

**IRR-07096 (120W Narrow Flood)**

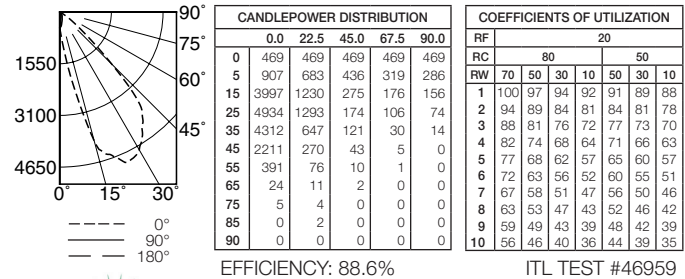

**Options**

**Wattage and Voltage**

- 58 277/120 volt stepdown transformer for 277 volt line input, prewired into fixture; with 277 volt thermal protector.

**Trims**

- 16 Champagne Gold specular Alzak reflector. (CP x .98)
- 30 All white reflector. (CP x .98)

- 31 White flange (only) on self-flanged reflector.
- 32 White oversize trim ring. Specify O.D.
- 45 Gasket between ceiling and reflector flange.
- 63 Dune specular Alzak reflector. (CP x .97)
- 69 Wheat specular Alzak reflector. (CP x .97)
- 70 SofTex clear reflector. (CP x .98)
- 71 SofTex Dune reflector. (CP x .95)
- 72 Black specular Alzak reflector. (CP x .80)
- 79 Extension collar for ceilings up to 2" thick.

- 91 SofTex Wheat reflector. (CP x .95)
- 93 Pewter specular Alzak reflector. (CP x .95)
- 94 Custom color/finish. Specify. Consult factory.

**Other**

- 99 Special modification. Consult factory.
- LP With PAR 38 lamp. Specify wattage and beam spread.

SUBMITTAL DATA

JOB NAME \_\_\_\_\_  
 TYPE \_\_\_\_\_  
 WATTAGE \_\_\_\_\_ VOLTAGE \_\_\_\_\_  
 CATALOG NUMBER \_\_\_\_\_

APPROVAL STAMP

LIMITED WARRANTY: CATALOGUED KIRLIN FIXTURES ARE WARRANTED FREE OF DEFECTS IN WORKMANSHIP OR MATERIAL FOR THREE YEARS FROM DATE OF PURCHASE. INSTALL TO N.E.C. IN NORMAL USE. Manufacturer of the option will replace or repair such fixture or refund the purchase price on presentation of proof of purchase and defective fixture at the office of manufacturer within three years of original shipment. Liability of manufacturer is limited to the foregoing and manufacturer shall not be liable for any other damages, direct or indirect, sustained or suffered by purchaser or any person. This warranty is subject to the buyer in place of all other warranties, expressed or implied. Seller does not warrant as to merchantability or fitness for a particular use, nor will any oral statement constitute a warranty or amend this specific warranty. Abuse of the fixture, improper installation, or repair or modification of the fixture without prior written authorization from the manufacturer will render the warranty void.