

CATALOG #	TYPE
JOB NAME	WATTAGE VOLTAGE

7" 1 PAR 38 120 WATT MAXIMUM Type IC - IRR-07086

## Type IC PAR 38 Halogen Downlight

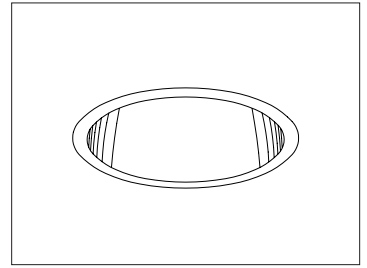

### Specifications

#### Lamp / Socket

- Designed for 1 vertical tungsten halogen lamp (by others): 250W maximum PAR 38.
- Rated 4200 hour life. 100 CRI.
- Dimmable (controls by others).
- Glazed porcelain medium base socket.

#### Reflector

- Self-flanged parabolic specular Alzak® aluminum.
- Optional reflector finishes and colors available.

#### Aluminum Housing

- Cool. Acrylic enameled 100% aluminum.
- Rustproof and corrosion resistant: Exceeds 1000 hour ASTM 5% salt spray test.
- Dissipates heat across entire surface area extending component life.
- Entire luminaire visible and serviceable from below through aperture.

- For top access, see Option -TA.
  - Built-in plaster frame. Also see Option -79.
- #### Outlet Box and Thermal Protection
- UL listed J-box with insulated removable cover. Prewired 14 GA (NEC) with 1/2" and 3/4" knockouts.
  - Thermal protector (per current NEC) provides automatic cut-off if rated wattage is exceeded.

#### Installation

- 27" galvanized hanger bars supplied (2).
- Fully adjustable universal galvanized mounting brackets supplied (2).
- Recesses indoor or outdoor in covered ceilings.

#### UL, C-UL (Canada) Listings

- Wet, damp or dry locations, covered ceilings.
- Through-branch conductors (6 #12 AWG 90°C).
- Type IC. Approved for direct contact with insulation.

#### Three Year Limited Warranty

- Complete standard fixture.

Recessed Round  
Open  
Single Reflector  
Type IC

### Performance at a Glance

IRR-07086: Type IC

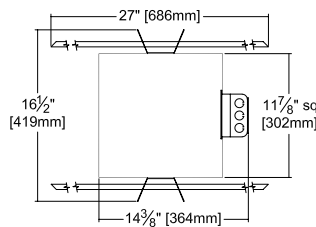
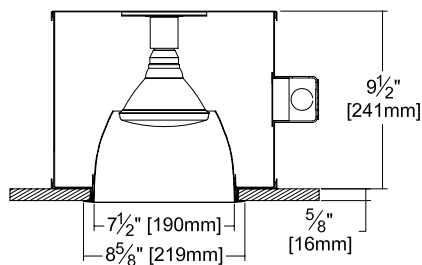

Ceiling Cut-out  
8" Dia.

IRR-07086 (120W Flood)

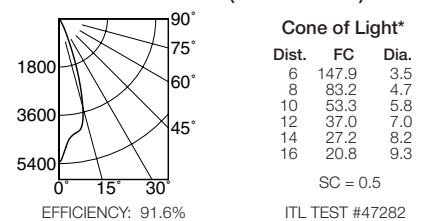

#### Cone of Light Key

- Ft. Distance from fixture
- FC Footcandles at nadir (0°)
- Dia. Circle of light at 50% of FC

\* Dia. (in ft.) shown is where FC value is half the FC at nadir.



Exceptional  
Energy  
Efficiency

## THE KIRLIN COMPANY

3401 EAST JEFFERSON AVENUE • DETROIT, MICHIGAN 48207-4232  
(313) 259-6400 • Fax: (313) 259-9409 OR (313) 259-3121 • www.kirlinlighting.com

TUNGSTEN HALOGEN &  
INCANDESCENT LIGHTING

MAXIMUM WATTAGE

120

CATALOG NUMBER

IRR-07086

DUE TO OUR CONTINUING EFFORT TO IMPROVE PRODUCTS, TECHNICAL INFORMATION IS SUBJECT TO CHANGE WITHOUT NOTICE.

Alzak® is a registered trademark of ALCOA.

## Detailed Photometry - Installed Fixture

Photometry from I.T.L., Boulder, CO

## IRR-07086 (120 Watt Flood)

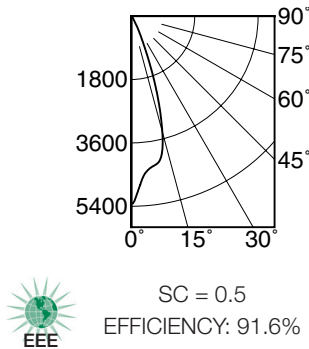

CANDLEPOWER DISTRIBUTION					
	0.0	22.5	45.0	67.5	90.0
0	5326	5326	5326	5326	5326
5	4483	4483	4483	4483	4483
15	3403	3403	3403	3403	3403
25	661	661	661	661	661
35	97	97	97	97	97
45	21	21	21	21	21
55	0	0	0	0	0
65	0	0	0	0	0
75	0	0	0	0	0
85	0	0	0	0	0
90	0	0	0	0	0

COEFFICIENTS OF UTILIZATION							
RF	20						
RC	80				50		
RW	70	50	30	10	50	30	10
1	105	103	101	100	98	96	95
2	102	98	95	93	94	92	90
3	98	93	90	87	91	87	85
4	95	89	86	83	87	84	81
5	91	86	82	79	83	80	78
6	88	82	78	75	80	77	75
7	86	79	75	72	78	74	72
8	83	76	72	70	75	72	69
9	80	74	70	67	73	69	67
10	78	71	67	65	70	67	64

ITL TEST #47282

## Options

## Trims

- 16 Champagne Gold specular Alzak reflector. (CP x .98)
- 30 All white reflector. (CP x .98)
- 31 White flange (only) on self-flanged reflector.
- 32 White oversize trim ring. Specify O.D.
- 45 Gasket between ceiling and reflector flange.
- 63 Dune specular Alzak reflector. (CP x .97)
- 69 Wheat specular Alzak reflector. (CP x .97)
- 70 Softex clear reflector. (CP x .98)
- 71 Softex Dune reflector. (CP x .95)
- 72 Black specular Alzak reflector. (CP x .80)
- 79 Extension collar for ceilings up to 2" thick.
- 91 Softex Wheat reflector. (CP x .95)
- 93 Pewter specular Alzak reflector. (CP x .95)
- 94 Custom color/finish. Specify. Consult factory.
- OG OptiGroove black seamless tapered aluminum reflector. White trim, self-flanged. (CP x .82)

## Other

- 99 Special modification. Consult factory.
- LP With PAR 38 lamp. Specify wattage and beam spread.
- TA Top access for servicing from above.

## SUBMITTAL DATA

JOB NAME

TYPE

WATTAGE

VOLTAGE

CATALOG NUMBER

## APPROVAL STAMP