

| | |
|-----------|-----------------|
| CATALOG # | TYPE |
| JOB NAME | WATTAGE VOLTAGE |

7" 1 T4 250 WATT MAXIMUM

IRR-07059

Church, Shopping Mall, Office Downlight

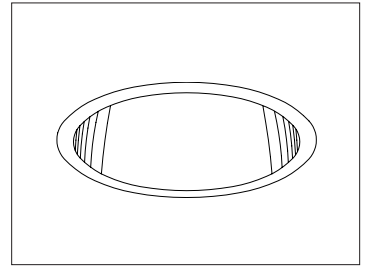

Recessed Round
Open
Appearance
Dual Reflector

Specifications

Lamp

- Designed for 1 vertical frosted T4 tungsten halogen lamp (by others): 250 watt maximum.

Lampholder

- Double contact bayonet. Heat resistant.
- Lamp socket bracket designed as heat sink.

Reflectors

- Upper: Specular Alzak® aluminum for precise control of source.
- Lower: Low brightness clear specular parabolic Alzak aluminum cone, self-flanged.
- Optional self-flanged lower cone finishes and colors available.
- Convection and radiation cooling by design.

Lens

- Tempered prismatic glass lens mounted to upper reflector (0.8 SC).

Aluminum Housing

- Cool. Acrylic enameled 100% aluminum.

- Rustproof and corrosion resistant: Exceeds 1000 hour ASTM 5% salt spray test.
- Dissipates heat across entire surface area extending component life.
- Entire luminaire visible and serviceable from below through aperture.
- For top access, see Option -TA.
- Built-in plaster frame. Also see Option -79.

Outlet Box and Thermal Protection

- UL listed J-box with insulated removable cover. Prewired 14 GA (NEC) with 1/2" and 3/4" knockouts.
- Thermal protector (per current NEC) provides automatic cut-off if rated temperature is exceeded.

Installation

- 27" galvanized hanger bars supplied (2).
- Fully adjustable universal galvanized mounting brackets supplied (2).
- Recesses indoor or outdoor in covered ceilings.

UL, C-UL (Canada) Listings

- Wet, damp or dry locations, covered ceilings.
- Through-branch conductors (6 #12 AWG 90°C).

Three Year Limited Warranty

- Complete standard fixture.

Performance at a Glance

IRR-07059

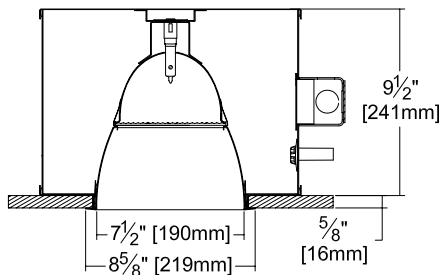

Cone of Light Key

- Ft. Distance from fixture
- FC Footcandles at nadir (0°)
- Dia. Circle of light at 50% of FC

* Dia. (in ft.) shown is where FC value is half the FC at nadir.

CAUTION: SINGLE ENDED T4 HALOGEN LAMPS MUST BE STARTED AT OR NEAR FULL VOLTAGE (120V) BEFORE DIMMING TO ENSURE MAXIMUM LIFE AND PERFORMANCE.



**Exceptional
Energy
Efficiency**

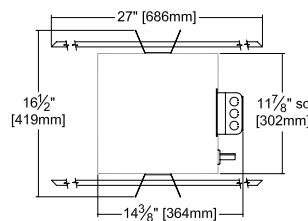

Ceiling Cut-out
8" Dia.

**KIRLIN RECOMMENDS
FROSTED T4 HALOGEN LAMPS
BY USHIO, GE OR SYLVANIA ONLY**

IRR-07059
(Frosted Lamp)

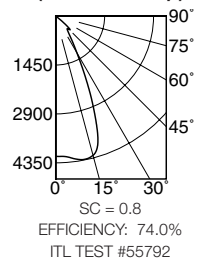

Cone of Light*

| Dist. | FC | Dia. |
|-------|-------|------|
| 6 | 115.5 | 5.2 |
| 8 | 65.0 | 6.9 |
| 10 | 41.6 | 8.6 |
| 12 | 28.9 | 10.4 |
| 14 | 21.2 | 12.1 |
| 16 | 16.2 | 13.8 |

THE KIRLIN COMPANY

3401 EAST JEFFERSON AVENUE • DETROIT, MICHIGAN 48207-4232
(313) 259-6400 • Fax: (313) 259-9409 OR (313) 259-3121 • www.kirlinlighting.com

TUNGSTEN HALOGEN & INCANDESCENT LIGHTING

MAXIMUM WATTAGE

250

CATALOG NUMBER

IRR-07059

DUE TO OUR CONTINUING EFFORT TO IMPROVE PRODUCTS, TECHNICAL INFORMATION IS SUBJECT TO CHANGE WITHOUT NOTICE.

Alzak® is a registered trademark of ALCOA.

Detailed Photometry - Installed Fixture

Photometry from I.T.L., Boulder, CO

IRR-07059 (250 Watt)

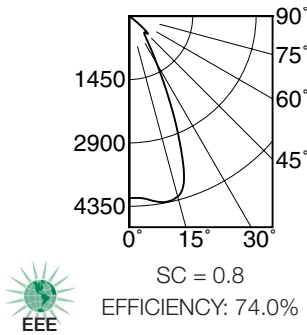

| CANDLEPOWER DISTRIBUTION | | | | | |
|--------------------------|------|------|------|------|------|
| | 0.0 | 22.5 | 45.0 | 67.5 | 90.0 |
| 0 | 4159 | 4159 | 4159 | 4159 | 4159 |
| 5 | 4194 | 4194 | 4194 | 4194 | 4194 |
| 15 | 4273 | 4273 | 4273 | 4273 | 4273 |
| 25 | 2244 | 2244 | 2244 | 2244 | 2244 |
| 35 | 767 | 767 | 767 | 767 | 767 |
| 45 | 557 | 557 | 557 | 557 | 557 |
| 55 | 23 | 23 | 23 | 23 | 23 |
| 65 | 2 | 2 | 2 | 2 | 2 |
| 75 | 2 | 2 | 2 | 2 | 2 |
| 85 | 0 | 0 | 0 | 0 | 0 |
| 90 | 0 | 0 | 0 | 0 | 0 |

| COEFFICIENTS OF UTILIZATION | | | | | | | |
|-----------------------------|----|----|----|----|----|----|----|
| RF | 20 | | | | | | |
| RC | 80 | | | | 50 | | |
| RW | 70 | 50 | 30 | 10 | 50 | 30 | 10 |
| 1 | 84 | 82 | 80 | 79 | 77 | 76 | 75 |
| 2 | 80 | 76 | 73 | 71 | 73 | 71 | 69 |
| 3 | 76 | 71 | 68 | 65 | 68 | 66 | 63 |
| 4 | 72 | 67 | 63 | 60 | 64 | 61 | 59 |
| 5 | 69 | 63 | 58 | 55 | 61 | 57 | 54 |
| 6 | 65 | 59 | 54 | 51 | 57 | 53 | 51 |
| 7 | 62 | 55 | 51 | 48 | 54 | 50 | 48 |
| 8 | 59 | 52 | 48 | 45 | 51 | 47 | 45 |
| 9 | 57 | 50 | 45 | 42 | 48 | 45 | 42 |
| 10 | 54 | 47 | 43 | 40 | 46 | 42 | 40 |

ITL TEST #55792

Options

Wattage and Voltage

- 58 277/120 volt stepdown transformer for 277 volt line input, prewired into fixture; with 277 volt thermal protector.

Lenses and Trims

- 16 Champagne Gold specular Alzak lower cone. (CP x .95)
- 30 All white lower cone. (CP x .95)
- 31 White flange (only) on self-flanged lower cone.

- 32 White oversize trim ring. Specify O.D.
- 45 Gasket between ceiling and lower cone flange.
- 63 Dune specular Alzak lower cone. (CP x .93)
- 69 Wheat specular Alzak lower cone. (CP x .92)
- 70 SofTex clear lower cone. (CP x .92)
- 71 SofTex Dune lower cone. (CP x .89)
- 72 Black specular Alzak lower cone. (CP x .80)
- 79 Extension collar for ceilings up to 2" thick.
- 91 SofTex Wheat lower cone. (CP x .88)
- 93 Pewter specular Alzak lower cone. (CP x .88)

- 94 Custom color/finish. Specify. Consult factory.
- OG OptiGroove black seamless tapered aluminum lower cone. White trim, self-flanged. (CP x .83)

Other

- 99 Special modification. Consult factory.
- LP With frosted DCB lamp. Specify wattage and color temperature.
- TA Top access; for servicing from above ceiling.

SUBMITTAL DATA

JOB NAME

TYPE

WATTAGE

VOLTAGE

CATALOG NUMBER

APPROVAL STAMP