

CATALOG #	TYPE	
JOB NAME	WATTAGE	VOLTAGE

7" 1 T4 250 WATT MAXIMUM

IRR-07058

Church, Shopping Mall, Office Downlight

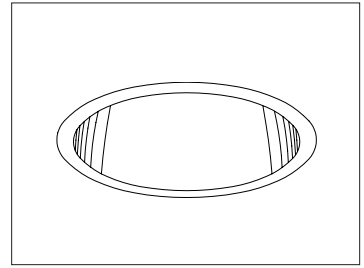

Recessed Round
Open
Appearance
Dual Reflector

Specifications

Lamp

- Designed for 1 vertical frosted T4 tungsten halogen lamp (by others): 250 watt maximum.

Lampholder

- Double contact bayonet. Heat resistant.
- Lamp socket bracket designed as heat sink.

Reflectors

- Upper: Specular Alzak® aluminum for precise control of source.
- Lower: Low brightness clear specular parabolic Alzak aluminum cone, self-flanged.
- Optional self-flanged lower cone finishes and colors available.
- Convection and radiation cooling by design.

Lens

- Tempered MicroLux (microprismatic) lens mounted to upper reflector (0.4 SC). Optional tempered prismatic glass (Option -15 with 0.7 SC) or tempered clear glass (Option -28 with 0.2 SC) available.

Aluminum Housing

- Cool. Acrylic enameled 100% aluminum.
- Rustproof and corrosion resistant: Exceeds 1000 hour ASTM 5% salt spray test.
- Dissipates heat across entire surface area extending component life.
- Entire luminaire visible and serviceable from below through aperture.
- For top access, see Option -TA.
- Built-in plaster frame. Also see Option -79.

Outlet Box and Thermal Protection

- UL listed J-box with insulated removable cover. Prewired 14 GA (NEC) with 1/2" and 3/4" knockouts.
- Thermal protector (per current NEC) provides automatic cut-off if rated temperature is exceeded.

Installation

- 27" galvanized hanger bars supplied (2).
- Fully adjustable universal galvanized mounting brackets supplied (2).

- Recesses indoor or outdoor in covered ceilings.

UL, C-UL (Canada) Listings

- Wet, damp or dry locations, covered ceilings.
- Through-branch conductors (6 #12 AWG 90°C).

Three Year Limited Warranty

- Complete standard fixture.

Performance at a Glance

IRR-07058

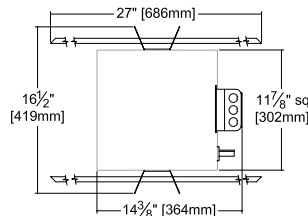
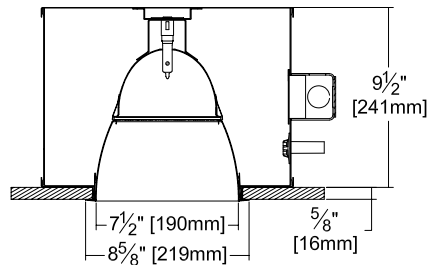

Ceiling Cut-out
8" Dia.

Cone of Light Key
Ft. Distance from fixture
FC Footcandles at nadir (0°)
Dia. Circle of light at 50% of FC

* Dia. (in ft.) shown is where FC value is half the FC at nadir.

IRR-07058
(Frosted Lamp)

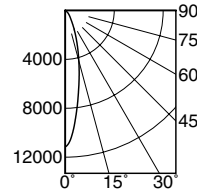

SC = 0.4

EFFICIENCY: 72.2%
ITL TEST #55794

Cone of Light*

Dist.	FC	Dia.
6	309.8	2.3
8	174.3	3.1
10	111.5	3.9
12	77.5	4.6
14	56.9	5.4
16	43.6	6.2

IRR-07058-15
(Frosted Lamp)

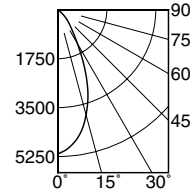

SC = 0.7

EFFICIENCY: 70.7%
ITL TEST #55791

Cone of Light*

Dist.	FC	Dia.
6	143.2	4.4
8	80.6	5.9
10	51.6	7.3
12	35.8	8.8
14	26.3	10.3
16	20.1	11.7

IRR-07058-28
(Frosted Lamp)

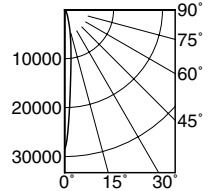

SC = 0.2

EFFICIENCY: 74.6%
ITL TEST #55793

Cone of Light*

Dist.	FC	Dia.
6	792.0	1.0
8	445.5	1.4
10	285.1	1.7
12	198.0	2.0
14	145.5	2.4
16	111.4	2.7

**KIRLIN RECOMMENDS
FROSTED T4 HALOGEN
LAMPS BY USHIO, GE OR
SYLVANIA ONLY.**

**CAUTION: SINGLE ENDED T4 HALOGEN LAMPS
MUST BE STARTED AT OR NEAR FULL VOLTAGE
(120V) BEFORE DIMMING TO ENSURE MAXIMUM
LIFE AND PERFORMANCE.**

THE KIRLIN COMPANY

3401 EAST JEFFERSON AVENUE • DETROIT, MICHIGAN 48207-4232
(313) 259-6400 • Fax: (313) 259-9409 OR (313) 259-3121 • www.kirlinlighting.com

TUNGSTEN HALOGEN &
INCANDESCENT LIGHTING

MAXIMUM WATTAGE

250

CATALOG NUMBER

IRR-07058

DUE TO OUR CONTINUING EFFORT TO IMPROVE PRODUCTS, TECHNICAL
INFORMATION IS SUBJECT TO CHANGE WITHOUT NOTICE.

Alzak® is a registered trademark of ALCOA.

Detailed Photometry - Installed Fixture

Photometry from I.T.L., Boulder, CO

IRR-07058 (250 Watt)

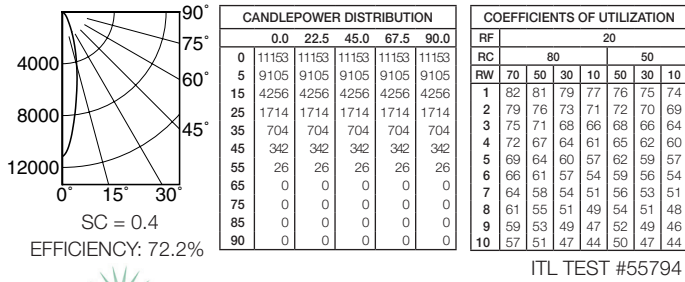

IRR-07058-15 (250 Watt)

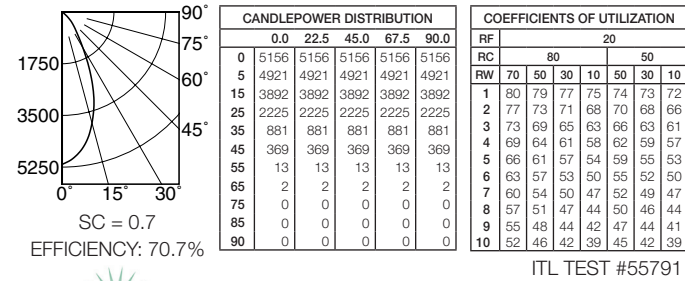

IRR-07058-28 (250 Watt)

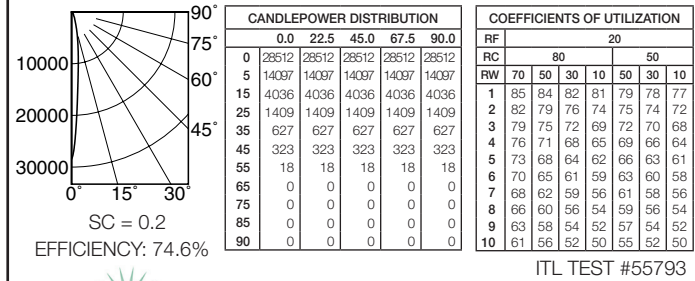

Options

Wattage and Voltage

- 58 277/120 volt stepdown transformer for 277 volt line input, prewired into fixture; with 277 volt thermal protector.

Lenses and Trims

- 15 Tempered prismatic glass lens for medium (0.7 SC) distribution.
- 16 Champagne Gold specular Alzak lower cone. (CP x .95)
- 28 Tempered clear flat glass for narrowest (0.2 SC) distribution.

- 30 All white lower cone. (CP x .95)
- 31 White flange (only) on self-flanged lower cone.
- 32 White oversize trim ring. Specify O.D.
- 45 Gasket between ceiling and lower cone flange.
- 63 Dune specular Alzak lower cone. (CP x .93)
- 69 Wheat specular Alzak lower cone. (CP x .92)
- 70 Softex clear lower cone. (CP x .92)
- 71 Softex Dune lower cone. (CP x .89)
- 72 Black specular Alzak lower cone. (CP x .80)
- 79 Extension collar for ceilings up to 2" thick.
- 91 Softex Wheat lower cone. (CP x .88)

- 93 Pewter specular Alzak lower cone. (CP x .88)
- 94 Custom color/finish. Specify. Consult factory.
- OG OptiGroove black seamless tapered aluminum lower cone. White trim, self-flanged. (CP x .83)

Other

- 99 Special modification. Consult factory.
- LP With frosted DCB lamp. Specify wattage and color temperature.
- TA Top access; for servicing from above ceiling.

SUBMITTAL DATA

JOB NAME _____
TYPE _____
WATTAGE _____ VOLTAGE _____
CATALOG NUMBER _____

APPROVAL STAMP

LIMITED WARRANTY: CATALOGED KIRLIN FIXTURES ARE WARRANTED FREE OF DEFECTS IN WORKMANSHIP OR MATERIAL FOR THREE YEARS FROM DATE OF PURCHASE. INSTALL TO N.E.C. IN NORMAL USE. Manufacturer of the fixture will replace or repair such fixture or refund the purchase price on presentation of proof of purchase and defective fixture at the office of manufacturer within three years of original shipment. Liability of manufacturer is limited to the foregoing and manufacturer shall not be liable for any other damages, direct or indirect, sustained or suffered by purchaser or any person. This warranty is subject to the buyer in place of all other warranties, expressed or implied. Seller does not warrant as to merchantability or fitness for a particular use, nor will any oral statement constitute a warranty or amend this specific warranty. Abnormal use, improper installation, or repair or modification of the fixture without prior written authorization from the manufacturer will render the warranty void.