

CATALOG #	TYPE	
JOB NAME	WATTAGE	VOLTAGE

6" 1 A21 150 WATT MAXIMUM

IRR-06135

Regressed Lens: Streamlined 6¼" Depth

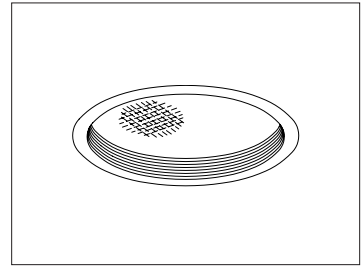

Specifications

Lamp / Socket

- Designed for one horizontal frosted incandescent lamp (by others): 150W maximum A21.
- Dimmable (controls by others).
- Glazed porcelain medium base socket.

Reflector

- Specular Alzak® aluminum.

Trim Assembly

- Tapered aluminum one piece black OptiGroove with white flange or all white smooth self-flanged trim (Option -40).
- Regressed tempered prismatic C#73 glass lens.
- Optional lenses and trims available.

Aluminum Housing

- Cool. Acrylic enameled 100% aluminum.
- Rustproof and corrosion resistant: Exceeds 1000 hour ASTM 5% salt spray test.
- Dissipates heat across entire surface area extending component life.

- Entire luminaire visible and serviceable from below through aperture.
- Built-in plaster frame. Also see Option -79.

Outlet Box and Thermal Protection

- UL listed J-box with insulated removable cover. Prewired 14 GA (NEC) with ½" and ¾" knockouts.
- Thermal protector (per current NEC) provides automatic cut-off if rated temperature is exceeded.

Installation

- 27" galvanized hanger bars supplied (2).
- Fully adjustable universal galvanized mounting brackets supplied (2).
- Recesses indoor or outdoor in covered ceilings.

UL, C-UL (Canada) Listings

- Wet, damp or dry locations, covered ceilings.
- Through-branch conductors (6 #12 AWG 90°C).

Three Year Limited Warranty

- Complete standard fixture.

Recessed Round
Regressed Lens
Shallow Plenum

Performance at a Glance

IRR-06135

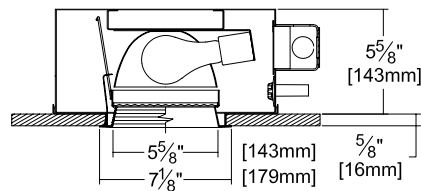

Option -40 Also Shown

Cone of Light Key

- Ft. Distance from fixture
- FC Footcandles at nadir (0°)
- Dia. Circle of light at 50% of FC

* Dia. (in ft.) shown is where FC value is half the FC at nadir.

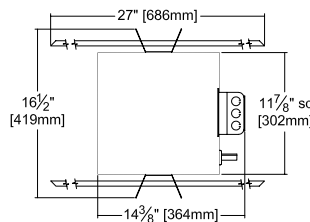

Ceiling Cut-out
6½" Dia.

IRR-06135 (150 Watt)

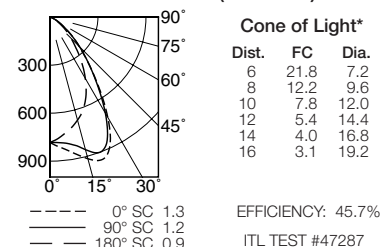

IRR-06135 (100 Watt)

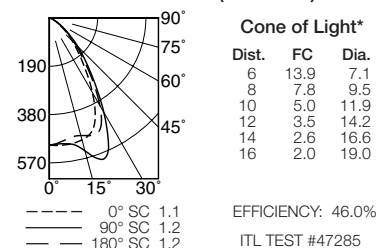

THE KIRLIN COMPANY

3401 EAST JEFFERSON AVENUE • DETROIT, MICHIGAN 48207-4232
(313) 259-6400 • Fax: (313) 259-9409 OR (313) 259-3121 • www.kirlinlighting.com

TUNGSTEN HALOGEN &
INCANDESCENT LIGHTING

MAXIMUM WATTAGE

150

CATALOG NUMBER

IRR-06135

DUE TO OUR CONTINUING EFFORT TO IMPROVE PRODUCTS, TECHNICAL INFORMATION IS SUBJECT TO CHANGE WITHOUT NOTICE.

Alzak® is a registered trademark of ALCOA.

Detailed Photometry - Installed Fixture

Photometry from I.T.L., Boulder, CO

IRR-06135 (150 Watt)

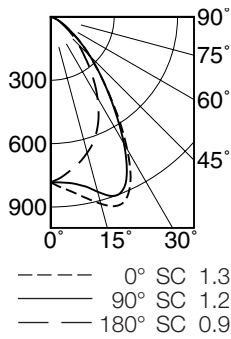

EFFICIENCY : 45.7%

CANDLEPOWER DISTRIBUTION					
	0.0	45.0	90.0	135.0	180.0
0	783	783	783	783	783
5	819	809	788	764	751
15	916	905	857	479	666
25	886	904	847	689	534
35	530	570	517	435	346
45	259	256	262	211	187
55	105	112	109	104	87
65	33	38	40	40	38
75	5	6	7	7	7
85	0	0	0	0	0
90	0	0	0	0	0

COEFFICIENTS OF UTILIZATION							
RF	20						
RC	80			50			
RW	70	50	30	10	50	30	10
1	51	50	48	47	47	46	45
2	48	45	43	41	43	41	40
3	45	41	39	36	39	37	36
4	42	38	35	33	36	34	32
5	39	35	32	29	33	31	29
6	37	32	29	26	31	28	26
7	35	30	26	24	29	26	24
8	33	27	24	22	27	24	22
9	31	26	22	20	25	22	20
10	29	24	21	19	23	21	19

ITL TEST #47287

IRR-06135 (100 Watt)

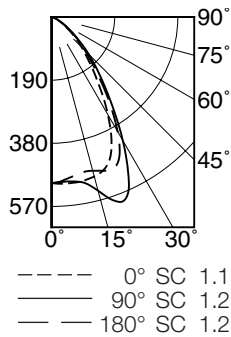

EFFICIENCY : 46.0%

CANDLEPOWER DISTRIBUTION					
	0.0	45.0	90.0	135.0	180.0
0	500	500	500	500	500
5	503	502	497	492	490
15	497	544	541	499	479
25	427	507	551	510	477
35	247	297	311	318	294
45	128	133	158	142	143
55	55	63	66	64	62
65	21	23	23	21	20
75	4	4	4	3	4
85	0	0	0	0	0
90	0	0	0	0	0

COEFFICIENTS OF UTILIZATION							
RF	20						
RC	80			50			
RW	70	50	30	10	50	30	10
1	52	50	49	48	47	46	45
2	49	46	44	42	44	42	40
3	45	42	39	37	40	38	36
4	43	38	35	33	37	34	32
5	40	35	32	30	34	31	29
6	37	33	29	27	31	29	27
7	35	30	27	25	29	26	24
8	33	28	25	22	27	24	22
9	31	26	23	21	25	23	21
10	29	24	21	19	24	21	19

ITL TEST #47285

Options

Wattage and Voltage

- 58 277/120 volt stepdown transformer for 277 volt line input, prewired into fixture; with 277 volt thermal protector.

Lenses and Trims

- 18 Opal flat glass. Not enameled. Diffusing.
- 20 White 1/2" cube eggcrate aluminum louver.

- 32 White oversize trim ring. Specify O.D.
- 33 Decorative tempered glass Glow Ring suspended trim assembly.
- 40 White grooveless flare trim. (CP x 1.10)
- 45 Gasket between ceiling and trim flange.
- 46 Gasket between trim and lens.
- 94 Custom color/finish. Specify. Consult factory.

- FR Fresnel tempered glass lens.
- FT Flat white trim. With C#73 spread lens or specify optional lens.

Other

- 99 Special modification. Consult factory.

SUBMITTAL DATA

APPROVAL STAMP

JOB NAME
TYPE
WATTAGE
VOLTAGE
CATALOG NUMBER

LIMITED WARRANTY: CATALOGED KIRLIN FIXTURES ARE WARRANTED FREE OF DEFECTS IN WORKMANSHIP OR MATERIAL FOR THREE YEARS FROM DATE OF PURCHASE. INSTALL TO N.E.C. IN NORMAL USE. Manufacturer of the fixture will replace or repair such fixture or refund the purchase price on presentation of proof of purchase and defective fixture at the offices of manufacturer within three years of original shipment. Liability of manufacturer is limited to the foregoing and manufacturer shall not be liable for any other damages, direct or indirect, sustained or suffered by purchaser or any person. This warranty is supplied to the buyer in place of all other warranties, expressed or implied. Seller does not warrant as to merchantability or fitness for a particular use, nor will any oral statement constitute a warranty or amend the specific warranty. Abnormal use, abuse of the fixture, improper installation, or repair or modification of the fixture without prior written authorization from the manufacturer will render the warranty void.