

CATALOG #	TYPE	
JOB NAME	WATTAGE	VOLTAGE

6" 1 A19 100 WATT MAXIMUM

Type IC - IRR-06131

## Adaptable 6" Type IC Downlight

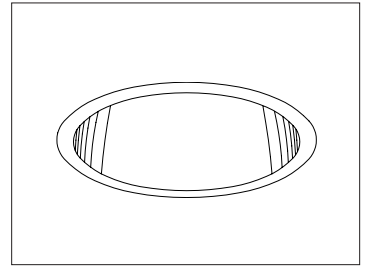

### Specifications

#### Lamp / Socket

- Designed for one frosted incandescent lamp (by others):  
Horizontal 100W maximum A19.
- Dimmable (controls by others).
- Glazed porcelain medium base socket.

#### Reflectors

- Upper: Ellipsoidal clear specular Alzak® aluminum.
- Lower: Parabolic self-flanged specular Alzak aluminum.
- Optional lower reflector finishes and colors available.

#### Aluminum Housing

- Cool. Acrylic enameled 100% aluminum.
- Rustproof and corrosion resistant: Exceeds 1000 hour ASTM 5% salt spray test.
- Dissipates heat across entire surface area extending component life.

- Entire luminaire visible and serviceable from below through aperture.
- Built-in plaster frame. Also see Option -79.

#### Outlet Box and Thermal Protection

- UL listed J-box with insulated removable cover. Prewired 14 GA (NEC) with 1/2" and 3/4" knockouts.
- Thermal protector (per current NEC) provides automatic cut-off if rated wattage is exceeded.

#### Installation

- 27" galvanized hanger bars supplied (2).
  - Fully adjustable universal galvanized mounting brackets supplied (2).
  - Recesses indoor or outdoor in covered ceilings.
- #### UL, C-UL (Canada) Listings
- Wet, damp or dry locations, covered ceilings.
  - Through-branch conductors (6 #12 AWG 90°C).
  - Type IC. Approved for direct contact with insulation.

#### Three Year Limited Warranty

- Complete standard fixture.

Recessed Round  
Open  
Dual Reflector  
Type IC



### Performance at a Glance

IRR-06131: Type IC

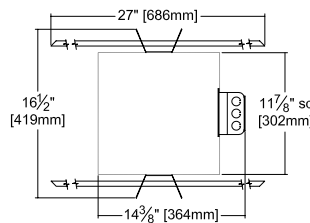
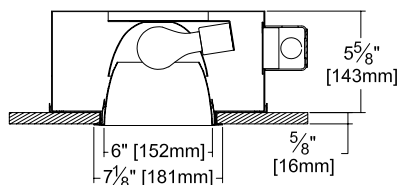

Ceiling Cut-out  
6 1/2" Dia.

IRR-06131 (100 Watt)

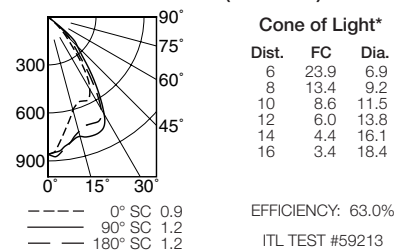

#### Cone of Light Key

- Ft. Distance from fixture
- FC Footcandles at nadir (0°)
- Dia. Circle of light at 50% of FC

\* Dia. (in ft.) shown is where FC value is half the FC at nadir.

## THE KIRLIN COMPANY

3401 EAST JEFFERSON AVENUE • DETROIT, MICHIGAN 48207-4232  
(313) 259-6400 • Fax: (313) 259-9409 OR (313) 259-3121 • www.kirlinlighting.com

TUNGSTEN HALOGEN &  
INCANDESCENT LIGHTING

MAXIMUM WATTAGE

100

CATALOG NUMBER

IRR-06131

Detailed Photometry - Installed Fixture

Photometry from I.T.L., Boulder, CO

IRR-06131 (100 Watt)

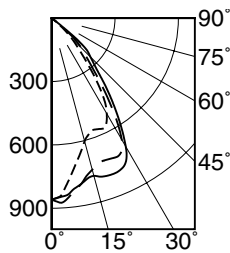

--- 0° SC 0.9  
 — 90° SC 1.2  
 — 180° SC 1.2



EFFICIENCY : 63.0%

CANDLEPOWER DISTRIBUTION					
	0.0	45.0	90.0	135.0	180.0
0	859	859	859	859	859
5	795	808	841	851	858
15	603	683	773	819	743
25	577	688	786	770	726
35	388	482	525	522	466
45	131	223	260	254	198
55	2	2	3	3	2
65	0	0	0	0	0
75	0	0	0	0	0
85	0	0	0	0	0
90	0	0	0	0	0

COEFFICIENTS OF UTILIZATION							
RF	20						
RC	80				50		
RW	70	50	30	10	50	30	10
1	71	69	68	66	65	64	63
2	67	64	61	59	61	59	57
3	63	59	55	53	56	54	51
4	60	54	50	48	52	49	47
5	56	50	46	43	48	45	43
6	53	47	42	39	45	42	39
7	50	43	39	36	42	38	36
8	47	40	36	33	39	36	33
9	44	38	33	31	37	33	30
10	42	35	31	28	34	31	28

ITL TEST #59213

Options

Trims

- 16 Champagne Gold specular Alzak reflector. (CP x .93)
- 31 White flange (only) on self-flanged reflector.
- 32 White oversize trim ring. Specify O.D.
- 45 Gasket between ceiling and reflector flange.
- 63 Dune specular Alzak reflector. (CP x .90)
- 69 Wheat specular Alzak reflector. (CP x .88)
- 70 SofTex clear reflector. (CP x .90)
- 71 SofTex Dune reflector. (CP x .81)
- 79 Extension collar for ceilings up to 2" thick.
- 91 SofTex Wheat reflector. (CP x .80)
- 93 Pewter specular Alzak reflector. (CP x .85)

- 94 Custom color/finish. Specify. Consult factory.
- OG OptiGroove black seamless tapered aluminum reflector. White trim, self-flanged. (CP x .75)

Other

- 99 Special modification. Consult factory.

SUBMITTAL DATA

APPROVAL STAMP

JOB NAME  
 TYPE  
 WATTAGE VOLTAGE  
 CATALOG NUMBER

LIMITED WARRANTY: CATALOGED KIRLIN FIXTURES ARE WARRANTED FREE OF DEFECTS IN WORKMANSHIP OR MATERIAL FOR THREE YEARS FROM DATE OF PURCHASE. INSTALL TO N.E.C. IN NORMAL USE. Manufacturer of the option will replace or repair such fixture or refund the purchase price on presentation of proof of purchase and defective fixture at the offices of manufacturer within three years of original shipment. Liability of manufacturer is limited to the foregoing and manufacturer shall not be liable for any other damages, direct or indirect, sustained or suffered by purchaser or any person. This warranty is supplied in place of all other warranties, expressed or implied. Seller does not warrant as to merchantability or fitness for a particular use, nor will any oral statement constitute a warranty or amend this specific warranty. Abnormal use, abuse of the fixture, improper installation, or repair or modification of the fixture without prior written authorization from the manufacturer will render the warranty void.