

CATALOG #	TYPE	
JOB NAME	WATTAGE	VOLTAGE

6" 1 A21 150 WATT MAXIMUM

IRR-06129

## Visual Comfort with High Efficiency

### Specifications

#### Lamp / Socket

- Designed for one frosted incandescent lamp (by others):  
Horizontal 150W maximum A21.
- Dimmable (controls by others).
- Glazed porcelain medium base socket.

#### Reflectors

- Upper: Ellipsoidal clear specular Alzak® aluminum.
- Lower: Parabolic self-flanged specular Alzak aluminum.
- Optional lower reflector finishes and colors available.

#### Aluminum Housing

- Cool. Acrylic enameled 100% aluminum.
- Rustproof and corrosion resistant: Exceeds 1000 hour ASTM 5% salt spray test.
- Dissipates heat across entire surface area extending component life.

- Entire luminaire visible and serviceable from below through aperture.
- Built-in plaster frame. Also see Option -79.

#### Outlet Box and Thermal Protection

- UL listed J-box with insulated removable cover. Prewired 14 GA (NEC) with 1/2" and 3/4" knockouts.
- Thermal protector (per current NEC) provides automatic cut-off if rated temperature is exceeded.

#### Installation

- 27" galvanized hanger bars supplied (2).
- Fully adjustable universal galvanized mounting brackets supplied (2).
- Recesses indoor or outdoor in covered ceilings.

#### UL, C-UL (Canada) Listings

- Wet, damp or dry locations, covered ceilings.
- Through-branch conductors (6 #12 AWG 90°C).

#### Three Year Limited Warranty

- Complete standard fixture.

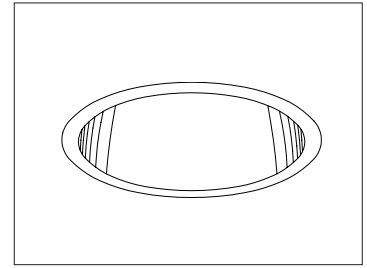

Recessed Round  
Open  
Dual Reflector

### Performance at a Glance

IRR-06129

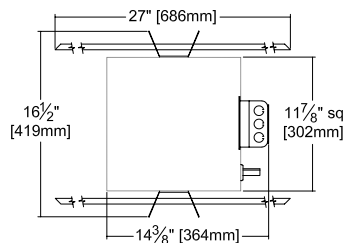
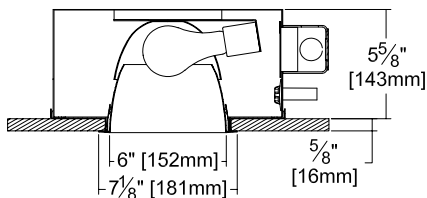

Ceiling Cut-out  
6 1/2" Dia.

IRR-06129 (150 Watt)

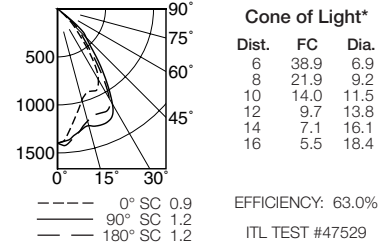

#### Cone of Light Key

- Ft. Distance from fixture
- FC Footcandles at nadir (0°)
- Dia. Circle of light at 50% of FC

\* Dia. (in ft.) shown is where FC value is half the FC at nadir.

## THE KIRLIN COMPANY

3401 EAST JEFFERSON AVENUE • DETROIT, MICHIGAN 48207-4232  
(313) 259-6400 • Fax: (313) 259-9409 OR (313) 259-3121 • www.kirlinlighting.com

TUNGSTEN HALOGEN &  
INCANDESCENT LIGHTING

MAXIMUM WATTAGE

150

CATALOG NUMBER

IRR-06129

DUE TO OUR CONTINUING EFFORT TO IMPROVE PRODUCTS, TECHNICAL INFORMATION IS SUBJECT TO CHANGE WITHOUT NOTICE.

Alzak® is a registered trademark of ALCOA.

Detailed Photometry - Installed Fixture

Photometry from I.T.L., Boulder, CO

IRR-06129 (150 Watt)

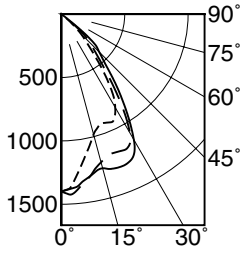

--- 0° SC 0.9  
 — 90° SC 1.2  
 — 180° SC 1.2



EFFICIENCY : 63.0%

CANDLEPOWER DISTRIBUTION					
	0.0	45.0	90.0	135.0	180.0
0	1399	1399	1399	1399	1399
5	1295	1316	1369	1386	1397
15	982	1112	1259	1334	1210
25	940	1121	1280	1254	1182
35	632	785	855	850	759
45	214	363	423	414	322
55	3	3	4	4	3
65	0	0	0	0	0
75	0	0	0	0	0
85	0	0	0	0	0
90	0	0	0	0	0

COEFFICIENTS OF UTILIZATION							
RF	20						
RC	80				50		
RW	70	50	30	10	50	30	10
1	71	69	68	66	65	64	63
2	67	64	61	59	61	59	57
3	63	59	55	53	56	54	51
4	60	54	51	48	52	49	47
5	56	50	46	43	48	45	43
6	53	47	42	39	45	42	39
7	50	43	39	36	42	38	36
8	47	40	36	33	39	36	33
9	44	38	33	31	37	33	30
10	42	35	31	28	34	31	28

ITL TEST #47529

Options

Wattage and Voltage

- 58 277/120 volt stepdown transformer for 277 volt line input, prewired into fixture; with 277 volt thermal protector.

Trims

- 16 Champagne Gold specular Alzak reflector. (CP x .93)
- 31 White flange (only) on self-flanged reflector.

- 32 White oversize trim ring. Specify O.D.
- 45 Gasket between ceiling and reflector flange.
- 63 Dune specular Alzak reflector. (CP x .90)
- 69 Wheat specular Alzak reflector. (CP x .88)
- 70 SofTex clear reflector. (CP x .90)
- 71 SofTex Dune reflector. (CP x .81)
- 79 Extension collar for ceilings up to 2" thick.
- 91 SofTex Wheat reflector. (CP x .80)

- 93 Pewter specular Alzak reflector. (CP x .85)
- 94 Custom color/finish. Specify. Consult factory.
- OG OptiGroove black seamless tapered aluminum reflector. White trim, self-flanged. (CP x .75)

Other

- 99 Special modification. Consult factory.

SUBMITTAL DATA

JOB NAME  
 TYPE  
 WATTAGE VOLTAGE  
 CATALOG NUMBER

APPROVAL STAMP

LIMITED WARRANTY: CATALOGED KIRLIN FIXTURES ARE WARRANTED FREE OF DEFECTS IN WORKMANSHIP OR MATERIAL FOR THREE YEARS FROM DATE OF PURCHASE. INSTALL TO N.E.C. IN NORMAL USE. Manufacturer of the option will replace or repair such fixture or refund the purchase price on presentation of proof of purchase and defective fixture at the offices of manufacturer within three years of original shipment. Liability of manufacturer is limited to the foregoing and manufacturer shall not be liable for any other damages, direct or indirect, sustained or suffered by purchaser or any person. This warranty is supplied in place of all other warranties, expressed or implied. Seller does not warrant as to merchantability or fitness for a particular use, nor will any oral statement constitute a warranty or amend this specific warranty. Abnormal use, abuse of the fixture, improper installation, or repair or modification of the fixture without prior written authorization from the manufacturer will render the warranty void.