

CATALOG #	TYPE	
JOB NAME	WATTAGE	VOLTAGE

6" 1 A19 100 WATT MAXIMUM

Type IC - IRR-06128

Type IC Alzak® 100 Watt Downlight

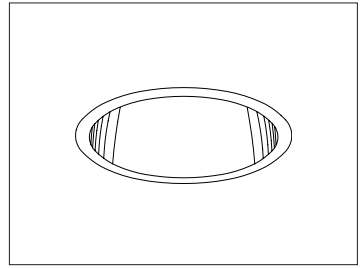

Specifications

Lamp / Socket

- Designed for one vertical frosted incandescent lamp (by others): 100W maximum A19.
- Dimmable (controls by others).
- Glazed porcelain medium base socket.

Reflector

- Self-flanged compound curved specular Alzak® aluminum.
- Optional reflector finishes and colors available.

Aluminum Housing

- Cool. Acrylic enameled 100% aluminum.
- Rustproof and corrosion resistant: Exceeds 1000 hour ASTM 5% salt spray test.
- Dissipates heat across entire surface area extending component life.
- Entire luminaire visible and serviceable from below through aperture.
- Built-in plaster frame. Also see Option -79.

Outlet Box and Thermal Protection

- UL listed J-box with insulated removable cover. Prewired 14 GA (NEC) with 1/2" and 3/4" knockouts.
- Thermal protector (per current NEC) provides automatic cut-off if rated wattage is exceeded.

Installation

- 27" galvanized hanger bars supplied (2).
- Fully adjustable universal galvanized mounting brackets supplied (2).
- Recesses indoor or outdoor in covered ceilings.

UL, C-UL (Canada) Listings

- Wet, damp or dry locations, covered ceilings.
- Through-branch conductors (6 #12 AWG 90°C).
- Type IC. Approved for direct contact with insulation.

Three Year Limited Warranty

- Complete standard fixture.

Recessed Round
Open
Single Reflector
Type IC

Performance at a Glance

IRR-06128: Type IC

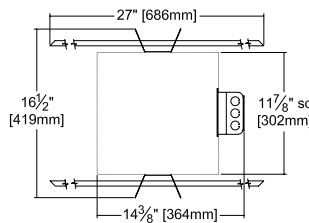
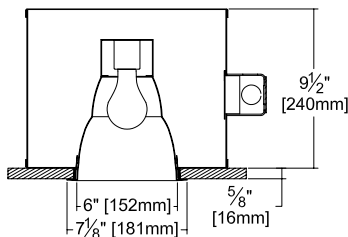

Ceiling Cut-out
6 1/2" Dia.

IRR-06128 (100 Watt)

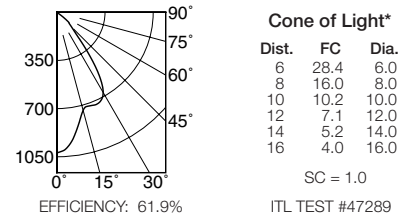

Cone of Light Key

- Ft. Distance from fixture
- FC Footcandles at nadir (0°)
- Dia. Circle of light at 50% of FC

* Dia. (in ft.) shown is where FC value is half the FC at nadir.

THE KIRLIN COMPANY

3401 EAST JEFFERSON AVENUE • DETROIT, MICHIGAN 48207-4232
(313) 259-6400 • Fax: (313) 259-9409 OR (313) 259-3121 • www.kirlinlighting.com

TUNGSTEN HALOGEN &
INCANDESCENT LIGHTING

MAXIMUM WATTAGE

100

CATALOG NUMBER

IRR-06128

Detailed Photometry - Installed Fixture

Photometry from I.T.L., Boulder, CO

IRR-06128 (100 Watt)

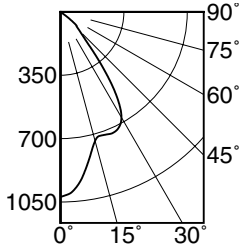

SC = 1.0
EFFICIENCY: 61.9%

CANDLEPOWER DISTRIBUTION table with columns for beam diameter (0.0 to 90.0) and footcandle values.

COEFFICIENTS OF UTILIZATION table with columns for fixture height (RF 1-10) and beam diameter (RW 70-110).

ITL TEST #47289

IRR-06128-WW (100 Watt A21)

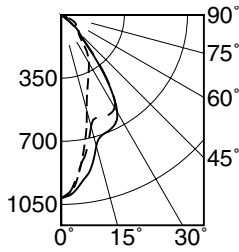

WALL > --- 0°
--- 90°
--- 180°
EFFICIENCY : 56.3%

CANDLEPOWER DISTRIBUTION table for WW fixture with columns for beam diameter (0.0 to 180.0) and footcandle values.

Footcandle distribution table for multiple fixtures showing distance from ceiling and wall surface.

ITL TEST #47277

Options

Trims

- List of trim options including Champagne Gold specular Alzak reflector, White flange, Decorative tempered glass Glow Ring, and various Alzak reflector finishes.

Other

- 99 Special modification. Consult factory.

SUBMITTAL DATA

APPROVAL STAMP

JOB NAME
TYPE
WATTAGE VOLTAGE
CATALOG NUMBER

LIMITED WARRANTY: CATALOGED KIRLIN FIXTURES ARE WARRANTED FREE OF DEFECTS IN WORKMANSHIP OR MATERIAL FOR THREE YEARS FROM DATE OF PURCHASE...