

CATALOG #	TYPE	
JOB NAME	WATTAGE	VOLTAGE

6" 1 A21 150 WATT MAXIMUM

IRR-06126

Small Aperture with Versatile 1.0 SC

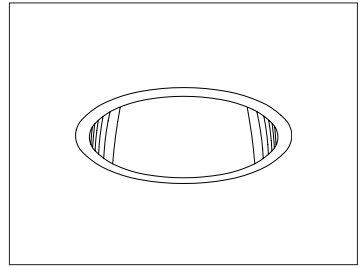

Recessed Round
Open
Single Reflector

Specifications

Lamp / Socket

- Designed for one vertical frosted incandescent lamp (by others): 150W maximum A21.
- Dimmable (controls by others).
- Glazed porcelain medium base socket.

Reflector

- Self-flanged compound curved specular Alzak® aluminum.
- Optional reflector finishes and colors available.

Aluminum Housing

- Cool. Acrylic enameled 100% aluminum.
- Rustproof and corrosion resistant: Exceeds 1000 hour ASTM 5% salt spray test.
- Dissipates heat across entire surface area extending component life.
- Entire luminaire visible and serviceable from below through aperture.
- Built-in plaster frame. Also see Option -79.

Outlet Box and Thermal Protection

- UL listed J-box with insulated removable cover. Prewired 14 GA (NEC) with 1/2" and 3/4" knockouts.
- Thermal protector (per current NEC) provides automatic cut-off if rated temperature is exceeded.

Installation

- 27" galvanized hanger bars supplied (2).
- Fully adjustable universal galvanized mounting brackets supplied (2).
- Recesses indoor or outdoor in covered ceilings.

UL, C-UL (Canada) Listings

- Wet, damp or dry locations, covered ceilings.
- Through-branch conductors (6 #12 AWG 90°C).

Three Year Limited Warranty

- Complete standard fixture.

Performance at a Glance

IRR-06126

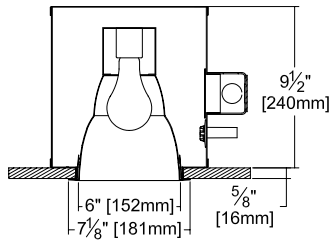

Cone of Light Key

- Ft.** Distance from fixture
- FC** Footcandles at nadir (0°)
- Dia.** Circle of light at 50% of FC

* Dia. (in ft.) shown is where FC value is half the FC at nadir.



Exceptional
Energy
Efficiency

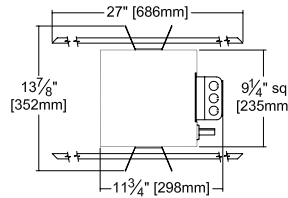

Ceiling Cut-out
6 1/2" Dia.

IRR-06126 (150 Watt)

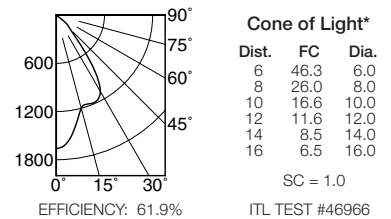

IRR-06126 (100 Watt)

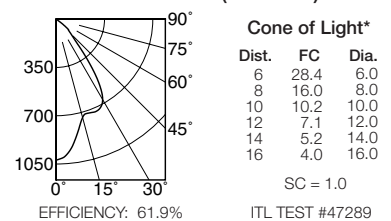

THE KIRLIN COMPANY

3401 EAST JEFFERSON AVENUE • DETROIT, MICHIGAN 48207-4232
(313) 259-6400 • Fax: (313) 259-9409 OR (313) 259-3121 • www.kirlinlighting.com

TUNGSTEN HALOGEN &
INCANDESCENT LIGHTING

MAXIMUM WATTAGE

150

CATALOG NUMBER

IRR-06126

Detailed Photometry - Installed Fixture

IRR-06126 (150 Watt)

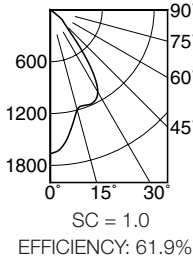

CANDLEPOWER DISTRIBUTION					
	0.0	22.5	45.0	67.5	90.0
0	1665	1665	1665	1665	1665
5	1588	1588	1588	1588	1588
15	1201	1201	1201	1201	1201
25	1180	1180	1180	1180	1180
35	816	816	816	816	816
45	246	246	246	246	246
55	5	5	5	5	5
65	1	1	1	1	1
75	0	0	0	0	0
85	0	0	0	0	0
90	0	0	0	0	0

COEFFICIENTS OF UTILIZATION										
RF	20									
	80					50				
RC	70	50	30	10	50	30	10	50	30	10
1	70	68	67	65	64	63	62	61	60	59
2	66	63	60	58	60	58	56	55	53	51
3	62	58	55	52	56	53	51	51	49	46
4	59	54	50	47	52	49	46	46	44	42
5	56	50	46	43	48	45	42	42	40	38
6	52	46	42	39	45	42	39	39	37	35
7	49	43	39	36	42	38	36	36	34	32
8	47	40	36	33	39	36	33	33	31	29
9	44	38	34	31	37	33	31	31	29	27
10	42	35	31	29	35	31	29	29	27	25

ITL TEST #46966

IRR-06126 (100 Watt)

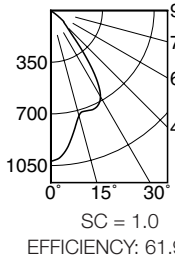

CANDLEPOWER DISTRIBUTION					
	0.0	22.5	45.0	67.5	90.0
0	1022	1022	1022	1022	1022
5	975	975	975	975	975
15	738	738	738	738	738
25	725	725	725	725	725
35	501	501	501	501	501
45	151	151	151	151	151
55	3	3	3	3	3
65	1	1	1	1	1
75	0	0	0	0	0
85	0	0	0	0	0
90	0	0	0	0	0

COEFFICIENTS OF UTILIZATION										
RF	20									
	80					50				
RC	70	50	30	10	50	30	10	50	30	10
1	70	68	67	65	64	63	62	61	60	59
2	66	63	60	58	60	58	56	55	53	51
3	62	58	55	52	56	53	51	51	49	46
4	59	54	50	47	52	49	46	46	44	42
5	56	50	46	43	48	45	42	42	40	38
6	52	46	42	39	45	42	39	39	37	35
7	49	43	39	36	42	38	36	36	34	32
8	47	40	36	33	39	36	33	33	31	29
9	44	38	34	31	37	33	31	31	29	27
10	42	35	31	29	35	31	29	29	27	25

ITL TEST #47289

IRR-06126-WW (150 Watt)

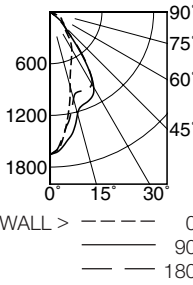

CANDLEPOWER DISTRIBUTION					
	0.0	22.5	45.0	67.5	90.0
0	1654	1654	1654	1654	1654
5	1522	1541	1580	1539	1493
15	891	1034	1225	1091	1044
25	583	771	1110	1013	997
35	403	508	725	720	746
45	221	242	238	225	223
55	165	113	25	18	21
65	105	78	33	49	58
75	21	14	7	10	12
85	0	0	0	0	0
90	0	0	0	0	0

DISTANCE FROM CEILING IN FEET	SINGLE FIXTURE					MULTIPLE FIXTURES					
	1'	2'	3'	4'	3' CENTERS	4' CENTERS	4' CENTERS	4' CENTERS	4' CENTERS	4' CENTERS	
	FIXTURE INSTALLED 3' FROM WALL										
Footcandle Distribution on Wall Surface											
1	4.5	3.7	2.3	1.6	1.3	10.5	10.2	10.5	9.1	7.8	9.1
2	10.5	9.0	5.8	3.2	1.8	19.8	19.6	19.8	16.1	14.9	16.1
3	9.0	8.3	5.7	3.3	2.2	18.7	20.2	18.7	15.4	15.0	15.4
4	8.7	7.8	5.7	4.1	2.4	20.2	19.1	20.2	15.7	15.1	15.7
5	7.7	7.4	6.2	4.0	2.8	19.2	20.9	19.2	15.7	16.3	15.7
6	6.2	6.1	5.7	4.5	3.0	19.4	18.9	19.4	14.4	16.1	14.4
7	5.1	5.0	4.9	4.3	3.4	18.1	18.2	18.1	14.6	14.4	14.6
8	4.3	4.3	4.2	3.9	3.5	16.9	17.4	16.9	14.0	13.3	14.0
9	3.9	3.9	3.8	3.6	3.4	16.4	16.8	16.4	13.3	13.3	13.3

ITL TEST #46982



Options

Wattage and Voltage

- 58 277/120 volt stepdown transformer for 277 volt line input, prewired into fixture; with 277 volt thermal protector.

Trims

- 16 Champagne Gold specular Alzak reflector. (CP x .93)
- 31 White flange (only) on self-flanged reflector.
- 32 White oversize trim ring. Specify O.D.

- 33 Decorative tempered glass Glow Ring suspended trim assembly.
- 45 Gasket between ceiling and reflector flange.
- 63 Dune specular Alzak reflector. (CP x .90)
- 69 Wheat specular Alzak reflector. (CP x .88)
- 70 Softex clear reflector. (CP x .90)
- 71 Softex Dune reflector. (CP x .81)
- 72 Black specular Alzak reflector. (CP x .80)
- 79 Extension collar for ceilings up to 2" thick.

- 91 Softex Wheat reflector. (CP x .85)
- 93 Pewter specular Alzak reflector. (CP x .75)
- 94 Custom color/finish. Specify. Consult factory.
- OG OptiGroove black seamless tapered aluminum reflector. White trim, self-flanged. (CP x .90)
- WW Wall wash version instead.
- Other**
- 99 Special modification. Consult factory.

SUBMITTAL DATA

APPROVAL STAMP

JOB NAME _____

TYPE _____

WATTAGE _____ VOLTAGE _____

CATALOG NUMBER _____

LIMITED WARRANTY: CATALOGED KIRLIN FIXTURES ARE WARRANTED FREE OF DEFECTS IN WORKMANSHIP OR MATERIAL FOR THREE YEARS FROM DATE OF PURCHASE. INSTALL TO N.E.C. IN NORMAL USE. Manufacturer of the option will replace or repair such fixture or refund the purchase price on presentation of proof of purchase and defective fixture at the office of manufacturer within three years of original shipment. Liability of manufacturer is limited to the foregoing and manufacturer shall not be liable for any other damages, direct or indirect, sustained or suffered by purchaser or any person. This warranty is supplied to the buyer in place of all other warranties, expressed or implied. Seller does not warrant as to merchantability or fitness for a particular use, nor will any oral statement constitute a warranty or amend the specific warranty. Abnormal use, abuse of the fixture, improper installation, or repair or modification of the fixture without prior written authorization from the manufacturer will render the warranty void.