

CATALOG #	TYPE	
JOB NAME	WATTAGE	VOLTAGE

4" 1 A19 100 WATT MAXIMUM

Type IC - IRR-04127

Type IC Alzak® 100 Watt Downlight

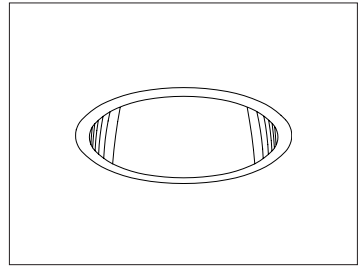

Specifications

Lamp / Socket

- Designed for one vertical frosted incandescent lamp (by others): 100W maximum A19.
- Dimmable (controls by others).
- Glazed porcelain medium base socket.

Reflector

- Self-flanged compound curved specular Alzak® aluminum.
- Optional reflector finishes and colors available.

Aluminum Housing

- Cool. Acrylic enameled 100% aluminum.
- Rustproof and corrosion resistant: Exceeds 1000 hour ASTM 5% salt spray test.
- Dissipates heat across entire surface area extending component life.
- Entire luminaire visible and serviceable from below through aperture.
- Built-in plaster frame. Also see Option -79.

Outlet Box and Thermal Protection

- UL listed J-box with insulated removable cover. Prewired 14 GA (NEC) with 1/2" and 3/4" knockouts.
- Thermal protector (per current NEC) provides automatic cut-off if rated wattage is exceeded.

Installation

- 27" galvanized hanger bars supplied (2).
- Fully adjustable universal galvanized mounting brackets supplied (2).
- Recesses indoor or outdoor in covered ceilings.

UL C-UL (Canada) Listings

- Wet, damp or dry locations, covered ceilings.
- Through branch conductors (6 #12 AWG 90°C).
- Type IC. Approved for direct contact with insulation.

Three Year Limited Warranty

- Complete standard fixture.

Recessed Round
Open
Single Reflector
Type IC

Performance at a Glance

IRR-04127: Type IC

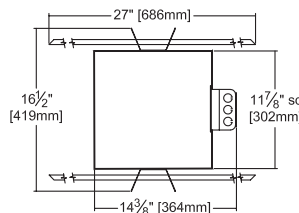
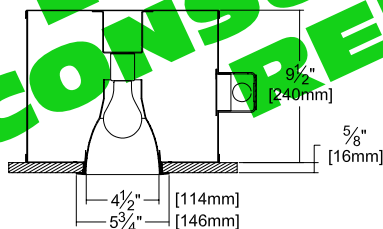

Ceiling Cut-out
5" Dia.

Cone of Light Key

- Ft. Distance from fixture
- FC Footcandles at nadir (0°)
- Dia. Circle of light at 50% of FC

* Dia. (in ft.) shown is where FC value is half the FC at nadir.

IRR-04127 (100 Watt)

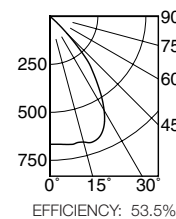

Cone of Light*

Dist.	FC	Dia.
6	18.5	7.3
8	10.4	9.7
10	6.7	12.2
12	4.6	14.6
14	3.4	17.0
16	2.6	19.5

SC = 1.1

ITL TEST #47085



Exceptional
Energy
Efficiency

THE KIRLIN COMPANY

3401 EAST JEFFERSON AVENUE • DETROIT, MICHIGAN 48207-4232
(313) 259-6400 • Fax: (313) 259-9409 OR (313) 259-3121 • www.kirlinlighting.com

TUNGSTEN HALOGEN &
INCANDESCENT LIGHTING

MAXIMUM WATTAGE

100

CATALOG NUMBER

IRR-04127

DUE TO OUR CONTINUING EFFORT TO IMPROVE PRODUCTS, TECHNICAL INFORMATION IS SUBJECT TO CHANGE WITHOUT NOTICE.

Alzak® is a registered trademark of ALCOA.

Detailed Photometry - Installed Fixture

Photometry from I.T.L., Boulder, CO

IRR-04127 (100 Watt)

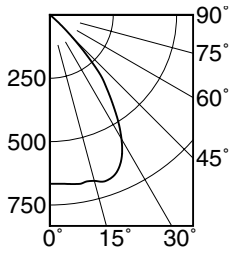

SC = 1.1
EFFICIENCY: 53.5%

CANDLEPOWER DISTRIBUTION					
	0.0	22.5	45.0	67.5	90.0
0	666	666	666	666	666
5	669	669	669	669	669
15	678	678	678	678	678
25	654	654	654	654	654
35	436	436	436	436	436
45	128	128	128	128	128
55	2	2	2	2	2
65	1	1	1	1	1
75	0	0	0	0	0
85	0	0	0	0	0
90	0	0	0	0	0

COEFFICIENTS OF UTILIZATION							
RF	20						
RC	80		50				
RW	70	50	30	10	50	30	10
1	61	59	58	56	56	55	54
2	57	55	52	50	52	50	49
3	54	51	48	45	48	46	44
4	51	47	44	41	45	42	40
5	48	43	40	37	42	39	37
6	45	40	37	34	39	36	34
7	43	37	34	32	36	33	31
8	40	35	31	29	34	31	29
9	38	33	29	27	32	29	27
10	36	31	27	25	30	27	25

ITL TEST #47085

IRR-04127-WW (100 Watt)

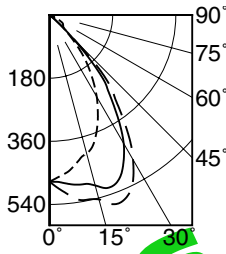

WALL → 90°
180°
EFFICIENCY: 40.4%

CANDLEPOWER DISTRIBUTION					
	0.0	45.0	90.0	135.0	180.0
0	475	475	475	475	475
5	456	463	481	500	508
15	409	440	503	540	544
25	326	377	490	536	549
35	207	249	324	359	371
45	75	74	98	99	111
55	47	35	9	5	5
65	25	22	14	19	23
75	7	4	4	6	7
85	0	0	0	0	0
90	0	0	0	0	0

FIXTURE CENTER TO WALL (ft)	SINGLE FIXTURE			MULTIPLE FIXTURES					
	1'	2'	4'	3' CENTERS		4' CENTERS			
1	1.50	1.21	0.55	4.06	3.92	4.06	3.46	3.17	3.46
2	2.25	1.77	0.68	6.47	6.37	6.47	5.38	4.87	5.38
3	3.00	2.41	1.12	6.70	6.12	6.70	5.66	4.63	5.66
4	3.75	2.61	1.21	8.26	9.20	8.26	6.94	6.77	6.94
5	4.50	3.75	3.05	9.57	9.25	9.57	6.98	7.67	6.98
6	5.25	3.13	2.74	8.99	9.07	8.99	7.30	7.12	7.30
7	6.00	2.65	2.58	8.38	8.53	8.38	6.70	6.67	6.70
8	6.75	2.19	2.15	7.88	7.85	7.88	6.18	6.35	6.18
9	7.50	1.88	1.86	7.35	7.47	7.35	5.88	5.95	5.88

ITL TEST #47263

Options

Trims

- 16 Champagne Gold specular Alzak reflector. (CP x .93)
- 31 White flange (only) on self-flanged reflector.
- 32 White oversize trim ring. Specify O.D.
- 45 Gasket between ceiling and reflector flange.
- 63 Dune specular Alzak reflector. (CP x .90)
- 69 Wheat specular Alzak reflector. (CP x .88)
- 70 SofTex clear reflector. (CP x .90)
- 71 SofTex Dune reflector. (CP x .81)
- 79 Extension collar for ceilings up to 2" thick.
- 91 SofTex Wheat reflector. (CP x .80)
- 93 Pewter specular Alzak reflector. (CP x .85)
- 94 Custom color/finish. Specify. Consult factory.
- WW Wall wash version instead.

Other

- 99 Special modification. Consult factory.

SUBMITTAL DATA

APPROVAL STAMP

JOB NAME
TYPE
WATTAGE
VOLTAGE
CATALOG NUMBER

LIMITED WARRANTY: CATALOGED KIRLIN FIXTURES ARE WARRANTED FREE OF DEFECTS IN WORKMANSHIP OR MATERIAL FOR THREE YEARS FROM DATE OF PURCHASE. INSTALL TO N.E.C. IN NORMAL USE. Manufacturer of the fixture will replace or repair such fixture or refund the purchase price on presentation of proof of purchase and defective fixture at the offices of manufacturer within three years of original shipment. Liability of manufacturer is limited to the foregoing and manufacturer shall not be liable for any other damages, direct or indirect, sustained or suffered by purchaser or any person. This warranty is supplied to the buyer in place of all other warranties, expressed or implied. Seller does not warrant as to merchantability or fitness for a particular use, nor will any oral statement constitute a warranty or amend the specific warranty. Abnormal use, abuse of the fixture, improper installation, or repair or modification of the fixture without prior written authorization from the manufacturer will render the warranty void.