

CATALOG #	TYPE	
JOB NAME	WATTAGE	VOLTAGE

4" 1 PAR 30 75 WATT MAXIMUM

IRR-04092

Mini-PAR Adjustable in 4" Aperture

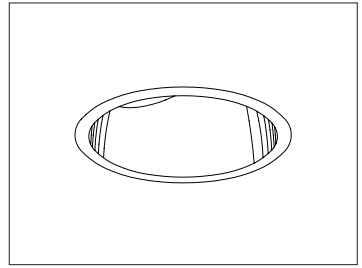

Specifications

Lamp / Socket Assembly

- Designed for tungsten halogen lamp (by others): 75W maximum PAR 30.
- Rated 2000-2500 hour life. 100 CRI.
- Dimmable (controls by others).
- Swivels 360° and tilts up to 45°.
- Glazed porcelain medium base socket.

Reflector

- Self-flanged parabolic specular Alzak® aluminum.
- Optional reflector finishes, colors and square trim available.

Aluminum Housing

- Cool. Acrylic enameled 100% aluminum.
- Rustproof and corrosion resistant: Exceeds 1000 hour ASTM 5% salt spray test.
- Dissipates heat across entire surface area extending component life.

- Entire luminaire visible and serviceable from below through aperture.
 - Built-in plaster frame. Also see Option -79.
- #### Outlet Box and Thermal Protection
- UL listed J-box with insulated removable cover. Prewired 14 GA (NEC) with 1/2" and 3/4" knockouts.
 - Thermal protector (per current NEC) provides automatic cut-off if rated temperature is exceeded.

Installation

- 27" galvanized hanger bars supplied (2).
- Fully adjustable universal galvanized mounting brackets supplied (2).
- Recesses indoor or outdoor in covered ceilings.

UL, C-UL (Canada) Listings

- Wet, damp or dry locations, covered ceilings.
- Through-branch conductors (6 #12 AWG 90°C).

Three Year Limited Warranty

- Complete standard fixture.

Recessed Round
Open
Adjustable

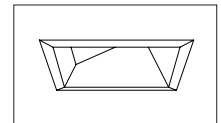

Square Reflector
Option -SQ

Performance at a Glance

IRR-04092

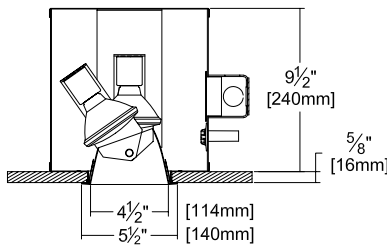

Ceiling Cut-out
5" Dia.

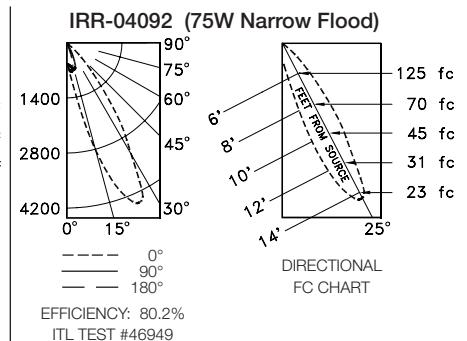
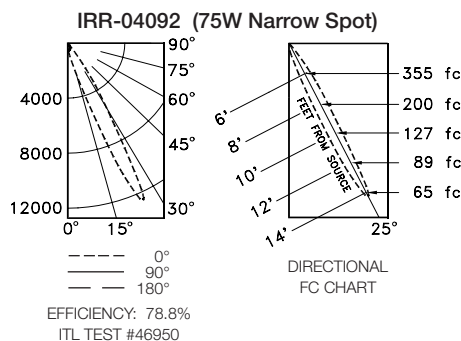
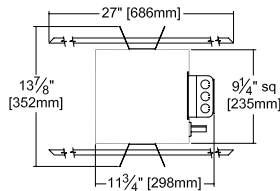

PHOTOMETRIC DATA
SHOWN AT 25° TILT

THE KIRLIN COMPANY

3401 EAST JEFFERSON AVENUE • DETROIT, MICHIGAN 48207-4232
(313) 259-6400 • Fax: (313) 259-9409 OR (313) 259-3121 • www.kirlinlighting.com

TUNGSTEN HALOGEN &
INCANDESCENT LIGHTING

MAXIMUM WATTAGE

75

CATALOG NUMBER

IRR-04092

DUE TO OUR CONTINUING EFFORT TO IMPROVE PRODUCTS, TECHNICAL INFORMATION IS SUBJECT TO CHANGE WITHOUT NOTICE.

Alzak® is a registered trademark of ALCOA.

Detailed Photometry - Installed Fixture

Photometry from I.T.L., Boulder, CO

IRR-04092 (75 Watt Narrow Spot)

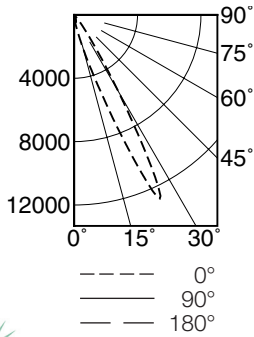

EFFICIENCY : 78.8%

CANDLEPOWER DISTRIBUTION					
	0.0	45.0	90.0	135.0	180.0
0	295	295	295	295	295
5	300	275	375	400	400
15	2248	649	462	350	275
25	12787	524	150	75	75
35	1424	100	12	12	25
45	75	0	0	0	0
55	0	0	0	0	0
65	0	0	0	0	0
75	0	0	0	0	0
85	0	0	0	0	0
90	0	0	0	0	0

COEFFICIENTS OF UTILIZATION							
RF	20						
RC	80			50			
RW	70	50	30	10	50	30	10
1	90	87	86	84	83	81	80
2	85	81	78	76	78	75	73
3	81	76	72	69	73	70	67
4	77	71	67	63	68	65	62
5	73	66	62	58	64	60	58
6	69	62	57	54	60	56	53
7	66	58	53	50	57	53	50
8	62	55	51	47	53	49	46
9	59	51	47	43	50	46	43
10	56	48	44	40	47	43	40

ITL TEST #46950

IRR-04092 (75 Watt Narrow Flood)

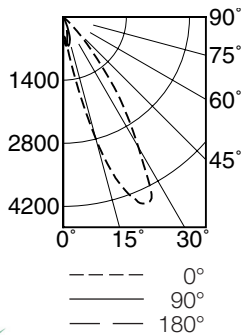

EFFICIENCY : 80.2%

CANDLEPOWER DISTRIBUTION					
	0.0	45.0	90.0	135.0	180.0
0	502	502	502	502	502
5	463	465	543	602	633
15	2794	865	559	339	313
25	4523	639	148	64	68
35	2164	133	26	21	23
45	373	19	8	6	8
55	23	3	0	0	0
65	0	0	0	0	0
75	0	0	0	0	0
85	0	0	0	0	0
90	0	0	0	0	0

COEFFICIENTS OF UTILIZATION							
RF	20						
RC	80			50			
RW	70	50	30	10	50	30	10
1	91	89	87	87	84	82	81
2	86	83	79	79	79	76	74
3	82	77	73	73	74	71	68
4	78	72	67	67	69	66	63
5	74	67	62	62	65	61	58
6	70	63	58	58	61	57	54
7	66	59	54	54	57	53	50
8	63	55	50	50	54	50	47
9	60	52	47	47	51	46	43
10	5	49	44	44	48	44	41

ITL TEST #46949

Options

Wattage and Voltage

- 58 277/120 volt stepdown transformer for 277 volt line input, prewired into fixture; with 277 volt thermal protector.

Trims

- 16 Champagne Gold specular Alzak reflector. (CP x .98)
- 30 All white reflector. (CP x .98)
- 31 White flange (only) on self-flanged reflector.

- 32 White oversize trim ring. Specify O.D.
- 45 Gasket between ceiling and reflector flange.
- 63 Dune specular Alzak reflector. (CP x .97)
- 69 Wheat specular Alzak reflector. (CP x .97)
- 70 SofTex clear reflector. (CP x .98)
- 71 SofTex Dune reflector. (CP x .95)
- 72 Black specular Alzak reflector. (CP x .80)
- 79 Extension collar for ceilings up to 2" thick.
- 91 SofTex Wheat reflector. (CP x .95)
- 93 Pewter specular Alzak reflector. (CP x .95)
- 94 Custom color/finish. Specify. Consult factory.

- OG OptiGroove black seamless tapered aluminum reflector. White trim, self-flanged. (CP x .82)
- SQ 4.5" Square self-flanged clear specular reflector instead. (Ceiling cut-out 5.25" sq.)

Other

- 99 Special modification. Consult factory.
- LP With PAR 30 lamp. Specify wattage and beam spread.

SUBMITTAL DATA

JOB NAME
TYPE
WATTAGE VOLTAGE
CATALOG NUMBER

APPROVAL STAMP

LIMITED WARRANTY: CATALOGED KIRLIN FIXTURES ARE WARRANTED FREE OF DEFECTS IN WORKMANSHIP OR MATERIAL FOR THREE YEARS FROM DATE OF PURCHASE. INSTALL TO N.E.C. IN NORMAL USE. Manufacturer at the option will replace or repair such fixture or refund the purchase price on presentation of proof of purchase and defective fixture at the office of manufacturer within three years of original shipment. Liability of manufacturer is limited to the foregoing, and manufacturer shall not be liable for any other damages, direct or indirect, sustained or suffered by purchaser or any person. This warranty is subject to the buyer in place of all other warranties, expressed or implied. Seller does not warrant as to merchantability or fitness for a particular use, nor will any oral statement constitute a warranty or amend this specific warranty. Abnormal use, abuse of the fixture, improper installation, or repair or modification of the fixture without prior written authorization from the manufacturer will render the warranty void.