

Recessed Lensed  
E-Lamp Downlights  
50 to 150 Watt



8" 100W  
11" 150W

**HRS-08167**  
**HRS-11168**

# THIS PRODUCT IS NO LONGER AVAILABLE

## PLEASE CONSULT QUOTATIONS

For the best alternative.

### Features

#### Lamp

- Designed for medium base metal halide E-lamps. See chart below for standard and optional wattages.
- See Option -43 and chart below for lower wattage or HPS availability.

#### Socket

- Horizontal. Medium base. Pulse rated.
- Nickel-plated brass screw shell. Silicone leads. Glazed porcelain.

#### Reflector

- GlasSurf™ multi-faceted reflector aluminum.

#### Trim Assembly

- UV absorbing, tempered prismatic shock resistant acrylic trim.
- Rustfree die-formed door and captive thumb screw(s). Concealed hinges.

- Recessed cast aluminum frame. Tapped to accept close fit with acrylic finish. Ballast Assembly: Standard.
- WhisperPack™ fully encapsulated 180°C rated HPF pulse start ballast.
- Class H, high reactance for 120 volt, linear reactor for 277 volt.
- Capacitor and ignitor supplied.
- Temperature (-30° to 130°) ballast assembly. See Options.
- Cool, quiet, long-life. Silicone leads.
- Visible and easily serviced in all ceilings.
- Flush or recessed. Flush or recessed.
- Acrylic enameled aluminum.
- Cool. Dissipates heat across entire surface.
- Easy to install.
- Rustproof. Exceeds 1000 hour ASTM 5% salt spray test.

- Entire luminaire serviced from below through removable reflector.
- Built-in plaster frame.

#### Outlet Box

- Prewired 14 GA (NEC) galvanized steel, UL listed; with removable insulated cover.
- 1/2" and 3/4" knockouts.

#### Installation

- 27" galvanized hanger bars supplied (2).
- Fully adjustable universal mounting brackets supplied (2).
- Recesses indoor or outdoor in covered locations.

#### UL C-UL (Canada) Listings

- Wet, damp or dry locations, covered ceilings.
- Through-brand circuit conductors (6 #12).

#### Three Year Limited Warranty

- Complete standard fixture, including ballast.

#### Thermal Protection

- Per current NEC.

### Wattage Availability and Cut-out Dimensions

Catalog No.	Lamp/Base	Standard Wattage		Option -43: Lower Wattage		Max. Standby Wattage (-49-65-66-LS)	Ceiling Cut-Out
		Pulse MH	-24 (HPS)	Pulse MH	-24 (HPS)		
HRS-08167	ED-17/Med	100	100	50-70	35-70	100	9.5" Sq.
HRS-11168	ED-17/Med	150	150	50-125	35-100	100	12.25" Sq.

### Options

#### Sources and Ballasts

- 24 HPS ballast instead. See wattage chart above for available wattages. Specify voltage.
- 39 Electronic dimming ballast instead, for pulse start metal halide. Consult factory for wattage and voltage availability.
- 96 Regulating electronic MH ballast instead.

#### Wattage and Voltage

- 43 Lower wattage: See Option -43 chart above for available lower wattages. Specify voltage.
- 120 120 volt, 60 Hz. ballast.
- 277 277 volt, 60 Hz. ballast.
- 347 347 volt, 60 Hz. ballast. Consult factory for dimming or electronic.
- 97 Other voltage ballast. Consult factory.

#### Relays, Standbys, Lamps (See Chart)

- 49 Extra circuit DCB socket. Do not energize simultaneously with main source. Also see -LS.
- 65 Electronic standby system and DCB socket. Following HID outage, provides immediate light until HID restrikes. Also see -66 and -LS.
- 66 Electronic time delay standby system and DCB socket. Following outage, provides light until HID reaches 70% output. Also see Option -LS.
- LP With lamp. Specify source, wattage, color temperature, and clear or coated. (3700°K standard for metal halide)
- LS With T-4 DCB tungsten halogen standby lamp. Use only with Options -49, -65 or -66.

#### Lenses and Trims

- 15 Prismatic C#73 flat glass lens instead.
- 26 Tamperproof recessed hex, center pin, button door screw with key. One key per ten fixtures. Also see Option -27.

- 27 Clear 1/4" tempered glass beneath tempered prismatic C#73 flat glass lens for added vandal resistance. Also see Option -26.
- 32 Trim extender. Broadens trim flange O.D. by 1".
- 45 Gasket between trim and ceiling.
- 46 Gasket between trim and lens.
- 94 Custom color frame finish instead. Consult factory.
- DG Drop Guard with tempered flat prismatic glass. Galvanized steel. White acrylic finish.
- DH Drop Holophane tempered lens instead for HRS-11168 only.

#### Mounting Options

- 85 Ceiling Panel; with recessed fixture hole. Lays-in 2' x 2' grid. White

#### Other Options

- 99 Special modification. Consult factory.



### THE KIRLIN COMPANY

3401 EAST JEFFERSON AVENUE • DETROIT, MICHIGAN 48207-4232  
(313) 259-6400 • Fax: (313) 259-9409 or (313) 259-3121 • www.kirlinlighting.com

THE KIRLIN COMPANY RESERVES THE RIGHT TO CHANGE, WITHOUT NOTICE, DETAILS OR SPECIFICATIONS IN PRODUCT DESIGN.

**HRS-08167**  
**HRS-11168**

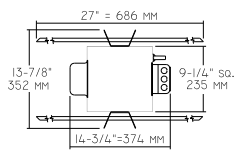

Plan View A

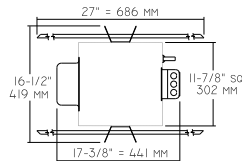

Plan View B

**Cone of Light Key**  
**Ft.** Distance from fixture  
**FC** Footcandles (average)  
**Dia.** Circle of light at 50% of FC  
 \* Dia. (in ft.) shown is where FC value is half the FC at nadir.

**C.U. (Coefficients of Utilization)**  
 Tables are available on request.  
 Please contact your Kirlin representative.

LIMITED WARRANTY: CATALOGED KIRLIN FIXTURES ARE WARRANTED FREE OF DEFECTS IN WORKMANSHIP OR MATERIAL FOR THREE YEARS FROM DATE OF PURCHASE. INSTALLED TO N.E.C. IN NORMAL USE. Manufacturer at the option will replace or repair, at no charge, the fixture or ballast, or both, if found to be defective in workmanship or material. This warranty is void if the fixture is used in an application for which it was not designed, or if it is damaged, altered, modified, or subjected to abnormal use. This warranty is void if the fixture is used in an application for which it was not designed, or if it is damaged, altered, modified, or subjected to abnormal use. This warranty is void if the fixture is used in an application for which it was not designed, or if it is damaged, altered, modified, or subjected to abnormal use.

**HRS-08167 100W (Plan View B)**

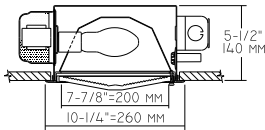

**HRS-08167 (Coated Lamp)**

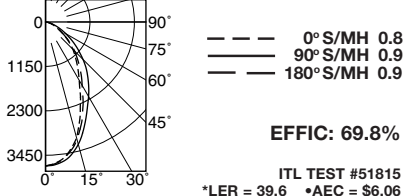

**Cone of Light\***

Ft.	FC	Dia.
6	103.5	5.4
8	58.2	7.2
10	37.3	8.9
12	25.9	10.7
14	19.0	12.5
16	14.6	14.3

	CANDLEPOWER DISTRIBUTION				
	0.0	45.0	90.0	135.0	180.0
0	3726	3726	3726	3726	3726
5	3637	3688	3684	3665	3651
15	3098	3125	3277	3164	3146
25	2141	2322	2539	2382	2302
35	1456	1590	1938	1659	1588
45	1000	1025	1372	1048	1065
55	569	671	832	672	585
65	279	377	417	366	287
75	124	155	159	146	126
85	24	28	28	31	26
90	6	6	9	7	8

**HRS-11168 150W (Plan View C)**

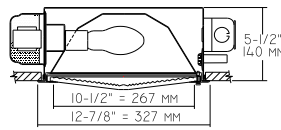

**HRS-11168 (Coated Lamp)**

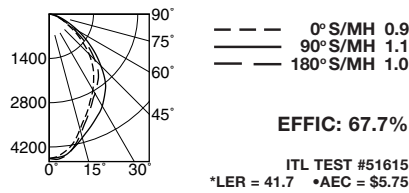

**Cone of Light\***

Ft.	FC	Dia.
6	126.8	5.9
8	71.3	7.9
10	45.6	9.8
12	31.7	11.8
14	23.3	13.8
16	17.8	15.7

	CANDLEPOWER DISTRIBUTION				
	0.0	45.0	90.0	135.0	180.0
0	4564	4564	4564	4564	4564
5	4441	4465	4521	4570	4562
15	3766	3855	4044	4009	3892
25	2621	3015	3576	3202	3166
35	2451	2270	3068	2460	2662
45	1783	1568	2311	1732	2036
55	1027	947	1451	1068	1181
65	494	513	728	569	542
75	215	222	299	239	215
85	55	58	67	60	53
90	19	14	15	12	14

**HRS-08167-15 (Coated Lamp)**

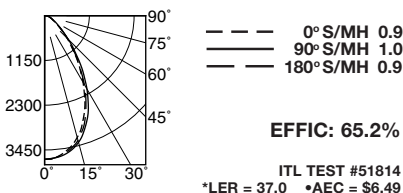

**Cone of Light\***

Ft.	FC	Dia.
6	102.5	5.9
8	57.7	7.8
10	36.9	9.8
12	25.6	11.8
14	18.8	13.7
16	14.4	15.7

	CANDLEPOWER DISTRIBUTION				
	0.0	45.0	90.0	135.0	180.0
0	3690	3690	3690	3690	3690
5	3643	3630	3655	3660	3649
15	3238	3326	3369	3383	3316
25	2454	2699	2659	2736	2514
35	1534	1736	1691	1738	1548
45	820	861	862	870	836
55	389	446	420	449	399
65	211	218	221	224	221
75	122	134	132	141	130
85	28	31	35	37	38
90	0	0	0	0	0

**HRS-11168-15 (Coated Lamp)**

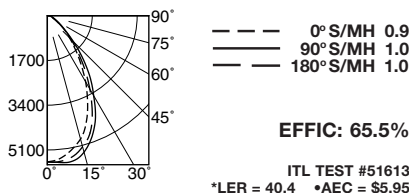

**Cone of Light\***

Ft.	FC	Dia.
6	154.3	6.1
8	86.8	8.1
10	55.5	10.1
12	38.6	12.2
14	28.3	14.2
16	21.7	16.2

	CANDLEPOWER DISTRIBUTION				
	0.0	45.0	90.0	135.0	180.0
0	5554	5554	5554	5554	5554
5	5448	5497	5600	5609	5556
15	4851	5174	5366	5489	5156
25	3603	4149	4308	4492	4021
35	2198	2684	2795	2899	2456
45	1188	1407	1387	1448	1279
55	578	644	639	656	581
65	270	309	327	320	270
75	173	202	190	198	171
85	60	75	66	74	53
90	0	0	0	0	0

\* LER (Luminaire Efficacy Rating) = Luminaire Effic. x Total Lamp Lumens x Ballast Factor / Input Watts

\* AEC = Annual Energy Cost per 1000 lumens (based on 3000 hours use @ \$0.08 KWH).

SUBMITTAL DATA

APPROVAL STAMP

JOB NAME

TYPE

WATTAGE

VOLTAGE

CATALOG NUMBER